

ANRAN Q4

ANRAN 4MP 360° PTZ WiFi Solar Camera System User Manual

Model: Q4

1. INTRODUCTION

Thank you for choosing the ANRAN 4MP 360° PTZ WiFi Solar Camera System. This system is designed to provide reliable and comprehensive surveillance for your home or property, featuring solar power for continuous operation, high-resolution video, and smart detection capabilities. Please read this manual thoroughly before installation and use to ensure proper operation and safety.

2. SAFETY INFORMATION

Always follow basic safety precautions when using this product to reduce the risk of fire, electric shock, and injury to persons. Keep the device away from water and moisture. Do not attempt to disassemble or repair the device yourself. Refer all servicing to qualified service personnel. Ensure the camera is mounted securely to prevent falling.

3. PACKAGE CONTENTS

Verify that all components are present in your package:

- 2 x ANRAN 4MP PTZ Solar Cameras
- 1 x ANRAN Home Base (with integrated 64GB storage)
- Mounting Screws and Anchors
- USB Charging Cable
- User Manual



Image: The ANRAN Q4 camera system, showing two solar-powered PTZ cameras, the home base, and a 64GB microSD card, representing the complete package contents.

4. PRODUCT OVERVIEW

4.1 ANRAN PTZ Solar Camera

The ANRAN PTZ Solar Camera features a built-in solar panel for continuous power, a 4MP lens for clear video, and pan/tilt capabilities for wide coverage. It also includes infrared LEDs for night vision, a spotlight for color night vision, a microphone, and a speaker for two-way audio.

Built-In Solar Panel

For Forever Power



Image: A close-up of the ANRAN PTZ solar camera, highlighting its integrated solar panel designed for continuous power supply.

4.2 ANRAN Home Base

The Home Base acts as the central hub for your camera system. It connects to your home Wi-Fi network and communicates wirelessly with the cameras. It features 64GB of integrated local storage for video recordings, eliminating the need for monthly cloud fees.

No Monthly Fee

Secure Local Storage
No additional Micro SD Purchase Required



Image: The ANRAN Home Base, emphasizing its secure local storage capability with a 64GB memory card icon, indicating no monthly fees for storage.

5. SETUP

5.1 Charging the Cameras

Before initial use, it is recommended to fully charge the cameras using the provided USB cable. While the solar panel provides continuous power, a full initial charge ensures optimal performance, especially during periods of low sunlight.

5.2 Connecting the Home Base

1. Connect the Home Base to a power outlet using the provided power adapter.
2. Connect the Home Base to your router via an Ethernet cable (recommended for initial setup) or connect wirelessly via the app.
3. Wait for the indicator lights to show a stable connection.

5.3 App Installation and Pairing

Download the ANRAN app from the Google Play Store or Apple App Store. Follow the in-app instructions to create an account and add your Home Base by scanning the QR code on the device. Once the Home Base is added, you can pair your cameras to the system.

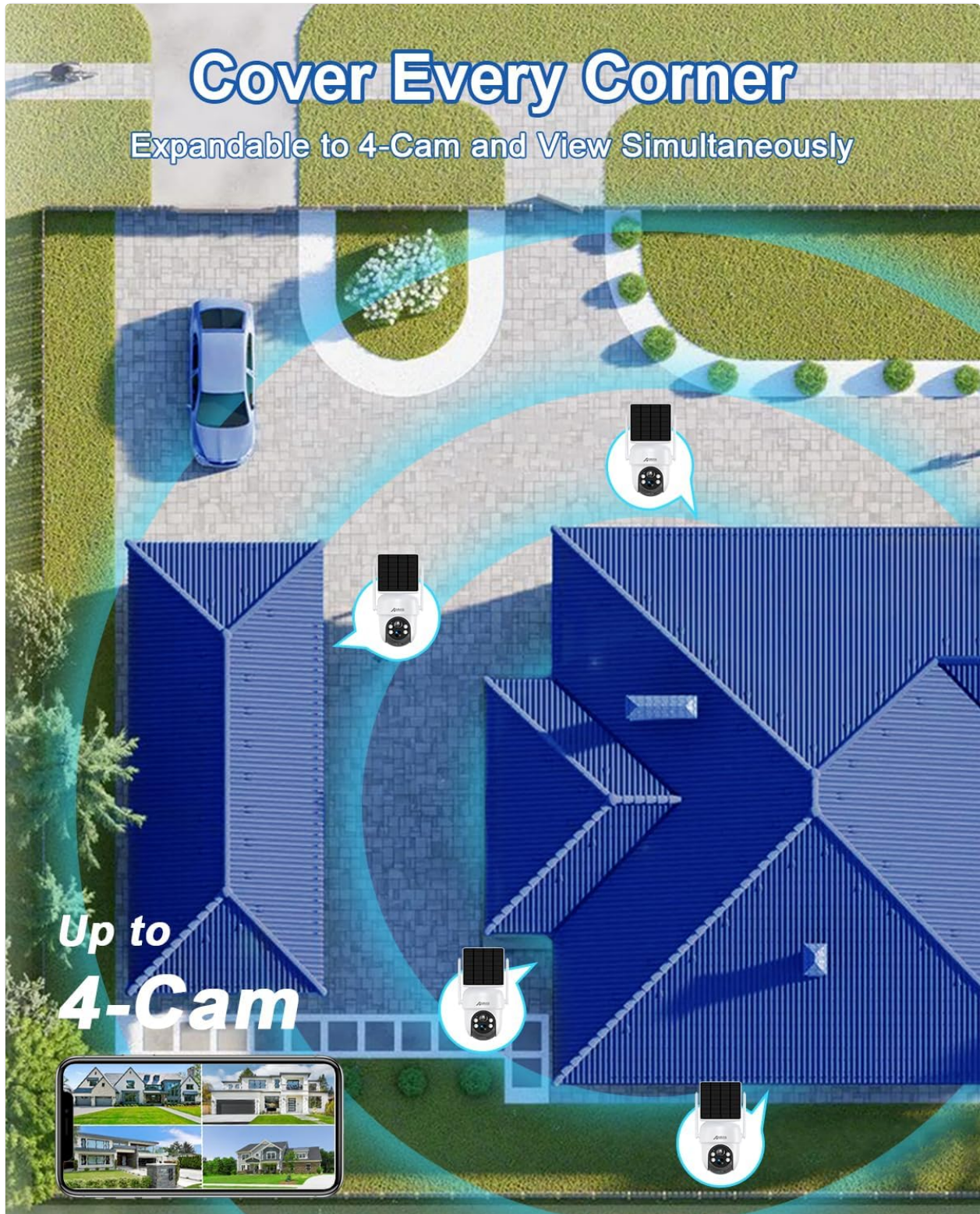

Image: A visual representation of the ANRAN app interface, demonstrating its ability to display multiple camera feeds simultaneously and its compatibility with various smart home platforms like Alexa and Google Home.

5.4 Camera Installation

The ANRAN Q4 cameras are 100% wireless, allowing for flexible installation without the need for complex wiring. Choose a location with good Wi-Fi signal and sufficient sunlight exposure for the solar panel. Mount the camera securely using the provided screws and anchors.



Image: A person easily installing an ANRAN solar camera on an exterior wall, illustrating the simple, minute-long installation process without additional drilling.

6. OPERATING INSTRUCTIONS

6.1 Live View

Open the ANRAN app to access the live feed from your cameras. You can switch between cameras or view multiple feeds simultaneously.

6.2 Pan & Tilt Control

Utilize the pan (355°) and tilt (90°) functions within the app to adjust the camera's viewing angle remotely, ensuring comprehensive coverage without blind spots.



Image: A smartphone screen showing the ANRAN app interface, with arrows indicating the 355° pan and 90° tilt rotation capabilities of the camera, controlled directly from the application.

6.3 Two-Way Audio

The built-in microphone and speaker allow for two-way communication. Tap the microphone icon in the app to speak through the camera, and hear responses from the camera's location.



Image: A person interacting with a delivery driver via the ANRAN camera's two-way audio feature, demonstrating clear communication through the device.

6.4 Motion Detection and Alerts

The camera features intelligent AI/PIR human detection to minimize false alarms. When motion is detected, the camera can trigger a light alert, an audible alarm, and send instant notifications to your smartphone.

PIR Human Motion Detection & Real-time Alerts

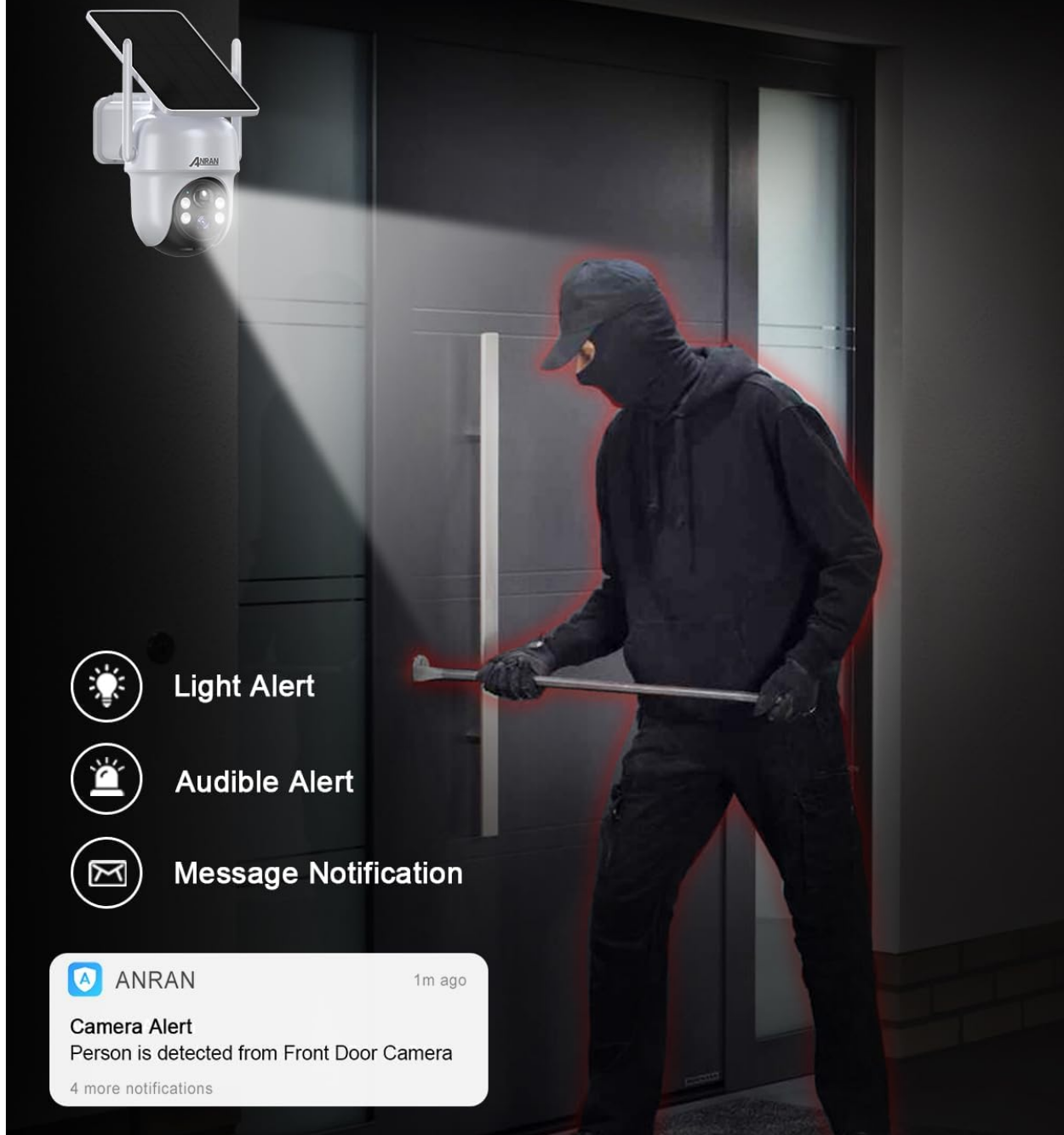

Image: An ANRAN camera detecting a person, illustrating the PIR human motion detection feature with light, audible, and message notifications being triggered.

6.5 Recording and Playback

All detected events are recorded and stored locally on the Home Base's 64GB memory. You can access and review recorded footage directly from the ANRAN app. The system supports continuous loop recording for over 180 days.

6.6 Video Quality and Night Vision

The 4MP (2592×1944p) resolution provides superior video clarity. The camera also features color night vision, allowing you to see detailed, full-color images even in low-light conditions.



Image: A comparison showing the superior clarity of 4MP resolution from the ANRAN camera versus lower resolution cameras, highlighting detail in a car's license plate.

7. MAINTENANCE

7.1 Cleaning

Regularly clean the camera lens and solar panel with a soft, damp cloth to ensure optimal image quality and charging efficiency. Do not use harsh chemicals or abrasive materials.

7.2 Battery Care

While the solar panel provides continuous charging, ensure the camera receives adequate sunlight. If the camera is installed in a shaded area or during prolonged cloudy periods, occasional manual charging via USB may be necessary to maintain battery health.

7.3 Firmware Updates

Keep your camera and Home Base firmware updated through the ANRAN app. Firmware updates often include performance improvements, new features, and security enhancements.

8. TROUBLESHOOTING

Problem	Possible Cause	Solution
Camera not connecting to Home Base	Out of range; interference; Home Base offline	Move camera closer; reduce interference; check Home Base power/network
Poor video quality	Dirty lens; low light; weak Wi-Fi signal	Clean lens; ensure adequate lighting; improve Wi-Fi signal
Battery not charging	Insufficient sunlight; dirty solar panel; faulty cable	Relocate camera for more sun; clean panel; try different USB cable
Frequent false alarms	Sensitivity too high; non-human motion	Adjust detection sensitivity in app; ensure human detection is enabled

9. SPECIFICATIONS

Feature	Detail
Model	Q4
Resolution	4 Megapixels (2592x1944p)
Pan/Tilt Range	Pan 355°, Tilt 90°
Connectivity	Wireless (Wi-Fi)
Power Source	Solar Powered (with rechargeable Lithium-ion battery)
Local Storage	64GB integrated (Home Base)
Detection	AI/PIR Human Motion Detection

Feature	Detail
Night Vision	Color Night Vision
Audio	Two-Way Audio
Material	Plastic
Voltage	12 Volts
Power	5 Watts
Product Dimensions (L x W x H)	25 x 25 x 25 millimeters
Weight	2.37 Kilograms (package weight)

10. WARRANTY AND SUPPORT

ANRAN products come with a 2-year manufacturer's warranty. For technical support or warranty claims, please contact ANRAN customer service. Our team is available for lifetime technical support and 7x24 hours online service.



2 Years Warranty



Lifetime Technical Support



7x24 Hours Online Service