

DBIT T1 Pro

DBIT N300 T1 Pro Wireless Wi-Fi Router User Manual

Model: T1 Pro

[Introduction](#) [Package Contents](#) [Product Overview](#) [Setup Guide](#) [Operating Modes](#) [Advanced Features](#) [Troubleshooting](#) [Specifications](#) [Warranty & Support](#)

1. INTRODUCTION

This manual provides detailed instructions for setting up, operating, and maintaining your DBIT N300 T1 Pro Wireless Wi-Fi Router. The N300 T1 Pro is designed to provide reliable wireless connectivity for your home or small office, supporting Wireless N speeds up to 300 Mbps. It features two high-power antennas, four Fast Ethernet ports, and supports various operating modes including Wireless Repeater and WISP.



Image 1.1: The DBIT N300 T1 Pro Wireless Wi-Fi Router, a compact black device with two external antennas.

2. PACKAGE CONTENTS

Verify that all items are present in your package:

- DBIT N300 T1 Pro Wi-Fi Router
- Power Adapter
- RJ45 Ethernet Cable
- User Manual (this document)

3. PRODUCT OVERVIEW

3.1. Hardware Layout

Familiarize yourself with the ports and buttons on your router:



Image 3.1: Rear view of the DBIT N300 T1 Pro router, highlighting the WPS/Reset button, LAN ports (LAN1, LAN2, LAN3), WAN port, and DC IN power port.

- **WPS/Reset Button:** Press for 1-2 seconds to activate WPS (Wi-Fi Protected Setup). Press and hold for 5-8 seconds to reset the router to factory default settings.
- **LAN Ports (1-4):** Four 10/100 Mbps Fast Ethernet ports for connecting wired devices such as computers, smart TVs, and gaming consoles.
- **WAN Port:** One 10/100 Mbps Fast Ethernet port for connecting to your modem or internet service provider's (ISP) network.
- **DC IN:** Power input port for connecting the provided power adapter.

4. SETUP GUIDE

4.1. Initial Hardware Connection

1. **Power Off Modem:** Disconnect the power from your existing modem.
2. **Connect Router:** Connect one end of the provided Ethernet cable to the WAN port of the DBIT N300 T1 Pro router and the other end to your modem's Ethernet port.
3. **Connect Power:** Plug the power adapter into the DC IN port of the router and then into a power

outlet.

4. **Power On:** Power on your modem first, wait for it to fully boot up (usually indicated by stable lights), then power on the DBIT router.

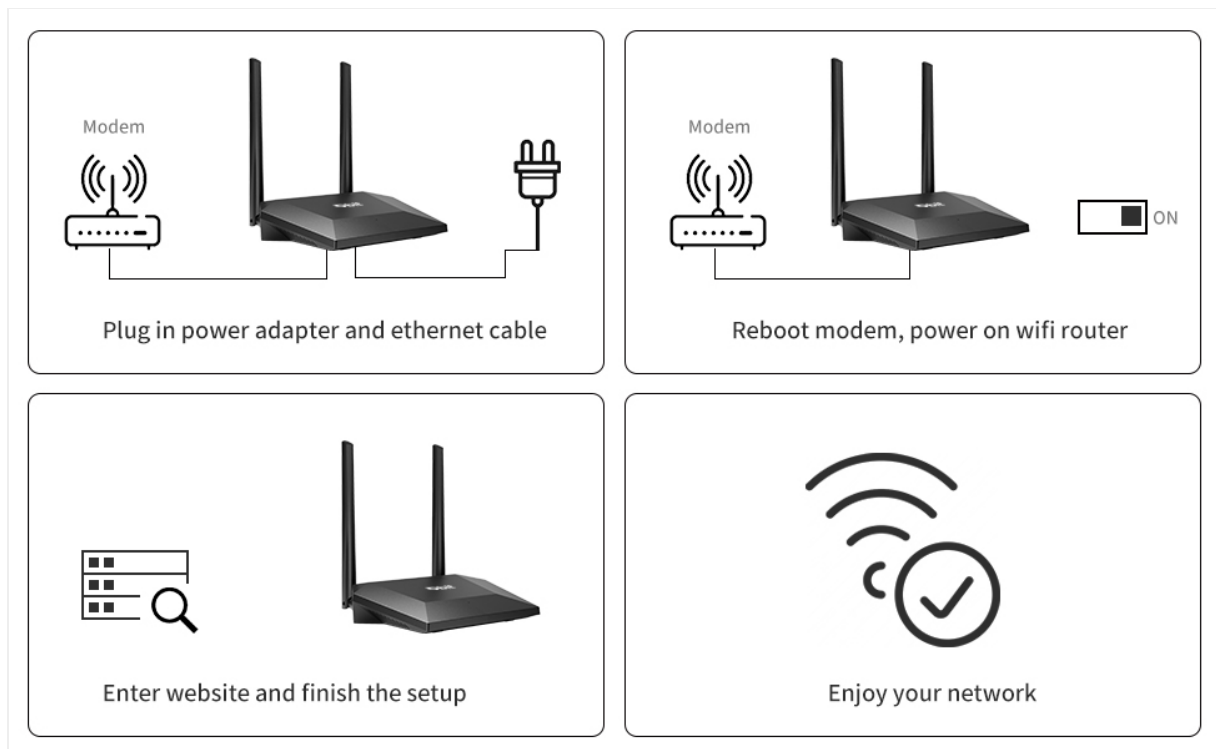

Image 4.1: A visual representation of the network setup, illustrating the connection from the internet to the modem, then to the T1 Pro router, and finally to various devices like laptops and desktops.

4.2. Connecting Devices

After the router is powered on and connected to the internet, you can connect your devices:

- **Wireless Connection:** On your Wi-Fi enabled device (smartphone, tablet, laptop), search for available Wi-Fi networks. Select the SSID (network name) printed on the label at the bottom of your router. Enter the default Wi-Fi password also found on the label.
- **Wired Connection:** Connect an Ethernet cable from one of the router's LAN ports to the Ethernet port on your computer or other wired device.

4.3. Web Interface Configuration

To customize your network settings, access the router's web interface:

1. Open a web browser on a device connected to the router (wired or wirelessly).
2. In the address bar, type the default IP address (e.g., 192.168.1.1 or 192.168.0.1) found on the router's label and press Enter.
3. Enter the default username and password (commonly admin for both, check the router label for specifics).
4. Follow the on-screen setup wizard to configure your internet connection, change the Wi-Fi name (SSID), and set a strong Wi-Fi password.



Image 4.2: Screenshots of the router's web-based management interface, accessible from a smartphone, displaying the login page, network status, and Wi-Fi configuration options.

4.4. WPS Connection

WPS (Wi-Fi Protected Setup) allows for easy connection of compatible devices without entering the Wi-Fi password:

1. Press the WPS button on your DBIT N300 T1 Pro router for 1-2 seconds.
2. Within two minutes, activate the WPS function on your client device (e.g., wireless adapter, printer).
3. The devices will automatically establish a secure wireless connection.

Advanced Security

Multi-level wireless encryption options to prevent unauthorized access, securing your network privacy.



Image 4.3: A hand pressing the WPS button located on the back panel of the DBIT N300 T1 Pro router, indicating the ease of connecting devices.

5. OPERATING MODES

The DBIT N300 T1 Pro router supports multiple operating modes to suit various networking needs:

- **Router Mode (Default):** Connects to your modem to provide internet access to all connected devices, both wired and wireless.
- **Wireless Repeater Mode (WISP):** Extends the coverage of an existing wireless network by connecting to it wirelessly and rebroadcasting the signal. This is useful for eliminating Wi-Fi dead zones.

Wireless Repeater-WISP

The WISP function realizes wider wireless network coverage and also provides better network security for users.



Image 5.1: A diagram showing the Wireless Repeater (WISP) function, where the T1 Pro router extends the network coverage from an ISP Access Point to multiple wireless devices.

6. ADVANCED FEATURES

The router offers several advanced features configurable via the web interface:

- **Parental Control:** Manage internet access for specific devices or users, setting time limits or blocking certain websites.
- **IP-based Bandwidth Control:** Allocate specific bandwidth to individual devices or applications to ensure fair usage and optimize network performance.
- **Wireless Security:** Supports multiple wireless encryption options (WPA/WPA2-PSK) to secure your network and prevent unauthorized access.



WPS Connection

Devices can be easily connected to the wireless network through the webpage or by pressing WPS button.

Image 6.1: An abstract graphic depicting advanced security features, symbolized by a secure network represented by a cube and a padlock within a shield.

7. TROUBLESHOOTING

If you encounter issues, refer to the following common solutions:

- **No Internet Access:**

- Check all cable connections, ensuring they are secure.
- Verify that your modem is working correctly.
- Reboot both your modem and router.
- Ensure the WAN port is connected to the modem and the correct connection type (e.g., Dynamic IP, PPPoE) is configured in the router's web interface.

- **Cannot Access Web Interface:**

- Ensure your device is connected to the router (wired or wirelessly).
- Verify the router's IP address (check the label).
- Try clearing your browser's cache or using a different browser.
- If the issue persists, perform a factory reset by holding the WPS/Reset button for 5-8 seconds.

Note that a factory reset will erase all custom settings.

- **Slow Wireless Speed:**







- Ensure the router is placed in a central location, away from obstructions and interference sources (e.g., microwaves, cordless phones).
- Check for firmware updates for your router.
- Reduce the number of connected devices or bandwidth-intensive activities.

8. SPECIFICATIONS

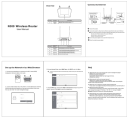
Feature	Detail
Model Name	T1 Pro 300Mbps WiFi Router
Wireless Standard	802.11n (Backward compatible with 802.11b/g)
Frequency Band	Single-Band (2.4GHz)
Wireless Speed	Up to 300 Mbps
Antennas	2 x 3dBi High Power Antennas
Ethernet Ports	4 x Fast Ethernet LAN (10/100 Mbps), 1 x Fast Ethernet WAN (10/100 Mbps)
Special Features	WPS, Wireless Repeater, WISP Mode, Parental Control, IP-based Bandwidth Control
Dimensions	9.76 x 8.7 x 1.85 inches
Item Weight	4.4 ounces
Manufacturer	Micronet Union Technology Co., Ltd.

9. WARRANTY AND SUPPORT

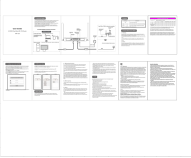
The DBIT N300 T1 Pro Wireless Wi-Fi Router comes with a standard manufacturer's warranty. For detailed warranty information, technical support, or service inquiries, please refer to the official DBIT website or contact their customer support channels. Keep your purchase receipt for warranty claims.

	<p>N300 Wireless Router User Manual</p> <p>User manual for the N300 Wireless Router, providing setup instructions, connection guides, and troubleshooting tips.</p>
<p>clarification</p> <p>If you encounter a situation where you cannot change the WiFi name and password, you can use the download link to download the firmware file, manually upgrade the firmware in the management interface, and then solve the problem after the upgrade is complete.</p> <p>Firmware file download address: http://dphdpcnsworld.com/download/AC1200FC_V2.0_138n</p> <p>Step 1</p> 	<p>DBIT AC1200 Firmware Upgrade Guide</p> <p>A guide on how to upgrade the firmware for the DBIT AC1200 Dual Band WiFi Router to resolve issues such as inability to change WiFi name and password.</p>
	<p>300 Mbps Wireless N Router User Manual and Quick Installation Guide</p> <p>User manual and quick installation guide for the Dbit 300 Mbps Wireless N Router, covering setup, FAQ, FCC compliance, and security warnings.</p>
	<p>DBIT X30 4G LTE Router User Manual</p> <p>User manual for the DBIT X30 4G LTE Router, providing setup instructions, product specifications, interface descriptions, indicator details, working environment guidelines, and factory reset procedures.</p>
	<p>WR-X30 AX3000 Dual Band Wi-Fi6 Router User Guide</p> <p>Comprehensive user guide for the WR-X30 AX3000 Dual Band Wi-Fi6 Router, covering setup, connections, troubleshooting, and regulatory information.</p>
	<p>DBIT 4G LTE Router User Manual and Configuration Guide</p> <p>Comprehensive guide to setting up and configuring the DBIT 4G LTE Router, including hardware overview, quick start instructions, and web interface details for wireless and network settings.</p>