

Manuals.plus /

› CAMAKT /

› CAMAKT USB Charger Camera HD 1080P Instruction Manual

## CAMAKT B0CGLM7L4P

# CAMAKT USB Charger Camera HD 1080P Instruction Manual

Model: B0CGLM7L4P

## INTRODUCTION

This manual provides detailed instructions for the setup, operation, and maintenance of your CAMAKT USB Charger Camera. This device combines a functional USB wall charger with a discreet 1080P HD Wi-Fi camera, designed for home security and surveillance. Please read this manual thoroughly before using the product to ensure proper functionality and safety.

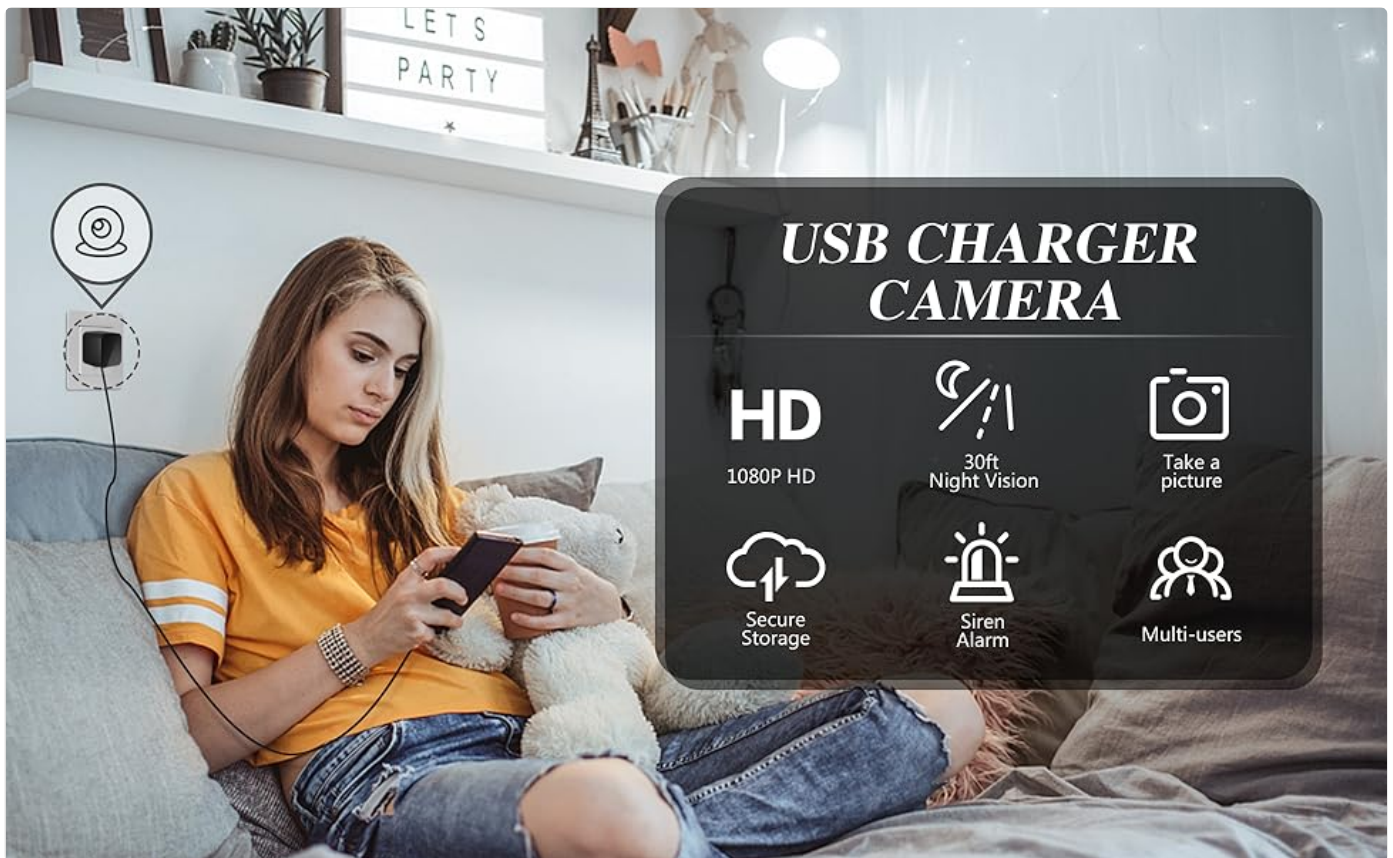

Image: The CAMAKT USB Charger Camera, highlighting its WiFi remote viewing feature and applications in home monitoring.

## PRODUCT OVERVIEW

The CAMAKT USB Charger Camera is a compact device that functions as a standard USB wall charger while discreetly housing a high-definition camera. It features 1080P video resolution, Wi-Fi connectivity for remote viewing, and motion detection capabilities. The device supports local storage via an SD card (up to 128GB, not included) and offers optional cloud storage.

# WIFI REMOTE VIEWING



Image: Front view of the CAMAKT USB Charger Camera, showcasing its compact design and integrated USB port.

## Components:

- USB Charger Camera Unit
- User Manual (this document)
- (Note: SD card is not included and must be purchased separately)

# PRODUCT DETAIL DRAWING



Image: Detailed diagram of the product, indicating the USB interface, camera lens, and SD card slot, along with approximate dimensions.

## SETUP INSTRUCTIONS

Follow these steps to set up your CAMAKT USB Charger Camera and connect it to your Wi-Fi network for remote viewing.

- 1. Insert SD Card (Optional):** Before plugging in, gently insert a compatible Micro SD card (up to 128GB, not included) into the SD card slot. Ensure it is inserted correctly until it clicks into place.
- 2. Connect to Power:** Plug the USB Charger Camera into a standard wall outlet. The device will power on automatically.
- 3. Download the App:** Scan the QR code provided in the packaging or search for "HDMini Camera" or "Tuya" in your smartphone's app store (Google Play Store for Android or Apple App Store for iOS) and download the application.
- 4. Register/Log In:** Open the app and follow the on-screen instructions to register a new account or log in if you already have one.
- 5. Reset the Camera:** Locate the reset button (often a small pinhole) on the device. Use a pin or a straightened paperclip to press and hold the reset button for approximately 5-10 seconds until the indicator light changes or flashes, indicating a reset. Release the button.
- 6. Add Device in App:** In the app, tap on "Add Device" or the "+" icon. Select the appropriate device type (e.g., "Smart

Camera" or "Security Camera").

7. **Select Wi-Fi Mode:** The app will prompt you to select a Wi-Fi connection mode. Choose "AP Mode" or "EZ Mode" as instructed by the app or the device's indicator light behavior. For AP Mode, you will connect your phone directly to the camera's Wi-Fi hotspot first, then configure it to connect to your home Wi-Fi. For EZ Mode, ensure your phone is connected to your 2.4GHz home Wi-Fi network.
8. **Connect to Wi-Fi:** Follow the app's instructions to enter your home Wi-Fi network name (SSID) and password. Ensure you are connecting to a 2.4GHz Wi-Fi network, as 5GHz networks are typically not supported.
9. **Connection Successful:** Once connected, the camera's indicator light will typically turn solid blue or green, and the app will confirm that the device has been added successfully. You can now access the live video feed.

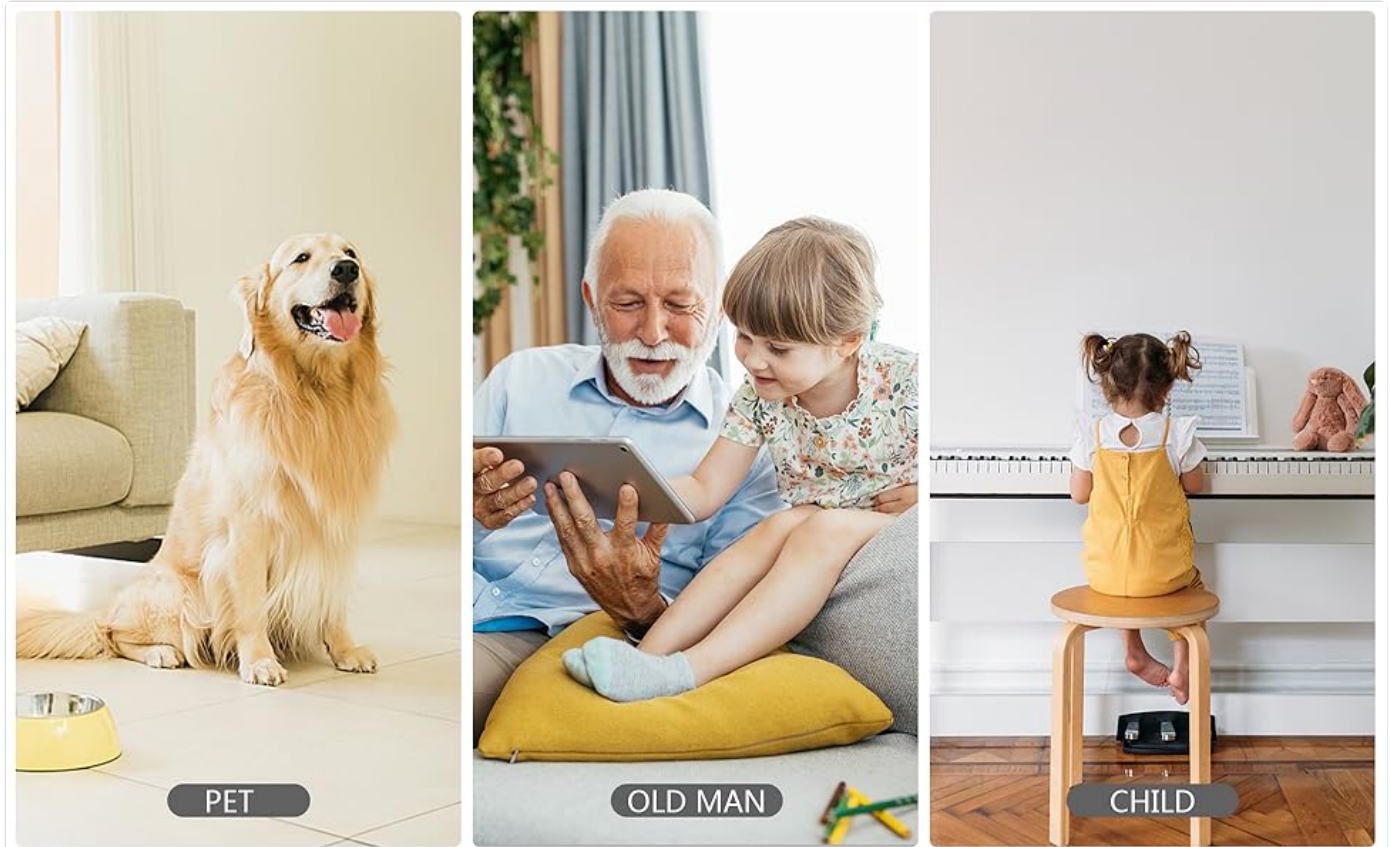

Image: Visual representation of the setup process, from plugging in the device to connecting it via the mobile application.

## OPERATING INSTRUCTIONS

---

### Remote Viewing:

Once the camera is connected to your Wi-Fi network, you can access live video feeds from anywhere using the "HDMini Camera" or "Tuya" app on your smartphone. Open the app, select your camera from the device list, and the live stream will begin.

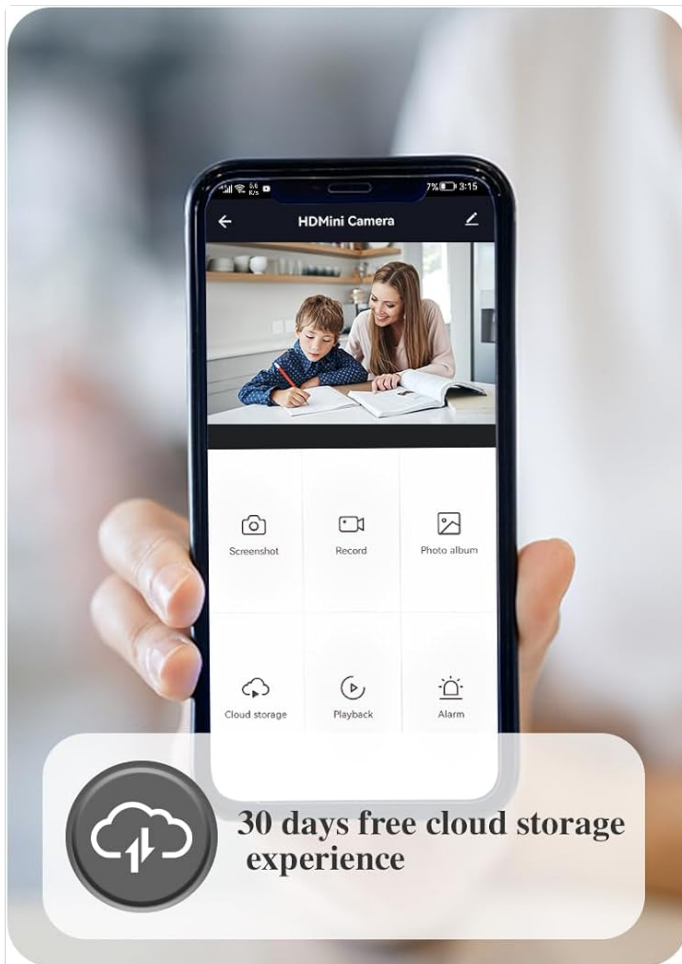

## *CLOUD OR SD CARD STORAGE*

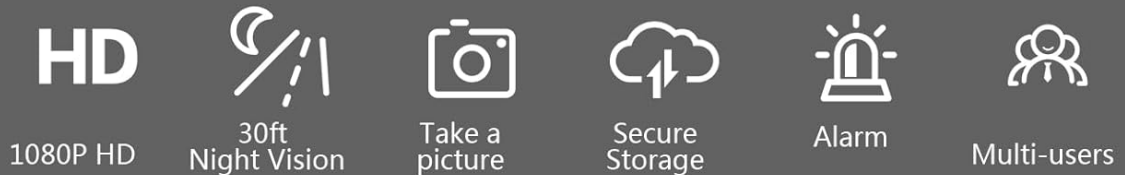

Image: The mobile application interface showing live video feed and options for storage.

### **Motion Detection:**

The camera features motion detection. When enabled, the camera will automatically begin recording when motion is detected and send alerts to your smartphone. You can configure motion detection sensitivity and alert settings within the app.

- **Enable/Disable:** Navigate to the camera settings in the app to turn motion detection on or off.
- **Sensitivity:** Adjust the sensitivity level to minimize false alarms.
- **Alerts:** Set up push notifications to receive instant alerts on your phone when motion is detected.

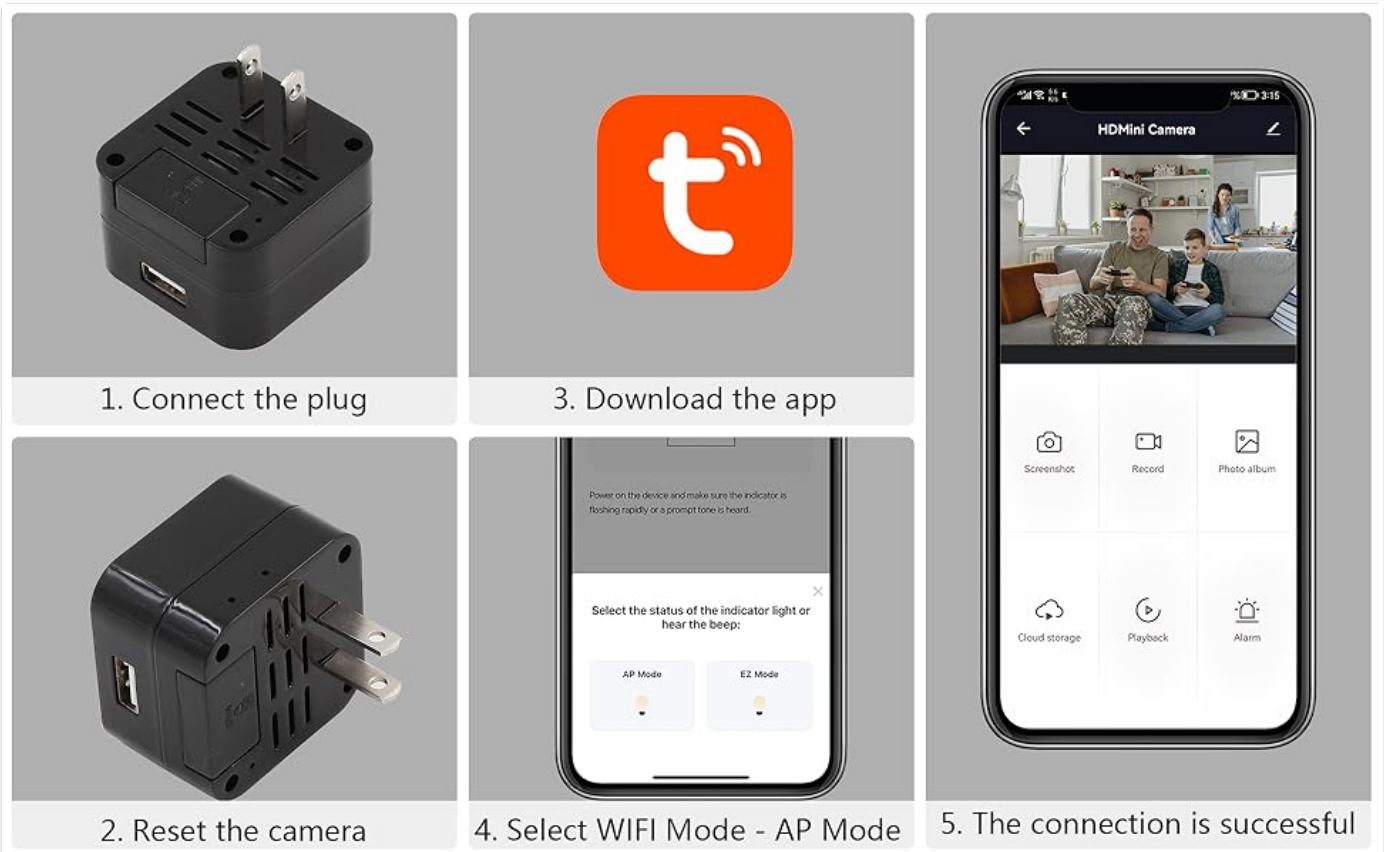

Image: The app's motion detection interface, illustrating its use in various monitoring situations.

### Video Recording and Storage:

The camera supports continuous recording or motion-activated recording. Footage can be stored on a Micro SD card or via cloud storage (subscription may be required).

- **SD Card Recording:** If an SD card is inserted, the camera will record video directly to it. You can view recorded footage through the app's playback function. The camera supports up to 128GB SD cards.
- **Cloud Storage:** The app may offer cloud storage options for secure, off-site storage of your recordings. Check the app for details on available plans.



Image: Overview of storage options and key camera features.

### USB Charging Function:

The device functions as a standard USB wall charger. You can plug in and charge your USB-powered devices while the camera is operating.



Image: The camera unit plugged into a wall outlet, demonstrating its USB charging capability for a smartphone.

## MAINTENANCE

---

- **Cleaning:** Use a soft, dry cloth to clean the camera lens and the device exterior. Do not use liquid cleaners or abrasive materials.
- **Placement:** Ensure the camera is plugged into a stable wall outlet and not easily dislodged.
- **Firmware Updates:** Periodically check the app for available firmware updates for your camera to ensure optimal performance and security.
- **SD Card Management:** If using an SD card, regularly back up important footage and format the card periodically to maintain performance.

## TROUBLESHOOTING

---

Problem	Possible Cause / Solution
<b>Camera not connecting to Wi-Fi / App connection issues</b>	<ul style="list-style-type: none"> <li>◦ Ensure your Wi-Fi network is 2.4GHz. The camera does not support 5GHz Wi-Fi.</li> <li>◦ Verify the Wi-Fi password is entered correctly in the app.</li> <li>◦ Make sure the camera is within range of your Wi-Fi router.</li> <li>◦ Try resetting the camera (press and hold the reset button for 5-10 seconds) and repeat the setup process.</li> <li>◦ If you changed your Wi-Fi password or ISP, you must reset the camera and reconfigure the Wi-Fi connection in the app.</li> <li>◦ Ensure your smartphone is connected to the same 2.4GHz Wi-Fi network during the initial setup.</li> </ul>
<b>No video feed / Offline status in app</b>	<ul style="list-style-type: none"> <li>◦ Check if the camera is properly plugged into a power outlet.</li> <li>◦ Verify your Wi-Fi connection is stable.</li> <li>◦ Restart the camera by unplugging and re-plugging it.</li> <li>◦ Check the app for any error messages or network status indicators.</li> </ul>
<b>Motion detection not working or too many false alarms</b>	<ul style="list-style-type: none"> <li>◦ Ensure motion detection is enabled in the app settings.</li> <li>◦ Adjust the motion detection sensitivity level in the app.</li> <li>◦ Check the camera's placement to avoid areas with constant, irrelevant motion (e.g., tree branches swaying outside a window).</li> </ul>
<b>SD card not recording or recognized</b>	<ul style="list-style-type: none"> <li>◦ Ensure the SD card is inserted correctly.</li> <li>◦ Check if the SD card is formatted to FAT32. You may need to format it via the app or on a computer.</li> <li>◦ Verify the SD card is not full.</li> <li>◦ Try using a different, compatible Micro SD card (up to 128GB).</li> </ul>

## SPECIFICATIONS

---

Feature	Detail
Video Capture Resolution	1080p
Connectivity Technology	Wireless (Wi-Fi)
Compatible Devices	Smartphone (Android, iOS)
Mounting Type	Wall Mount
Storage Support	Micro SD Card (up to 128GB, not included), Cloud Storage
Motion Detection	Yes, with alerts
Night Vision	30ft (as per A+ content)
Power Source	AC Wall Outlet (No internal battery)
Package Dimensions	3.54 x 3.54 x 2.32 inches
Item Weight	3.84 ounces
Indoor/Outdoor Usage	Indoor
Control Method	App
Video Capture Format	MPEG-4

## WARRANTY AND SUPPORT

---

CAMAKT is committed to providing professional and dedicated after-sales service. For any product issues, technical assistance, or warranty inquiries, please contact our customer support team. Refer to the product packaging or the CAMAKT official website for contact information.

We aim for rapid response and efficient resolution of all product-related concerns.