

SITISFI 7112

SITISFI Outdoor Emergency Light with Battery Backup - Model 7112 Instruction Manual

Model: 7112 | Brand: SITISFI

[Introduction](#) [Safety Information](#) [Product Components](#) [Setup](#) [Operating](#)
[Instructions](#) [Maintenance](#) [Troubleshooting](#) [Specifications](#) [Warranty](#) [Support](#)

1. INTRODUCTION

This manual provides detailed instructions for the installation, operation, and maintenance of your SITISFI Outdoor Emergency Light with Battery Backup, Model 7112. This fixture is designed to provide reliable emergency illumination in wet locations, ensuring safety during power outages.

The SITISFI emergency light is UL 924 certified, complying with United States fire inspection and International Fire Code standards. It features an injection-molded, flame-retardant, high-impact thermoplastic housing and an IP65 waterproof rating, making it suitable for various outdoor and wet environments.

2. IMPORTANT SAFETY INFORMATION

- **Read all instructions:** Before installation and use, carefully read and understand all instructions to prevent injury, electric shock, fire, or property damage.
- **Electrical Safety:** Installation must be performed by a qualified electrician in accordance with national and local electrical codes. Ensure power is disconnected at the circuit breaker before installation or servicing.
- **Grounding:** The fixture must be properly grounded to prevent electric shock.
- **Location:** This product is designed for wet locations. Ensure the mounting surface is flat to create a waterproof seal and prevent water leakage.
- **Battery:** The unit contains a rechargeable nickel-cadmium battery. Do not dispose of batteries in fire as they may explode. Follow local regulations for proper disposal.
- **Temperature:** Suitable for operating in environments between 32°F (0°C) and 104°F (40°C).
- **Maintenance:** Refer to the maintenance section for battery testing and replacement procedures.

3. PRODUCT COMPONENTS

The SITISFI Outdoor Emergency Light includes the following components:

- Emergency Light Fixture with two adjustable LED lamp heads
- Mounting Plate
- 3.6V 1000mAh Nickel-Cadmium Rechargeable Battery (pre-installed or included)
- Mounting Accessories (screws, wire nuts)
- Instruction Manual
- EVA foam for insulation (on the back of the light)
- Waterproof Test Button

Easy Installation



1
Loosen the screws on the housing



2
Using a screwdriver to remove mounting plate from fixture

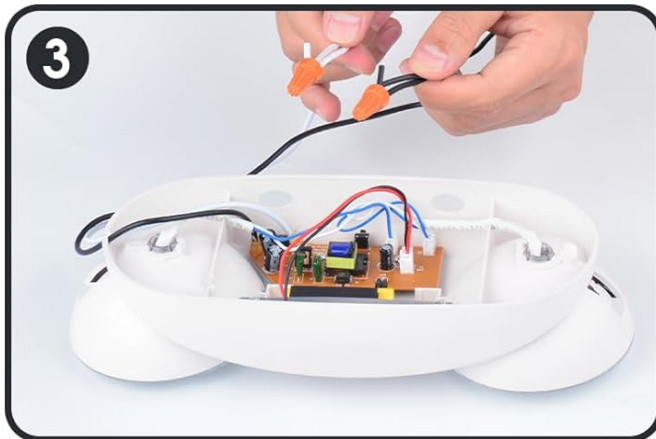

3
Connect wires with external power supply and battery terminal



4
Snap fixture onto mounting plate and ensure no wires are pinched

Figure 3.1: Internal components and features of the emergency light, including the anti-corrosion protected shield, waterproof sealing rubber strip, fire-resistant ABS housing, waterproof test button, and 3.6V rechargeable battery.

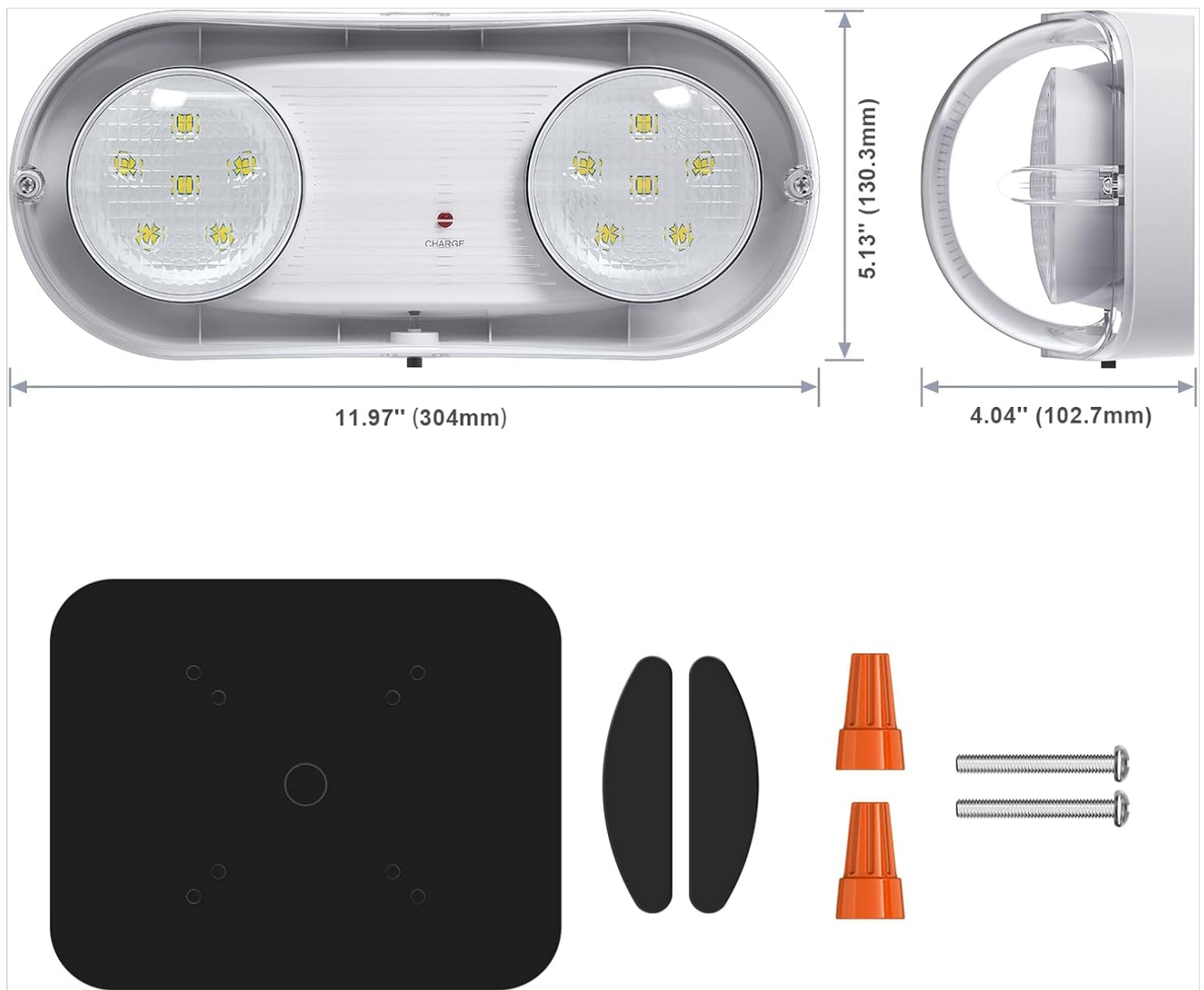

Figure 3.2: Dimensions of the emergency light (11.97" L x 4.04" W x 5.13" H) and included mounting accessories: mounting plate, EVA foam pads, wire nuts, and screws.

4. SETUP AND INSTALLATION

Before you begin: Ensure power is turned off at the circuit breaker. This fixture is designed for wall mounting with a universal J-box mounting pattern. A flat wall surface is required for a waterproof seal.

1. Prepare the Fixture:

- Loosen the screws on the housing to open the fixture.
- Using a screwdriver, remove the mounting plate from the fixture.

2. Mounting the Plate:

- Position the mounting plate on the desired wall location, aligning it with a standard J-box.
- Mark and drill appropriate holes if not using an existing J-box.
- Secure the mounting plate to the wall using the provided screws.

3. Electrical Connection:

- Connect the AC power wires (120-347V) from the building's electrical supply to the corresponding wires on the emergency light using the provided wire nuts. Ensure proper polarity (Live, Neutral, Ground).
- Connect the pre-installed 3.6V battery to the circuit board terminal. Ensure the connection is secure.

4. Assemble the Fixture:

- Carefully snap the main fixture body onto the mounted plate, ensuring no wires are pinched.
- Secure the housing with the previously loosened screws.
- Verify that the EVA foam on the back of the light is properly seated to prevent water leakage and insulate heat.

5. **Initial Charge:** After installation, restore power to the circuit. The unit will begin charging the battery. Allow a maximum of 24 hours for the battery to fully recharge before its first emergency operation.



Figure 4.1: Step-by-step installation guide for the emergency light, detailing how to open the housing, remove the mounting plate, connect electrical wires and the battery, and reassemble the unit.

Your browser does not support the video tag.

Video 4.1: Official SITISFI video demonstrating the installation process and features of the outdoor emergency light. This video shows the light automatically activating during a power outage, the process of opening the unit, connecting wires, and adjusting the lamp heads.

5. OPERATING INSTRUCTIONS

The SITISFI emergency light operates automatically once properly installed and charged.

- **Automatic Operation:** When AC power is present, the unit charges its battery and remains in standby mode. In the event of a power outage, the emergency light will automatically turn on, providing illumination for over 90 minutes.
- **Adjustable Lamp Heads:** The two LED lamp heads can be rotated 360 degrees horizontally and adjusted vertically to direct light where needed.
- **Test Button:** A waterproof test button is located on the fixture. Press and hold this button to simulate a power outage and verify that the emergency lights function correctly. Release the button to return to normal operation.

Wet Location Emergency Light

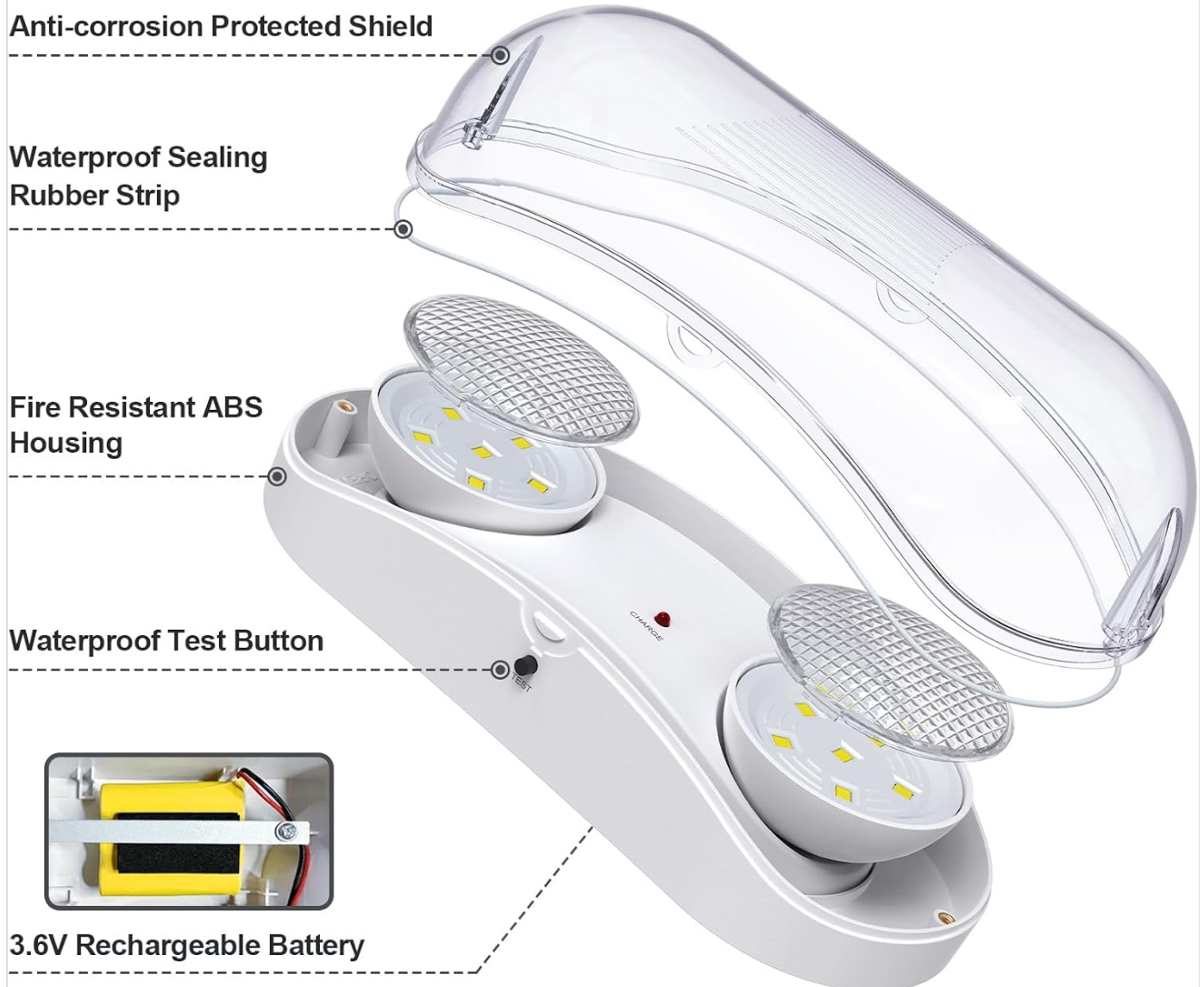

Figure 5.1: The emergency light features two adjustable lamp heads that can rotate 360 degrees to direct light as required.

Easy Installation



1
Loosen the screws on the housing



2
Using a screwdriver to remove mounting plate from fixture

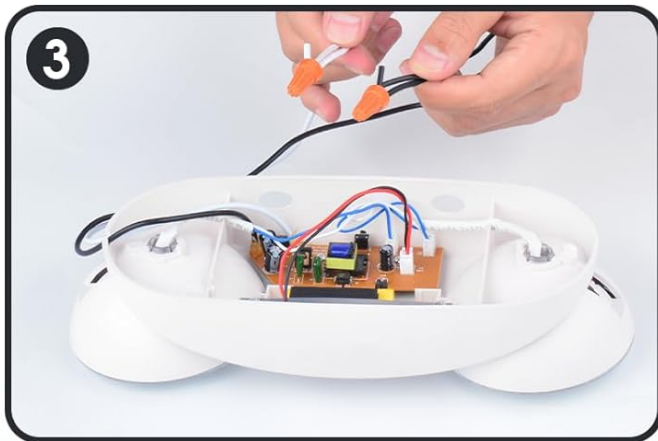

3
Connect wires with external power supply and battery terminal



4
Snap fixture onto mounting plate and ensure no wires are pinched

Figure 5.2: Location of the waterproof test button on the emergency light fixture. Pressing this button activates the lights to confirm functionality.

6. MAINTENANCE

Regular maintenance ensures the reliable operation of your emergency light.

- **Monthly Test:** Press the test button for at least 30 seconds. The emergency lights should illuminate. If they do not, check the AC power supply and battery connection.
- **Annual Test:** Disconnect AC power to the unit for 90 minutes. The emergency lights should remain illuminated for the entire duration. If the lights dim or turn off before 90 minutes, the battery may need replacement.
- **Cleaning:** Clean the exterior of the fixture with a soft, damp cloth. Do not use abrasive cleaners or solvents.
- **Battery Replacement:** The nickel-cadmium battery has a lifespan of approximately 600 recharge cycles. If the unit fails the annual test, the battery may need to be replaced. Contact SITISFI support for replacement battery information. Ensure power is disconnected before replacing the battery.

7. TROUBLESHOOTING

Problem	Possible Cause	Solution
Lights do not turn on during power outage or when test button is pressed.	<p>No AC power to the unit.</p> <p>Battery not connected or faulty.</p> <p>Battery not fully charged.</p> <p>Faulty LED lamp heads.</p>	<p>Check circuit breaker and wiring connections.</p> <p>Ensure battery is properly connected. Allow 24 hours for initial charge.</p> <p>Replace battery if it fails to hold a charge after prolonged use.</p> <p>Contact support if LED heads are faulty.</p>
Lights dim or turn off before 90 minutes during emergency operation.	<p>Battery not fully charged.</p> <p>Battery nearing end of life.</p>	<p>Ensure unit has been connected to AC power for at least 24 hours.</p> <p>Replace the battery.</p>
Charging indicator light (red LED) is off.	<p>No AC power to the unit.</p> <p>Charging circuit fault.</p>	<p>Check AC power supply and wiring.</p> <p>Contact support.</p>

8. SPECIFICATIONS

Feature	Detail
Model Number	7112
Brand	SITISFI
Input Voltage	120-347V AC
Wattage	2 watts
Light Source	LED (2 adjustable heads)
Brightness	800 Lumens
Battery Type	3.6V 1000mAh Nickel-Cadmium (Ni-Cd)
Emergency Operation Time	> 90 minutes
Recharge Time	Max 24 hours
Housing Material	UL injection-molded, flame-retardant, high-impact thermoplastic
IP Rating	IP65 (Waterproof)
Operating Temperature	32°F - 104°F (0°C - 40°C)
Dimensions (L x W x H)	11.97" x 4.04" x 5.13" (304mm x 102.7mm x 130.3mm)
Weight	1.1 Pounds
Certifications	UL Listed (UL 924)

Feature	Detail
Mounting Type	Wall Mount

9. WARRANTY INFORMATION

The SITISFI Outdoor Emergency Light, Model 7112, comes with a **5-year limited warranty** from the date of purchase. This warranty covers defects in materials and workmanship under normal use and service.

The warranty does not cover damage resulting from improper installation, misuse, abuse, neglect, accident, unauthorized repair or modification, or acts of nature. The battery is considered a consumable item and may have a separate warranty period or expected lifespan.

For warranty claims or further details, please contact SITISFI customer support.

10. CUSTOMER SUPPORT

If you have any questions, require technical assistance, or need to report an issue with your SITISFI emergency light, please contact our customer support team.

SITISFI Customer Service:

- **Website:** [Visit the SITISFI Store on Amazon](#)
- **Email/Phone:** Refer to the product packaging or the SITISFI store page for the most current contact information.

Please have your model number (7112) and purchase date available when contacting support.

