

[Manuals.plus](#) /

> [CHEREKI](#) /

> [CHEREKI Digital Alarm Clock Model 06-5081 User Manual](#)

CHEREKI 06-5081

CHEREKI Digital Alarm Clock Model 06-5081 User Manual

Your guide to setting up and operating your new CHEREKI Digital Alarm Clock.

INTRODUCTION

Thank you for choosing the CHEREKI Digital Alarm Clock. This manual provides detailed instructions for the proper use and maintenance of your device. Please read it carefully before use and retain it for future reference.

PACKAGE CONTENTS

Ensure all items are present in the package:

- CHEREKI Digital Alarm Clock
- USB Power Cable
- AC Adapter
- CR2032 Backup Battery (pre-installed or included separately)
- User Manual
- Detachable Stand

Snooze Function & Dual Alarms

Press the snooze button to get extra 5 mins sleep,
Independent switch to easily set different alarm plans



Image: The CHEREEKI Digital Alarm Clock, USB power cable, AC adapter, and user manual are shown neatly arranged, indicating the package contents.

SETUP

1. Power Connection

This alarm clock operates via mains power. Connect the provided USB power cable to the clock's input port (INPUT 5V 1A) and then connect the AC adapter to a standard wall outlet. The clock requires continuous power to function. The included CR2032 battery is for memory backup only, retaining time and alarm settings during power interruptions.



Image: The alarm clock is shown connected to a wall outlet via its power adapter. An inset highlights the CR2032 battery compartment, emphasizing its role for memory backup.

2. Battery Installation (Memory Function)

Locate the battery compartment on the back of the clock. Carefully open the compartment cover. Insert the CR2032 button cell battery with the positive (+) side facing up. Close the cover securely. This battery ensures that your time and alarm settings are preserved if the main power is disconnected.

Caution: The battery compartment cover can be stiff. Exercise caution when opening to avoid damage.

3. Positioning the Clock

The clock can be placed on a tabletop using its detachable stand or mounted on a wall. Ensure the clock is placed on a stable surface or securely mounted.

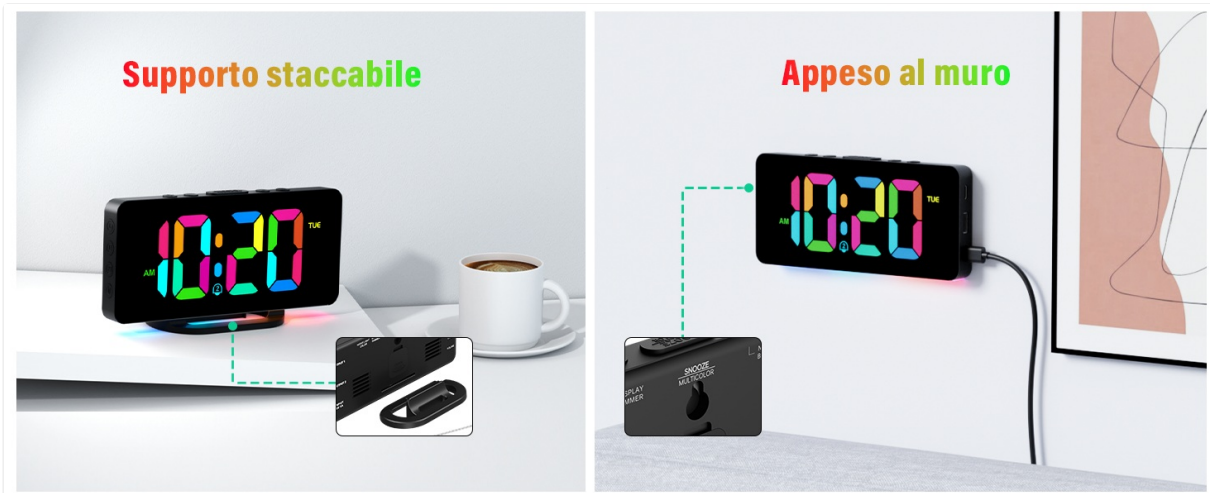

Image: The alarm clock is displayed in two configurations: resting on its detachable stand on a desk, and mounted on a wall, demonstrating its versatile placement options.

OPERATING INSTRUCTIONS

The CHEREEKI Digital Alarm Clock features conveniently located buttons on the top and sides for easy operation.



Image: A close-up view of the alarm clock highlights the buttons located on its top and side panels, indicating their accessibility for user interaction.

1. Setting the Time

Refer to the user manual for specific button functions to set the current time. The clock supports both 12-hour and 24-hour formats. Press the designated button (often labeled 'TIME' or 'SET') to enter time setting mode, then use the '+' and '-' buttons to adjust hours and minutes. Press the 'SET' button again to confirm.



Image: The alarm clock displays time in both 12-hour and 24-hour formats, illustrating the option to switch between them.

2. Adjusting Display Brightness

The 7-inch LED display offers 6 levels of brightness, from very bright to very dim. Use the dedicated brightness control buttons (often '+' and '-' or a specific 'DIMMER' button) to adjust the display intensity to your preference.



Image: The alarm clock's display is shown at six different brightness levels, from high to off, demonstrating the adjustable intensity.

3. Changing Display Colors

The clock features 11 digital color options for the time display, including fixed colors and dynamic variations. Use the 'COLOR' button or similar control to cycle through the available color modes.

11 Color Modes Time Display



Image: A visual representation of the alarm clock's display showing 11 distinct color modes for the time, including static and dynamic options.

4. Setting Alarms and Snooze Function

The clock supports dual alarms. Press the 'ALARM 1' or 'ALARM 2' button to set individual alarm times. You can program alarms for weekdays, weekends, or every day. When an alarm sounds, press the 'SNOOZE' button to get an additional 5 minutes of sleep. The alarm will sound again after the snooze period.

Snooze Function & Dual Alarms

Press the snooze button to get extra 5 mins sleep,
Independent switch to easily set different alarm plans



Image: The alarm clock displays two separate alarm settings, 8:30 AM and 9:30 PM, with the snooze button clearly visible on top. This illustrates the dual alarm and snooze features.



Image: The alarm clock demonstrates its dual alarm function with different schedules: one for Monday to Friday, one for Saturday to Sunday, and one for Monday to Sunday, allowing flexible alarm programming.

5. Adjusting Alarm Volume

The alarm volume can be adjusted to 3 different levels. Use the volume control buttons to select your

preferred alarm sound intensity.

6. Using the RGB Night Light

The bottom night light offers 10 different color modes, including 7 fixed colors and 3 dynamic variations. You can also adjust the brightness of the night light. Use the 'LIGHT' or 'RGB' button to cycle through colors and the '+' and '-' buttons to adjust brightness.



Image: The alarm clock is depicted with its base illuminated in 10 different color modes, showcasing the variety of night light options available.

5 livelli di luminosità della luce notturna regolabile

Premere il pulsante "+" o "-" per impostare la luminosità della luce inferiore

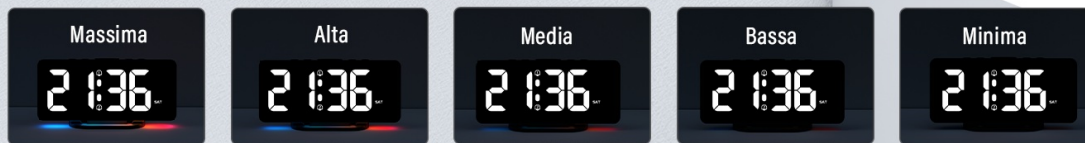

Image: The alarm clock's night light is shown at five different brightness levels, from maximum to minimum, demonstrating its adjustable intensity.

7. Charging External Devices

The alarm clock is equipped with two output ports (USB and Type-C) for charging electronic devices. Connect your device's charging cable to the appropriate port on the clock.

Dual Output Ports

Ultra-slim body enables simultaneous charging for two devices



Image: A close-up of the alarm clock's side reveals two output ports, labeled 'OUTPUT 1' (USB) and 'OUTPUT 2' (Type-

C), indicating their function for charging external devices.

MAINTENANCE

To ensure the longevity and optimal performance of your CHEREEKI Digital Alarm Clock, follow these simple maintenance guidelines:

- **Cleaning:** Wipe the clock with a soft, dry cloth. Do not use abrasive cleaners or solvents, as they may damage the surface.
- **Power:** Always use the provided AC adapter and USB cable. Avoid using unapproved power sources.
- **Environment:** Keep the clock away from direct sunlight, extreme temperatures, and high humidity.
- **Battery:** Replace the CR2032 backup battery annually or if you notice settings are not retained during power outages.

TROUBLESHOOTING

Problem	Possible Cause	Solution
Clock display is off or not functioning.	Not connected to mains power; power outage.	Ensure the AC adapter is securely plugged into a working outlet and the USB cable is connected to the clock. The clock requires continuous mains power to operate.
Time or alarm settings are lost after power disconnection.	CR2032 backup battery is dead or not installed.	Check and replace the CR2032 backup battery. Ensure it is installed correctly with the positive (+) side up.
Display brightness is too high at night.	Brightness level is set too high.	Adjust the display brightness to a lower setting using the dedicated brightness control buttons. The clock offers 6 levels, including off.
Night light brightness is too high.	Night light brightness level is set too high.	Adjust the night light brightness to a lower setting using the '+' and '-' buttons when in night light mode. The clock offers 5 levels.
Clock time drifts (runs fast or slow).	Minor internal timing inaccuracy.	Periodic time adjustment may be necessary. Reset the time as needed.
Unable to open battery compartment.	Stiff cover mechanism.	Apply gentle, even pressure. Avoid excessive force to prevent damage to the cover tabs.

SPECIFICATIONS

Brand	CHEREKI
Model Number	06-5081
Color (This Variant)	Black

Display Type	Digital LED
Special Features	USB & Type-C Charging Ports, RGB Night Light, Dual Alarm with Snooze
Product Dimensions	15L x 83H mm
Power Source	Mains Powered (AC Adapter included)
Backup Battery	1 x CR2032 (included, for memory function)
Material	Plastic
Weight	250 Grams
Connectivity Technology	USB, Type-C
Indoor/Outdoor Use	Indoor

WARRANTY INFORMATION

The CHEREEKI Digital Alarm Clock comes with a **Lifetime Warranty**. For details regarding warranty claims or service, please contact our customer support.

CUSTOMER SUPPORT

If you have any questions, concerns, or require assistance with your CHEREEKI Digital Alarm Clock, please do not hesitate to contact our customer support team:

Email: support@chereeki.com

Our team is available to help you with setup, troubleshooting, and any other product-related inquiries.