

Saneen S05



Saneen 4K 64MP Digital Camera User Manual

Model: S05

INTRODUCTION

Thank you for choosing the Saneen 4K 64MP Digital Camera. This camera is designed for photography and video enthusiasts, offering high-resolution imaging, versatile features, and user-friendly operation. This manual provides detailed instructions to help you get started and make the most of your new camera.



Image: The Saneen 4K 64MP Digital Camera shown with its included accessories, including a camera bag, battery, SD card, and lens hood.

Saneen 4K & 64MP Digital Camera

video

4k60fps / 2.7k30fps / 1080p60fps / 720p60fps

photo

64mp / 48mp / 24mp / 8mp



Image: An illustration highlighting the camera's video resolutions (4K 60fps, 2.7K 30fps, 1080P 60fps, 720P 60fps) and photo resolutions (64MP, 48MP, 24MP, 8MP).

WHAT'S IN THE BOX

Please check the package contents to ensure all items are present:

- Saneen 4K 64MP Digital Camera x 1
- 3000mAH Lithium Battery x 1
- USB Cable x 1
- User Manual x 1
- 32GB SD Card x 1
- Lanyard x 1
- Lens Hood x 1
- Camera Bag x 1



Instructions



Charger



Type C cable



Lanyard



Lens Hood



Camera Bag



32GB Card



batteries



Camera

Image: A visual representation of all items included in the camera package, such as the camera, lens hood, instructions, 32GB card, Type C cable, lanyard, camera bag, charger, and batteries.

SETUP

1. Battery Installation

Insert the 3000mAh Lithium Battery into the battery compartment at the bottom of the camera. Ensure the battery is inserted in the correct direction as indicated by the diagram. The battery cannot be charged if it is reversed.

2. SD Card Installation

Insert the 32GB SD card into the designated slot next to the battery compartment. Ensure the card is oriented correctly until it clicks into place.

3. Charging the Battery

Connect the camera to a power source using the provided USB cable. The charging indicator will illuminate. A full charge typically takes 2-3 hours.

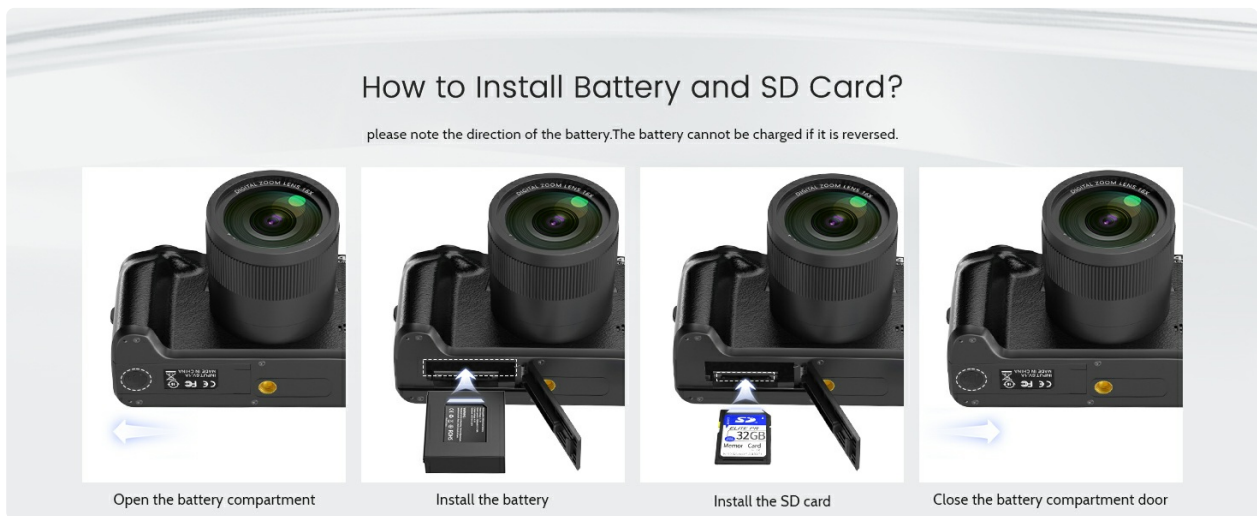

Image: A step-by-step visual guide demonstrating how to open the battery compartment, install the battery, install the SD card, and close the compartment door.



Image: An illustration emphasizing the long battery life provided by the 3000mAH rechargeable batteries, set against a scenic waterfall backdrop.

OPERATING INSTRUCTIONS

Camera Controls Overview



Image: A detailed diagram labeling the various buttons and interfaces on the Saneen digital camera, including the flash pop-up button, power button, photo button, exposure setting, hot shoe interface, photo and video modes, front camera, front and rear camera switch button, flash button, WiFi button, delete button, setting button, menu button, and playback button.

Photo and Video Modes

Use the mode dial on the top of the camera to switch between photo and video recording modes. The 4.0-inch touch screen allows for intuitive navigation and setting adjustments.

WiFi Connection

The camera features built-in Wi-Fi for easy sharing. Scan the QR code in the manual to download the corresponding APP (IDC CAM). Turn on Wi-Fi on your smartphone and connect to the camera's Wi-Fi network (Name: 4K_WIFI, Password: 12345678). This allows instant sharing of photos and videos to your mobile device.

WiFi Connection & Touch Screen

Built-in wireless connectivity including Wi-Fi allows for on-the-go convenience when you want to share your photos and videos with friends and family.

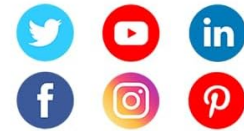

Image: Demonstrates the camera's Wi-Fi connectivity and touch screen functionality, showing a user interacting with the touch screen and social media icons for sharing.

Built in Wifi- Easy to Share Your Happiness

1. Scan the code to download the corresponding APP-IDC CAM.
2. Just turn on your smartphone and connect it to Wi-Fi.
3. Wifi name: 4K-WIFI password: 12345678



Image: Illustrates the process of connecting the camera to a smartphone via Wi-Fi using the IDC CAM app for easy photo and video sharing.

Webcam Function

Connect the camera to your PC using the USB cable. Select "PC camera" mode on the camera's screen to use it as a webcam for video calls and live streaming.

HDMI Output

The camera supports TV output. Connect the camera to a TV using a mini HDMI cable (not included) to view your photos and videos on a larger screen.

Webcam Function

Connect to computer via USB cable and select the "PC camera" mode for video calls and live streaming.

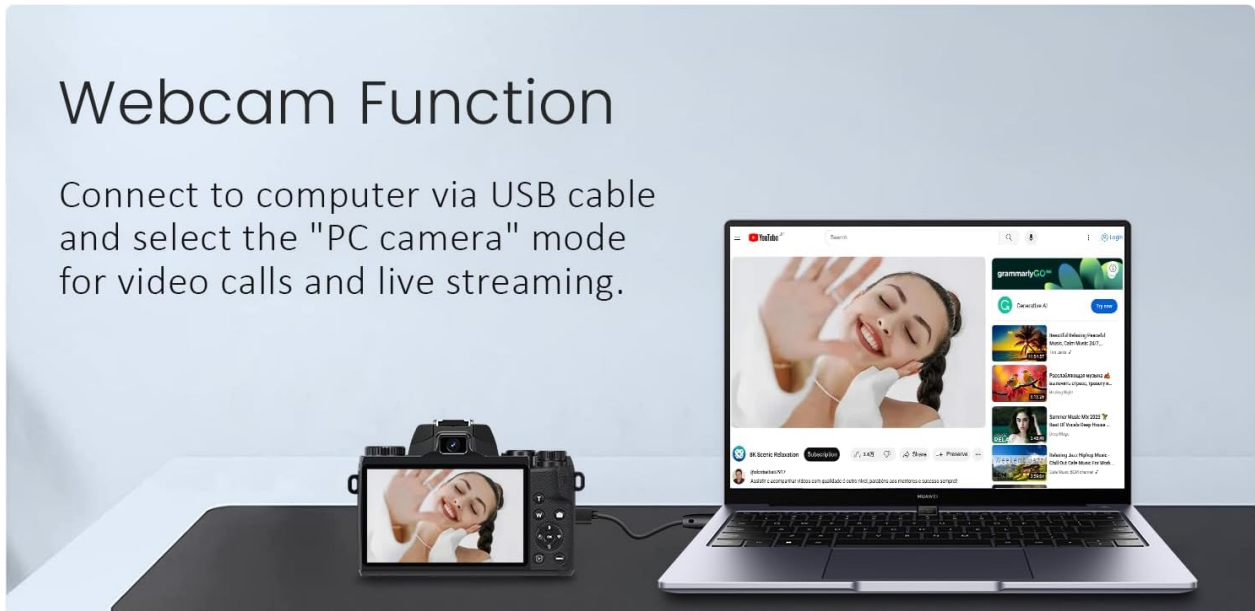

HDMI TV Output

You can watch the camera files on TV via HDMI cable(not include), any mini HDMI cable will work with this camera.

Image: Two panels showing the camera's webcam function when connected to a laptop and its HDMI TV output capability when connected to a television.

Front camera makes it easier to live streaming and video call



HDMI Output



Image: Depicts the camera being used as a webcam for live streaming on a laptop and connected to a TV for HDMI output, showcasing its versatility.

Flash Usage

The camera has a built-in flash. Press the flash pop-up button to activate it. The flash helps illuminate subjects in low-light conditions, ensuring clear images.

Flash & Hotshoe



Standard hot shoe



Flash pop-up button



Image: Compares a scene without flash (darker) and with flash (brighter), demonstrating the effectiveness of the built-in flash. Also shows the standard hot shoe and flash pop-up button.

Built-in Flash

Fill light makes sure pictures stay high quality even in the dark.



Image: Illustrates the effect of the built-in flash, showing a scene before and after using the flash to improve lighting and image quality.

Dual-Lens / Selfie Camera

Equipped with dual lenses, the camera allows for easy switching between front and rear cameras. This is particularly useful for vlogging and taking selfies, as you can see what you are recording or framing.

Selfie Camera – Dual Lens to Take Selfie



Quickly switch front and rear cameras



Image: A person holding the camera and taking a selfie, demonstrating the quick switch between front and rear cameras for self-portraits and vlogging.

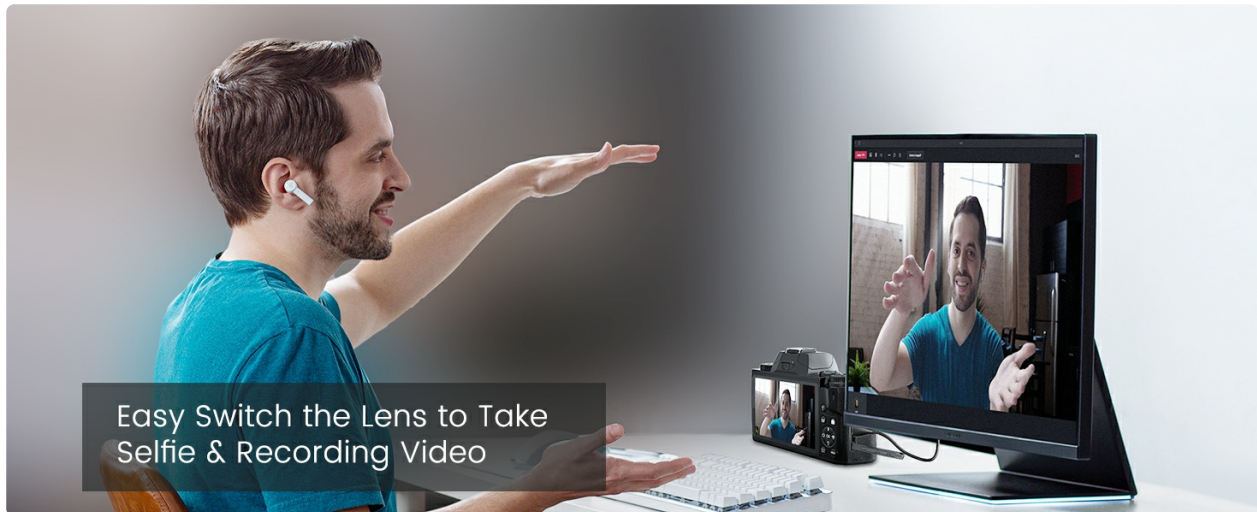

Easy Switch the Lens to Take Selfie & Recording Video

Image: Shows a person using the camera for a video call, highlighting the ease of switching lenses for selfies and video recording.

16X Digital Zoom

This camera features 16X digital zoom. Digital zoom works by cropping and digitally enlarging the center of the image, stretching existing pixels. This can result in blurred images with reduced sharpness, especially at higher zoom levels. For optimal quality, it is recommended to move closer to your subject rather than relying solely on digital zoom.



Image: A visual comparison demonstrating the effect of 2X, 4X, 8X, and 16X digital zoom on an image, illustrating that while the image is enlarged, the picture quality becomes blurry at higher magnifications.

Autofocus Function and Lens Hood

Gently press the camera button to focus. The camera supports autofocus for clear images. The included lens hood helps to prevent lens flare and protect the lens from accidental damage.

Autofocus Function and Hood

Gently press the camera button to focus

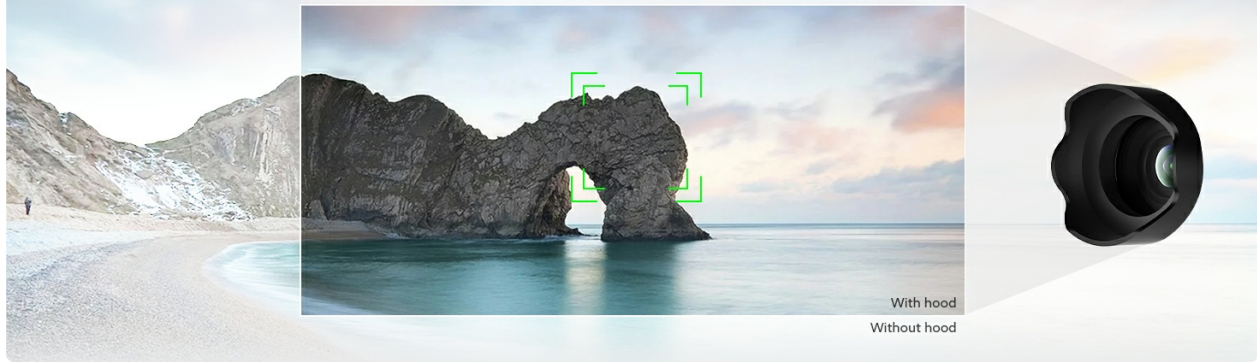

Image: Shows the camera's autofocus in action with a green focus box, and a comparison of a scene with and without the lens hood.

Filters and Exposure Compensation

Explore various creative filters (Gray, Negative, Antique, Red, Green, Blue) to enhance your photos. Adjust exposure compensation from -3 to +3 to control the brightness of your images.



Image: Displays six different filter effects (Gray, Negative, Antique, Red, Green, Blue) applied to a portrait, and a scale illustrating seven levels of exposure compensation.

Pause Function

The camera features an excellent PAUSE FUNCTION, allowing you to temporarily stop recording and then resume in the same file without creating a new one. This is useful for continuous recording of events with breaks.

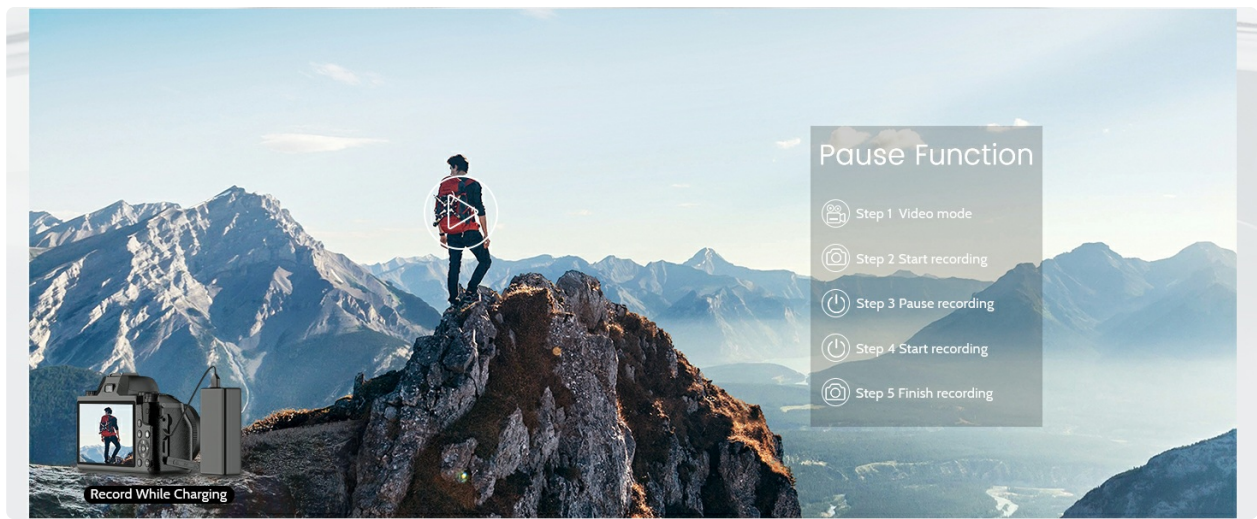

Image: A step-by-step guide for using the pause function during video recording: 1. Video mode, 2. Start recording, 3. Pause recording, 4. Start recording, 5. Finish recording. Also shows the camera recording while charging.

Time-lapse Recording

The time-lapse recording feature enables you to capture and observe slow-changing phenomena, such as blooming flowers, sunsets, or sunrises, compressed into a short video.

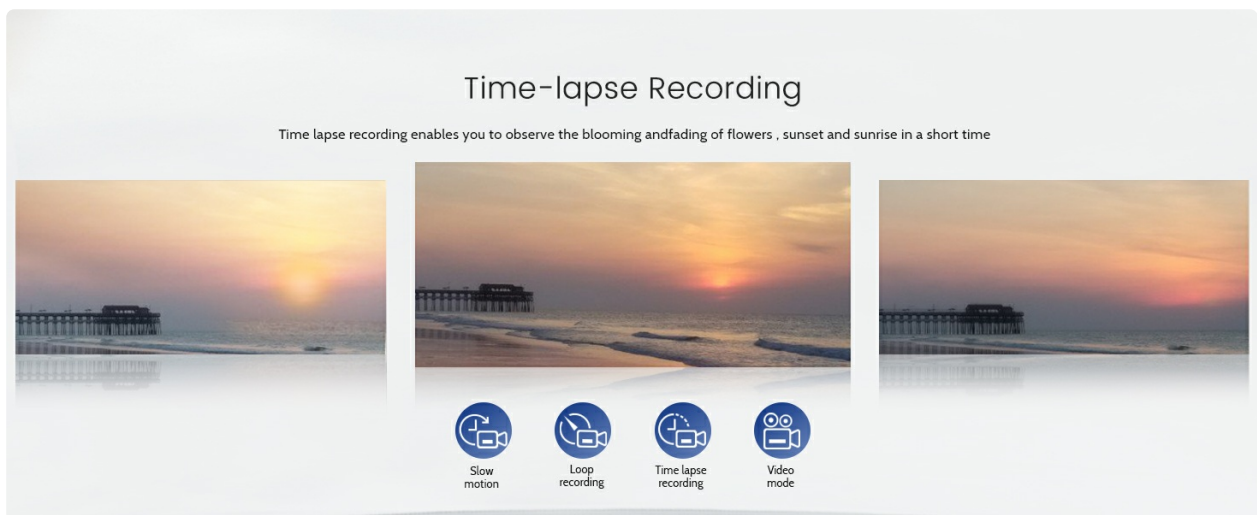

Image: Illustrates the concept of time-lapse recording with three sequential images of a sunset over water, along with icons for slow motion, loop recording, time-lapse recording, and video mode.

Continuous Shooting

The camera supports continuous shooting modes (3P, 5P, 5S) for capturing a sequence of images rapidly. This is ideal for action shots or capturing subtle movements.



Image: Displays various shooting modes including continuous shooting, time-lapse, loop photography, and photo mode, with examples of different photo styles.

Transferring Files to Computer

Connect your camera to a computer using the USB cable. On the camera screen, select "Mass Storage Mode". Your computer will then recognize the camera as a removable drive, allowing you to transfer photos and videos.

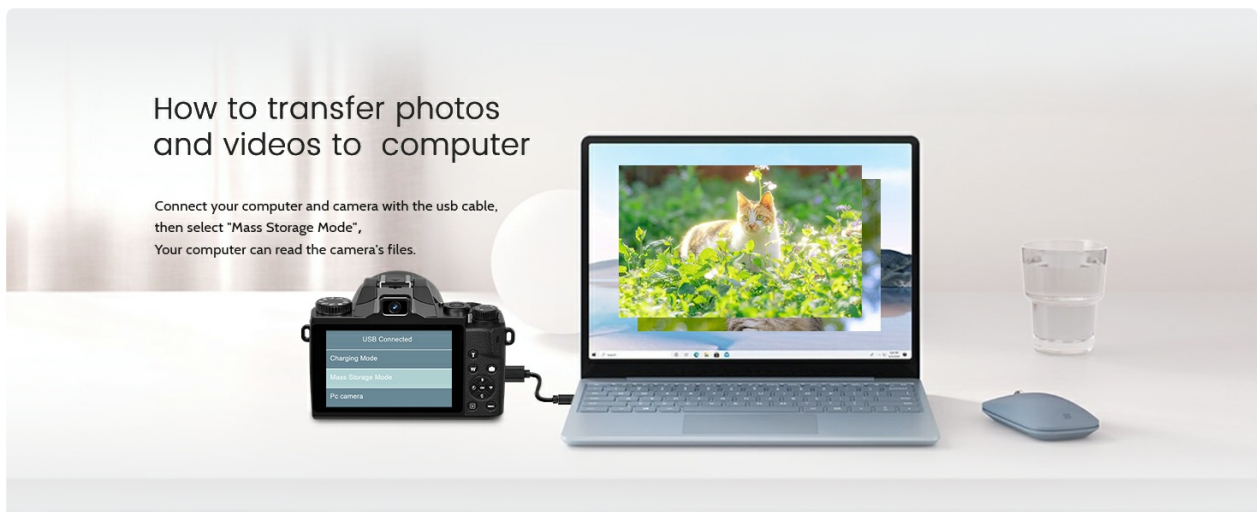

Image: Illustrates connecting the camera to a laptop via USB cable and selecting "Mass Storage Mode" on the camera's screen to access files on the computer.

MAINTENANCE

To ensure the longevity and optimal performance of your Saneen Digital Camera, please follow these maintenance guidelines:

- Keep the camera clean: Use a soft, dry cloth to wipe the camera body. For the lens, use a specialized lens cleaning cloth and solution.
- Protect from dust and moisture: Store the camera in its bag when not in use, especially in dusty or humid environments.
- Handle with care: Avoid dropping the camera or subjecting it to strong impacts.
- Battery care: Remove the battery if the camera will not be used for an extended period. Store batteries in

a cool, dry place.

TROUBLESHOOTING

External Microphone Considerations

If you plan to use an external microphone with your Saneen camera, please note the following critical points:

1. **External Microphone Power Supply:** The external microphone requires its own power supply. The camera cannot power the microphone. If the microphone is not powered, the camera will show the microphone logo but will not record audio from it.
2. **Microphone Connector Type:** The external microphone must be a dual-channel microphone with a 3.5mm connector.

External Microphone

Standard Hot Shoe Interface

There are 2 very important points about external microphones that need attention:

1. The external microphone needs its own power supply, the camera cannot power the microphone.

If the microphone is not powered, the microphone plugged into the camera will show the microphone logo but will not work.

2. The external microphone must be a dual-channel microphone with a 3.5mm connector.



Image: A visual representation of the camera with an external microphone attached to the standard hot shoe interface, emphasizing the two critical points regarding external microphone power and connector type.

General Troubleshooting Tips

- **Camera not turning on:** Ensure the battery is fully charged and correctly inserted.
- **Images are blurry:** Check focus settings. Ensure sufficient lighting. Avoid excessive digital zoom.
- **SD card error:** Ensure the SD card is properly inserted. Try formatting the card (this will erase all data). Use a Class 10 or higher SD card.
- **Wi-Fi connection issues:** Double-check the Wi-Fi name and password. Ensure the IDC CAM app is installed correctly on your mobile device.

SPECIFICATIONS

Feature	Detail
Lens	Dual camera, Fixed lens F/2.4, f=5.04mm
Digital Zoom	16x
WiFi	Support (Name: 4K_WIFI, Password: 12345678)
External MIC	Support (3.5mm dual-channel, self-powered)
Display Screen	4.0-inch ultra HD screen (4:3) Touch screen
Fill Light	<1.0m Range
HDMI Interface	HDMI output interface
Exposure	-3.0EV ~ +3.0EV
Timed Shooting (Self-timer)	2/5/10/15/30S (3/10/15/20/30S)
Image Sensor	CMOS sensor
White Balance	Auto / sunny / cloudy / incandescent / fluorescent
Video/Photo Format	MP4/JPG
Filter	ordinary/black and white/Negative film/nostalgia/red/green/blue
Continuous Shooting	3P, 5P, 5S
Storage	SD card up to 256GB / Class 10 (includes 32GB SD card only)
Auto Power Off	ON/OFF 3/5/10 Min
Photo Resolution	64MP, 56MP, 48MP, 30MP, 24MP, 20MP, 12MP, 8MP, 5MP, 3MP
USB Interface	USB2.0 (high speed)
Photo Sensibility	Auto/ISO100/ISO200/ISO400/ISO800/ ISO1600/ISO3200/ISO6400
AF	Support (Normal auto focus Range of >10cm)
Battery	One SX-90 / 3000mAH lithium-ion battery (2-3H, 4-5H Charging time)
Language	English (default), Spanish, Portuguese, Russian, simplified Chinese, Traditional Chinese, German, Italian, French, Japanese, Korean, Thai

Video Resolution	4K_3840X2160(60FPS/30FPS), 2.7K_2688X1520(30FPS), 1080P_1920X1080(60FPS/30FPS), 720P_1280X720 (120FPS/60FPS/30FPS)
------------------	--

Lens: Dual camera	Digital zoom: 16x
Wifi: Support(Name:4K_WIFI,Password:12345678)	External MIC: Support
Display screen: 4.0-inch ultra HD screen(4:3)Touch screen	Fill Light: <1.0m Range
High-Definition Multimedia Interface: HDMI output interface	Exposure: -3.0EV~+3.0EV
Timed shooting(Self-timer): 2/5/10/15/30S (3/10/15/20/30S)	Image Sensor: CMOS sensor
White balance: Auto / sunny / cloudy / incandescent / fluorescent	Video/Photo Format: MP4/JPG
Filter: ordinary/black and white/Negative film/nostalgia/red/green/blue	Lens: Fixed lens F/2.4,f=5.04mm
Storage: SD card up to 256GB / Class10 (Includes 32G SD card only)	Continuous shootingP: 3P/S,5P/S
Photo Resolution: 64MP,56MP,48MP, 30MP, 24MP, 20MP,12MP, 8MP, 5MP, 3MP	Auto Power Off: ON/OFF 3/5/10 Min
Photo sensibility: Auto/IOS100/ISO200/ISO400/ISO800/ ISO1600/ISO3200/ISO6400	USB Interface: USB2.0(high speed)
Battery: One SX-90 / 3000mAh lithium-ion batteries can work 2- 3H, 4-5H Charging time	AF: Support(Normal auto focus Range of >10cm)
Video Resolution: 4K_3840X2160(60FPS/30FPS), 2.7K_2688X1520(30FPS), 1080P_1920X1080(60FPS/30FPS), 720P_1280x720 (120FPS/60FPS/30FPS)	
Language: English (default), Spanish, Portuguese, Russian, simplified Chinese, traditional Chinese, German, Italian, French, Japanese, Korean, Thai	

Image: A comprehensive table detailing the technical specifications of the Saneen digital camera, including lens type, digital zoom, WiFi, external MIC support, display, HDMI, timed shooting, image sensor, video/photo format, filters, storage, photo resolution, USB interface, battery, and video resolutions.

Physical Dimensions

- Product Dimensions: 5.63 x 3.86 x 3.54 inches
- Item Weight: 2.27 pounds

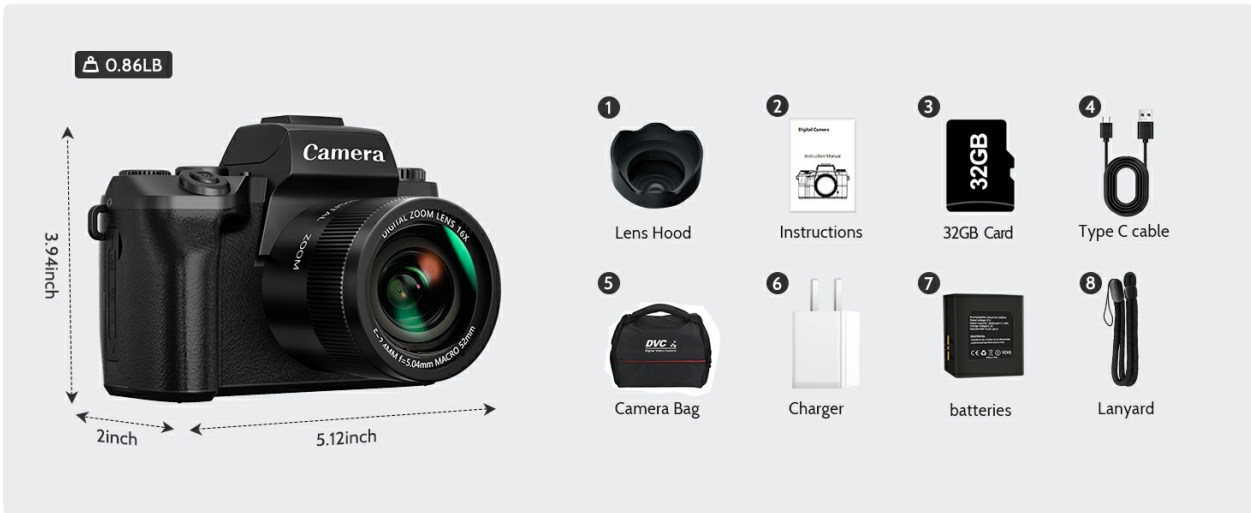

Image: Displays the camera's dimensions (length, width, height) and weight, alongside a numbered list of the included accessories.

WARRANTY AND SUPPORT

Saneen provides a **12-month warranty** for this product. Additionally, we offer a **30-day no-reason return policy**. For any questions, technical support, or warranty claims, please contact Saneen customer service through the retailer where you purchased the product or visit the official Saneen website for contact information.

Documents - Saneen – S05

no relevant documents