

SMALLRIG 3902-SR

SmallRig Wireless Remote Control Instruction Manual

Model: 3902-SR

INTRODUCTION

The SmallRig Wireless Remote Control (Model: 3902-SR) is a versatile Bluetooth remote shutter release designed for select Sony, Canon, and Nikon digital cameras. It enables users to remotely start and stop video recording, as well as capture still photographs, enhancing shooting flexibility and reducing camera shake. Its ergonomic design and multiple mounting options make it a convenient tool for various photographic and videographic applications.



Image: Top view of the SmallRig Wireless Remote Control.

PACKAGE CONTENTS

Please verify that all items listed below are included in your package:

- 1 x SmallRig Wireless Remote Control
- 2 x CR2032 Batteries (Panasonic)
- 1 x 1/4"-20 Screw
- 1 x Allen Wrench

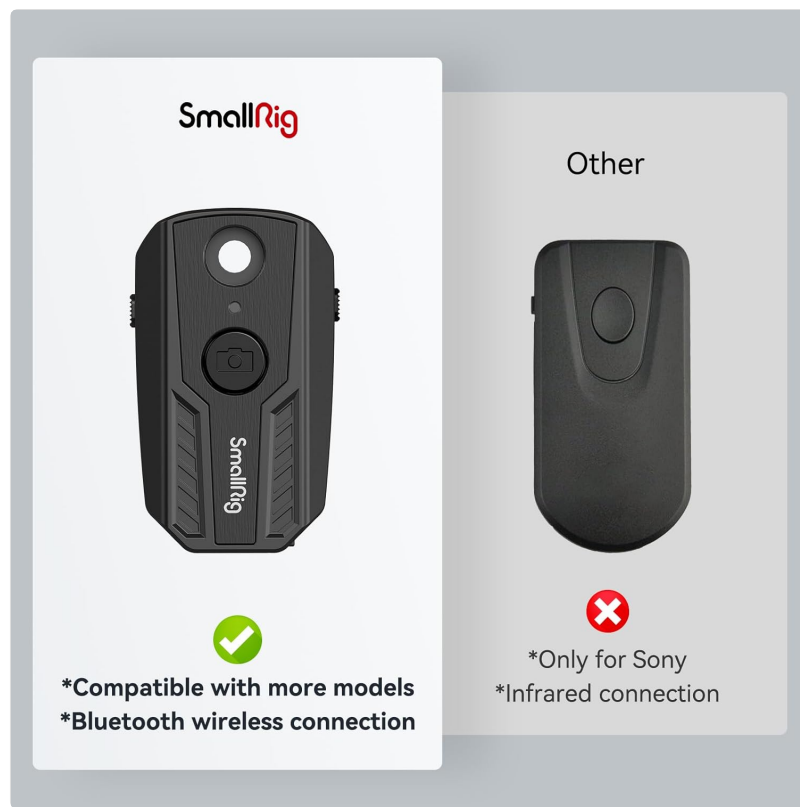

Image: Contents of the SmallRig Wireless Remote Control package.

PRODUCT OVERVIEW

Familiarize yourself with the key components of the SmallRig Wireless Remote Control:

- **Shutter / Recording Button:** Used to trigger photo capture or start/stop video recording.
- **Mode Switch:** Toggles between STILL (photo) and MOVIE (video) modes.
- **Power Switch:** Turns the remote control on or off.
- **Status Indicator:** Provides visual feedback on the remote's status (e.g., pairing, active).
- **1/4"-20 Threaded Hole:** Allows for attachment to various camera accessories.
- **Cold Shoe Compatible Clip:** Detachable clip for mounting to cold shoe mounts or clothing.
- **Battery Compartment:** Houses the CR2032 battery.



Image: Labeled components of the SmallRig Wireless Remote Control.

COMPATIBILITY

The SmallRig Wireless Remote Control is compatible with a wide range of Bluetooth-enabled digital cameras from Sony, Canon, and Nikon. Please refer to the list below for specific models:

For Sony	For Canon	For Nikon
Alpha 7R V / Alpha 7R IV / Alpha 7R III / Alpha 7 IV / Alpha 7 III / Alpha 7S III / Alpha 7C II / Alpha 7C / Alpha 7CR / Alpha 9 II / Alpha 9 / Alpha A1 / FX3 / FX30 / Alpha 6700 / Alpha 6600 / Alpha 6100 / Alpha 6400 / ZV-E1 / ZV-E10 / ZV-E10 II / ZV-1 II / ZV-1 / ZV-1F / DSC-RX100 VII	EOS R5 / R5 II / R6 Mark II / R6 / R7 / R8 / R10 / R / RP / R50 / M6 Mark II / M50 / 90D	Z50 / Zfc / Z30 <i>(Note: Does not support half-press autofocus for Nikon)</i>



Image: Compatibility overview for SmallRig Wireless Remote Control.

SETUP

Battery Installation

1. Pull out the battery compartment from the remote control.
2. Install the CR2032 battery with the "+" pole facing up.
3. Close the battery compartment securely.

How to Replace the Battery

Step 1

Pull out the battery compartment



Step 2

Install the battery with the "+" pole facing up



Step 3

Close the battery compartment



Image: Steps for battery replacement.

Pairing with Cameras

The remote control features a fast and reliable Bluetooth connection with a range of up to 32.8 feet (10 meters). Once paired, it will automatically connect to the camera the next time you turn it on.

Bluetooth Wireless Connection within a 32.8ft / 10m Range

Once paired, it will automatically connect upon activation and can be triggered remotely from a distance of 32.8ft / 10m.



Image: Bluetooth wireless connection range demonstration.

For Sony Selected Cameras:

1. Adjust the remote control power switch to [ON]. The status indicator flashes and then goes out. Confirm the mode switch adjustment to [LOCK].
2. Adjust the camera settings:
 - a. Select MENU -> [Network] -> [Transfer/Remote] -> [BLE Rmt Cntrl] -> [On]
 - b. Select MENU -> [Network] -> [BLE function] -> [On] -> [On]
 - c. Select MENU -> [Network] -> [BLE Settings] -> [Pairing]
3. Press and hold the remote control shutter / record button until the indicator flashes and the camera screen prompts "Allow connection from the device? Connected device: SR-RC3", select [OK].
4. When pairing is complete, "[Paired]" appears, select [OK].
5. Combined with the actual shooting needs, adjust the remote control mode switch to [STILL] (shutter) or [MOVIE] (record).

Built-in Cold Shoe Mount

It can be attached to the cage or handle via its cold shoe.



32.8ft / 10m Range

Featuring a fast and stable bluetooth connection that enables transmission within a 32.8ft / 10m range.



1/4"-20 Mounting Screw

It can be mounted onto handles, cages, and any accessories with the 1/4"-20 screw for handheld shooting



Image: Pairing instructions for Sony cameras.

For Canon R6 Mark II / R8 / R50:

(Note: For pairing on other Canon models, please consult your camera's manual.)

1. Adjust the remote control power switch to [ON], the status indicator flashes and then goes out, confirm the mode switch adjustment to [LOCK].
2. Adjust the camera settings:
 - a. Select MENU -> [Communication functions] -> [BLE settings] -> [Enable]
 - b. Select MENU -> [Communication functions] -> [Connect to Wireless Remote] -> [Add a device to connect to]
3. The camera screen prompts "Pairing in progress. Start pairing on the Wireless Remote." Press and hold the remote shutter / record button until the indicator flashes and the camera screen indicates "[Paired with SR-RC3]", select [OK] to complete the pairing.
4. Combined with the actual shooting needs, adjust the remote control mode switch to [STILL] (shutter) or [MOVIE] (record). If you choose [STILL] mode, on the camera home page select [SET] -> [Drive mode] -> [Self-timer: 10sec/remote] or [Self-timer: 2sec/remote].



Image: Pairing instructions for Canon cameras.

For Nikon Selected Cameras:

1. Adjust the remote control power switch to [ON], the status indicator flashes and then goes out, confirm the mode switch adjustment to [LOCK].
2. Adjust the camera settings:
 - a. Select MENU -> [SETUP MENU] -> [Wireless remote (ML-L7) options] -> [ON]
 - b. Select MENU -> [SETUP MENU] -> [Wireless remote (ML-L7) options] -> [Save wireless remote controller]
3. Press and hold the shutter / record button on the remote control until the light flashes rapidly and then release it.
4. After successful pairing, the screen prompts "Wireless remote controller is saved".
5. Combined with the actual shooting needs, adjust the remote control mode switch to [STILL] (shutter) or [MOVIE] (record).

Note: The remote control mode needs to be the same as the camera mode, and the shutter / record button does not support the half-press autofocus function for Nikon cameras.



Image: Pairing instructions for Nikon cameras.

OPERATING INSTRUCTIONS

The SmallRig Wireless Remote Control features two primary operating modes:

- **STILL Mode (Photo):**

In STILL mode, press the shutter button halfway down to activate automatic focus. Press the button all the way down to capture a photograph.

- **MOVIE Mode (Video):**

In MOVIE mode, a full press of the shutter button will toggle video recording on or off. This allows for convenient start/stop control during video shoots.

Ensure the remote control's mode switch matches your camera's intended shooting mode for optimal functionality.

MOUNTING OPTIONS

The remote control offers flexible mounting solutions to integrate seamlessly with your camera setup:

- **Detachable Cold Shoe Clamp:** The remote comes with a detachable cold shoe clamp at the bottom, allowing for quick attachment to any standard cold shoe mount on your camera cage, handle, or other accessories. It can also be clipped onto your collar or other convenient locations.
- **1/4"-20 Screw Mount:** By removing the cold shoe clamp, the remote can be securely attached to accessories such as the SmallRig Side Handle 3260 or Top Handle 2165C using the included 1/4"-20 screw. This provides a stable mounting point for handheld shooting setups.



Image: Examples of mounting the remote control on camera handles.

MAINTENANCE

To ensure the longevity and optimal performance of your SmallRig Wireless Remote Control, follow these maintenance guidelines:

- **Cleaning:** Use a soft, dry cloth to clean the remote control. Avoid using harsh chemicals or abrasive materials.
- **Storage:** Store the remote in a cool, dry place away from direct sunlight and extreme temperatures.
- **Battery Life:** If the remote is not going to be used for an extended period, it is recommended to remove the battery to prevent leakage and potential damage.
- **Handle with Care:** While durable, avoid dropping the remote or subjecting it to strong impacts.

TROUBLESHOOTING

If you encounter issues with your SmallRig Wireless Remote Control, please refer to the following common troubleshooting steps:

- **Remote Not Pairing:**
 - Ensure the remote control is powered on and the mode switch is set to [LOCK] during the initial pairing process.
 - Verify that your camera's Bluetooth settings are enabled and in pairing mode as per the "Setup"

section for your specific camera brand.

- Check if the remote's battery is properly installed and has sufficient charge. Replace if necessary.
- Move closer to the camera to ensure you are within the 32.8ft (10m) Bluetooth range.
- Restart both the camera and the remote control and attempt the pairing process again.

- **Button Not Responding / Sticking:**

- Ensure the remote is powered on and not in [LOCK] mode if you intend to use the shutter/record function.
- Check for any debris or foreign objects around the button that might be obstructing its movement.
- Gently press the button multiple times to see if it frees up.
- If the button feels stiff or sticky, it may indicate a manufacturing issue. Refer to the warranty information for support.

- **Intermittent Connection:**

- Environmental factors (e.g., strong electromagnetic interference, physical obstructions) can affect Bluetooth range. Try using the remote in a different location.
- Ensure the remote and camera are within the optimal operating range.
- Re-pair the remote control with your camera.

If the issue persists after attempting these steps, please contact SmallRig customer support for further assistance.

SPECIFICATIONS

Feature	Detail
Brand	SMALLRIG
Model Number	3902-SR
Connectivity Technology	Bluetooth
Max Number of Supported Devices	1
Product Dimensions	1.57 x 1.57 x 1.97 inches (53.2 x 32.4 x 22.5 mm)
Item Weight	0.635 ounces (18 ± 5g)
Material(s)	ABS+PC
Special Feature	Ergonomic
First Available Date	August 17, 2023





WARRANTY AND SUPPORT

SmallRig products are manufactured to high-quality standards. This product is covered by a limited warranty against defects in materials and workmanship. For detailed warranty terms, technical support, or

service inquiries, please visit the official SmallRig website or contact their customer service department.
Please retain your proof of purchase for warranty claims.
For the latest information and support, please visit: www.smallrig.com

© 2024 SMALLRIG. All rights reserved.

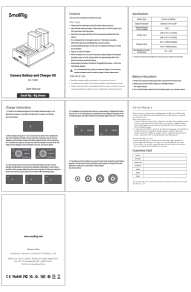
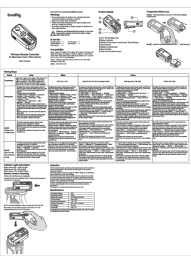
Related Documents - 3902-SR

 <p>SmallRig</p> <p>Cold Shoe Adapter with Furry Windscreen (for Sony ZV Series)</p>	<p>SmallRig 3526 Cold Shoe Adapter with Furry Windscreen for Sony ZV Series Cameras</p> <p>Enhance your Sony ZV series vlogging setup with the SmallRig 3526 Cold Shoe Adapter and Furry Windscreen. This accessory reduces wind noise, allows simultaneous mounting of accessories like LED lights, and provides a secure, compact, and lightweight solution for creators. Compatible with Sony ZV-1 II, ZV-1, ZV-1F, ZV-E1, ZV-E10, and ZV-E10 II cameras.</p>
 <p>SmallRig</p>	<p>SmallRig SR-RG1 Wireless Shooting Grip User Manual</p> <p>User manual for the SmallRig SR-RG1 Wireless Shooting Grip, detailing its features, compatibility, pairing instructions for Sony and Canon cameras, product specifications, and warranty information.</p>
 <p>SmallRig</p>	<p>SmallRig NP-FW50 Camera Battery and Charger Kit User Manual</p> <p>User manual for the SmallRig NP-FW50 Camera Battery and Charger Kit, detailing specifications, charging instructions, battery care, and warranty information for Sony NP-FW50 compatible cameras.</p>
 <p>SmallRig</p>	<p>SmallRig 3902 Wireless Remote Controller for Sony, Canon, Nikon Cameras - User Manual</p> <p>User manual for the SmallRig 3902 Wireless Remote Controller, designed for seamless operation with select Sony, Canon, and Nikon cameras. Learn about setup, features, and usage for enhanced photography and videography.</p>
 <p>SmallRig</p> <p>SR-RG2 Wireless Remote Controller</p>	<p>SmallRig SR-RG2 Wireless Remote Controller Operating Instructions</p> <p>This document provides operating instructions for the SmallRig SR-RG2 Wireless Remote Controller, covering product details, specifications, indicator light descriptions, pairing steps for Sony, Nikon, and Canon cameras, and app update information.</p>

SmallRig



HawkLock Quick Release Cage Kit
for Sony FX3 / FX30
鷹鉤FX3 / FX30快速釋放籠組件

Operating Instruction / 操作指南

[SmallRig HawkLock Quick Release Cage Kit for Sony FX3/FX30 - Operating Instructions and Specifications](#)

Detailed operating instructions, specifications, and compatibility information for the SmallRig HawkLock Quick Release Cage Kit designed for Sony FX3 and FX30 cameras. Includes parts lists and installation guides.