

Flodream FD-700JLF

Flodream FD-700JLF 700 Watt Upflush Macerating Toilet Instruction Manual

Model: FD-700JLF

1. INTRODUCTION

This manual provides essential information for the safe and efficient installation, operation, and maintenance of your Flodream FD-700JLF 700 Watt Upflush Macerating Toilet. Please read these instructions thoroughly before installation and retain this manual for future reference.

2. PRODUCT FEATURES

- **Powerful Macerator Pump:** Equipped with a 700W macerator pump, capable of flushing waste up to 32 feet vertically and 328 feet horizontally. The pump operates automatically when needed.
- **Versatile Application:** Designed to handle waste from a WC, sink, shower, and washing machine.
- **No-Clog Drainage:** Features a 1.96-inch large pipe drainage design, larger than traditional 1.36-inch pipes, to prevent clogging and ensure smooth waste discharge.
- **Anti-Freeze Crack Technology:** Special accessories and groove design ensure reliable operation even in cold conditions.
- **Water-Saving Dual Flush:** Offers a half-flush (0.8 GPF) and a full-flush (1.28 GPF) system for water conservation.
- **Nano-Glaze Toilet Bowl:** Provides a smooth, easy-to-clean surface that resists stains.
- **Soft-Close Seat:** The toilet seat closes slowly and quietly, preventing slamming.
- **Fully Skirted Trapway:** Offers a sleek appearance and simplifies cleaning.
- **Quick-Release Functionality:** Quick-attach hardware ensures fast and secure installation of the toilet seat.

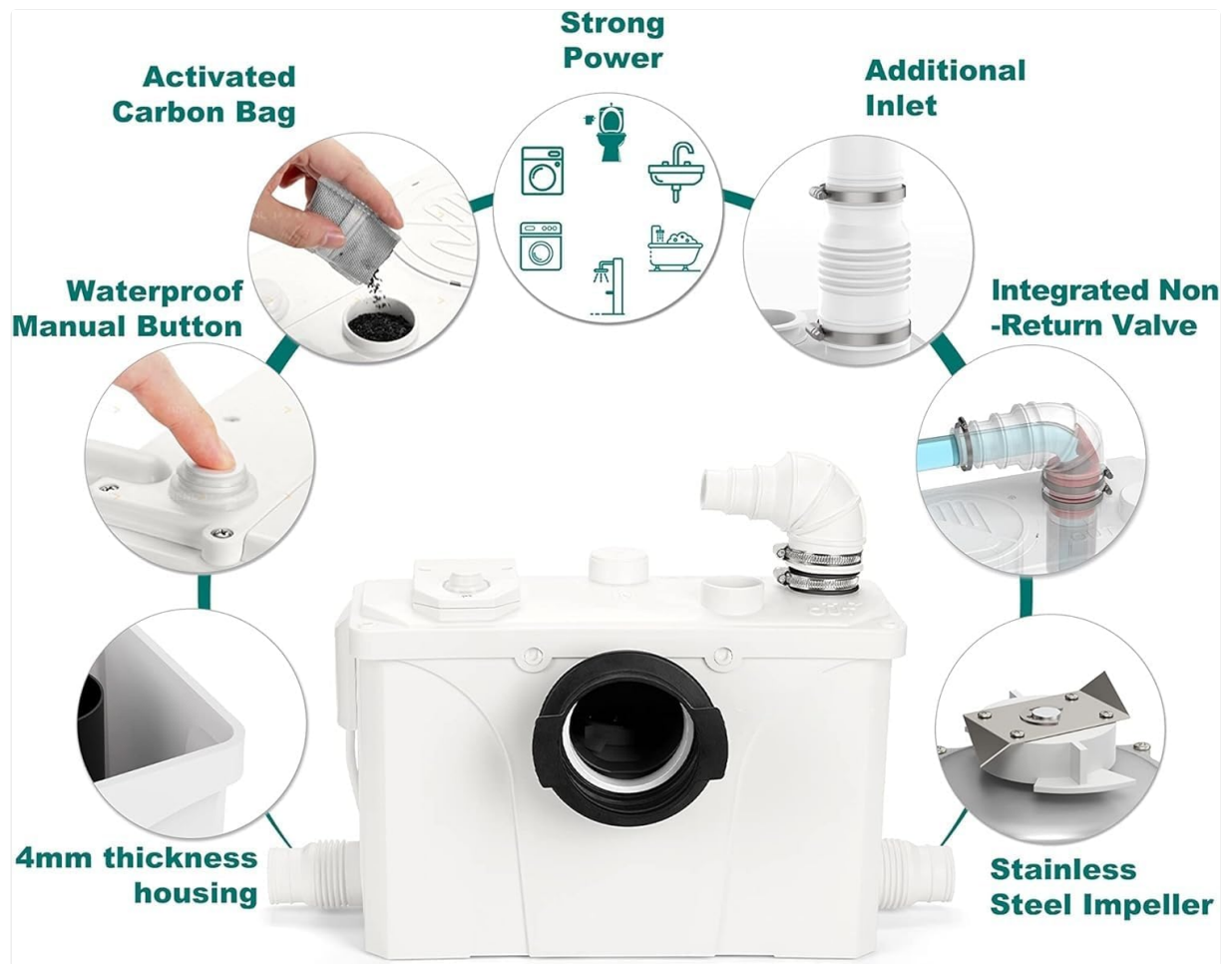

Figure 2.1: Macerator Pump Internal Features

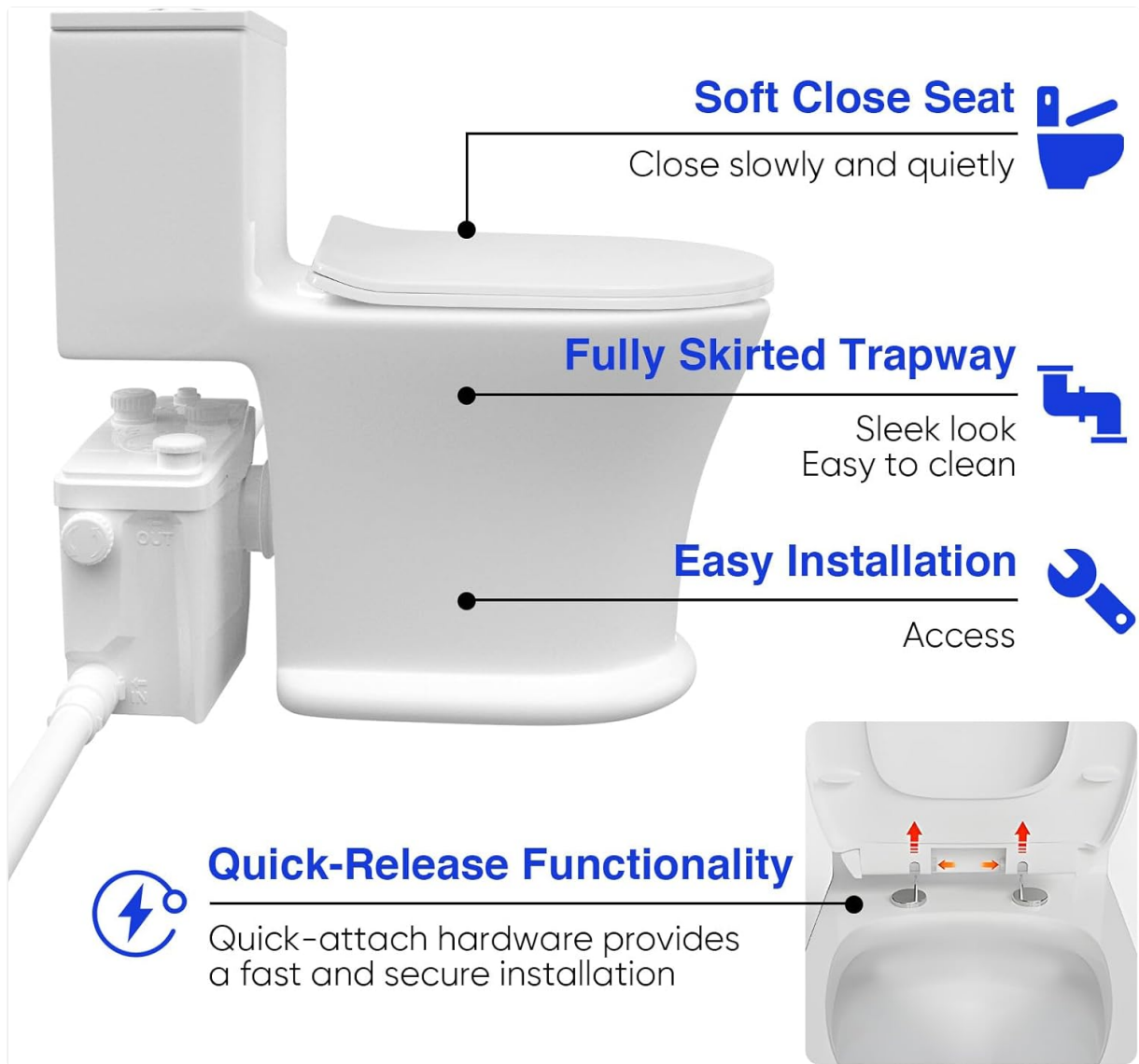

Figure 2.2: Toilet Bowl Features



Figure 2.3: Seamless Design Advantage

3. SAFETY INFORMATION

- Always disconnect power before performing any maintenance or service.
- Ensure all electrical connections comply with local codes and regulations.
- Do not dispose of foreign objects (e.g., sanitary products, wipes, chemicals) into the toilet, as this can damage the macerator pump.
- Ensure proper ventilation for the macerator unit as per installation guidelines.
- Keep children away from the unit during operation and maintenance.
- If any unusual noise, smell, or malfunction occurs, immediately disconnect power and contact qualified service personnel.

4. PACKAGE CONTENTS

Verify that all components are present before beginning installation:

- Macerating pump

- Mounting Screws and fasteners
- Rear Toilet Unit
- Toilet seat

5. SPECIFICATIONS

Feature	Specification
Model Number	FD-700JLF
Power Rating	700W
Input Voltage	AC 100-120V, 60HZ
Maximum Vertical Pumping	32 ft
Maximum Horizontal Pumping	328 ft
Qmax (Flow Rate)	130 L/Min
Max. Liquid Temperature	90 °C
Max. Ambient Temperature	39 °C
Noise Level	39 dBA
Degree of Protection	IPX4
Product Dimensions (D x W x H)	30"D x 15"W x 40"H
Material	Ceramic (Toilet), Polypropylene (Seat)
Installation Type	Wall Mounted (Macerator unit)



Figure 5.1: Macerator Pump Dimensions



Figure 5.2: Toilet Dimensions

6. SETUP AND INSTALLATION

6.1 Connecting the Macerator Pump to the Toilet

The macerator pump connects directly to the rear of the toilet unit. Ensure a secure and watertight seal using the provided rubber gasket and clamps.

Your browser does not support the video tag.

Video 6.1: Installation of the rubber gasket to connect the pump and toilet. This video demonstrates the correct procedure for attaching the macerator pump to the toilet using the provided rubber gasket and hose clamps, ensuring a secure connection.

6.2 Connecting Additional Fixtures

The macerator pump is designed with multiple inlets to connect a sink, shower, and washing machine. Refer to the diagram below for typical connection points.

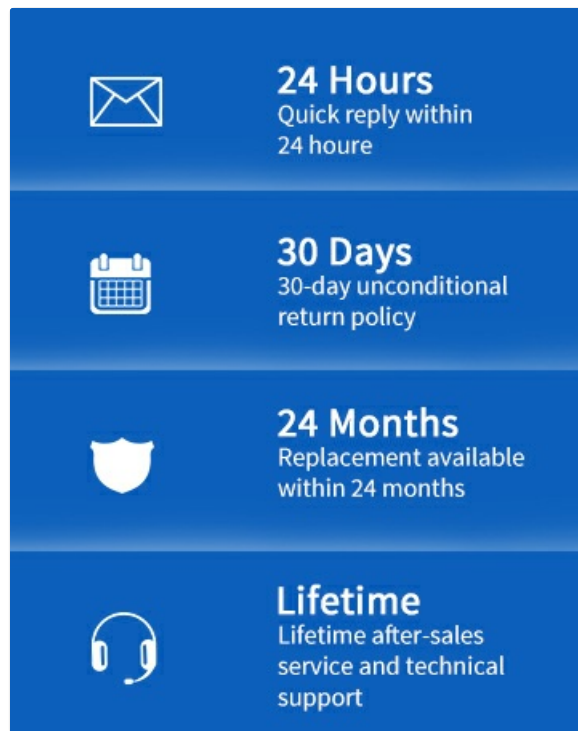

Figure 6.1: Macerating Toilet System with Multiple Inlets

6.3 Venting Options

Proper ventilation is crucial for the macerator system. You have two primary options for deodorization:

1. **Activated Carbon Deodorization:** Install an activated carbon bag into the designated compartment on the macerator unit.
2. **Ventilation Duct Deodorization:** Connect a vent pipe to the macerator unit. A 40mm (1-1/2") vent pipe can be connected by cutting the designated section.

Activated carbon deodorization or vent pipe deodorization



1
Activated
carbon deodorization

2
Ventilation
duct deodorization

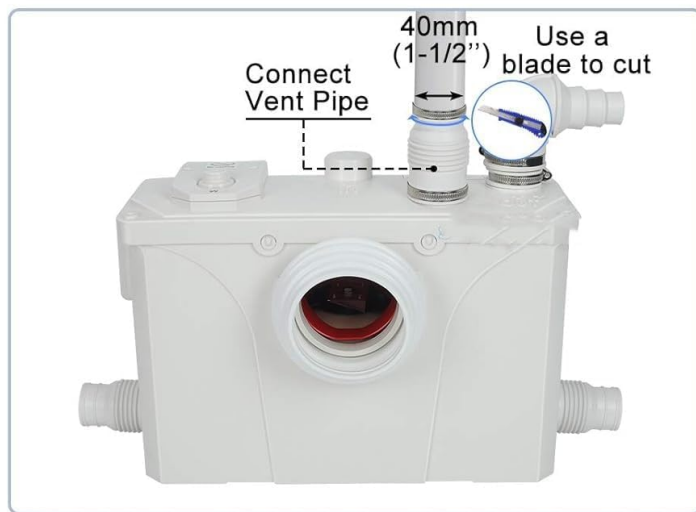

Figure 6.2: Deodorization Options

7. OPERATING INSTRUCTIONS

The Flodream FD-700JLF macerating toilet operates automatically. When the toilet is flushed or water enters the macerator unit from connected fixtures (sink, shower, washing machine), the pump will activate to grind and discharge the waste.

- **Dual-Flush System:** Utilize the dual-flush buttons on the toilet tank for water conservation. Press the smaller button for a half-flush (0.8 GPF) for liquid waste, and the larger button for a full-flush (1.28 GPF) for solid waste.
- **Automatic Macerator Activation:** The macerator pump will automatically engage when the water level in the unit rises, processing waste and pumping it through the discharge pipe.

Your browser does not support the video tag.

Video 7.1: How the macerating toilet system functions in a basement environment. This video visually explains the operational principle of the macerating toilet, demonstrating how it processes and pumps waste in locations without gravity drainage.

8. MAINTENANCE

Regular maintenance ensures the longevity and optimal performance of your Flodream macerating toilet.

- **Cleaning the Toilet Bowl:** The nano-glaze surface is designed for easy cleaning. Use standard non-abrasive toilet cleaners and a soft brush or cloth. Avoid harsh chemicals that could damage the glaze or internal components.
- **Macerator Unit Cleaning:** Periodically inspect the macerator unit for any debris. If necessary, disconnect power and carefully remove any obstructions. Consult a professional if you are unsure.
- **Activated Carbon Bag Replacement:** If using activated carbon for deodorization, replace the carbon bag periodically (e.g., every 3-6 months, depending on usage) to maintain effectiveness.
- **General Inspection:** Regularly check all connections for leaks and ensure the power cord is in good condition.

9. TROUBLESHOOTING

If you encounter issues with your Flodream macerating toilet, refer to the following common problems and solutions. Always disconnect power before attempting any inspection or repair.

Problem	Possible Cause	Solution
Pump does not activate	No power, clogged sensor, motor issue	Check power supply. Inspect for obstructions around the sensor. Contact support if motor issue is suspected.
Continuous running pump	Leak in the system, faulty sensor, foreign object	Check for leaks in pipes and connections. Inspect for foreign objects. Contact support if sensor is faulty.
Unpleasant odors	Improper ventilation, clogged vent, old carbon filter	Ensure vent pipe is clear or activated carbon bag is fresh. Check for proper installation of vent system.
Water leakage	Loose connections, damaged seals, cracked housing	Tighten all pipe connections. Inspect and replace damaged seals. Contact support for cracked housing.

If the problem persists after attempting these solutions, please contact Flodream customer support.

10. WARRANTY AND SUPPORT

Flodream provides the following warranty for your FD-700JLF 700 Watt Upflush Macerating Toilet:

- **2-Year Limited Warranty:** Against staining or fading of the porcelain glaze.
- **2-Year Limited Warranty:** On the flushing mechanism.
- **Lifetime After-Sale Service:** Flodream offers lifetime after-sale service and technical support.

For any inquiries, technical assistance, or warranty claims, please contact Flodream customer support. Messages are typically responded to within 12 hours. All parts are available for future replacement.