

GREATHTEK S7232H-01

GREATHTEK USB 3.0 2-Port HDMI KVM Switch User Manual

Brand: GREATHTEK | Model: S7232H-01

INTRODUCTION

This manual provides detailed instructions for the installation, operation, and maintenance of your GREATHTEK USB 3.0 2-Port HDMI KVM Switch. This device allows two computers to share a single HDMI monitor and a set of USB 3.0 peripherals, including a keyboard and mouse, streamlining your workspace and enhancing productivity.

PRODUCT FEATURES

- **Dual PC Control:** Control two separate computers using one HDMI monitor and a single set of USB 3.0 keyboard and mouse.
- **High Resolution Support:** Supports Ultra HD 4K resolution at 60Hz (3840x2160@60Hz), backward compatible with 4K@30Hz, 1080p@60Hz, and other resolutions, providing a high-definition visual experience.
- **USB 3.0 Connectivity:** Equipped with three USB 3.0 ports for sharing various USB peripherals such as keyboards, mice, scanners, printers, and U-disks, offering 10x faster transmission rates than USB 2.0.
- **Flexible Switching Methods:** Easily switch between connected computers using either the wired remote control or the button on the KVM switch unit. *Note: Hotkey switching is not supported.*
- **Adaptive EDID & Plug and Play:** Features adaptive EDID for stable and smooth image transmission. The device is plug-and-play, requiring no external power supply or driver software for installation.
- **Wide Compatibility:** Compatible with various input devices like PCs, laptops, and PS4, and supports operating systems including Windows 7/8/10/Vista/XP, Linux, and Mac.

The **USB3.0 ports** can greatly improve transmission rate and work efficiency

10X faster than USB 2.0

5Gbps



The USB 3.0 ports on the KVM switch provide high-speed data transfer for connected peripherals.

Support 4K@60Hz

Support 3840*2160@60Hz UHD resolution, backward compatible
with 4K@30Hz, 1080P, etc.

Adaptive EDID can identify multiple display devices.



This KVM switch supports stunning 4K resolution at 60Hz for a clear visual experience.

2 computers share 1 monitor 1 USB 3.0 keyboard and mouse



**Wide
compatibility**



Windows



Linux



UNIX



DOS

The KVM switch offers wide compatibility with various operating systems and devices.

PACKAGE CONTENTS

Please verify that all items listed below are included in your package:

- 1 x GREATHTEK USB 3.0 2-Port HDMI KVM Switch Unit
- 2 x USB 3.0 Cables (1.2m)
- 1 x 3.5mm Audio Cable (1m)
- 1 x Wired Remote Controller
- 1 x User Manual
- 1 x Warranty Card
- 4 x Foot Pads

Package List



3.5mm audio cable *1



Wire-DesktopController*1



USB 3.0 Cable*2



User Manual



Warranty Card



Foot Pads

Contents included in the product package.

SETUP AND INSTALLATION

Follow these steps to correctly set up your KVM switch. Ensure all cables are securely connected for optimal performance.

1. Connect your HDMI monitor to the **HDMI OUT** port on the KVM switch.
2. For PC1, connect an HDMI cable from your PC's HDMI output to the **HDMI IN (PC1)** port on the KVM switch.
3. For PC1, connect a USB 3.0 cable from your PC's USB port to the **USB (PC1)** port on the KVM switch.
4. Repeat steps 2 and 3 for PC2, connecting its HDMI output to **HDMI IN (PC2)** and its USB port to **USB (PC2)** on the KVM switch.
5. Connect your USB keyboard, mouse, and any other USB 3.0 peripherals (e.g., printer, U-disk) to the three **USB 3.0** ports on the front of the KVM switch.
6. If desired, connect the wired remote controller to the **CTRL** port on the KVM switch.

Note: Three HDMI cables are required for connecting two computers and one monitor, and these are not included in

the package.

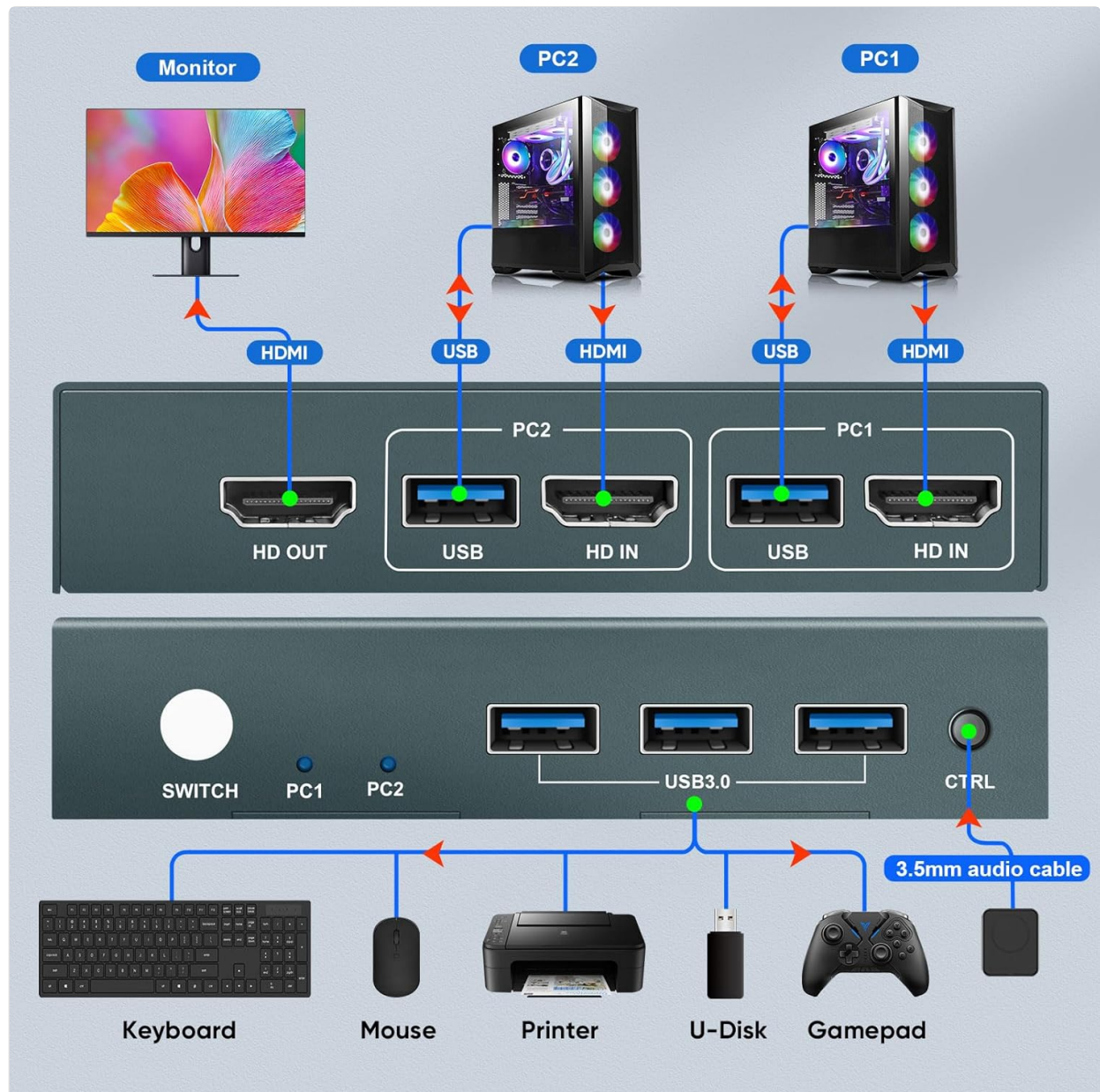

Connection diagram for the KVM switch.

OPERATING INSTRUCTIONS

The GREATHTEK KVM switch offers two convenient methods for switching between connected computers:

1. Button Switching

Press the "SWITCH" button located on the front panel of the KVM switch. Each press will toggle between PC1 and PC2.

2. Wired Remote Control Switching

If connected, simply press the button on the wired remote control. This will also toggle between PC1 and PC2.

Important: This KVM switch does not support hotkey switching via keyboard commands.



Button Switching



Wired Remote

Switch between computers using the front panel button or the wired remote.

MAINTENANCE

- Keep the device in a dry, well-ventilated area.
- Avoid exposing the device to extreme temperatures or direct sunlight.
- Clean the device with a soft, dry cloth. Do not use liquid cleaners or aerosols.
- Ensure all cables are properly secured and not under strain.

TROUBLESHOOTING

If you encounter issues with your KVM switch, please refer to the following common problems and solutions:

1. No Display on Monitor:

- Ensure all HDMI cables are securely connected to both the KVM switch and your computers/monitor.
- Verify that the KVM switch is powered on (though it's plug-and-play, ensure USB connections provide sufficient power).
- Try restarting the connected computers.

- Check your monitor's input source settings to ensure it's set to the correct HDMI input.

2. Keyboard/Mouse Not Responding:

- Ensure the USB cables from your computers are connected to the correct USB input ports on the KVM switch (USB PC1/PC2).
- Ensure your keyboard and mouse are connected to the USB 3.0 peripheral ports on the KVM switch.
- Try reconnecting the USB devices.
- Some specialized gaming keyboards/mice with high power consumption or complex drivers may not be fully compatible. Try a standard keyboard/mouse to test.

3. Resolution Issues (e.g., Not 4K@60Hz):

- Verify that your monitor and graphics card support 4K@60Hz resolution.
- Ensure you are using high-quality HDMI 2.0 cables capable of supporting 4K@60Hz.
- Check your computer's display settings to ensure the resolution and refresh rate are correctly configured.

4. Switching Delay or Failure:

- Ensure the wired remote control cable is fully inserted into the CTRL port.
- Avoid rapid, successive switching. Allow a moment for the signal to stabilize.

If problems persist after trying these steps, please contact customer support.

SPECIFICATIONS

Feature	Detail
Model Number	S7232H-01
Brand	GREATHTEK
Connector Type	USB 3.0, HDMI
Max Resolution	3840 x 2160 @ 60Hz (4K@60Hz)
Backward Compatibility	3840 x 2160 @ 30Hz, 1920 x 1080p @ 60Hz
USB Ports	3 x USB 3.0 (for peripherals)
Switching Methods	Button, Wired Remote Control
HDMI Standard	HDMI 2.0
HDCP Support	HDCP 2.2
Operating Mode	Automatic
Material	Copper (internal components)
Package Dimensions	16.31 x 15.19 x 2.39 cm
Item Weight	259 grams

WARRANTY AND SUPPORT

GREATHTEK products come with a lifetime warranty service, ensuring long-term reliability and customer satisfaction.

If you have any questions, concerns, or require technical assistance regarding your KVM switch, please do not hesitate to contact our customer support team. For efficient service, please provide your order number when reaching out.

We are committed to providing a prompt and effective solution to any issues you may encounter.