

## Owl Labs Whiteboard Owl

# Owl Labs Whiteboard Owl Camera User Manual

Model: Whiteboard Owl (ASIN: B0CFM5QDH3)

Brand: Owl Labs

## INTRODUCTION

The Owl Labs Whiteboard Owl Camera is designed to enhance visual content for remote meeting participants by automatically capturing whiteboard content. This device requires pairing with a Meeting Owl Pro or Meeting Owl 3 (sold separately) to function.

Key features include:

- **Whiteboard Sharing:** Enables remote attendees to participate in hybrid meetings and classes by live-streaming whiteboard content alongside a 360° panoramic view of the room.
- **Enhanced Content:** Improves the visibility of writing on the whiteboard by increasing contrast, sharpening text, reducing shadows, and making the presenter transparent.
- **Flexible Installation:** Supports large whiteboards up to 15x20 feet and offers various mounting options (wall, ceiling, tripod) for spaces 7-16 feet from the whiteboard. Compatible with standard dry erase markers and non-glass whiteboards.
- **Software Updates:** Designed for continuous software improvements and future capability enhancements.

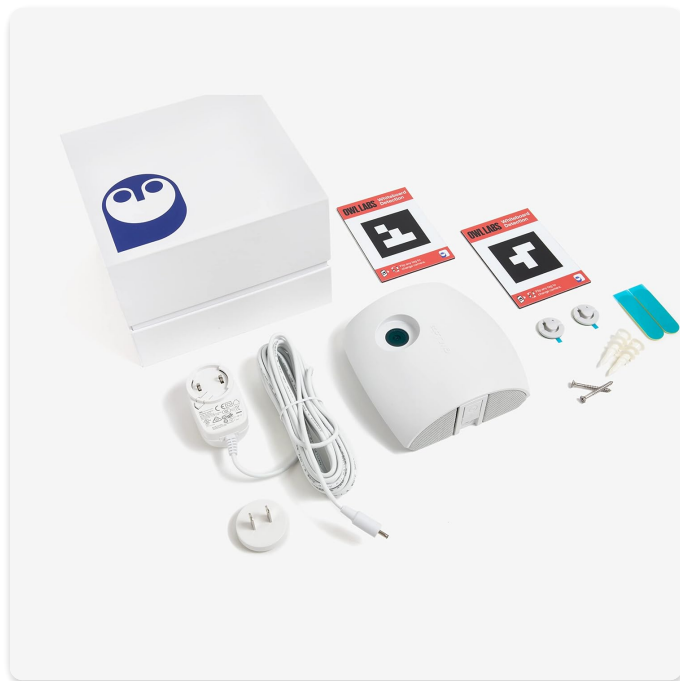

*Figure 1: Front view of the Whiteboard Owl Camera, a compact white device with a camera lens and a cable extending from the bottom.*

## WHAT'S IN THE BOX

Upon unboxing your Whiteboard Owl Camera, please ensure all the following components are present:

- Whiteboard Owl Camera Unit
- Power Adapter and Cable
- Whiteboard Tag(s)
- Mounting Hardware (screws, anchors, wall mounts)



*Figure 2: All components included in the Whiteboard Owl Camera package, laid out next to the product box. This includes the camera, power supply, mounting hardware, and Whiteboard Tags.*

## SETUP AND INSTALLATION

The Whiteboard Owl Camera requires a Meeting Owl Pro or Meeting Owl 3 for operation. Ensure your Meeting Owl device is set up and connected before proceeding.

### 1. Choosing a Location

Position the Whiteboard Owl Camera between 7 to 16 feet (approximately 2.1 to 4.9 meters) from the whiteboard. It can be mounted on a wall, ceiling, or tripod. Consider the size of your whiteboard; the camera supports whiteboards up to 15x20 feet (approximately 4.6x6.1 meters).

### 2. Mounting the Camera

Use the provided mounting hardware to securely attach the Whiteboard Owl Camera to your chosen surface. Ensure the camera has a clear, unobstructed view of the entire whiteboard.

### 3. Connecting to Power

Connect the power adapter to the Whiteboard Owl Camera and plug it into a power outlet.

### 4. Pairing with Meeting Owl

Follow the instructions in the Meeting Owl app to pair your Whiteboard Owl Camera with your Meeting Owl Pro or Meeting Owl 3. This step is crucial for the camera to function correctly and integrate with your meeting setup.

### 5. Placing Whiteboard Tags

Place the provided Whiteboard Tags on the corners of your whiteboard. These tags help the camera accurately detect and frame the whiteboard area for optimal content capture.

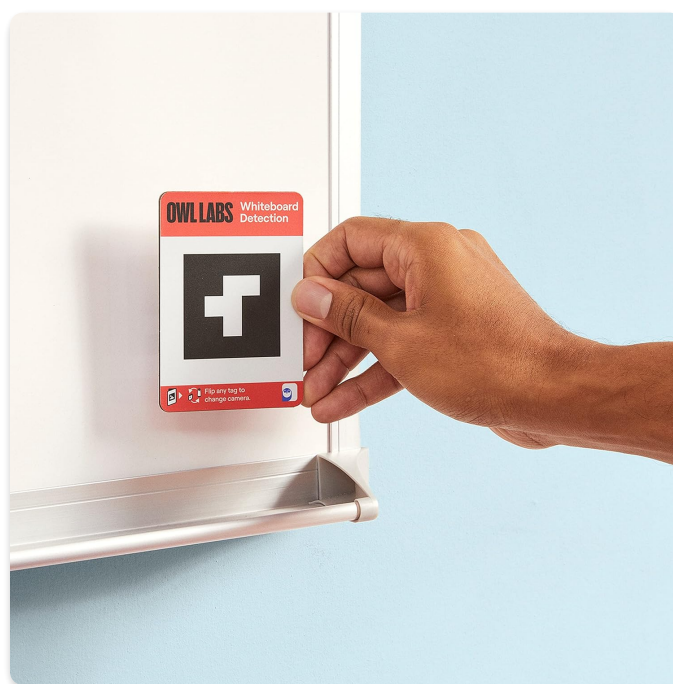

*Figure 3: A hand placing a Whiteboard Tag, a red and white square with a black cross, onto the corner of a whiteboard. These tags assist the camera in identifying the whiteboard boundaries.*

## OPERATING THE WHITEBOARD OWL CAMERA

Once set up and paired with your Meeting Owl device, the Whiteboard Owl Camera automatically enhances and shares your whiteboard content with remote participants.

## Automatic Content Capture

The camera intelligently detects writing and drawings on the whiteboard. It works with any standard dry erase markers and non-glass whiteboards. The system automatically adjusts the image to provide a clear, enhanced view to remote attendees.



*Figure 4: A man actively writing on a large whiteboard, demonstrating the typical use case for the Whiteboard Owl Camera in a meeting or classroom setting.*

## Enhanced Visuals

The Whiteboard Owl Camera applies proprietary algorithms to the captured image to:

- Increase contrast for better readability.
- Sharpen text and lines.
- Decrease shadows that might obscure content.
- Make the presenter transparent, ensuring their body does not block the whiteboard content for remote viewers.

## Integration with Meeting Owl

The Whiteboard Owl Camera works in conjunction with your Meeting Owl Pro or Meeting Owl 3, providing a comprehensive view of the meeting space. Remote participants will see both the 360° panoramic view of the room and the enhanced whiteboard feed simultaneously.



Figure 5: Three individuals engaged in a meeting, with a Meeting Owl device on the table and a whiteboard visible in the background, illustrating a typical hybrid meeting setup.

## MAINTENANCE

To ensure optimal performance and longevity of your Whiteboard Owl Camera, follow these simple maintenance guidelines:

- **Cleaning:** Gently wipe the camera lens and body with a soft, dry, lint-free cloth. Avoid using abrasive cleaners, solvents, or harsh chemicals, as these can damage the device.
- **Software Updates:** Regularly check for and install software updates via the Meeting Owl app. These updates often include performance improvements, new features, and bug fixes.
- **Environment:** Keep the camera in a clean, dry environment. Avoid exposing it to extreme temperatures, humidity, or direct sunlight for prolonged periods.
- **Cable Management:** Ensure all cables are neatly organized and not under strain to prevent damage.

## TROUBLESHOOTING

If you encounter issues with your Whiteboard Owl Camera, try the following troubleshooting steps:

Problem	Possible Cause / Solution
Camera not powering on.	<ul style="list-style-type: none"><li>• Ensure the power adapter is securely connected to the camera and a working power outlet.</li><li>• Try a different power outlet.</li></ul>
Whiteboard content is blurry or unclear.	<ul style="list-style-type: none"><li>• Check if the camera lens is clean and free of dust or smudges.</li><li>• Verify the camera is within the recommended distance (7-16 feet) from the whiteboard.</li><li>• Ensure the whiteboard tags are correctly placed on all four corners of the whiteboard.</li><li>• Check lighting conditions; excessive glare or insufficient light can affect image quality.</li></ul>
Whiteboard Owl not pairing with Meeting Owl.	<ul style="list-style-type: none"><li>• Ensure both devices are powered on.</li><li>• Update the firmware for both the Whiteboard Owl and Meeting Owl via the Meeting Owl app.</li><li>• Restart both devices.</li><li>• Ensure your Meeting Owl app is up to date.</li></ul>

Problem	Possible Cause / Solution
Presenter is not transparent on the whiteboard feed.	<ul style="list-style-type: none"><li>• Ensure the Whiteboard Owl Camera has a clear view of the whiteboard and the presenter.</li><li>• Verify that the latest software updates are installed.</li></ul>

If these steps do not resolve the issue, please refer to the official Owl Labs support resources or contact customer service.

## SPECIFICATIONS

Feature	Detail
Brand Name	Owl Labs
Model	Whiteboard Owl
ASIN	B0CFM5QDH3
Item Weight	2 pounds (approx. 0.91 kg)
Product Dimensions	2 x 5.25 x 5 inches (approx. 5.1 x 13.3 x 12.7 cm)
Color	White
Connectivity Technology	Wi-Fi
Shooting Modes	Automatic
Exposure Control Type	Automatic
Water Resistance Level	Waterproof
Compatibility	Requires Meeting Owl Pro or Meeting Owl 3 (sold separately)
Supported Whiteboard Size	Up to 15'x20' (approx. 4.6m x 6.1m)
Optimal Distance from Whiteboard	7-16 feet (approx. 2.1m - 4.9m)

## WARRANTY AND SUPPORT

This product is listed as "Renewed" and may come with specific return policies. For detailed information regarding warranty coverage, please refer to the terms provided by the seller or the Amazon Renewed program at the time of purchase.

For technical support, software updates, and additional resources, please visit the official Owl Labs support website.

You can also find more information on the [Amazon Renewed Store](#) page.

**Return Policy:** The product has a 90-day return/replacement policy as per the Amazon Renewed program.