

Agri-Fab 45-05431

Agri-Fab 100 lb. Tow-Behind Spiker/Seeder/Drop Spreader Instruction Manual

Model: 45-05431

1. PRODUCT OVERVIEW

The Agri-Fab 100 lb. Tow Spiker/Seeder/Drop Spreader (Model #45-05431) is designed to help maintain and improve your lawn by efficiently spreading seed, fertilizer, salt, or ice melt, and aerating the soil. This versatile tool is intended to be pulled behind lawn and garden tractors, offering a controlled spreading width of 32 inches.

With a 100 lb. capacity, this unit can cover up to 17,500 square feet in a single fill, depending on the material and application speed. It features 8 galvanized steel spike disks for thorough aeration, 10-inch flat-free tires for smooth transport, and a steel lift handle for easy height adjustment and precise control.



Figure 1: Overall view of the Agri-Fab 100 lb. Tow-Behind Spiker/Seeder/Drop Spreader.

Key Features:

- Made in USA
- 100 lb. capacity, 32-inch working width
- 8 galvanized steel spike disks for thorough aeration
- 10-inch flat-free tires
- Galvanized steel agitator, capable of aerating and seeding in one pass

2. SAFETY INFORMATION

Always read and understand the entire instruction manual before operating the spiker/seeder/drop spreader. Failure to follow safety instructions can result in serious injury or property damage.

General Safety Precautions:

- **Read the Manual:** Familiarize yourself with the controls and proper use of the equipment.
- **Personal Protective Equipment (PPE):** Wear appropriate safety glasses, gloves, and sturdy footwear when assembling, operating, or maintaining the unit.
- **Clear Area:** Ensure the area is clear of bystanders, especially small children and pets, before operating.
- **Secure Attachment:** Always ensure the spreader is securely attached to the towing vehicle before operation.

- **Material Handling:** Use caution when handling and loading materials. Avoid overfilling the hopper.
- **Slope Operation:** Exercise extreme caution when operating on slopes. Avoid steep inclines where the unit could tip.
- **Maintenance:** Perform all maintenance as instructed. Disconnect from the towing vehicle before performing any adjustments or repairs.
- **Storage:** Store the unit in a safe, dry place, out of reach of children.

WARNING: This product can expose you to chemicals including lead and lead compounds, which are known to the State of California to cause cancer and birth defects or other reproductive harm. For more information go to www.P65Warnings.ca.gov.

3. ASSEMBLY

Assembly of your Agri-Fab Spiker/Seeder/Drop Spreader requires careful attention to detail. While the process involves multiple components, following the instructions systematically will ensure correct setup. It is recommended to have a clear, flat workspace and the necessary tools readily available.

General Assembly Steps:

1. **Unpack Components:** Carefully remove all parts from the packaging and verify against the parts list (not provided in this manual, refer to manufacturer's included documentation).
2. **Assemble Frame:** Connect the main frame components, ensuring all bolts and nuts are securely fastened.
3. **Attach Wheels:** Mount the 10-inch flat-free wheels to the axle, ensuring they rotate freely.
4. **Install Hopper:** Secure the 100 lb. capacity poly hopper to the frame.
5. **Mount Spiker/Agitator Assembly:** Install the galvanized steel spike disks and agitator mechanism. Ensure the chain drive system is correctly aligned and tensioned.
6. **Attach Control Handles:** Secure the steel lift handle and flow control lever to the appropriate positions.
7. **Final Checks:** Before use, double-check all connections for tightness and ensure all moving parts operate smoothly without binding.



Figure 2: Front view, showing the hopper and wheel assembly.



Figure 3: Side view, highlighting the overall structure and handle.



Figure 4: Rear view, showing the tow hitch and spiker mechanism.

4. OPERATION

Proper operation of your spiker/seeder/drop spreader ensures effective lawn care and extends the life of the unit. This section outlines the steps for preparing and using the equipment.

Preparing for Operation:

1. **Attach to Tractor:** Securely attach the spreader to the hitch of your lawn or garden tractor. Ensure the hitch pin is properly inserted and secured.
2. **Load Material:** Fill the 100 lb. capacity hopper with your desired material (seed, fertilizer, salt, or ice melt). Do not overfill.



Figure 5: The hopper filled with grass seed, ready for spreading.

3. **Set Flow Rate:** Adjust the flow control lever to the desired setting based on the material type and desired application rate. Refer to the material manufacturer's recommendations for specific settings.



Figure 6: Detailed view of the flow setting dial on the spreader.



Figure 7: A user adjusting the flow setting lever for precise material distribution.

4. **Adjust Spiker Height:** Use the steel lift handle to raise or lower the spike disks. For aeration, ensure the spikes are engaged with the ground. For spreading only, the spikes can be disengaged if preferred, though simultaneous aeration and spreading is a key feature.

Operating the Spreader:

- **Start Movement:** Begin moving the towing vehicle at a consistent, moderate speed. The agitator and spiker disks are driven by the wheels, so movement is necessary for operation.
- **Engage Spreading:** Once moving, open the flow gate using the control lever to begin spreading material.
- **Maintain Overlap:** For even coverage, overlap each pass slightly. The 32-inch working width provides a good guide.
- **Turning:** Close the flow gate when making turns or stopping to prevent over-application in one area.
- **Emptying:** Continue operating until the hopper is empty or the desired area is covered.

Agri-Fab®
Lawn Care Made Easy®

**100 lb. Tow Drop Spiker/
Seeder/Spreader (45-0543)**

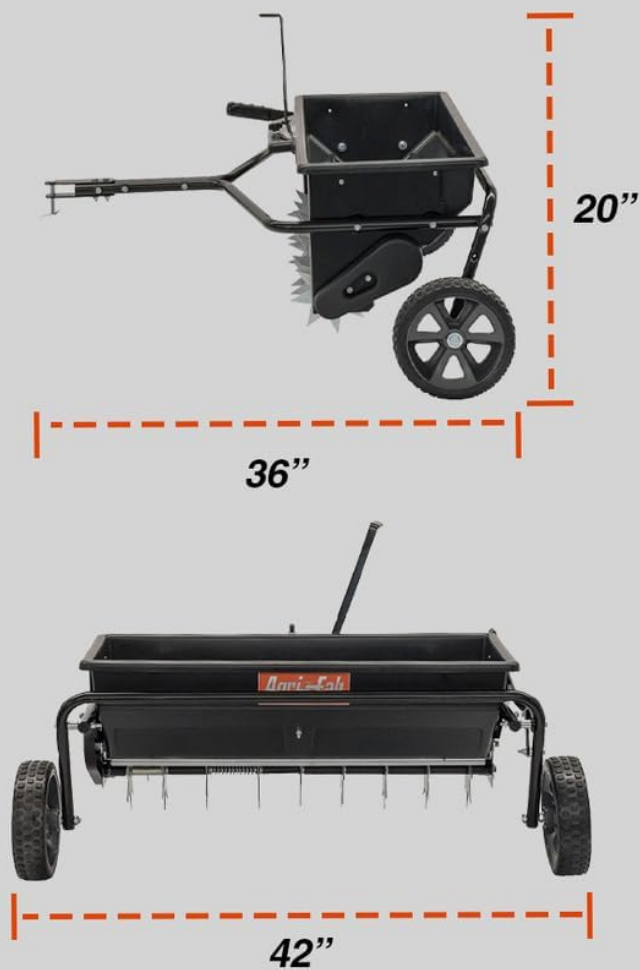

Figure 8: Dimensional diagram of the Agri-Fab Spiker/Seeder/Drop Spreader, indicating its length and width.

Optimal Usage Times:

- **Spring:** Ideal for spreading grass seed over bare areas and initial fertilization.
- **Summer:** Use for additional fertilization and feeding as needed to enhance growth.

- **Fall/Winter:** Effective for spreading salt or ice melt on pathways and driveways.

5. MAINTENANCE

Regular maintenance is crucial for the longevity and optimal performance of your Agri-Fab Spiker/Seeder/Drop Spreader.

After Each Use:

- **Clean Thoroughly:** Empty any remaining material from the hopper. Rinse the hopper and all spreading components with water to prevent corrosion and material buildup. Ensure all parts are dry before storage.
- **Inspect Spikes and Agitator:** Check the galvanized spike disks and agitator for any damage, bending, or excessive wear. Clean off any debris.
- **Lubricate:** Apply a light coat of lubricant to all moving parts, including the axle, chain, and pivot points of the control levers, to ensure smooth operation and prevent rust.

Seasonal Maintenance:

- **Check Fasteners:** Periodically check all nuts, bolts, and fasteners for tightness and re-tighten as necessary.
- **Inspect Tires:** Examine the 10-inch flat-free tires for any signs of wear or damage.
- **Storage:** Store the unit in a clean, dry area, protected from the elements. If storing for an extended period, ensure it is thoroughly cleaned and lubricated.

6. TROUBLESHOOTING

This section provides solutions to common issues you might encounter with your spiker/seeder/drop spreader.

Problem	Possible Cause	Solution
Material not spreading or uneven spread.	<ul style="list-style-type: none">• Flow gate closed or obstructed.• Agitator or chain mechanism jammed/broken.• Material is clumping or wet.• Incorrect flow setting.	<ul style="list-style-type: none">• Ensure flow gate is open and clear of debris.• Inspect agitator and chain for binding or damage. Clear any obstructions.• Break up clumps or use dry material.• Adjust flow setting according to material type.
Spiker disks not penetrating ground.	<ul style="list-style-type: none">• Ground is too hard/dry.• Insufficient weight on the unit.• Spiker height not adjusted correctly.	<ul style="list-style-type: none">• Water the lawn before aerating.• Add additional weight to the hopper (e.g., sandbags, bricks) over the axle, ensuring not to exceed the unit's capacity or stability.• Ensure the steel lift handle is set to lower the spikes sufficiently.

Problem	Possible Cause	Solution
Unit is difficult to pull or wheels are binding.	<ul style="list-style-type: none"> Axle or wheel bearings need lubrication. Debris wrapped around axle or wheels. Overloaded hopper. 	<ul style="list-style-type: none"> Lubricate axle and wheel bearings. Clear any grass, string, or other debris from around the axle and wheels. Reduce the amount of material in the hopper.

7. SPECIFICATIONS

Feature	Detail
Model Number	45-05431
Capacity	100 lb.
Working Width	32 inches
Spike Disks	8 galvanized steel
Tires	10-inch Flat-Free
Material	Metal, Polypropylene
Finish Type	Painted
Item Weight	45.9 pounds
Manufacturer	Agri-Fab Inc.
UPC	052613161937

8. WARRANTY AND SUPPORT

Warranty Information:

The Agri-Fab 100 lb. Tow Spiker/Seeder/Drop Spreader (Model #45-05431) comes with a **3-Year Limited Warranty**. This warranty covers defects in materials and workmanship under normal use and service. Please retain your proof of purchase for warranty claims.

For specific warranty terms and conditions, please refer to the warranty card included with your product or visit the official Agri-Fab website.

Customer Support:

If you have any questions regarding assembly, operation, maintenance, or troubleshooting that are not covered in this manual, please contact Agri-Fab customer support.

- **Website:** Visit the official Agri-Fab website for FAQs, product registration, and additional resources.
- **Phone:** Refer to the contact information provided on the product packaging or the Agri-Fab website for customer service phone numbers.
- **Parts:** For replacement parts, please have your model number (45-05431) and the part number ready when contacting support.

Note: Always use genuine Agri-Fab replacement parts to ensure compatibility and maintain product warranty.

Related Documents

<div></div>	<div><h3>Agri-Fab 45-0547 Spreader: Owner's Manual and Parts List</h3><p>Comprehensive guide for the Agri-Fab 45-0547 lawn spreader, including safety instructions, operation procedures, maintenance tips, application chart, and a detailed parts list.</p></div>
<div></div>	<div><h3>Agri-Fab 45-0575 Push Broadcast Spreader Manual</h3><p>This document provides instructions, safety information, and maintenance guidelines for the Agri-Fab 45-0575 Push Broadcast Spreader.</p></div>
<div></div>	<div><h3>Agri-Fab 45-0463 130 lb. Tow Spreader Assembly and Operation Manual</h3><p>This manual provides assembly instructions, safety rules, operation guidelines, and maintenance procedures for the Agri-Fab 45-0463 130 lb. Tow Spreader. Learn how to properly assemble, use, and maintain your spreader for optimal lawn care.</p></div>
<div></div>	<div><h3>Agri-Fab 45-0527 Tow Spreader Owner's Manual</h3><p>Comprehensive guide for the Agri-Fab 45-0527 tow spreader, covering safety information, assembly instructions, operation procedures, maintenance tips, and application charts for various materials. Learn how to properly use, store, and maintain your Agri-Fab spreader for optimal lawn care.</p></div>



[pdf] User Manual Parts List Guide

Manual Downloadable Manuals and Parts Lists 45 05431 agri fab Portals 0 |||

Want more information or assembly tips Video Instruction Guide

youtube.com/c/agrifab **45-05431** 32 POLY SPIKER/SPREADER

.....4

ESPAOL.....13 ENGLISH.....

lang:en score:46 filesize: 3.5 M page_count: 20 document date: 2021-09-20

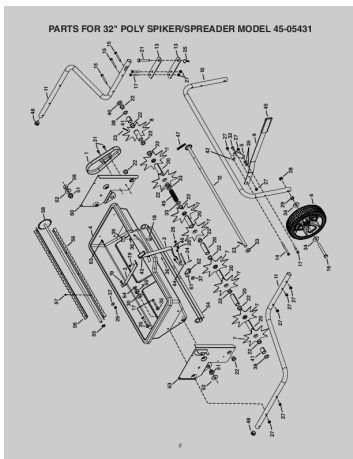

[pdf] User Manual

MANUAL Agri Fab® Tow Drop Spiker Seeder Spreader 100 Lbs 36 L x 42 W 20 H Black B3082248

GLOBALindustrial ca Manual 1 static globalindustrial products 105284 agri fab inc |||

PARTS FOR 32 POLY SPIKER/SPREADER MODEL **45-05431** 2 48 27 27 48 58 11

57 52 53 52 51 22 38 41 22 56 56 60 59 51 55 63 4 1 31 15 26 35 37 19 39 64 3 30 17

43 50 19 36 35 36 2 44 26 26 46 61 24 26 18 22 33 49 22 40 23 38 41 22 22 17 22 22

8 22 20 7 33 47 27...

lang:i-klngon score:31 filesize: 405.4 K page_count: 2 document date: 2021-09-20



[pdf] User Manual Guide

Product Manual 450543 by Agri Fab 100 lb Tow Drop Spiker Seeder Spreader 45 0543 Grebe s

frvevwloboow images webfronts cache |||

Want more information or assembly tips Video Instruction Guide

youtube.com/c/agrifab **45-05431** 32 POLY SPIKER/SPREADER

.....4

ESPAOL.....13 ENGLISH.....

lang:en score:29 filesize: 3.71 M page_count: 20 document date: 2018-10-31



[\[pdf\]](#) User Manual Owner's Manual Instructions

45 05431 32 POLY SPIKER SPREADER 45941 1 OWNER 39 S MANUAL 4 RULES FOR SAFE OPERATIONS Read this owner s manual before attempting to assemble or operate the spiker spreader towing vehicle and know how tractor using attachment 330759517 AssemblyInstructions frCA cdn rona ca webassets manuals Do not allow anyone ride on sit Never children

45-05431 32 POLY SPIKER/SPREADER4

Español.....13

ENGLISH.....6

français.....

lang:en score:28 filesize: 3.42 M page_count: 20 document date: 2020-03-25

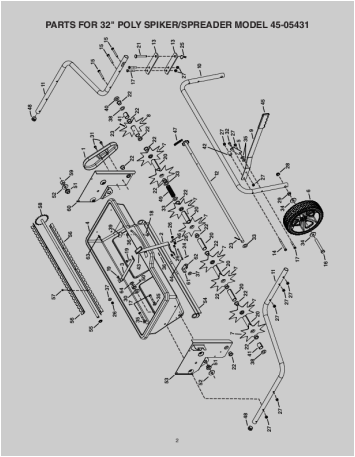

[\[pdf\]](#) Parts List

Parts List 450543 by Agri Fab 100 lb Tow Drop Spiker Seeder Spreader 45 0543 Grebe s frmejtepbnqj images webfronts cache |||

PARTS FOR 32 POLY SPIKER/SPREADER MODEL 45-05431 2 48 27 27 48 58 11 57 52 53 52 51 22 38 41 22 56 56 60 59 51 55 63 4 1 31 15 26 35 37 19 39 64 3 30 17 43 50 19 36 35 36 2 44 26 26 46 61 24 26 18 22 33 49 22 40 23 38 41 22 22 17 22 22 8 22 20 7 33 47 27...

lang:i-klngon score:19 filesize: 489 K page_count: 2 document date: 2021-09-20