

xTool P5010215

xTool F1 Desktop Smoke Air Purifier Instruction Manual

1. PRODUCT OVERVIEW

The xTool F1 Desktop Smoke Air Purifier is designed exclusively for use with the xTool F1 Laser Engraver. It features a 3-layer filtration system to effectively remove fumes, smoke, and odors generated during laser engraving processes. This unit ensures a cleaner and safer working environment by achieving a 99.97% purification rate.

The purifier is pre-assembled for easy setup and offers intelligent synchronization with the xTool F1 Laser Engraver, starting and stopping automatically with the engraving process. Its compact and portable design, combined with quiet operation (below 55dB), makes it suitable for various indoor environments.

Filter out 99.97% of the Smoke and Dirt

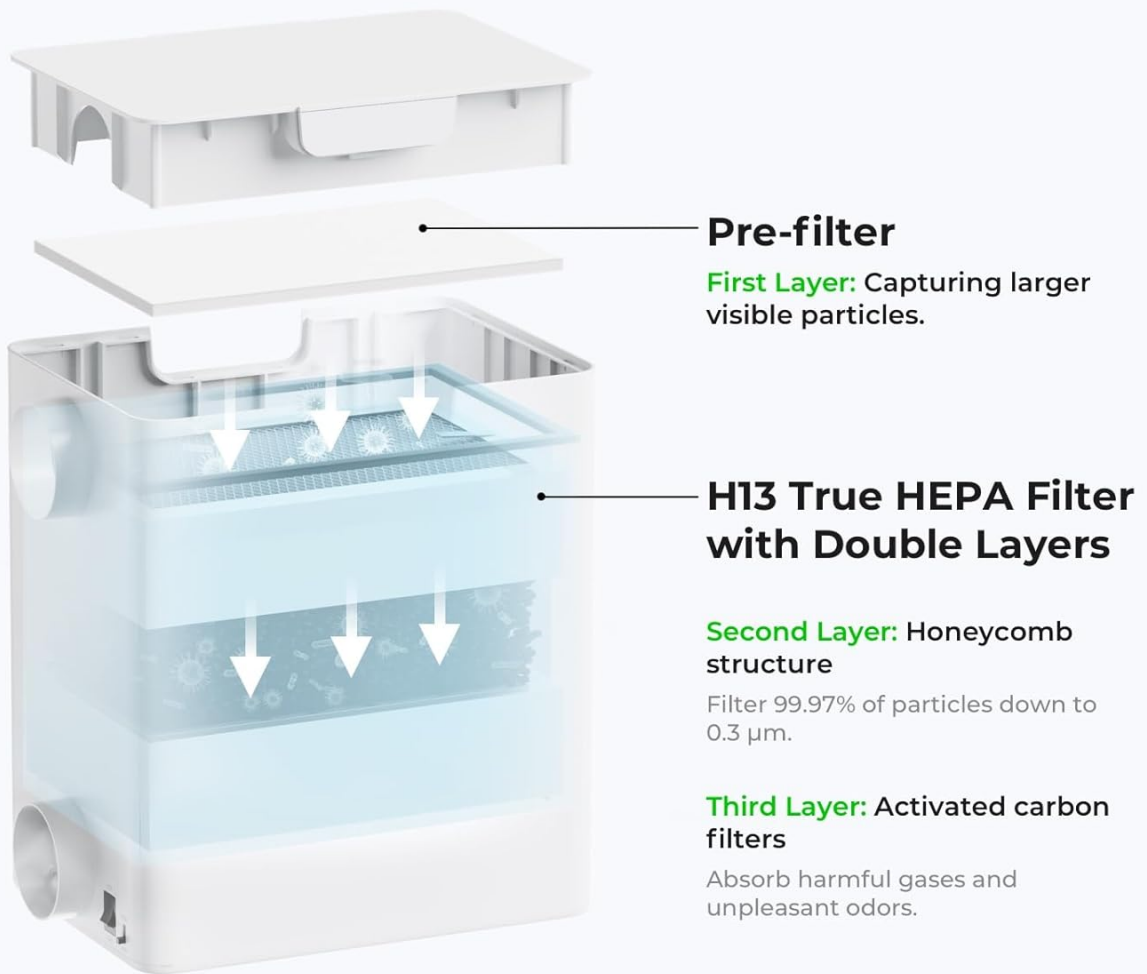

Figure 1.1: The xTool F1 Desktop Smoke Air Purifier, a compact white unit designed for fume extraction.



Figure 1.2: Key features of the xTool Desktop Smoke Air Purifier, highlighting its 3-layer filtration, quiet operation, portability, and adjustable levels.

2. SETUP

2.1 Package Contents

Before beginning setup, ensure all components are present in the package:

- Desktop smoke purifier unit
- Filter pack (pre-filter, H13 HEPA filter, activated carbon filter)
- Hose for fume extraction
- Pipe adapter
- Power adapter & power cable
- USB cable (Type-C)
- User manual

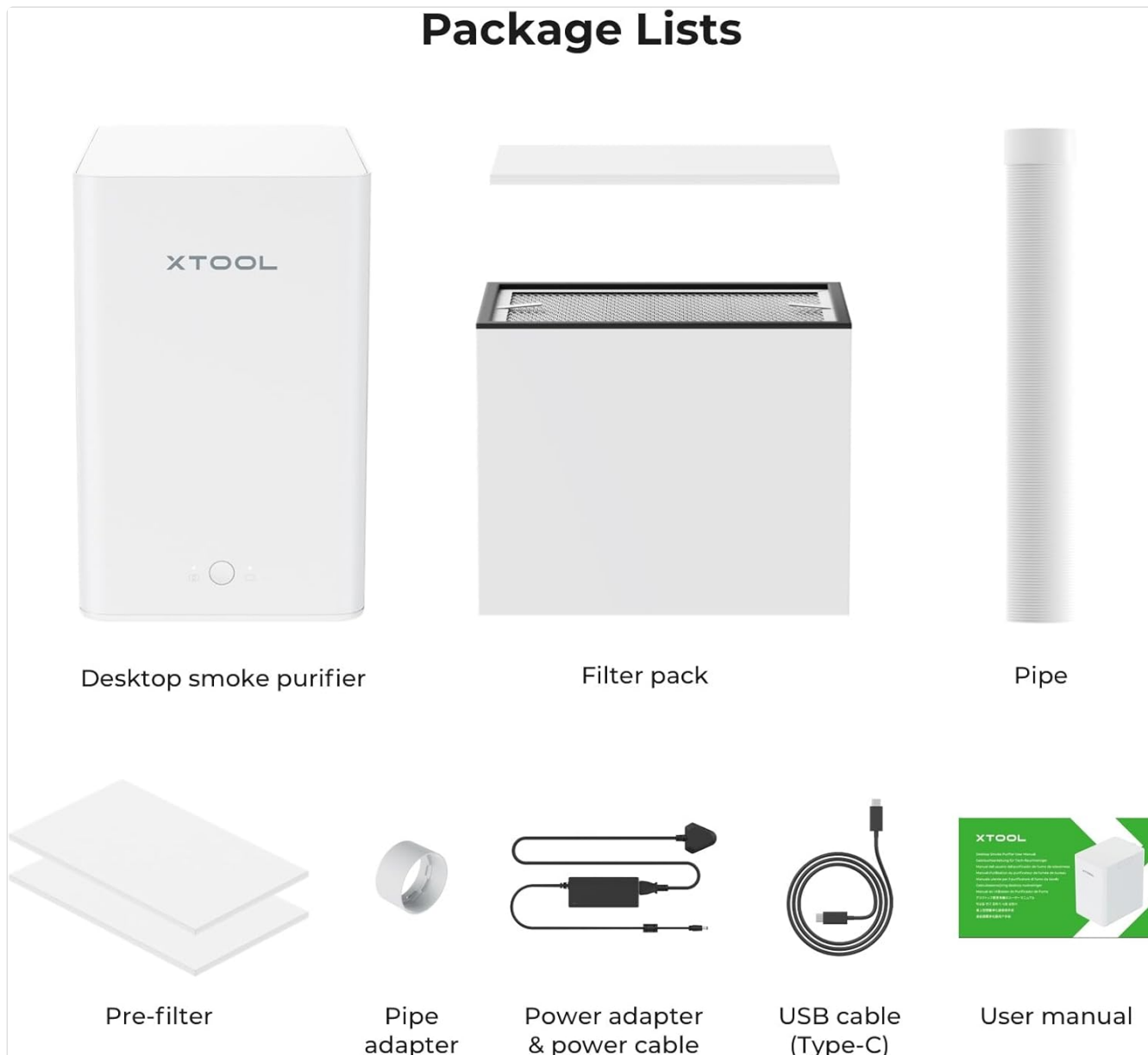

Figure 2.1: Visual representation of all items included in the xTool F1 Desktop Smoke Air Purifier package.

2.2 Connecting the Purifier

1. Connect the provided hose to the exhaust port on the rear of the smoke air purifier.
2. Connect the other end of the hose to the xTool F1 Laser Engraver's exhaust port.
3. Plug the power adapter into the purifier and then into a power outlet.
4. Connect the USB-C cable from the purifier to the xTool F1 Laser Engraver for synchronization.



Figure 2.2: Connection diagram for one-click synchronization between the xTool F1 Laser Engraver and the smoke purifier.

3. OPERATING INSTRUCTIONS

3.1 Powering On and Synchronization

Once connected, the smoke air purifier will automatically synchronize with your xTool F1 Laser Engraver. It will start extracting fumes when the engraver begins processing and stop shortly after the engraving process is complete.



Figure 3.1: The smoke air purifier operating in sync with the xTool F1 Laser Engraver.

3.2 Adjusting Fan Speed

The purifier features a switch to adjust the fan speed between minimum and maximum settings. Select the appropriate speed based on the material being engraved and the intensity of fumes produced.



Figure 3.2: Fan speed adjustment switch on the side of the purifier.

3.3 Setting Working Time

You can customize the purifier's working time through the xTool Creative Space software. This allows you to extend the purification duration for materials that produce strong smoke or odors, ensuring thorough air cleaning.

4. MAINTENANCE

4.1 Filter Replacement

The xTool F1 Desktop Smoke Air Purifier utilizes a 3-layer filtration system consisting of a pre-filter, an H13 HEPA filter, and an activated carbon filter. Regular replacement of these filters is crucial for maintaining optimal purification performance.

The pre-filter should be replaced after approximately 3 pieces are used. The main filtration kit (HEPA and activated carbon) should be replaced periodically based on usage and material types. The intelligent design allows for simple, tool-free filter replacement.

1. Press the button on the top of the unit and remove the lid.
2. Carefully take out the used filtration kit by pulling on the attached ribbons.
3. Insert the new filtration kit into the unit, ensuring it sits securely.
4. Press the lid down firmly until it clicks into place.

4 Steps to Replace the Filter



1. Press the button then remove the lid



2. Take out the used filtration kit



3. Put the new filtration kit



4. Press the lid down and start to use

Figure 4.1: Step-by-step guide for replacing the filter in the smoke air purifier.



Figure 4.2: Inserting the new filtration kit into the purifier.

4.2 Filter System Overview

The 3-layer system includes:

- **Pre-filter:** Captures larger visible particles.
- **H13 True HEPA Filter with Double Layers:** Filters 99.97% of particles down to 0.3 μm .
- **Activated Carbon Filters:** Absorbs harmful gases and unpleasant odors.



Figure 4.3: Detailed view of the 3-layer filtration system.

5. TROUBLESHOOTING

For common issues, refer to the following table:

Problem	Possible Cause	Solution
Purifier not turning on	Power cable disconnected; xTool F1 not powered on or connected.	Ensure all power and USB cables are securely connected. Verify xTool F1 is powered on.
Ineffective fume extraction/strong odor	Clogged filters; incorrect fan speed; loose hose connection.	Check and replace filters if dirty. Adjust fan speed to 'max'. Ensure hose connections are tight.
Unusual noise during operation	Obstruction in fan; unit not on a stable surface.	Inspect fan for any foreign objects. Place the purifier on a flat, stable surface.

6. SPECIFICATIONS

- **Product Dimensions:** 18.11 x 10.24 x 16.93 inches; 13.23 Pounds (or 1.5"D x 0.85"W x 1.4"H; 6 Kilograms)
- **Item Model Number:** P5010215
- **Manufacturer:** Makeblock Co., Ltd.
- **Color:** White
- **Power Source:** AC
- **Noise Level:** No more than 55dB
- **Filtration System:** 3-layer (Pre-filter, H13 HEPA, Activated Carbon)
- **Purification Rate:** 99.97%

7. WARRANTY AND SUPPORT

xTool provides a strong warranty and friendly customer service for this air purifier. For detailed warranty information or to contact customer support, please visit the official xTool store or refer to the contact information provided in your user manual.

Your browser does not support the video tag.

Video 7.1: A review of the xTool Air Purifier HEPA Filter, demonstrating its features and filter replacement process.

For additional resources and community support, you may explore the xTool store [xTool Official Store](#)