

## Luceco LEXS95W65-01

# Luceco Batten LED Solaire Multifonction 950 Im 10W Instruction Manual

Model: LEXS95W65-01

## 1. INTRODUCTION

Thank you for choosing the Luceco Batten LED Solaire Multifonction. This instruction manual provides essential information for the safe and efficient installation, operation, and maintenance of your new solar-powered LED light. Please read this manual thoroughly before use and retain it for future reference.

## 2. SAFETY INFORMATION

- Ensure all electrical connections are secure and protected from moisture.
- Do not attempt to open or modify the product. This may void the warranty and pose a safety risk.
- Keep the solar panel and LED batten away from flammable materials.
- Avoid direct eye exposure to the LED light when it is illuminated.
- Dispose of the product and its components responsibly according to local regulations at the end of its lifespan.

## 3. PACKAGE CONTENTS

Please check the package for the following items:

- Luceco Batten LED Light Unit (1)
- Solar Panel (1)
- Connecting Cable (1)
- Mounting Screws and Wall Plugs (Set)

## 4. PRODUCT OVERVIEW

The Luceco Batten LED Solaire Multifonction consists of an LED light batten and a separate solar panel, designed for versatile lighting solutions. The batten features an integrated motion sensor and control buttons for various operating modes.



**Figure 4.1:** Luceco Batten LED light unit and solar panel connected by a cable. This image displays the complete Luceco Batten LED Solaire Multifonction system, featuring the LED light batten and its accompanying solar panel, connected by a black cable. The batten unit is white with a translucent light cover, and the solar panel is black with a dark frame.



**Figure 4.2:** Top-down view of Luceco Batten LED light and solar panel. A top-down perspective of the Luceco Batten LED light and solar panel. The solar panel is positioned above the batten, which shows its integrated motion sensor and control buttons.

## 5. SETUP AND INSTALLATION

---

### 5.1 Mounting the Solar Panel

Choose a location for the solar panel that receives maximum direct sunlight throughout the day. Avoid shaded areas. The panel should be angled to optimize sun exposure, typically facing south (in the Northern Hemisphere) at an angle matching your latitude.

### 5.2 Mounting the LED Batten

The LED batten can be mounted on a wall or ceiling using the provided screws and wall plugs. Ensure the mounting surface is suitable to support the weight of the unit. The batten features integrated mounting brackets on its rear for secure attachment.



**Figure 5.1:** Side view of Luceco Batten LED light showing charging port and controls. Close-up side view of the Luceco Batten LED light unit, highlighting the charging port, power button, and motion sensor on its white casing.



**Figure 5.2:** Rear view of Luceco Batten LED light showing mounting brackets. This image shows the rear of the Luceco Batten LED light, revealing the integrated mounting brackets and screw holes designed for secure installation.



**Figure 5.3:** Mounting hardware including screws and wall anchors. A collection of mounting hardware provided with the product, consisting of various screws and wall plugs for different installation surfaces.

### 5.3 Connecting the Components

Connect the cable from the solar panel to the designated input port on the LED batten. Ensure the connection is firm. For optimal performance, allow the unit to charge for at least 8-10 hours in direct sunlight before initial use.

## 6. OPERATING INSTRUCTIONS

---

### 6.1 Powering On/Off

Locate the power button on the LED batten. Press and hold for a few seconds to turn the unit on or off. Short presses may cycle through different operating modes.

### 6.2 Operating Modes

The batten LED light features multiple functions, including a motion sensor. Specific modes may include:

- **Motion Sensor Mode:** The light will activate at full brightness when motion is detected in low light conditions and turn off after a set period of no motion.
- **Constant Light Mode:** The light remains on at a set brightness level.
- **Dim Light + Motion Mode:** The light stays on at a dim level and brightens upon motion detection.

Refer to the markings near the control buttons for specific mode selection instructions.

### 6.3 Charging Indicators

Small LED indicator lights on the batten unit display the charging status and battery level. Refer to these indicators to monitor the unit's power status.

### 6.4 Power Bank Functionality

The Luceco Batten LED light can also serve as a power bank to charge other devices via its USB output port.



**Figure 6.1:** Luceco Batten LED light charging a smartphone via USB port. The Luceco Batten LED light unit is shown connected to a smartphone via a USB cable, demonstrating its capability to function as a power bank. The batten's indicator lights are visible.

## 7. MAINTENANCE

---

### 7.1 Cleaning the Solar Panel

Regularly clean the surface of the solar panel with a soft, damp cloth to remove dust, dirt, and debris. A clean panel ensures maximum sunlight absorption and charging efficiency. Do not use abrasive cleaners or harsh chemicals.

### 7.2 Cleaning the LED Batten

Wipe the LED batten with a soft, dry, or slightly damp cloth. Avoid getting water into the ports or control

buttons. Do not use solvents or strong cleaning agents.

### 7.3 Battery Care

To prolong the life of the internal battery, ensure the unit receives adequate sunlight for charging. If storing the unit for an extended period, ensure it is fully charged before storage and recharge it periodically.

## 8. TROUBLESHOOTING

- **Light not turning on:**
  - Ensure the unit is fully charged. Place the solar panel in direct sunlight for a full day.
  - Check that the solar panel is correctly connected to the batten unit.
  - Verify that the power button has been pressed to turn the unit on.
  - Ensure it is dark enough for the light to activate in motion sensor modes.
- **Light not charging:**
  - Confirm the solar panel is in direct sunlight and not obstructed by shade or dirt.
  - Check the connection cable between the solar panel and the batten for damage or loose connections.
- **Motion sensor not working:**
  - Ensure the unit is in a motion-sensing mode.
  - Check for obstructions in front of the sensor.
  - Verify that the ambient light conditions are dark enough for the sensor to activate.

## 9. SPECIFICATIONS



Feature	Specification
Brand	Luceco
Model Number	LEXS95W65-01
Manufacturer	Luceco UK Ltd
Dimensions (L x W x H)	1.7 x 24.8 x 34.9 cm
Weight	1.98 kilograms
Power Source	Solar Powered
Power	10 Watts
Luminosity	950 lm
Light Type	LED
Color Temperature	6500K
Light Color	Daylight White
Components Included	LED Batten Light, Solar Panel

## 10. WARRANTY AND SUPPORT

For warranty information and technical support, please refer to the documentation provided with your purchase or contact Luceco customer service directly. Keep your proof of purchase for any warranty claims.

© 2023 Luceco. All rights reserved.

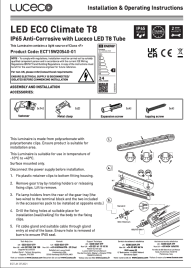
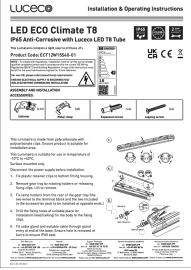
### Related Documents - LEXS95W65-01

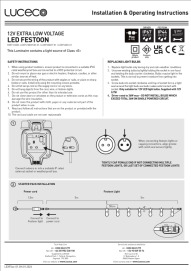
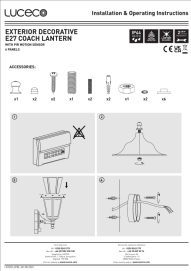
	<p><a href="#">Luceco LED ECO Climate T8 IP65 Anti-Corrosive Luminaire: Installation &amp; Operating Instructions</a></p> <p>Detailed installation and operating guide for the Luceco LED ECO Climate T8 IP65 anti-corrosive luminaire. Covers assembly, mounting, wiring, component replacement, warranty, and safety information.</p>
	<p><a href="#">Luceco LED ECO Climate T8 IP65 Installation &amp; Operating Instructions</a></p> <p>Detailed installation and operating instructions for the Luceco LED ECO Climate T8 IP65 anti-corrosive luminaire, including assembly, wiring, and component replacement guidance.</p>
	<p><a href="#">Instructions d'installation et d'utilisation du Projecteur LED Portatif 50W Luceco (LW50BG2, LW50BG2J)</a></p> <p>Guide complet pour l'installation et l'utilisation du projecteur LED portatif 50W Luceco. Inclut les références LW50BG2 et LW50BG2J, informations de montage, fonctionnement et garantie.</p>
	<p><a href="#">Luceco 12V LED Festoon Lights Installation &amp; Operating Instructions   LEXFS Series</a></p> <p>Get detailed installation and operating instructions for Luceco 12V Extra Low Voltage LED Festoon lights (LEXFS10B27UK-01, LEXFS5B27-01, LEXFS3EX-01). Learn about safety, bulb replacement, and connection methods for your outdoor lighting.</p>
	<p><a href="#">Luceco Exterior Decorative E27 Coach Lantern with PIR Motion Sensor - Installation &amp; Operating Instructions</a></p> <p>Comprehensive installation and operating instructions for the Luceco Exterior Decorative E27 Coach Lantern, featuring a PIR motion sensor. Includes accessory list, step-by-step guidance, and technical support information.</p>



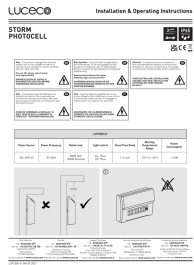

## Luceco Storm Photocell LSPC500-01 Installation and Operating Instructions

Comprehensive installation and operating guide for the Luceco Storm Photocell (LSPC500-01). This IP65 rated outdoor light sensor is designed for domestic use and features a 3-year warranty. Includes technical specifications, step-by-step installation instructions with diagram descriptions, and contact information.