

MOES MT-WP-EU-MS

MOES 16A Smart Plug with Energy Monitoring User Manual

Model: MT-WP-EU-MS

INTRODUCTION

Thank you for choosing the MOES 16A Smart Plug with Energy Monitoring. This smart plug is designed to enhance your home automation experience by allowing you to control connected devices remotely, monitor energy consumption, and integrate with popular smart home platforms like Apple HomeKit, Amazon Alexa, and Google Home. Please read this manual carefully before use to ensure proper installation and operation.

SAFETY INFORMATION

- Do not disassemble or modify the device.
- Keep the device away from water, fire, and high humidity environments.
- Ensure the connected appliance's power consumption does not exceed the smart plug's maximum rating (16A, 3680W).
- This device is intended for indoor use only.
- For safety, do not connect multiple smart plugs in series.

PRODUCT OVERVIEW

The MOES Smart Plug features a compact design with essential controls and indicators.



MOES MATTER Steckdose

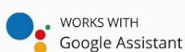
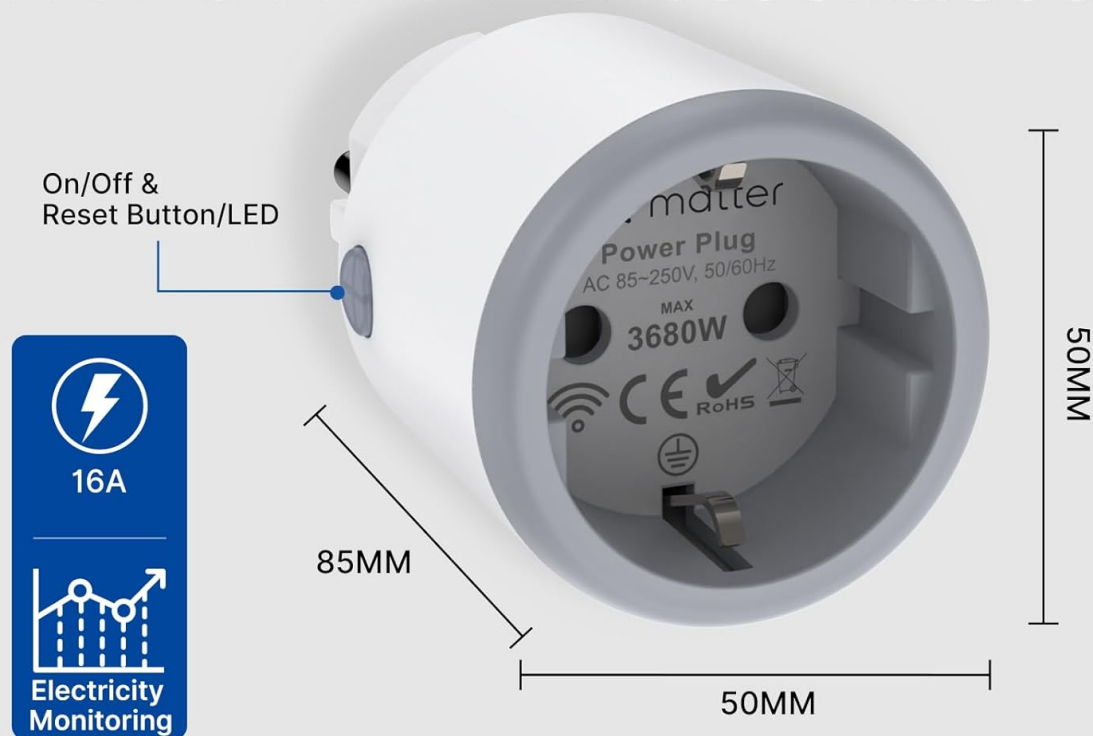

Image 1: Front and side view of the MOES Smart Plug, highlighting the On/Off & Reset Button/LED, 16A current rating, electricity monitoring feature, and dimensions (85mm length, 50mm width, 50mm height). The plug supports AC 85-250V, 50/60Hz, with a maximum power of 3680W.

- **On/Off & Reset Button/LED:** Press to manually turn the plug on or off. Press and hold for several seconds to initiate pairing mode or factory reset. The LED indicates the plug's status (e.g., solid for on, blinking for pairing).
- **Power Rating:** Supports up to 16 Amperes and 3680 Watts.
- **Electricity Monitoring:** Tracks real-time and historical power consumption of connected devices.

SETUP

1. Initial Plug-in

1. Plug the MOES Smart Plug into a standard wall outlet.
2. The LED indicator will start blinking, indicating it's in pairing mode. If not, press and hold the On/Off & Reset button for 5 seconds until it blinks rapidly.

2. App Installation and Pairing

The MOES Smart Plug supports multiple smart home ecosystems. Choose your preferred method:

For Apple HomeKit:

- Open the Apple Home app on your iOS device (iOS 16.0 or above required).
- Tap the "+" icon and select "Add Accessory."
- Scan the HomeKit setup code located on the smart plug or its packaging.
- Follow the on-screen instructions to complete the pairing process.

For Amazon Alexa / Google Home (via Tuya Smart or MOES App):

First, install the Tuya Smart app or MOES app on your smartphone (Android 8.1+ or iOS 16.0+).

1. Download the "Tuya Smart" or "MOES" app from the App Store or Google Play Store.
2. Register or log in to your account.
3. Tap the "+" icon in the app to add a new device.
4. Select "Electrical Outlet" or "Smart Plug" from the device list.
5. Confirm the LED indicator is blinking rapidly. If not, reset the plug.
6. Enter your 2.4GHz Wi-Fi network credentials. *Note: The plug may not connect to 5GHz Wi-Fi networks. If you experience issues, temporarily disable 5GHz on your router during setup.*
7. Follow the in-app instructions to complete the pairing.
8. Once paired with the Tuya Smart/MOES app, you can link it to Alexa or Google Home via their respective apps' "Skills" or "Works with Google" sections.

KOMPATIBILITÄT UND NUTZUNGSANFORDERUNGEN

APP	Gateway Devices	APP Version Requirements	Other Requirements
Tuya Smart	No required	V4.7.0 and above	
Home	HomePod, HomePod mini, Apple TV and iPad	IOS 16.0 and above	
Google Home	Speakers: Google Home, Google Home Mini, Nest Mini, Nest Audio Displays: Nest Hub (1st gen), Nest Hub (2nd gen), Nest Hub Max Wi-Fi routers: Nest Wifi Pro (Wi-Fi 6E)	3.0.1.9 and above	Android 8.1 and above Google Play service 22.46.17 and above Bluetooth low power consumption (BLE) 4.2 and above
Amazon Alexa	Echo Dot (5th Gen), Echo Dot (5th Gen) with clock, Echo (4th Gen), Echo Dot (3rd Gen, 2018 release), Echo Studio, Echo Show 8 (2nd Gen, 2021 release), Echo Show 10 (3rd Gen), Echo Show 5 (2nd Gen, 2021 release), Echo Show 15, Echo Dot (Gen 3 with Clock), Echo Dot (Gen 4 with Clock), Echo Show 5, Echo (v3), Echo Dot Gen 4, Echo Input, Echo Flex, Echo Show 8, Echo Plus (V2), Echo Dot (V2), and Echo V2	2.2.536317 and above	
MOES	No required	1.0.4 and above	

Image 2: Compatibility table detailing app versions and gateway device requirements for Tuya Smart, Home (Apple HomeKit), Google Home, Amazon Alexa, and MOES apps. For example, Google Home requires Android 8.1 and above, Google Play service 22.46.17 and above, and Bluetooth Low Energy 4.2 and above.

OPERATING INSTRUCTIONS

Manual Control

Press the physical button on the side of the smart plug to manually turn the connected appliance on or off.

App Control

Use the MOES, Tuya Smart, Apple Home, Google Home, or Amazon Alexa app to remotely control the smart plug from anywhere with an internet connection. You can turn it on/off, set schedules, and monitor energy.



Image 3: Illustration of remote control functionality, showing a mobile phone displaying the MOES app interface controlling various smart devices like lamps, air conditioners, ovens, washing machines, and coffee machines within a home environment.

Voice Control

Integrate with Amazon Alexa or Google Assistant for hands-free control.

- **For Alexa:** Say "Alexa, turn on [device name]" or "Alexa, turn off [device name]".
- **For Google Assistant:** Say "Hey Google, turn on [device name]" or "Hey Google, turn off [device name]".

FREIHÄNDIGE SPRACHSTEUERUNG



Image 4: Depiction of hands-free voice control, showing a user interacting with Amazon Alexa and Google Assistant devices to control the smart plug. Examples include "Google, close the socket" and "Alexa, set the reading mode."

Scheduling and Timers

Set up custom schedules, countdown timers, or random on/off cycles through the app to automate your devices.

PERSONALISIERTE PLANUNG



Zeitplan

Jeden Tag um 18:00 Uhr das Licht einschalten

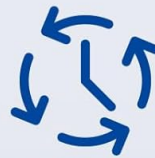

verbreiten

Schalten Sie die Klimaanlage um 20:00 Uhr einschalten, täglich um 8:00 Uhr ausschalten



Verzögerung aus

Jedes Mal, wenn das Fernsehgerät eingeschaltet wird, schaltet es sich nach 3 Stunden automatisch aus

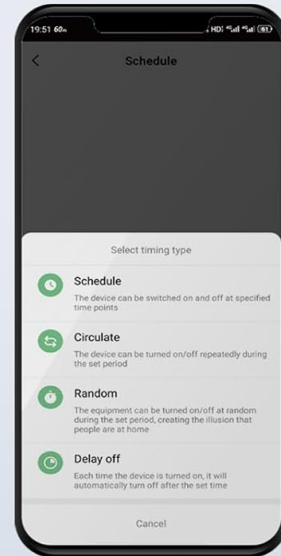

Image 5: Visual representation of personalized scheduling features within the app, including options for setting specific schedules (e.g., turn on lights daily at 18:00), circulating schedules (e.g., turn on AC daily from 20:00 to 8:00), random on/off, and delay-off functions (e.g., TV turns off automatically after 3 hours).

Energy Monitoring

View real-time and historical power consumption data for devices connected to the smart plug within the app. This helps you understand and manage your energy usage.

MAINTENANCE

- Clean the smart plug with a dry, soft cloth. Do not use liquid cleaners.
- Ensure the plug is disconnected from the power outlet before cleaning.
- Avoid exposing the device to extreme temperatures or direct sunlight.

TROUBLESHOOTING

- **Plug not responding:** Ensure the plug is securely inserted into the wall outlet and the power supply is active.
- **Cannot connect to Wi-Fi:**

- Ensure your Wi-Fi network is 2.4GHz. This device may not be compatible with 5GHz networks. Temporarily disable 5GHz on your router during setup if necessary.
- Check your Wi-Fi password.
- Move the smart plug closer to your Wi-Fi router.
- Reset the smart plug by pressing and holding the button for 5 seconds until the LED blinks rapidly, then try pairing again.
- **Voice control not working:**
 - Ensure the smart plug is successfully linked to your Alexa or Google Home account.
 - Check the device name in your smart home app; use this exact name for voice commands.
 - Verify your internet connection.
- **Energy monitoring data incorrect:** Ensure the connected appliance is functioning correctly and the plug is receiving stable power.

SPECIFICATIONS

Model Number	MT-WP-EU-MS
Brand	MOES
Rated Current	16 Ampere
Max Wattage	3680 Watts
Operating Mode	On-off-on
Controller Type	Amazon Alexa, Apple HomeKit, Google Home (via Tuya/MOES App)
Material	Plastic
Item Weight	103 g
Dimensions	9.6 x 5.7 x 5.4 cm

WARRANTY AND SUPPORT

MOES products come with a standard manufacturer's warranty. For specific warranty details, please refer to the warranty card included with your purchase or visit the official MOES website. For technical support, troubleshooting assistance, or any inquiries, please contact MOES customer service through their official channels.

You can visit the MOES store on Amazon for more information:[MOES Store](#)

DISPOSAL INFORMATION

This symbol on the product or its packaging indicates that this product shall not be treated as household waste. Instead, it shall be handed over to the applicable collection point for the recycling of electrical and electronic equipment. By ensuring this product is disposed of correctly, you will help prevent potential negative consequences for the environment and human health, which could otherwise be caused by inappropriate waste handling of this product.

