

Manuals+

[Q & A](#) | [Deep Search](#) | [Upload](#)

[manuals.plus](#) /

› [GameSir](#) /

› [GameSir T4 Cyclone Pro Wireless Pro Controller User Manual](#)

GameSir T4 Cyclone Pro

GameSir T4 Cyclone Pro Wireless Pro Controller User Manual

Brand: GameSir

Model: T4 Cyclone Pro

1. OVERVIEW

The GameSir T4 Cyclone Pro is a versatile wireless pro controller designed for an enhanced gaming experience across multiple platforms. It features advanced Hall Effect technology for precise control and durability, along with customizable options to suit various playstyles. This manual provides detailed instructions for setup, operation, and maintenance of your controller.

This controller is compatible with Windows 10/11, Nintendo Switch/Lite/OLED, macOS, Android, iOS, and Steam Deck. Please note that Xbox consoles are not supported.

2. PACKAGE CONTENTS

- GameSir T4 Cyclone Pro Wireless Controller
- 2.4G Wireless Dongle
- USB-C Cable
- User Manual

3. PRODUCT FEATURES

3.1 Hall Effect Joysticks

Equipped with GameSir Hall Effect joysticks, this controller ensures no dead zone and no drifting, providing consistent and accurate input for precise control during gameplay. These joysticks are designed for long-term durability, rated for up to 5 million cycles.

GAMESIR™ HALL EFFECT STICKS

ANTI-DRIFT

CONTACTLESS SENSING TECH

LAST

UP TO 5 MILLION CYCLES



Figure 1: Internal view of GameSir Hall Effect Joysticks, emphasizing anti-drift and longevity.

3.2 Hall Effect Analog Triggers

The Hall Effect analog triggers offer precise and smooth input with 0.1mm accuracy. Users can switch between regular trigger mode and a fast trigger mode, which is particularly beneficial for games requiring rapid input like FPS or RPG titles.

HALL EFFECT ANALOG TRIGGERS

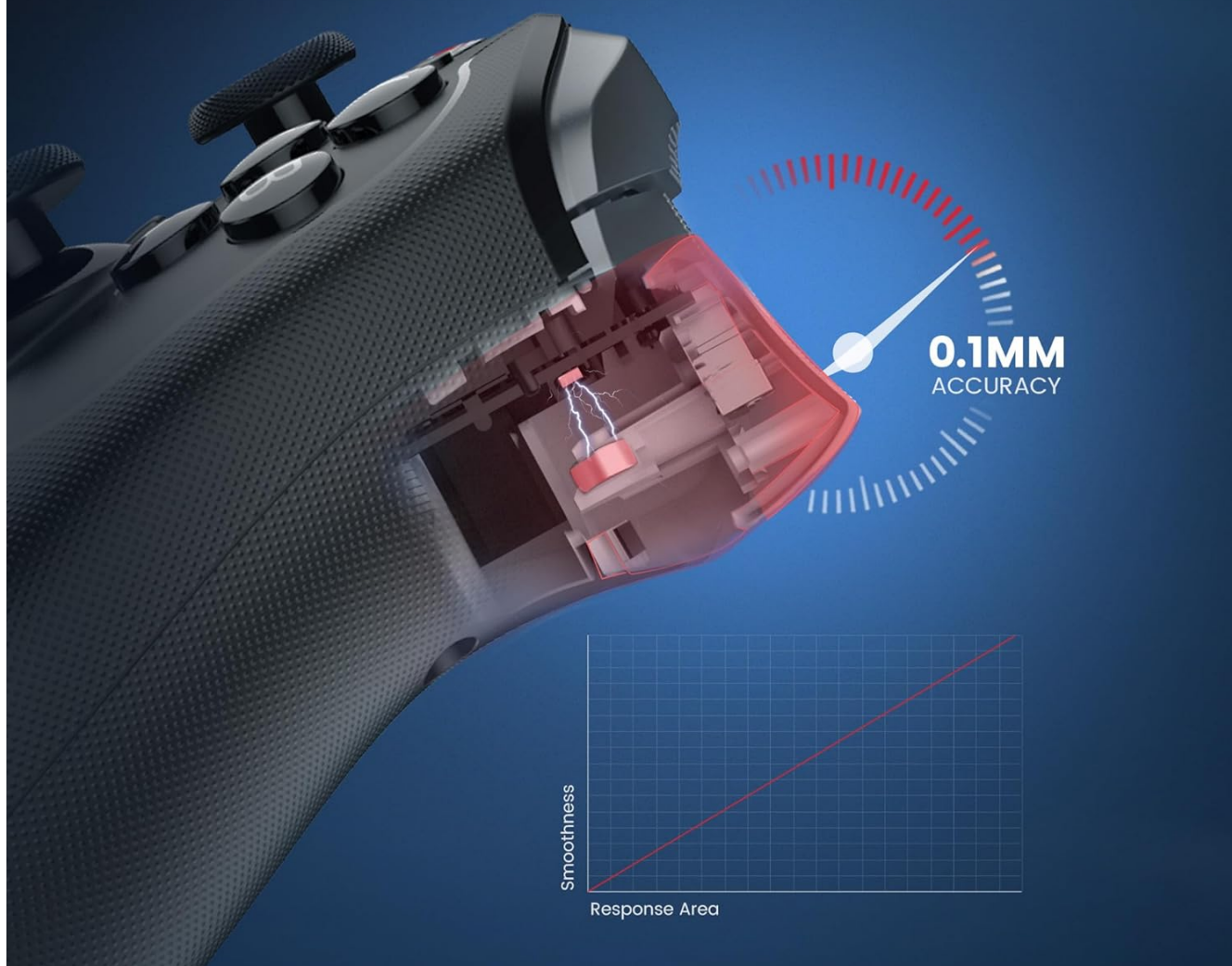

Figure 2: Cross-section view of a Hall Effect Analog Trigger, illustrating its precise response.

3.3 Programmable Macro Back Buttons

Enhance your gameplay with two programmable macro back buttons (L4 and R4). These buttons can be assigned to a single button, a sequence of buttons, or complex combo motions, providing a competitive edge and personalized control.

2 PROGRAMMABLE MACRO BACK BUTTONS



BUTTON MAPPING
L4=A

TURBO
L4=RB+RB+RB

COMBO
L4=LT+RT

FULLY SOFTWARE-CUSTOMIZABLE



Figure 3: Rear view of the controller highlighting the programmable back buttons and their customization options.

3.4 Dual Rumble Motors

The controller features two distinct rumble motors in the grips for strong and subtle vibrations, providing realistic feedback. Additionally, two motors inside the triggers deliver haptic feedback directly to your fingertips. Trigger vibration is supported only in Bluetooth XInput mode.

3.5 Multi-function M Button

The multi-function 'M' button allows seamless control over various settings, including switching between trigger modes, adjusting stick deadzone, changing vibration intensity, and altering the ABXY button layout.

MULTI-FUNCTION M BUTTON FOR CONVENIENT CONTROL

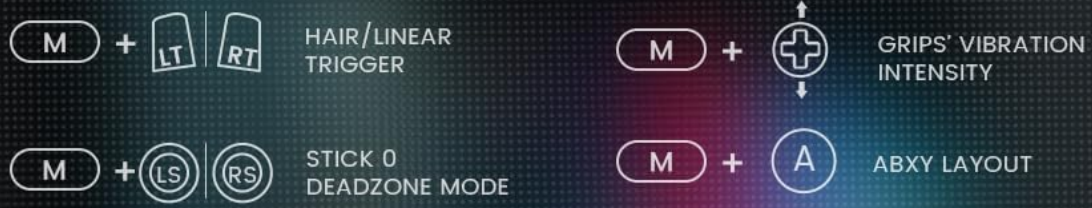

Figure 4: The M button and its various control functions.

3.6 Motion Controls

For Nintendo Switch users, the controller supports interactive motion controls, allowing you to tilt, shake, or rotate the controller to immerse yourself in compatible games.

MOTION CONTROL FOR IMMERSIVE GAMEPLAY



Figure 5: Motion control capabilities for immersive gameplay.

3.7 Tri-Mode Connectivity

The GameSir T4 Cyclone Pro offers flexible connectivity options: Bluetooth, 2.4G wireless receiver, and wired USB-C connection, ensuring compatibility and low latency across various devices.

TRI-MODE CONNECTIVITY



BLUETOOTH



USB-C



LOW-LATENCY
WIRELESS DONGLE



Figure 6: Tri-mode connectivity options for versatile use.

3.8 GameSir App Customization

Unlock extensive customization options for your controller using the GameSir App. This application allows you to customize buttons, adjust stick deadzone, set trigger travel distance, modify vibration intensity, and change the ABXY layout to suit your preferences for different games.

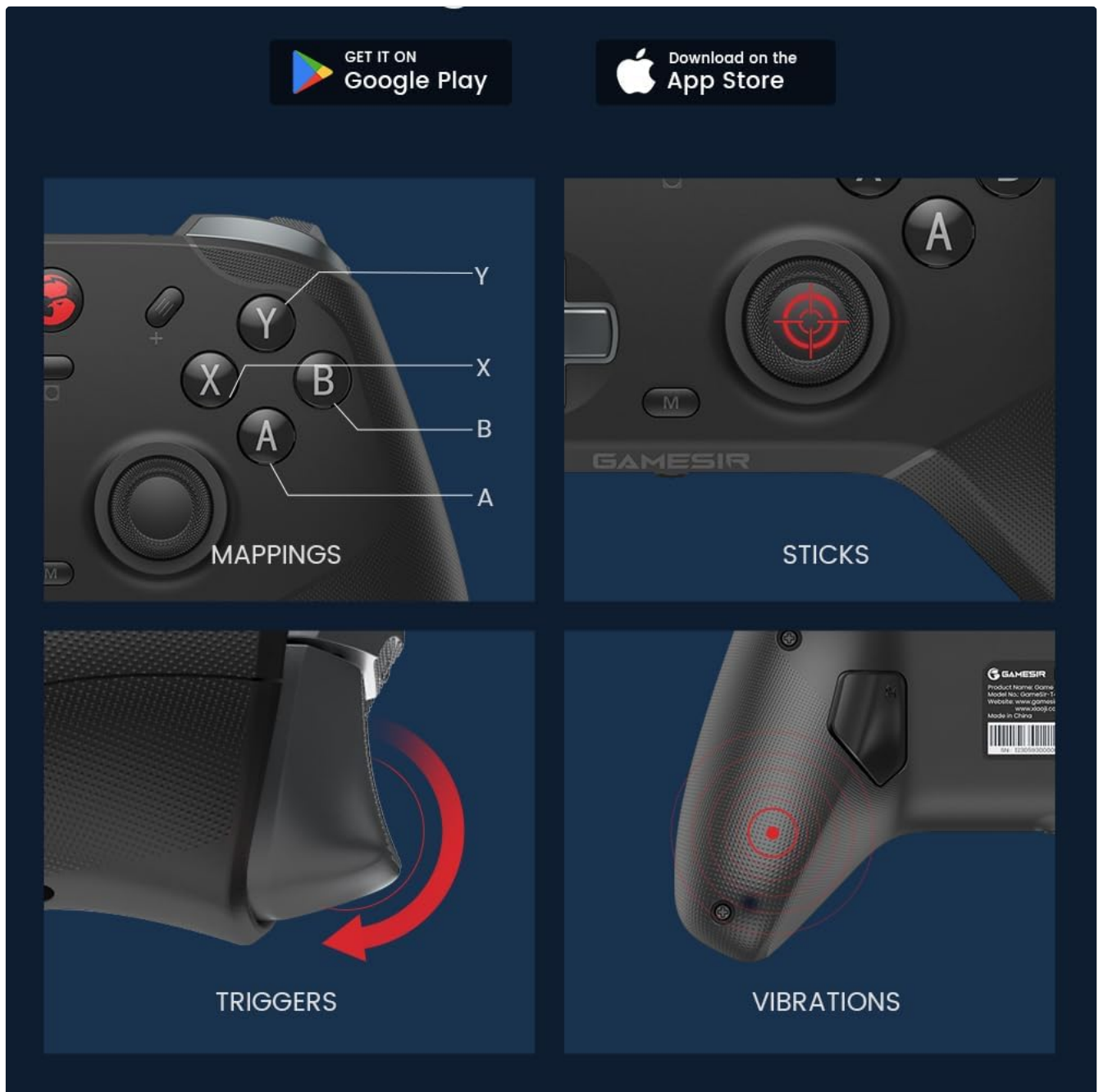

Figure 7: GameSir App interface for comprehensive controller customization.

4. SETUP

4.1 Charging the Controller

Before first use, fully charge the controller using the provided USB-C cable. Connect the USB-C end to the controller's port and the USB-A end to a compatible power source (e.g., computer USB port, USB wall adapter). The indicator light will show charging status and turn off when fully charged.

A full charge provides approximately 25 hours of playing time.

4.2 Connecting the Controller

The GameSir T4 Cyclone Pro supports three connection modes:

- **2.4G Wireless (Dongle Mode):**

Insert the 2.4G wireless dongle into your device's USB port. Press and hold the **Home + X** buttons on the controller to power on and enter Dongle Mode. The controller will automatically pair with the dongle.

- **Bluetooth (X-Input Mode):**

For Windows PC, macOS, Android, and iOS devices. Press and hold the **Home + B** buttons to power on and enter Bluetooth X-Input Mode. On your device, search for "GameSir T4 Cyclone Pro" in the Bluetooth settings and pair.

- **Bluetooth (Android Mode):**

Specifically for Android devices. Press and hold the **Home + A** buttons to power on and enter Bluetooth Android Mode. Search for "GameSir T4 Cyclone Pro" in your Android device's Bluetooth settings and pair.

- **Bluetooth (Switch Mode):**

For Nintendo Switch/Lite/OLED. Press and hold the **Home + Y** buttons to power on and enter Bluetooth Switch Mode. On your Switch, navigate to "Controllers" > "Change Grip/Order" and the controller will connect.

- **Wired (USB-C):**

Connect the controller directly to your device using the USB-C cable. The controller will automatically switch to wired mode and be recognized by your system.

To power on the controller in the last used mode, simply press the Home button.

5. OPERATING INSTRUCTIONS

5.1 Basic Controls

Familiarize yourself with the standard button layout, including joysticks, D-pad, ABXY buttons, shoulder buttons (L1/R1), and triggers (L2/R2).

5.2 Customizing with GameSir App

Download the official GameSir App from the Google Play Store or Apple App Store. Connect your controller via Bluetooth to the app to access advanced customization options:

- **Button Mapping:** Reassign functions to any button.
- **Joystick Deadzone:** Adjust the sensitivity and deadzone of the joysticks for optimal precision.
- **Trigger Travel Distance:** Modify the activation point of the triggers.
- **Vibration Intensity:** Customize the strength of the rumble motors.
- **ABXY Layout:** Switch between Xbox and Nintendo Switch button layouts.

5.3 Using Macro Back Buttons (L4/R4)

The L4 and R4 buttons on the back of the controller can be programmed for various functions. Refer to the GameSir App for detailed instructions on how to assign single buttons, turbo functions, or complex macros to these buttons.

5.4 Multi-function M Button Usage

Press the 'M' button in combination with other buttons to quickly change controller settings without needing the app:

- **M + LT/RT:** Switch between Hair Trigger and Linear Trigger modes.
- **M + LS/RS:** Adjust stick deadzone (e.g., to 0 for maximum responsiveness).
- **M + D-pad Up/Down:** Adjust grips vibration intensity.
- **M + A:** Toggle ABXY button layout (Xbox/Switch).

6. MAINTENANCE

- Clean the controller regularly with a soft, dry cloth. Avoid using harsh chemicals or abrasive materials.
- Store the controller in a cool, dry place away from direct sunlight and extreme temperatures.
- To preserve battery life, avoid fully discharging the controller frequently. Charge it when the battery is low.
- Do not attempt to disassemble or repair the controller yourself, as this may void the warranty.

7. TROUBLESHOOTING

7.1 Connection Issues

- **Controller not connecting:** Ensure the controller is powered on in the correct mode for your device (e.g., Home + Y for Switch). Check your device's Bluetooth settings or USB connection.
- **Interference with 2.4G dongle:** Try plugging the dongle into a different USB port or moving it closer to the controller.
- **Controller not recognized by PC:** Ensure necessary drivers are installed (usually automatic for Windows). Try a different USB port or cable.

7.2 Joystick/Trigger Problems

- **Inaccurate input/minor drift:** While Hall Effect joysticks are designed to prevent drift, minor calibration issues can occur. Use the GameSir App to recalibrate joysticks and adjust deadzones.
- **Triggers not responding correctly:** Check trigger travel distance settings in the GameSir App. Ensure you are in the desired trigger mode (Hair Trigger/Linear Trigger).

7.3 Battery Issues

- **Controller not charging:** Verify the USB-C cable is securely connected to both the controller and the power source. Try a different cable or power adapter.
- **Short battery life:** Ensure the controller is fully charged before use. Reduce vibration intensity via the M button or GameSir App to conserve battery.

7.4 General Issues

- **Controller unresponsive:** Perform a soft reset by pressing the reset button (usually a small pinhole on the back) or by holding the Home button for 10 seconds.
- **Xbox Not Supported:** Please remember that this controller is not compatible with Xbox consoles.

8. SPECIFICATIONS

Feature	Detail
Product Dimensions	6.14 x 4.06 x 2.48 inches
Item Weight	14.1 ounces

Connectivity Technology	Bluetooth, 2.4G Wireless, USB-C Wired
Controller Type	Gamepad
Compatible Devices	PC (Windows 10/11), Nintendo Switch/Lite/OLED, macOS, Android, iOS, Steam Deck
Joysticks	Hall Effect (No Dead Zone, No Drifting)
Triggers	Hall Effect Analog Triggers
Battery Capacity	860 mAh
Playing Time	Up to 25 hours
Programmable Buttons	2 Macro Back Buttons (L4, R4)
Vibration	Dual Rumble Motors (Grips & Triggers)
Motion Control	Supported (for Nintendo Switch)

9. WARRANTY AND SUPPORT

GameSir products come with a limited warranty. For detailed warranty information, product support, or technical assistance, please visit the official GameSir website or contact their customer service. You may also refer to the official User Manual PDF for additional details and troubleshooting steps.

Official User Manual (PDF): [Download Here](#)

GameSir Official Store: [Visit Store](#)