

Manuals.plus /

› Rosekm /

› Rosekm 1.1L Small Cool Mist Humidifier User Manual (Model KC-KM13T-1.1L)

Rosekm KC-KM13T-1.1L

Rosekm 1.1L Small Cool Mist Humidifier User Manual

Model: KC-KM13T-1.1L

Brand: Rosekm

1. INTRODUCTION

Thank you for choosing the Rosekm 1.1L Small Cool Mist Humidifier. This ultrasonic humidifier is designed to provide optimal humidity levels for small spaces, enhancing comfort and well-being. Its quiet operation, compact design, and user-friendly features make it ideal for bedrooms, nurseries, offices, and plant rooms.

Key features include a 1.1L (0.29gal) capacity, up to 15 hours of continuous operation on a low setting, automatic shut-off when water runs out, a 360° adjustable mist nozzle, and a filterless design for easy maintenance.

2. SAFETY INSTRUCTIONS

- Always place the humidifier on a firm, flat, waterproof surface.
- Do not place the humidifier near heat sources or in direct sunlight.
- Keep out of reach of children and pets.
- Use clean, cool tap water or distilled water. Distilled water is recommended to prevent mineral buildup.
- Do not add essential oils directly into the water tank, as this may damage the unit.
- Unplug the humidifier before filling, cleaning, or moving it.
- The unit features an automatic shut-off function when the water level is low, ensuring safety.
- This product is BPA-free.

3. PRODUCT OVERVIEW

Familiarize yourself with the components of your Rosekm humidifier:

- **Water Tank:** Transparent tank with 1.1L capacity.
- **Base Unit:** Contains the ultrasonic transducer and control panel.

- **Mist Nozzle:** 360° rotatable for directing mist.
- **Control Panel:** Power button and mist level indicators.

Figure 1: Key components including the 360° nozzle, transparent tank, and multiple mist settings.

4. SETUP

Follow these simple steps to set up your humidifier:

1. **Step 1: Remove the Water Tank.** Gently lift the water tank from the base unit.
2. **Step 2: Fill the Water Tank.** Unscrew the cap at the bottom of the tank. Fill the tank with clean, cool water. Securely screw the cap back on.
3. **Step 3: Place Tank on Base.** Carefully place the filled water tank back onto the base unit, ensuring it is seated correctly.
4. **Step 4: Plug In and Power On.** Plug the power cord into a suitable electrical outlet. Press the power button to turn on the humidifier.

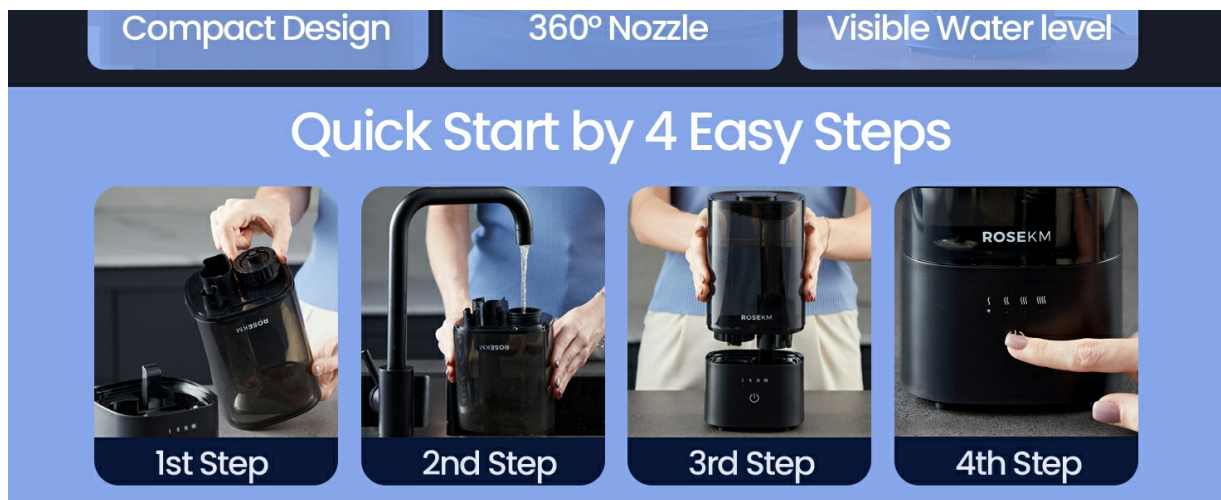

Figure 2: Quick start guide illustrating the four easy setup steps.

5. OPERATING INSTRUCTIONS

Operating your Rosekm humidifier is straightforward:

- **Power On/Off:** Press the power button once to turn the unit on. Press and hold the power button to turn it off.
- **Adjust Mist Level:** After powering on, tap the power button repeatedly to cycle through the four mist output levels (low, medium, high, highest). The indicator lights will show the selected mist level.
- **Direct Mist:** Rotate the 360° mist nozzle on top of the water tank to direct the mist in your desired direction.
- **Automatic Shut-Off:** The humidifier will automatically turn off when the water tank is empty. Refill the tank to resume operation.

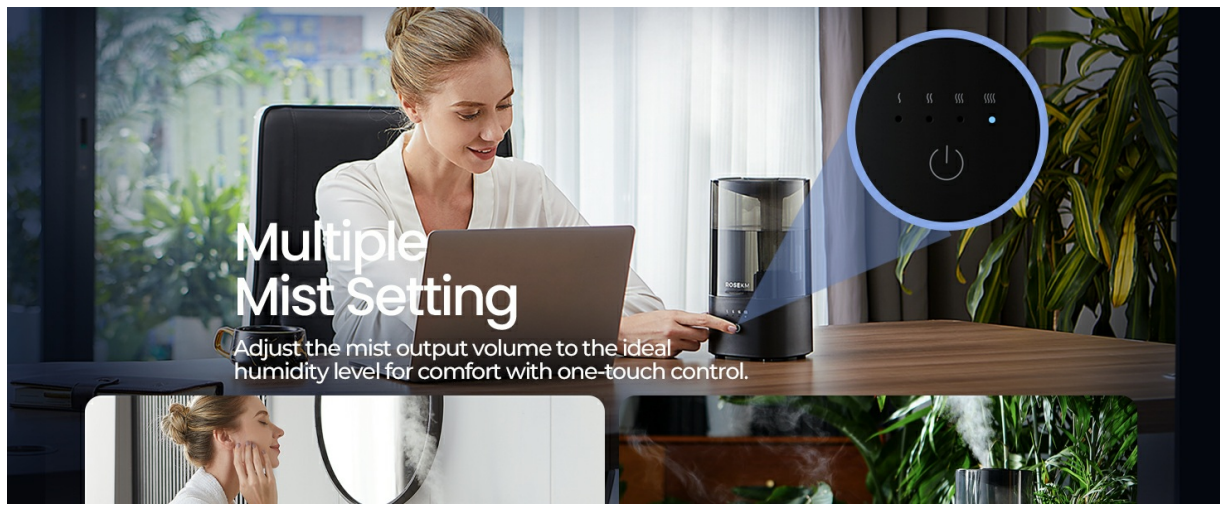

Figure 3: Adjusting mist output with the one-touch control.

6. MAINTENANCE AND CLEANING

Regular cleaning ensures optimal performance and extends the life of your humidifier:

- **Daily:** Empty and rinse the water tank and base unit daily. Allow them to air dry before refilling.
- **Weekly:** For a more thorough cleaning, remove the water tank and base. Fill the tank with a mixture of equal parts white vinegar and water. Let it sit for 30 minutes, then rinse thoroughly. Use a soft brush or cloth to clean the ultrasonic transducer in the base unit.
- **Filterless Design:** This humidifier does not require filter replacements, simplifying maintenance.

7. TROUBLESHOOTING

Problem	Possible Cause	Solution
No mist or low mist output.	Water tank empty; unit not plugged in; mist level too low; mineral buildup.	Refill water tank; ensure power connection; increase mist level; clean the ultrasonic transducer.
Unusual odor.	Dirty water or tank.	Empty old water, clean tank and base thoroughly, refill with fresh water.
Water leakage when refilling.	Water tank cap not securely tightened; unit tilted during refill.	Ensure the water tank cap is tightly sealed. When refilling, hold the tank sideways to minimize spillage from the valve before placing it back on the base.
White dust around the humidifier.	Hard water usage.	Use distilled or demineralized water to reduce mineral deposits. Regularly clean the unit.

8. SPECIFICATIONS

- **Brand:** Rosekm
- **Model Name:** KC-KM13T-1.1L
- **Capacity:** 1.1 Liters (0.29 Gallons)
- **Operation Mode:** Ultrasonic

- **Special Features:** Adjustable Humidity Control, Auto Shut Off, Low Water Indicator, Quiet Operation, Removable Tank, Filterless
- **Product Dimensions:** 4.4"D x 4.4"W x 8.9"H
- **Item Weight:** 1.65 pounds (0.75 Kilograms)
- **Voltage:** 110 Volts (AC)
- **Floor Area Coverage:** Up to 180 Square Feet
- **Room Type:** Bedroom, Kids Room, Nursery, Office, Plant Room

9. WARRANTY AND SUPPORT

The Rosekm 1.1L Small Cool Mist Humidifier comes with a **Five-Year Warranty**. This warranty covers defects in materials and workmanship under normal use. For warranty claims, technical support, or any questions regarding your product, please contact Rosekm customer support through the retailer where you purchased the product or visit the official Rosekm website for contact information.

We are committed to ensuring your satisfaction and will promptly assist with replacements for defective or used products under warranty.