

MOFII 9ba2972e-6f07-4811-848e-dfc5f15f8cc9

MOFII Wired Retro Typewriter Keyboard User Manual

Model: 9ba2972e-6f07-4811-848e-dfc5f15f8cc9

Brand: MOFII

1. SETUP

This section provides instructions for the initial setup of your MOFII Wired Retro Typewriter Keyboard.

1.1 Unboxing and Components

Carefully remove all components from the packaging. The package should contain the MOFII Wired Retro Typewriter Keyboard and a USB cable.

1.2 Connecting the Keyboard

1. Locate an available USB-A port on your computer (PC, Laptop, Desktop, Chromebook).
2. Plug the USB cable from the keyboard into the USB-A port on your computer.
3. The keyboard is designed for plug-and-play functionality and does not require additional driver installation.



Image: The MOFII Wired Retro Typewriter Keyboard connected to a computer, illustrating the simple plug-and-play USB connection.

1.3 Adjusting Keyboard Angle

The keyboard features foldable stands on the underside, allowing you to adjust the typing angle for enhanced comfort.

- To raise the keyboard, gently pull out the two foldable stands located at the top corners of the keyboard's underside.
- To return the keyboard to a flat position, fold the stands back into their recessed slots.



Image: A side view of the keyboard demonstrating the adjustable angle provided by the foldable stands.

2. OPERATING INSTRUCTIONS

This section details the primary functions and features of your MOFII Wired Retro Typewriter Keyboard.

2.1 Basic Typing

The keyboard operates as a standard 104-key full-size QWERTY keyboard. Simply begin typing after connecting it to your computer.

2.2 Multimedia Functions

The keyboard includes 11 multimedia shortcut combinations accessible via the **Fn** key and the function keys (F1-F12). These shortcuts provide quick control over various computer functions.

- **Fn + F1:** Media Player

- **Fn + F2:** Volume Down
- **Fn + F3:** Volume Up
- **Fn + F4:** Mute
- **Fn + F5:** Play to Suspend
- **Fn + F6:** Previous Track
- **Fn + F7:** Play / Pause
- **Fn + F8:** Next Track
- **Fn + F9:** Email
- **Fn + F10:** Web Home
- **Fn + F11:** Screen Lock
- **Fn + W:** Swaps W, A, S, D keys with arrow keys.
- **Fn + Win - L:** Locks/unlocks the Windows and APP keys.

Note: Some multimedia functions may not be fully available or function differently with Mac OS.

RETRO FULL SIZE

Keyboard with Numerical Keypad

USB Cable Length: 65in



Image: An illustration highlighting the multimedia function keys and their corresponding actions when pressed with the Fn key.

2.3 Indicator Lights

The keyboard features indicator lights to show the status of certain functions:

- **Keypad Lock Indicator:** Illuminates when the numeric keypad is active.

- **Caps Lock Indicator:** Illuminates when Caps Lock is active.
- **Win Lock Indicator:** Illuminates when the Windows key is locked.



Image: A detailed view of the keyboard's upper right section, pointing out the three indicator lights.

3. MAINTENANCE

Proper maintenance ensures the longevity and optimal performance of your keyboard.

3.1 Cleaning the Keyboard

The keyboard features a removable keycap design, facilitating easy cleaning.

- To clean, gently pull off the keycaps. A small brush (often included with the product) can be used to remove dust, hair, and debris from underneath the keycaps and between the switches.
- Wipe the keycaps and keyboard surface with a soft, damp cloth. Avoid using harsh chemicals or abrasive materials.

- Ensure the keyboard is completely dry before reattaching the keycaps and resuming use.

REMOVABLE KEYCAP DESIGN

Package include a brush to remove dust, hair and other dirty things

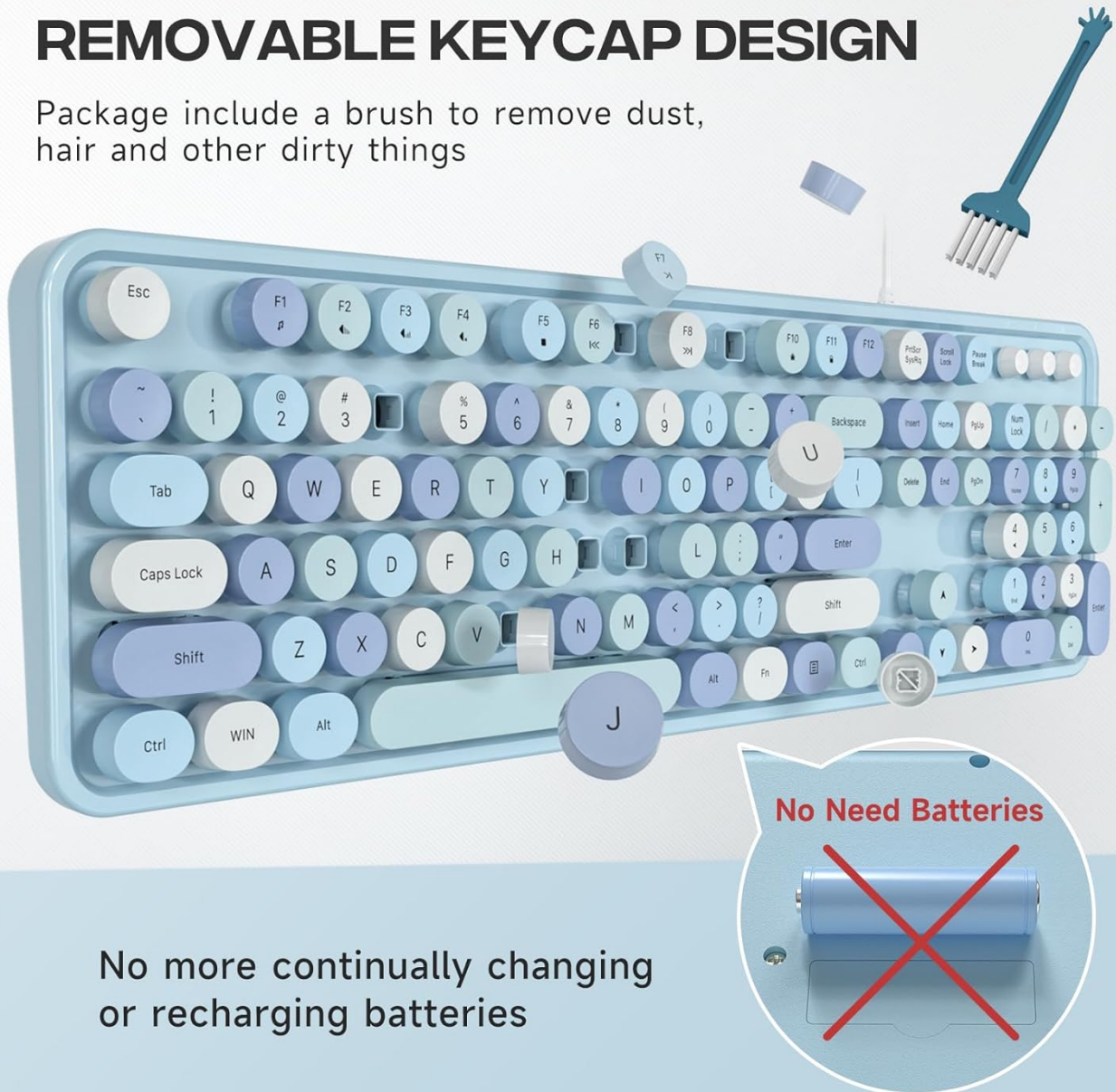

No more continually changing or recharging batteries

Image: The keyboard with keycaps detached, illustrating the removable keycap feature and the use of a cleaning brush for maintenance.

4. TROUBLESHOOTING

If you encounter issues with your keyboard, refer to the following troubleshooting steps.

4.1 Keyboard Not Responding

- **Check USB Connection:** Ensure the USB cable is securely plugged into both the keyboard and the computer's USB port. Try plugging it into a different USB port.
- **Restart Computer:** Sometimes, a simple computer restart can resolve connectivity issues.
- **Test on Another Computer:** If possible, test the keyboard on a different computer to determine if the issue is with the keyboard or the original computer's setup.

4.2 Multimedia Keys Not Functioning on Mac OS

As noted in the operating instructions, some multimedia functions may not be fully compatible or may behave differently on Mac OS compared to Windows operating systems. This is due to differences in operating system design and keyboard driver support.

5. SPECIFICATIONS

Detailed technical specifications for the MOFII Wired Retro Typewriter Keyboard.

Feature	Specification
Model Name	Blue Retro Typewriter Keyboard
Item Model Number	9ba2972e-6f07-4811-848e-dfc5f15f8cc9
Connectivity Technology	USB-A (Wired)
Keyboard Description	Multimedia, Full-Size (104 Key)
Special Feature	Round Key, Foldable Stands
Compatible Devices	PC, Laptop, Desktop, Chromebook (Windows XP/Vista/7/8/10/11, Mac)
Material	Plastic
Item Weight	1.85 pounds
Package Dimensions	17.87 x 6.42 x 1.73 inches

PLUG AND PLAY

One USB cable for the keyboard, do not need any extra software, super easy to use.

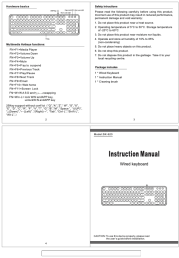
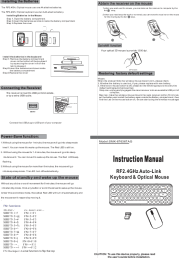
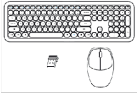





Image: A technical diagram illustrating the physical dimensions of the keyboard.

6. WARRANTY AND SUPPORT

For warranty information or technical support, please refer to the documentation included with your purchase or contact MOFII customer service directly. Contact details can typically be found on the manufacturer's official website or product packaging.

© 2023 MOFII. All rights reserved.

	<p>SK-623 Wired Keyboard Instruction Manual</p> <p>Instruction manual for the SK-623 Wired Keyboard, detailing hardware basics, multimedia hotkeys, safety instructions, and package contents.</p>
	<p>SMK-676367AG RF2.4GHz Auto-Link Keyboard & Mouse Instruction Manual</p> <p>Instruction manual for the SMK-676367AG RF2.4GHz Auto-Link Keyboard and Optical Mouse, covering battery installation, receiver connection, power-saving features, FN+ functions, and troubleshooting.</p>
<p>Bezprzewodowy zestaw klawiatura + myszka MOFii 666 2.4G Instrukcja obsługi</p>  <p>Model: DMH-666375G</p>	<p>Bezprzewodowy zestaw klawiatura + myszka MOFii 666 2.4G - Instrukcja obsługi</p> <p>Instrukcja obsługi dla bezprzewodowego zestawu klawiatury i myszy MOFii 666 2.4G. Zawiera informacje o instalacji baterii, podłączaniu odbiornika, funkcjach oszczędzania energii, skrótach klawiszowych, rozwiązywaniu problemów i deklaracji zgodności.</p>
<p>Vezeték nélküli billentyűzet + egérkészlet MOFii 666 2.4G Felhasználói kézikönyv</p>  <p>Model: DMH-666375G</p>	<p>MOFii 666 2.4G Vezeték nélküli Billentyűzet és Egér Kombó Felhasználói Kézikönyv</p> <p>Részletes felhasználói útmutató a MOFii 666 2.4G vezeték nélküli billentyűzet és egér kombóhoz. Tartalmazza a telepítési útmutatót, akkumulátor-behelyezést, energiatakarékossági funkciókat, multimédia gyorsbillentyűket, hibaelhárítást és garanciális információkat.</p>
<p>MOFii Wireless Keyboard & Mouse Set Instruction Manual</p> <p>FCC Manual</p> <p>Attention: Read Carefully This equipment has been tested and found to comply with the limits for a Class B digital device, pursuant to part 15 of the FCC Rules. These limits are designed to provide reasonable protection against harmful interference to radio communications. This equipment generates, uses, and can radiate radio frequency energy and, if not installed and used according to the instructions, may cause harmful interference to radio communications. However, there is no guarantee that interference will not occur in a particular installation. If interference does occur, you may wish to take the following steps: (a) Reorient or relocate the receiving antenna. (b) Increase the separation between the equipment and the receiver. (c) Connect the equipment to a different power outlet or a different branch circuit. (d) Consult the equipment manufacturer for more information.</p> <p>Product Description</p>  <p>Multimedia function key</p>	<p>MOFii Wireless Keyboard & Mouse Set Instruction Manual</p> <p>This document provides instructions and specifications for the MOFii Wireless Keyboard & Mouse Set, including FCC compliance information, product description, and installation guidance.</p>
<p>MOFii Sweet 2.4G vezeték nélküli billentyűzet + egér készlet Felhasználói kézikönyv</p>  <p>Model: DMH-666375G</p>	<p>MOFii Sweet 2.4G Wireless Keyboard and Mouse Set User Manual</p> <p>User manual for the MOFii Sweet 2.4G wireless keyboard and mouse set, including setup, battery installation, power saving features, multimedia shortcuts, and warranty information.</p>