

LAMTTO 9“ Portable Wireless Carplay

LAMTTO 9 Inch Wireless Car Stereo User Manual

Model: 9" Portable Wireless Carplay | Brand: LAMTTO

1. INTRODUCTION

This manual provides comprehensive instructions for the LAMTTO 9 Inch Wireless Car Stereo. It covers essential information regarding product setup, operational procedures, maintenance guidelines, and troubleshooting tips to ensure optimal performance and a satisfactory user experience. Please read this manual thoroughly before using the device.



Figure 1.1: LAMTTO 9 Inch Wireless Car Stereo with Apple CarPlay interface.

2. WHAT'S IN THE BOX

Verify that all components are present in the packaging:

- 1 x 9 Inch Caplay Screen Monitor
- 1 x 9.8 ft Car Charger Cable
- 1 x 4.65ft Aux cable
- 1 x Suction Cup Bracket & Desktop Bracket

- 1 x Manual

3. KEY FEATURES

- **Wireless Apple CarPlay and Android Auto:** Seamless integration with your smartphone for navigation, music, and communication.
- **Upgraded Bluetooth Stereo Output:** Connects to car stereo speakers for high-quality audio playback.
- **iOS and Android Mirror Link:** Display smartphone content, including video applications, on the car stereo screen.
- **Siri and Google Assistant Smart Voice Control:** Hands-free operation for calls, navigation, and music commands.
- **Online Maps and Real-time GPS Navigation:** Utilizes smartphone map applications for up-to-date navigation.
- **9-Inch HD IPS Display:** Provides a clear and intuitive visual experience with 1600x600 resolution.
- **Multiple Audio Output Options:** Supports Bluetooth, FM wireless transmission, and AUX output.

4. SETUP

4.1 Mounting the Device

The device includes both a suction cup bracket and a desktop bracket for flexible installation. Choose the most suitable mounting option for your vehicle's dashboard or windshield, ensuring it does not obstruct your view or interfere with vehicle controls.



Figure 4.1: Available mounting options and installation methods.

4.2 Power Connection

Connect the provided 9.8 ft car charger cable to the device's TYPE-C port and plug the other end into your vehicle's 12V power outlet. Ensure the car charger provides at least 5V/3A power for proper device activation. Route the cable to minimize clutter and ensure it does not interfere with driving.



Figure 4.2: Recommended cable routing for a clean installation.

4.3 Initial Connection for Apple CarPlay (iOS)

1. Turn on Wi-Fi and Bluetooth on your iPhone.
2. On your iPhone, connect to the device's Bluetooth (e.g., 'T86xxxx').
3. Allow the connection prompt on your iPhone.
4. Select 'Use CarPlay' when prompted.
5. After 10-20 seconds, the wireless CarPlay connection will be successful.

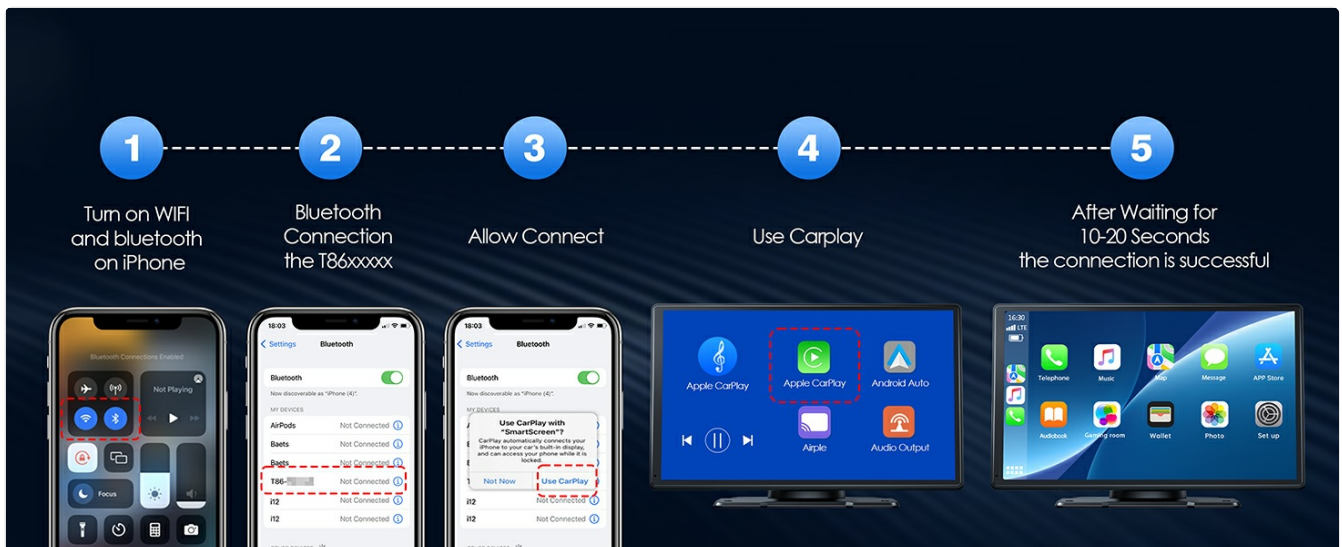

Figure 4.3: iPhone connection process for Apple CarPlay.

4.4 Initial Connection for Android Auto (Android)

1. Turn on Wi-Fi and Bluetooth on your Android phone.
2. On your Android phone, connect to the device's Bluetooth (e.g., 'T86xxxx').
3. Allow the connection prompt on your Android phone.
4. After 10-20 seconds, the wireless Android Auto connection will be successful.

Note: For Android Auto, your Google phone needs to be Android 8.0 or above. For other Android brands, the system needs to be Android 11 or above.

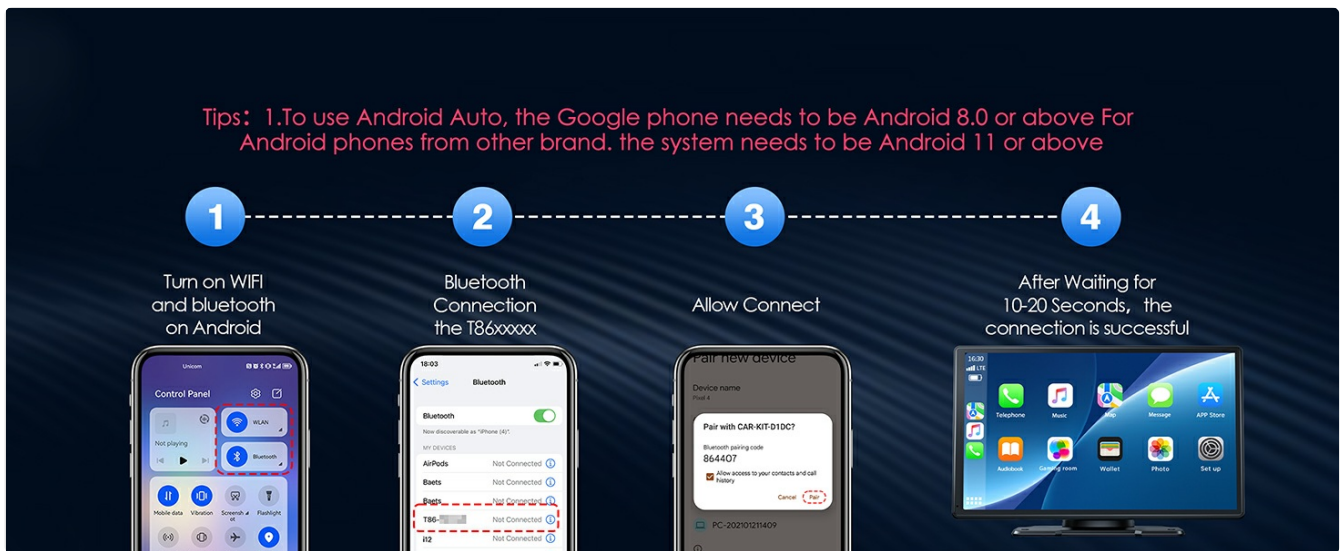

Figure 4.4: Android phone connection process for Android Auto.

4.5 Important Considerations Before Use

- Before connecting your phone, ensure that your phone's Wi-Fi and Bluetooth are not occupied by other devices.
- When connecting, turn on your phone's Bluetooth and Wi-Fi first. After a successful connection, Bluetooth will automatically disconnect, and data will primarily be transmitted via Wi-Fi.
- For audio transmission to your car stereo, Bluetooth is generally more stable than AUX and FM.
- This product does not include a camera.
- It is recommended to set your screen brightness to maximum for optimal daytime visibility.

Supported Mobile Phone Models: Android system needs to be version 11 or above. Apple phones need iOS 11.0 or above. **Supported car models:** Only supports 2016+ cars (not supporting BMW and Tesla).

5. OPERATING INSTRUCTIONS

5.1 Wireless Apple CarPlay & Android Auto

Once connected, your smartphone's interface will be mirrored on the 9-inch display. You can access navigation, music, messages, and other compatible applications directly from the touch screen. The system automatically connects to your smartphone upon vehicle startup after the initial pairing.

5.2 Bluetooth Stereo Output

The device utilizes an upgraded Bluetooth connection method to transmit audio to your car's stereo speakers. This method aims to provide a lossless audio experience. Ensure your car's stereo is set to the correct Bluetooth input source.

Advantages of Wireless Carplay

Ours



Plug & Play



Real-time Information of Your Phone



Portable Wireless When Has New Car



No Installation Skills Required

Others

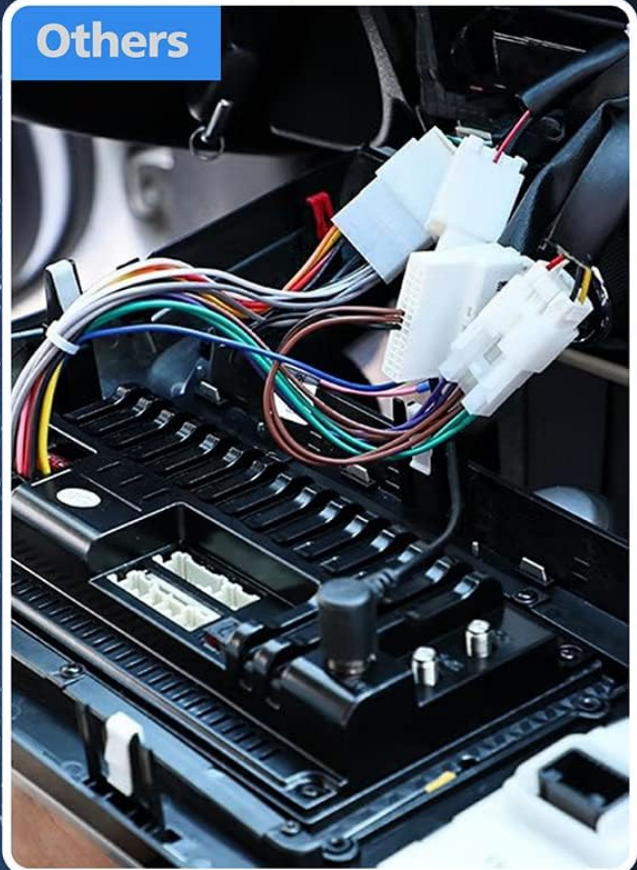

Complicated Installation



Have to upgrade fireware regularly



Hard to remove if after-sales required



Extra Cost for Professional Installation

Figure 5.1: Four audio output options for the car stereo.

5.3 Mirror Link (iOS & Android)

Use the Apple Airplay (for iOS) or Android Cast (for Android) function to mirror your smartphone's screen onto the car stereo display. This allows you to view content such as YouTube or TikTok videos. The 1600x600 HD resolution supports 1080P video playback.



Figure 5.2: Phone Mirror Link in operation.

5.4 Voice Control (Siri/Google Assistant)

The built-in microphone enables smart voice control. Activate Siri or Google Assistant by voice commands to perform actions such as playing music, initiating GPS navigation, sending messages, or making phone calls, enhancing driving safety by minimizing manual interaction.

Phone Mirror Link

Enjoy the Great Outdoors

Equipped with 1024*600 HD resolution touch screen, you can connect your phone through the Mirror Link function and enjoy the great outdoor time



Figure 5.3: Voice control functionality for calls and navigation.

5.5 GPS Navigation

The device displays real-time map information from your smartphone's navigation applications (e.g., Google Maps, Waze). This provides up-to-date navigation without the need for frequent manual updates, offering a more intuitive visual experience on the 9-inch HD IPS display.

Real-time GPS Navigation

Real-time gps navigation as your
phone, 9 inch screen to give you peace of mind



Figure 5.4: Real-time GPS navigation display.

5.6 Audio Output Modes

The LAMTTO car stereo supports four methods for audio output:

- **Built-in Speaker:** The device has an integrated speaker for direct audio output.
- **AUX Connect to Car Speaker:** Use the provided 4.65ft AUX cable to connect the device to your car's AUX input for audio transmission.
- **FM Transmitter of Car Audio:** The power supply includes an FM transmitter. Tune your car's radio to the specified FM frequency to receive audio from the device.

- **Bluetooth Connect to Car Speaker:** Connect the device via Bluetooth to your car's stereo system for high-quality audio playback.

6. MAINTENANCE

To ensure the longevity and optimal performance of your LAMTTO Wireless Car Stereo, follow these maintenance guidelines:

- **Cleaning:** Use a soft, dry, lint-free cloth to clean the screen and exterior surfaces. Avoid using abrasive cleaners, solvents, or aerosol sprays, as they may damage the device.
- **Temperature:** Avoid exposing the device to extreme temperatures, direct sunlight for prolonged periods, or high humidity.
- **Cable Management:** Periodically check all connected cables for wear or damage. Ensure cables are securely routed and not pinched.
- **Software Updates:** Keep the device's software updated if updates become available, as this can improve performance and add new features. Refer to the manufacturer's website for update instructions.

7. TROUBLESHOOTING

If you encounter issues with your LAMTTO Wireless Car Stereo, refer to the following troubleshooting steps:

Problem	Possible Cause	Solution
Device does not power on.	Insufficient power supply; loose connection.	Ensure the car charger provides at least 5V/3A. Check that the charger cable is securely connected to both the device and the car's 12V outlet.
Wireless CarPlay/Android Auto fails to connect.	Phone Wi-Fi/Bluetooth occupied; incorrect pairing steps; incompatible phone OS.	Ensure phone's Wi-Fi and Bluetooth are not connected to other devices. Follow the correct pairing steps (Section 4.3/4.4). Verify your phone's OS version meets requirements (Android 8.0+/11+, iOS 11.0+).
No audio or poor audio quality.	Incorrect audio output mode selected; loose AUX cable; FM interference.	Check the selected audio output mode (Bluetooth, AUX, FM). If using AUX, ensure the cable is fully inserted. If using FM, try a different frequency to avoid interference. Bluetooth is recommended for best quality.
Screen is dim or difficult to see in daylight.	Brightness setting is too low.	Adjust the screen brightness to maximum for optimal visibility during the day.
Touchscreen is unresponsive.	Temporary software glitch; screen obstruction.	Restart the device. Ensure the screen is clean and free from debris or moisture.

8. SPECIFICATIONS

Feature	Detail
Product Dimensions	14.17 x 14.17 x 13 inches

Feature	Detail
Item Weight	2.51 pounds
Item Model Number	9" Portable Wireless Carplay
OS	Android (Internal system, not user-facing)
Wireless Communication	Bluetooth, Wi-Fi
Special Features	Touchscreen, Wireless Carplay & Android Auto
Human Interface Input	Microphone, Touchscreen
Scanner Resolution	1600 x 600
Color	Black
Manufacturer	LAMTTO
Screen Size	9 Inches
Map Type	Worldwide (via smartphone apps)
Audio Output Mode	Stereo

9. WARRANTY AND SUPPORT





LAMTTO provides a one-year warranty for this product from the date of purchase. Additionally, lifetime technical service is available to assist with any product-related inquiries or issues. For support, please contact LAMTTO customer service.

Customer Support: 24/7 customer support is available for assistance.

10. IMPORTANT SAFETY INFORMATION

- Always prioritize safe driving. Do not operate the device in a manner that distracts you from the road.
- Ensure the device is securely mounted and does not obstruct your view or interfere with airbags or other safety features.
- Avoid prolonged exposure to direct sunlight, which can cause overheating or damage to the screen.
- Do not attempt to disassemble or modify the device. Unauthorized modifications can void the warranty and pose safety risks.
- Keep the device away from water and other liquids.

Related Documents

<p>RC05-10.26 INCH SMART SCREEN PLAYER User Manual</p> 	<p>RC05 10.26 Inch Smart Screen Player User Manual LAMTTO</p> <p>Comprehensive user manual for the LAMTTO RC05 10.26 Inch Smart Screen Player. Learn about installation, features like Apple CarPlay and Android Auto, FM transmit, and troubleshooting.</p>
	<p>Lamtto RC04: Wireless Carplay & Android Auto User Guide</p> <p>This guide provides instructions for connecting and using the Lamtto RC04 device with Apple Carplay and Android Auto, covering setup, features, FM transmission, AUX output, and troubleshooting.</p>
	<p>Carplay Smart Screen User Manual</p> <p>User manual for the Carplay Smart Screen, detailing product overview, composition, description, wiring instructions, installation methods, and FAQs. Supports Apple CarPlay and Android Auto.</p>
	<p>LAMTTO RC19 Motorcycle CarPlay & Android Auto Smart Screen User Manual</p> <p>Comprehensive user guide for the LAMTTO RC19 smart screen, covering installation, product overview, CarPlay, Android Auto, and Bluetooth connectivity for motorcycles.</p>