

Osim uGlow PoreCare

OSIM uGlow PoreCare Blackhead Remover Pore Vacuum Instruction Manual

1. INTRODUCTION

The OSIM uGlow PoreCare is a facial device designed for deep pore cleansing and impurity extraction. It features Softskin Vacuum Technology, a warm nose compress function, and LED aftercare pore solutions to address various skin concerns. This manual provides essential information for the safe and effective use of your device.

2. PRODUCT COMPONENTS

The OSIM uGlow PoreCare device comes with several components to facilitate a comprehensive pore treatment:

- **uGlow PoreCare Device:** The main handheld unit with controls for suction levels, temperature, and LED light.
- **4 Interchangeable Suction Probes:** Designed for different pore concerns and skin areas.
- **LED Covers:** For targeted light therapy.
- **USB Charging Cable:** For recharging the device.

Customisable pore treatment

Pore suction heads suitable for different concerns.



Round

For blackheads and stubborn residues



Elliptical

For corners with slight lifting stimulation



Microlite

For dead skin exfoliation



Silicone

For sensitive skin with soft cushioning

Image: The uGlow PoreCare device shown with its four distinct interchangeable suction heads, each designed for specific pore treatments.

Remove impurities from inside out

Relieve your congested pores all at once with uGlow PoreCare. Whether your skin is normal, oily or sensitive, effectively remove facial impurities for a brighter you.

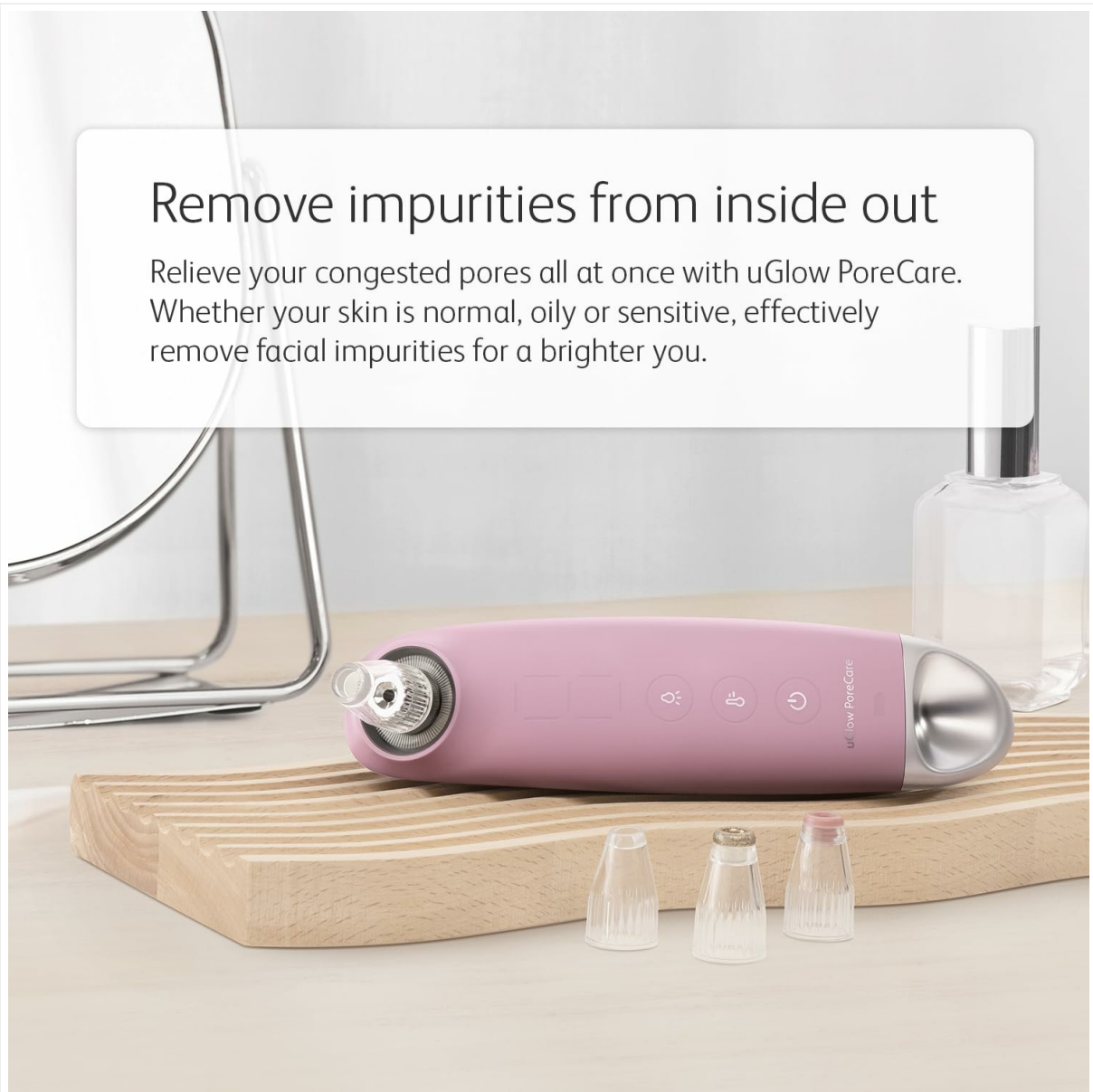

Image: The uGlow PoreCare device highlighting its LED light therapy feature, with red, blue, and yellow LED covers.

3. SETUP

3.1 Charging the Device

Before first use, fully charge the uGlow PoreCare device using the provided USB charging cable. Connect the cable to the charging socket on the device and a suitable USB power adapter (5V-1A recommended). The device's indicator lights will show charging status.

3.2 Attaching Suction Probes or LED Covers

Select the desired suction probe or LED cover based on your treatment needs. Gently twist and attach it to the head of the device until it is securely in place. Ensure a snug fit to maintain optimal suction or light contact.

4. OPERATING INSTRUCTIONS

4.1 Preparation: Warm Nose Compress

To prepare your skin for deep cleansing, use the adjustable warm nose compress function. This helps to open up pores and loosen accumulated debris, making extraction easier.

1. Ensure the device is clean and charged.
2. Activate the warm compress function (refer to device controls).
3. Gently place the warm compress area of the device against your nose or other areas where pores need opening.
4. Hold for a few minutes to allow pores to soften.

Clean Pores in 2 Steps



Step 1
Open up pores by using the adjustable warm nose compress



Step 2
Change the pore suction & strength according to your skin type & needs, & use it on your face



Tip: It is recommended to start with the lowest strength (1) and move in one direction. Do not stay in the same spot for more than 3 seconds.

Image: Step 1 of pore cleansing, demonstrating the use of the adjustable warm nose compress to open pores.

4.2 Pore Extraction: Softskin Vacuum Technology

The device utilizes Softskin Vacuum Technology to gently extract impurities from your pores. It offers 5 adjustable suction levels to suit different skin types and needs.

1. After using the warm compress, select an appropriate suction probe.
2. Turn on the device and select the lowest suction strength (Level 1) initially.
3. Place the probe flat against your skin and move it in one continuous direction.
4. **Important:** Do not keep the device in the same spot for more than 3 seconds to avoid skin irritation or bruising.
5. Adjust the suction level as needed, increasing gradually if your skin tolerates it.
6. Focus on areas with blackheads, whiteheads, and other impurities.



Vacuum Technology

Extract pore impurities with gentle vacuum suction

Image: Visual representation of the vacuum technology at work, extracting pore impurities.

Product Dimension

Measurements in CM (*Note: all measurements are subjected to $\pm 5\%$ tolerance)

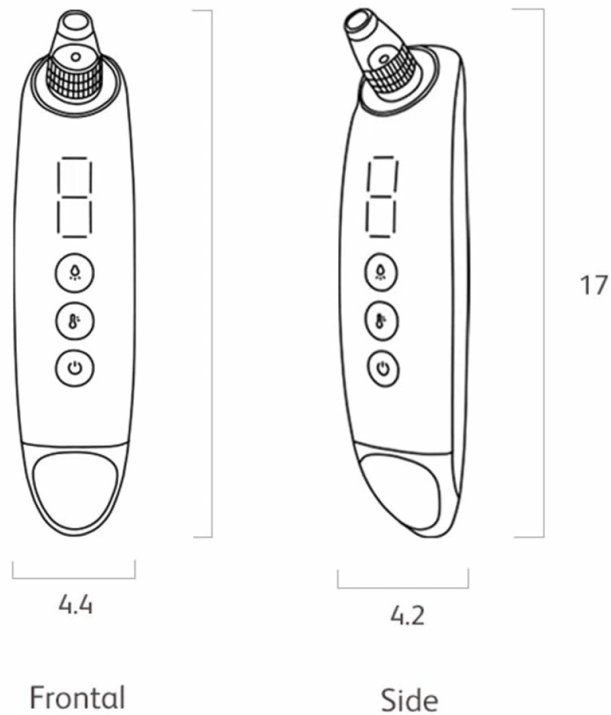

Model Specification

Model uGlow Porecare	Adaptor output 5V - 1A
Model Number OS-1224	Auto Timer 15 minutes

Weight

Gross Weight Approx. 0.35kg	Net Weight Approx. 0.17 kg
---------------------------------------	--------------------------------------

Image: Diagram explaining Softskin Vacuum Technology, showing deep cleansing to minimize pore congestion with 5 adjustable suction levels.

4.3 LED Aftercare Pore Solution

After extraction, use the LED aftercare pore solution to treat and improve various pore concerns with 3 spectrums of light. Attach the appropriate LED cover to the device.

- **Red LED:** Helps regenerate cell production for pore recovery.
- **Blue LED:** Soothes the skin and helps clear up inflammation around pores.
- **Yellow LED:** Reduces skin pigments and brightens dark spots.

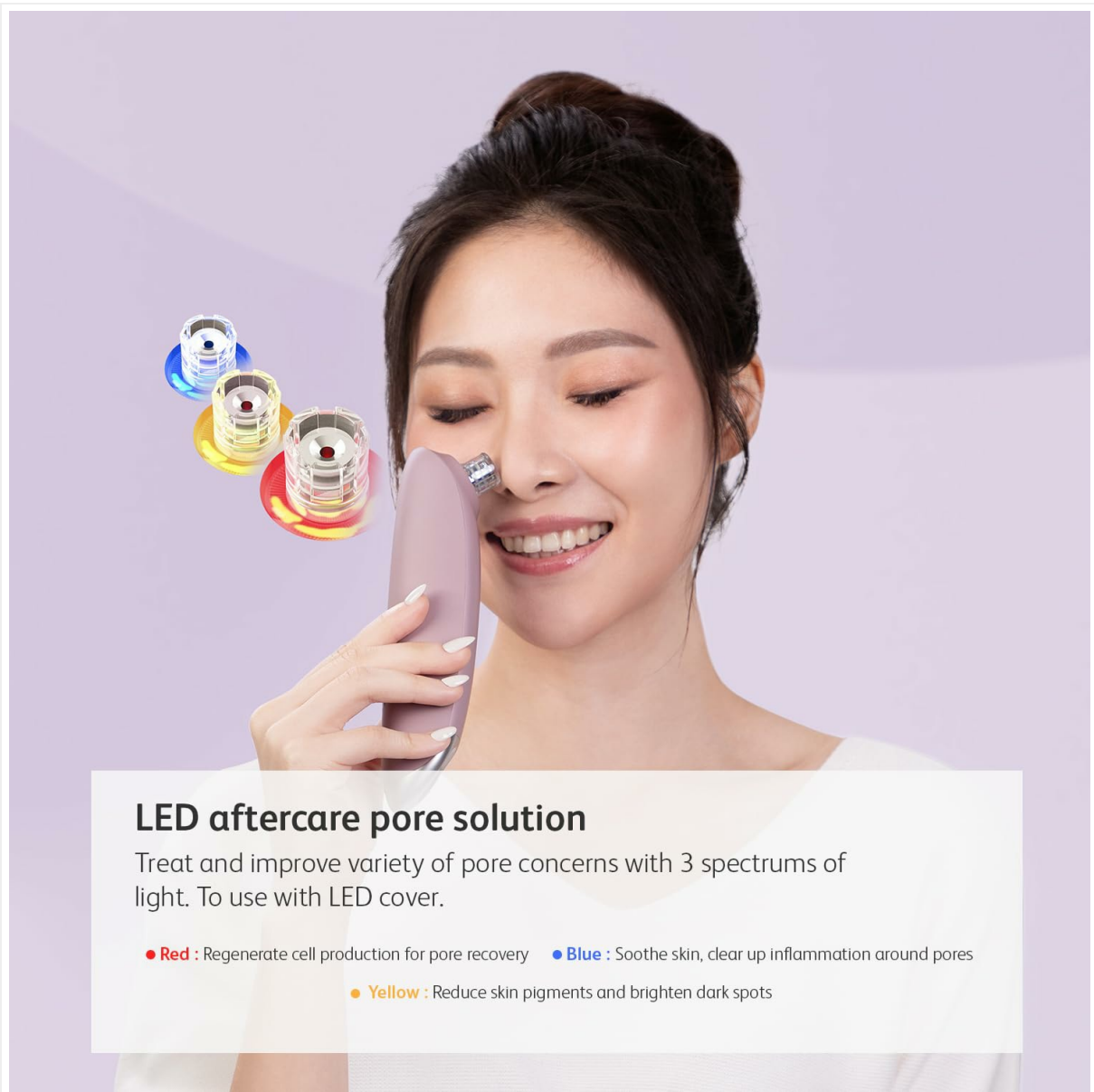

Image: The device in use, demonstrating the LED aftercare pore solution with descriptions for Red, Blue, and Yellow light benefits.

4.4 Interchangeable Suction Heads

The uGlow PoreCare includes four distinct suction heads, each designed for specific pore treatments:

- **Round**: Ideal for blackheads and stubborn residues.
- **Elliptical**: Suitable for corners and provides slight lifting stimulation.
- **Microlite**: Used for dead skin exfoliation.
- **Silicone**: Designed for sensitive skin with soft cushioning.



Image: A display of the four customisable pore treatment suction heads and their recommended uses.

5. MAINTENANCE

5.1 Cleaning the Device and Probes

Regular cleaning ensures hygiene and optimal performance.

- After each use, detach the suction probe or LED cover.
- Rinse the probe/cover under running water and clean with a mild soap.
- Wipe the main device body with a soft, damp cloth. Do not immerse the main unit in water.
- Ensure all parts are completely dry before reattaching or storing.

5.2 Storage

Store the device and its accessories in a cool, dry place, away from direct sunlight and extreme temperatures. Keep out of reach of children.

6. TROUBLESHOOTING

If you encounter issues with your OSIM uGlow PoreCare, refer to the following common problems and

solutions:

Problem	Possible Cause	Solution
Device does not turn on	Low battery; Device malfunction	Charge the device fully; Contact customer support if issue persists.
Weak or no suction	Probe not attached correctly; Blockage in the suction head; Low battery	Ensure probe is securely attached; Clean the suction head; Charge the device.
LED light not working	LED cover not attached correctly; Device malfunction	Ensure LED cover is securely attached; Contact customer support if issue persists.
Skin redness or bruising	Suction level too high; Device held in one spot for too long	Reduce suction level; Keep the device moving continuously; Do not exceed 3 seconds in one spot.

7. SPECIFICATIONS

Detailed specifications for the OSIM uGlow PoreCare device:

Feature	Detail
Model	uGlow PoreCare
Model Number	OS-1224
Adaptor Output	5V - 1A
Auto Timer	15 minutes
Gross Weight	Approx. 0.35 kg
Net Weight	Approx. 0.17 kg
Product Dimensions (LxWxH)	17 x 4.4 x 17 cm

Note: All measurements are subject to $\pm 5\%$ tolerance.



Image: Product dimensions and model specifications for the uGlow PoreCare device.

8. WARRANTY AND SUPPORT

The OSIM uGlow PoreCare device comes with a **6-month warranty** from the date of purchase. This warranty covers manufacturing defects under normal use conditions.

For warranty claims, technical support, or any other inquiries, please refer to the contact information provided with your purchase or visit the official OSIM website. Please retain your proof of purchase for warranty validation.

9. OFFICIAL PRODUCT VIDEO

Watch the official product video for a visual guide on how to use the OSIM uGlow PoreCare device effectively.



Video: An official demonstration of the OSIM uGlow PoreCare, showcasing its features and usage steps for effective pore cleansing and aftercare.

