

[manuals.plus](#) /

› [1Mii](#) /

› [1Mii RT5066Pro 2.4Ghz Wireless Audio Transmitter Receiver User Manual](#)

1Mii RT5066Pro

1Mii RT5066Pro 2.4Ghz Wireless Audio Transmitter Receiver User Manual

Model: RT5066Pro

INTRODUCTION

The 1Mii RT5066Pro is a 2.4Ghz wireless audio transmitter and receiver kit designed to transmit high-fidelity audio wirelessly. This system allows you to send audio from various sources like TVs, PCs, or AV receivers to active speakers, subwoofers, or amplifiers without the need for long audio cables. It supports multiple input/output options including Optical, Coaxial, and 3.5mm (RCA) connections, offering flexibility for different audio setups.



Image: The 1Mii RT5066Pro wireless audio transmitter and receiver units, showcasing their compact design and external antennas.

Safety Information

- Do not expose the device to water or moisture.
- Avoid placing the device near heat sources or in direct sunlight.
- Use only the provided power adapters to prevent damage.
- Do not attempt to disassemble or repair the device yourself. Contact customer support for assistance.
- Keep the device away from strong magnetic fields.
- Ensure proper ventilation around the units during operation.

Package Contents

Verify that all items are present in the package:

- 1Mii RT5066Pro Wireless Audio Transmitter (Tx)
- 1Mii RT5066Pro Wireless Audio Receiver (Rx)
- 2 x USB Power Adapters
- 2 x Optical Audio Cables
- 2 x 3.5mm to 3.5mm Audio Cables
- 2 x Type-C Charging Cables
- User Manual (this document)



Image: All components included in the 1Mii RT5066Pro wireless audio kit, laid out for inspection.

PRODUCT OVERVIEW

The RT5066Pro kit consists of two main units: a Transmitter (Tx) and a Receiver (Rx). Both units feature a compact metal shell design with external antennas for enhanced signal range.

Transmitter (Tx) Unit

The transmitter unit is responsible for receiving audio from your source device and sending it wirelessly to the receiver.

- **Audio In Ports:** Optical, Coaxial, 3.5mm (for RCA connection via adapter).
- **DC 5V Port:** USB Type-C for power input.
- **Antenna Port:** For connecting the external antenna.
- **Power Button/Indicator:** Controls power and shows status.



Image: The transmitter unit of the 1Mii RT5066Pro, highlighting its audio input ports (Optical, Coaxial, 3.5mm) and power input.

Receiver (Rx) Unit

The receiver unit receives the wireless audio signal from the transmitter and outputs it to your audio playback device.

- **Audio Out Ports:** Optical, Coaxial, 3.5mm (for RCA connection via adapter).
- **DC 5V Port:** USB Type-C for power input.

- **Antenna Port:** For connecting the external antenna.
- **Power Button/Indicator:** Controls power and shows status.



Image: The receiver unit of the 1Mii RT5066Pro, showing its audio output ports (Optical, Coaxial, 3.5mm) and power input.

SETUP INSTRUCTIONS

Follow these steps to set up your 1Mii RT5066Pro wireless audio system.

1. Connect the Transmitter (Tx)

1. Connect one end of an audio cable (Optical, Coaxial, or 3.5mm) to the audio output port of your source device (e.g., TV, PC, AV Receiver).
2. Connect the other end of the audio cable to the corresponding **Audio In** port on the 1Mii RT5066Pro Transmitter unit.
3. Connect the Type-C charging cable to the **DC 5V** port on the Transmitter and plug the USB power adapter into a power outlet.

2. Connect the Receiver (Rx)

1. Connect one end of an audio cable (Optical, Coaxial, or 3.5mm) to the **Audio Out** port on the 1Mii RT5066Pro Receiver unit.
2. Connect the other end of the audio cable to the corresponding audio input port of your audio playback device (e.g., active speaker, subwoofer, amplifier).
3. Connect the Type-C charging cable to the **DC 5V** port on the Receiver and plug the USB power adapter into a power outlet.

Plug & Play And Easy to Use

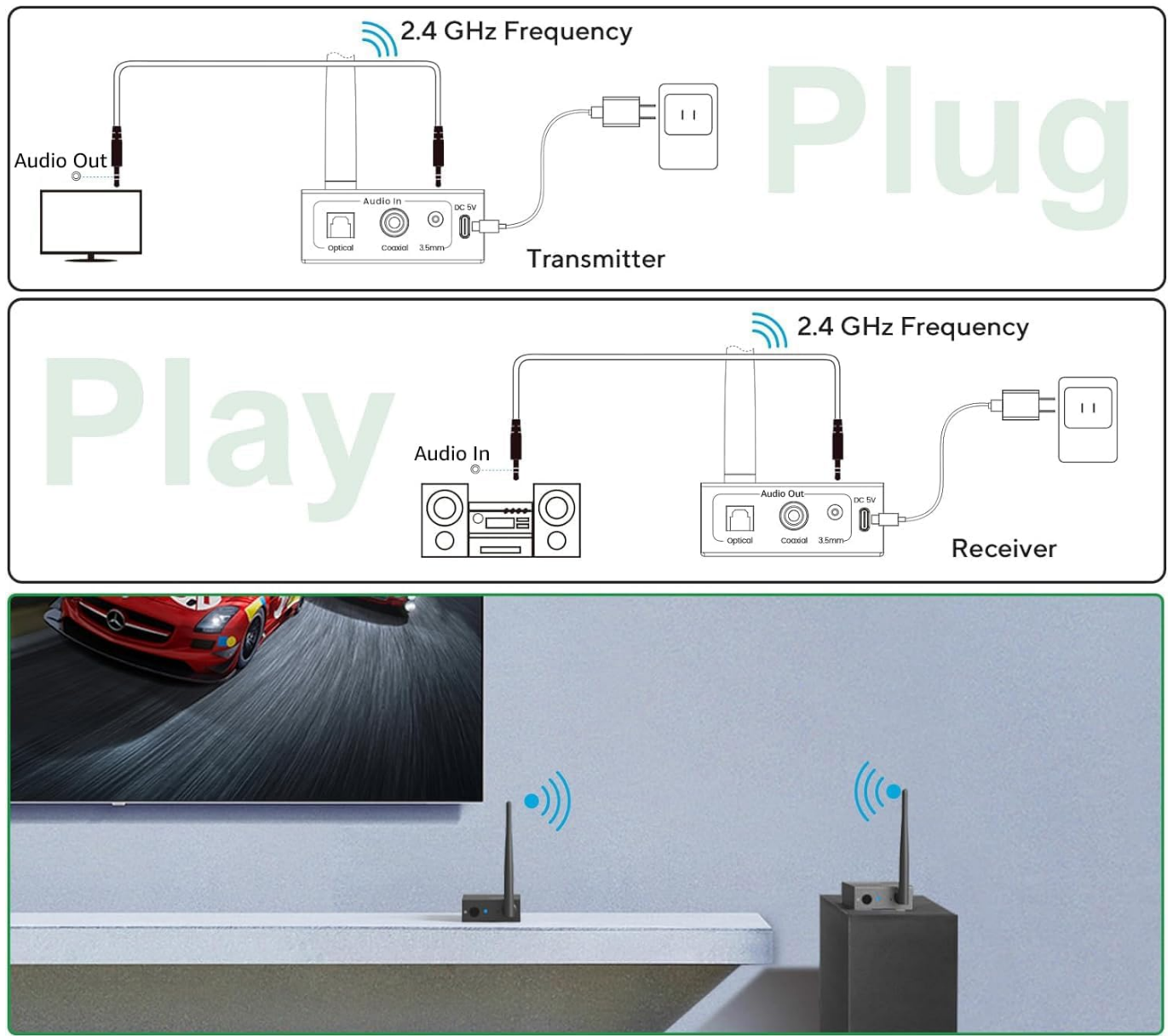

Image: A diagram illustrating the "Plug & Play" setup, showing how to connect the transmitter to an audio source (TV) and the receiver to an audio output device (stereo system).

3. Automatic Pairing

Once both the Transmitter and Receiver units are powered on, they will automatically search for and connect to each other. The indicator lights on both units will confirm a successful connection.

4. Audio Source Configuration (for TV Optical/Coaxial)

If you are using the Optical or Coaxial connection from your TV, you may need to adjust your TV's audio settings:

1. Navigate to your TV's **Settings** menu.
2. Select **Sound** or **Audio Output**.
3. Choose **Optical Out** or **Digital Out**.
4. Set the **Digital Audio Format** to **PCM/Stereo** or ensure **Dolby - Off**. The RT5066Pro does not support Dolby or DTS formats.

For Using TV Optical/Coaxial Port



Settings→Audio Out→Optical/Digital Out



Settings→Sound→Expert Settings→
Digital Audio Fromat→PCM/Stereo or Dolby - Off

Image: Screenshots of a television's audio settings menu, demonstrating how to select Optical/Digital Out and set the digital audio format to PCM/Stereo or turn Dolby off.

Note: The RT5066Pro is designed for audio transmission and does not support HDMI connections.



Image: A comprehensive diagram illustrating various input sources (TV, AV Receiver, PC) connected to the transmitter, and various output devices (Soundbar, Power Amplifier, Subwoofer, Active Speakers) connected to the receiver, highlighting Optical, Coaxial, and 3.5mm interfaces.

OPERATING INSTRUCTIONS

Power On/Off

Press the power button on each unit to turn it on or off. The units will automatically connect once powered on.

Audio Transmission

Once connected, audio from your source device will be wirelessly transmitted to your playback device. Ensure the volume on both your source and playback devices is adjusted appropriately.

The system operates on a 2.4GHz frequency, providing a low latency of less than 20ms, ensuring audio and video synchronization. It supports high-quality audio up to 24bit/192kHz.

Zero Latency Between Any Audio Devices

2.4GHz wireless technology
brings you perfect audio and video synchronization



Image: A diagram illustrating the concept of zero latency with 2.4GHz wireless technology, showing a person watching TV with synchronized audio from a speaker.

Range Considerations

The 1Mii RT5066Pro can achieve a wireless range of up to 328 feet (100m) outdoors and 100-165 feet (30-50m) indoors. For optimal performance and range, avoid placing the units near Wi-Fi routers (2.4G/5.8G) or other devices that may cause interference. Physical obstacles like walls and metal objects can also affect the transmission range.

Long Range & Stable Connection

up to 328FT (100M) and dual gain antenna



Extended Long Range

Up to 328FT (100M)



Image: An illustration demonstrating the extended long range capability of the 1Mii RT5066Pro, showing the transmitter and receiver units wirelessly connected across a large living space.

MAINTENANCE

- **Cleaning:** Use a soft, dry cloth to clean the units. Do not use liquid cleaners or aerosols.
- **Storage:** When not in use for extended periods, store the units in a cool, dry place away from direct sunlight.
- **Antennas:** Handle the antennas carefully to avoid bending or breaking them.

TROUBLESHOOTING

Problem	Possible Cause	Solution
---------	----------------	----------

Problem	Possible Cause	Solution
No audio output	<ul style="list-style-type: none">Units not powered on.Units not paired.Incorrect audio cable connection.TV audio settings incorrect (for Optical/Coaxial).Source/playback device volume too low.Unsupported audio format (e.g., Dolby/DTS).	<ul style="list-style-type: none">Ensure both Tx and Rx units are powered on.Verify indicator lights show a successful connection.Check all audio cables are securely connected to the correct input/output ports.Adjust TV audio output to PCM/Stereo and disable Dolby/DTS.Increase volume on both source and playback devices.Ensure the audio source is outputting a supported format (PCM/Stereo).
Static or distorted audio	<ul style="list-style-type: none">Interference from other 2.4GHz devices (e.g., Wi-Fi router).Units too far apart or obstacles blocking signal.Loose cable connections.	<ul style="list-style-type: none">Move the units away from Wi-Fi routers or other wireless devices.Reduce the distance between Tx and Rx, or reposition them to minimize obstacles.Ensure all cables are firmly connected.
RCA port not working (if using 3.5mm to RCA adapter)	<ul style="list-style-type: none">Potential compatibility issue with specific RCA cables/adapters.	<ul style="list-style-type: none">Ensure you are using a standard 3.5mm to RCA cable. Some users have reported better results with specific adapters if direct RCA connection is problematic.

SPECIFICATIONS





Feature	Detail
Model Number	RT5066Pro
Connectivity Technology	2.4GHz Wireless
Audio Sampling Rate	Up to 24bit/192kHz
Latency	Less than 20ms
Wireless Range (Outdoor)	Up to 328 feet (100m)
Wireless Range (Indoor)	100-165 feet (30-50m)
Input Ports (Tx)	Optical, Coaxial, 3.5mm AUX (RCA compatible)
Output Ports (Rx)	Optical, Coaxial, 3.5mm AUX (RCA compatible)
Power Input	DC 5V (USB Type-C)
Product Dimensions	3.43 x 2.76 x 0.98 inches (per unit)
Item Weight	10.4 ounces (295 grams)
Color	Black

WARRANTY AND SUPPORT

1Mii products are designed for reliability and performance. For warranty information and technical support, please refer to the official 1Mii website or contact their customer service directly. Keep your purchase receipt for warranty claims.

For further assistance, you may visit the [1Mii Store on Amazon](#).

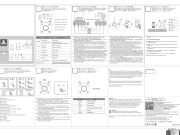
Related Documents - RT5066Pro

	<p>1Mii B03 Bluetooth 5.3 Transmitter Receiver User Manual</p> <p>User manual for the 1Mii B03 Bluetooth 5.3 Transmitter Receiver, detailing its features, operation, and troubleshooting for home stereo audio transmission with aptX Low Latency and HD support.</p>
	<p>1Mii B03Pro Bluetooth 5.0 Transmitter and Receiver User Manual</p> <p>User manual for the 1Mii B03Pro Bluetooth 5.0 audio transmitter and receiver. Features include aptX HD, Low Latency, ESS DAC, Optical/RCA/AUX connectivity, and dual-link for high-fidelity wireless audio streaming.</p>
	<p>1Mii B03 Bluetooth 5.0 Transmitter Receiver User Guide</p> <p>Comprehensive user guide for the 1Mii B03 Long Range Bluetooth 5.0 Transmitter and Receiver. Learn how to connect your TV or home stereo for wireless audio with aptX Low Latency support.</p>
	<p>1Mii B06Ultra Bluetooth Receiver User Manual</p> <p>User manual for the 1Mii B06Ultra Bluetooth 5.2 Receiver, detailing its features, setup, and operation for Hi-Res Wireless Audio.</p>
	<p>1Mii B03Pro Bluetooth 5.3 Transmitter Receiver: User Manual & Features</p> <p>A comprehensive guide to the 1Mii B03Pro Bluetooth 5.3 transmitter and receiver, detailing its advanced features, technical specifications, connection modes, and operational instructions for seamless wireless audio.</p>
	<p>1Mii B03 Bluetooth Transmitter Receiver HiFi Audio Adapter with aptX LL</p> <p>User manual for the 1Mii B03 Bluetooth 5.3 transmitter and receiver. Learn how to connect, pair, and use this HiFi audio adapter with aptX Low Latency for TVs, speakers, and headphones.</p>

Hi hi,
Thank you so much for your info.
We are now trying for you to use 1Mii RT5066Pro 2.4GHz Wireless Audio Transmitter Receiver Set.

1. How to use 1Mii RT5066Pro Transmitter & receiver to connect the TV and speaker?
2. Use the power supply adapter and USB charging cable to power on both the transmitter and receiver.
After power on, both RT5066Pro Transmitter and receiver will automatically enter pairing mode with red laser flashing back and red laser continuously paired, both indicators will be blue.
3. Connect the "AUDIO OUT" jack of your TV to the 3.5mm/Optical/Auxial Audio IN" jack of RT5066Pro Transmitter.
3. Connect the "AUDIO IN" jack of your speaker to the 3.5mm/Optical/Auxial Audio Out jack of RT5066Pro Receiver.
4. TV Settings:
After connect the RT5066Pro Transmitter to your TV via Optical/Auxial audio cable, please make sure the Audio Out is set to Digital/Analog (not Internal Speaker Output) and the audio format is set to PCM/Dolby.
Go to Settings and in Output/Output Format/Internal Speaker/Output.
Go to Settings/General/Output Settings/Output Audio Format/PCM/Dolby, or you can turn off Dolby.
If you connect the RT5066Pro Transmitter to your TV via 3.5mm AUX audio cable, the above TV settings are not required.

2. Troubleshooting:
No Sound/Not Sound:
-Make sure the RT5066Pro Transmitter is connected to the "AUDIO OUT" jack of your TV (Not AUDIO IN).
-Make sure the RT5066Pro Receiver is connected to the "AUDIO IN" jack of your speaker (Not AUDIO OUT).
-Make sure the audio cables are plugged fully (you can unplug and plug again).
-Have use Optical or Auxial audio cable. Set and format to PCM/External speaker/Optical and Dolby/DL.
-Plug more than one audio cable at the same time may cause no sound, please ONLY use Optical/Auxial/Auxial for Optical or 3.5mm jack.
Don't use RT5066Pro receiver in airtight room or screen panel because there will cause interference.
-RT5066Pro are 2.4G wireless devices, they can not be paired to any other 2.4G wireless devices, they can only be paired to each other.
If you have any questions about the RT5066Pro, please feel free to ask for help from us. We will always be here.
Best regards
Alice Support

[1Mii RT5066Pro 2.4GHz Wireless Audio Transmitter Receiver Set User Guide](#)

Tips and troubleshooting for the 1Mii RT5066Pro 2.4GHz Wireless Audio Transmitter Receiver Set, covering connection instructions and common sound issues.

lang:en score:40 filesize: 38.39 K page_count: 1 document date: 2025-06-24