



Manuals.plus /

- › Xbuyee /
- › Xbuyee 200W 2FT Linear High Bay LED Shop Light Instruction Manual

Xbuyee 200W

Xbuyee 200W 2FT Linear High Bay LED Shop Light Instruction Manual

Model: 200W-2Pack

[Overview](#) [Installation](#) [Operation](#) [Safety Information](#) [Product](#)
[Maintenance](#) [Troubleshooting](#) [Specifications](#) [Warranty & Support](#)

1. SAFETY INFORMATION

Please read and understand all instructions before installing or operating this product. Failure to follow these instructions may result in electric shock, fire, or other hazards that could cause personal injury or property damage.

- **Electrical Safety:** Ensure power is disconnected at the circuit breaker before installation or maintenance. All wiring must be in accordance with national and local electrical codes. If you are unsure about wiring, consult a qualified electrician.
- **Installation:** This fixture is designed for chain mount installation. Ensure the mounting surface and hardware can support the weight of the fixture. Do not install in locations where the operating temperature exceeds the specified range.
- **Handling:** Avoid direct eye exposure to the light source when the fixture is powered on. Do not touch the fixture when it is operating, as it may be hot.
- **Environment:** This product is intended for indoor use only. Do not expose to water or excessive moisture.

2. PRODUCT OVERVIEW

The Xbuyee 200W 2FT Linear High Bay LED Shop Light is designed for high-efficiency illumination in various commercial and industrial settings. It features adjustable wattage and color temperature, robust construction, and flexible lighting angles.

Key Features:

- **High Efficiency:** Delivers 28,000 lumens at 200W, with an efficiency of 140LM/W.

- **3 Wattages Adjustable:** Selectable power output at 200W, 150W, or 100W to suit different lighting needs.
- **Color Temperature Selectable:** Choose between 4000K (natural white) and 5000K (daylight) for optimal lighting ambiance.
- **Excellent Heat Dissipation:** Constructed with die-cast aluminum housing and multiple air vents for extended lifespan.
- **Flexible Lighting Angle:** 360° rotatable design allows adjustment of light direction.
- **0-10V Dimmable:** Compatible with 0-10V dimmer switches (not included) for adjustable brightness.
- **Anti-glare:** Frosted polycarbonate lens provides soft, even, and non-dazzling light.



Image: The Xbuyee 200W 2FT Linear High Bay LED Shop Light, showcasing its sleek design and robust construction.

What's in the Box:

- 2 x LED Linear High Bay Lights
- Mounting Hardware (2 x Strong Suspending Chains, 2 x V-Shaped Hooks)



2FT 200W Super Bright LED Linear High Bay Lights



28,000
Lumens



120° Beam
Angle



100-277V
Voltage



50,000h
Lifespan

Image: Diagram illustrating the product dimensions (23.6 in L x 9.84 in W x 1.96 in H) and included mounting accessories: two strong suspending chains and two V-shaped hooks.

3. INSTALLATION

The Xbuyee High Bay LED Shop Light is designed for hassle-free chain mount installation. Follow these steps carefully.

Installation Steps:

1. **Prepare Mounting Location:** Identify a suitable location on the ceiling for hanging the light fixture. Ensure the ceiling structure can support the weight of the light.
2. **Install Hooks:** Securely install appropriate ceiling hooks (not included, unless specified) into the ceiling.
3. **Attach V-Shaped Hooks:** Insert the V-shaped hooks into the slotted holes on the top of the light fixture.
4. **Connect Chains:** Attach the strong suspending chains to the V-shaped hooks on the fixture and then to the ceiling hooks. Ensure the fixture is level and securely suspended.

5. **Wiring Connections:** Make wiring connections with terminal caps. Connect the live, neutral, and ground wires according to local electrical codes. For 0-10V dimming, connect the dimming wires to a compatible 0-10V dimmer switch (not included).
6. **Secure Driver Box:** Insert the terminal cap and wires into the driver box, ensuring all connections are secure and insulated.
7. **Restore Power:** Once installation is complete and all connections are checked, restore power at the circuit breaker.

Hassle-Free Mounting

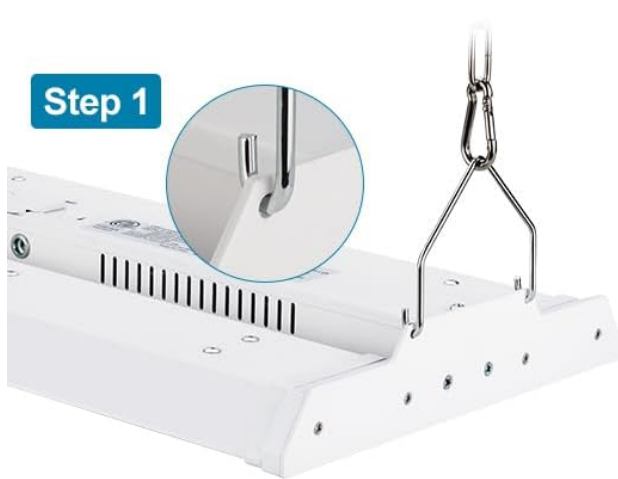

Step 1

Insert the hook into the slotted holes.

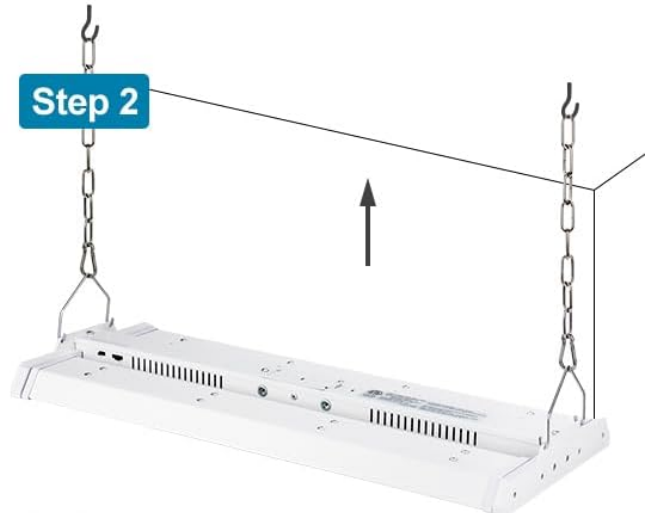

Step 2

Hook up the chain to the ceiling.



Step 3

Make wiring connections with terminal caps.

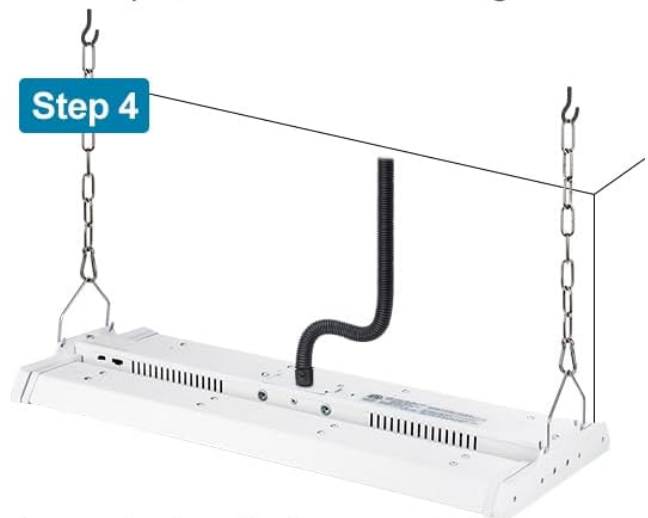

Step 4

Insert the terminal cap and wires into the driver box.

Image: A four-step visual guide demonstrating the hassle-free mounting process: 1. Inserting the V-shaped hook into slotted holes. 2. Hooking up the chain to the ceiling. 3. Making wiring connections with terminal caps. 4. Inserting the terminal cap and wires into the driver box.

[Your browser does not support the video tag.](#)

Video: An official product video from Xbuyee demonstrating the features and installation process of the LED Linear High Bay Light. This video highlights the frosted PC lens, integrated LEDs, sturdy aluminum housing, strong hanging chains, excellent heat dissipation, and flexible angle adjustment.

4. OPERATION

The Xbuyee High Bay LED Shop Light offers versatile settings for optimal lighting control.

Adjusting Wattage and Color Temperature:

The fixture features integrated switches for adjusting both wattage and color temperature. These switches are typically located on the fixture's body.

- **Wattage Selection:** Slide the wattage switch to select between 200W, 150W, or 100W. Adjusting the wattage will change the brightness (lumens) of the light.
- **Color Temperature Selection:** Slide the color temperature switch to choose between 4000K (Natural White) and 5000K (Daylight).

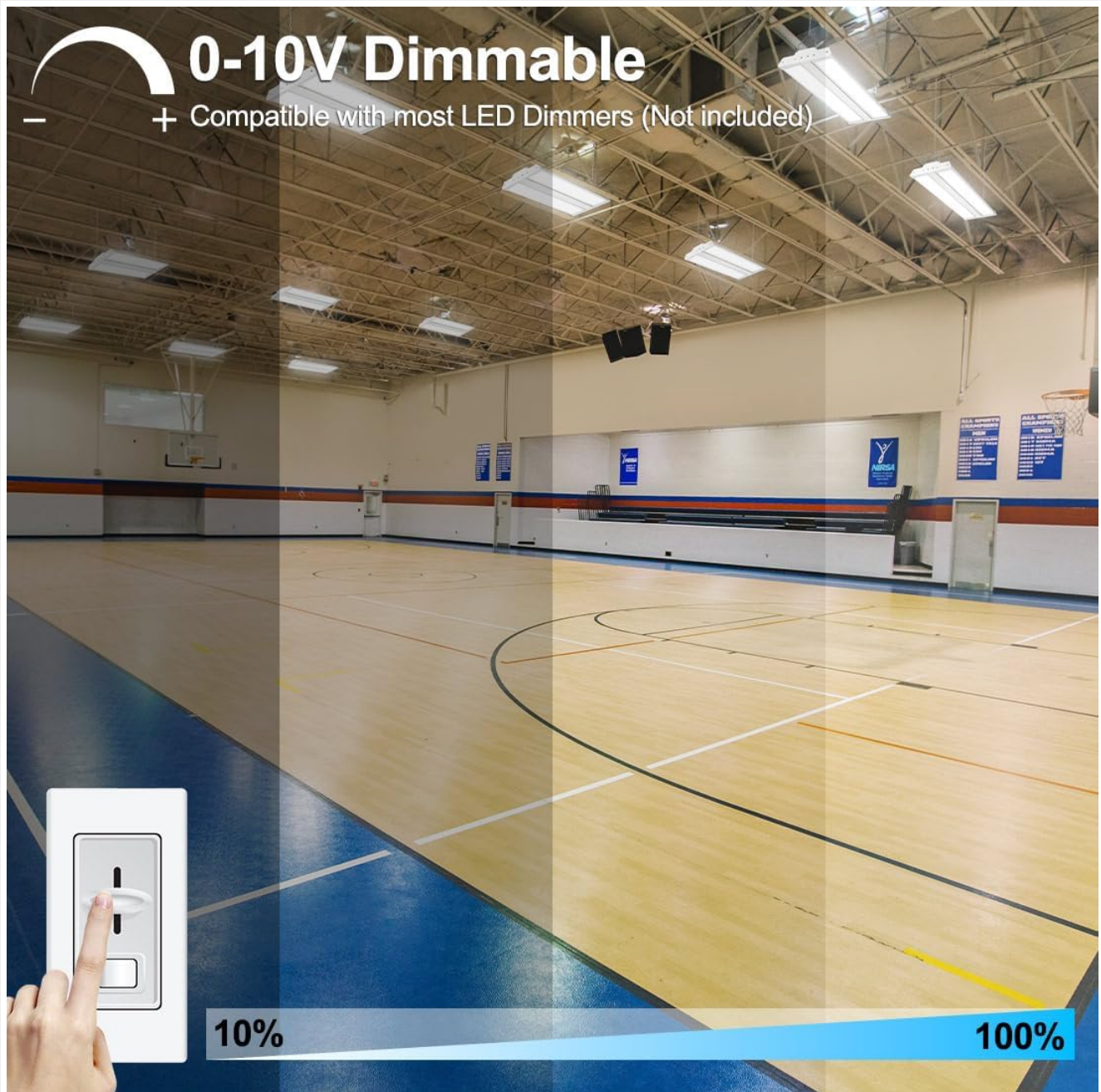

Image: Close-up view of the switches on the light fixture, indicating options for 200W/150W/100W power output and 5000K/4000K color temperature selection.

0-10V Dimming:

This fixture supports 0-10V dimming. To utilize this feature, connect the fixture to a compatible 0-10V dimmer switch (not included) during installation. The dimmer allows you to control the LED output intensity from 10% to 100% to achieve your desired lighting effect.

Flexible Angle Adjustment



360° 360° Rotatable

Image: Illustration of the 0-10V dimming feature, showing a dimmer switch adjusting light output from 10% to 100% in a large indoor space.

Flexible Angle Adjustment:

The light panels of the fixture can be rotated 360° to adjust the lighting direction. Gently rotate the panels inwards or outwards to direct light precisely where needed.

Rugged Construction

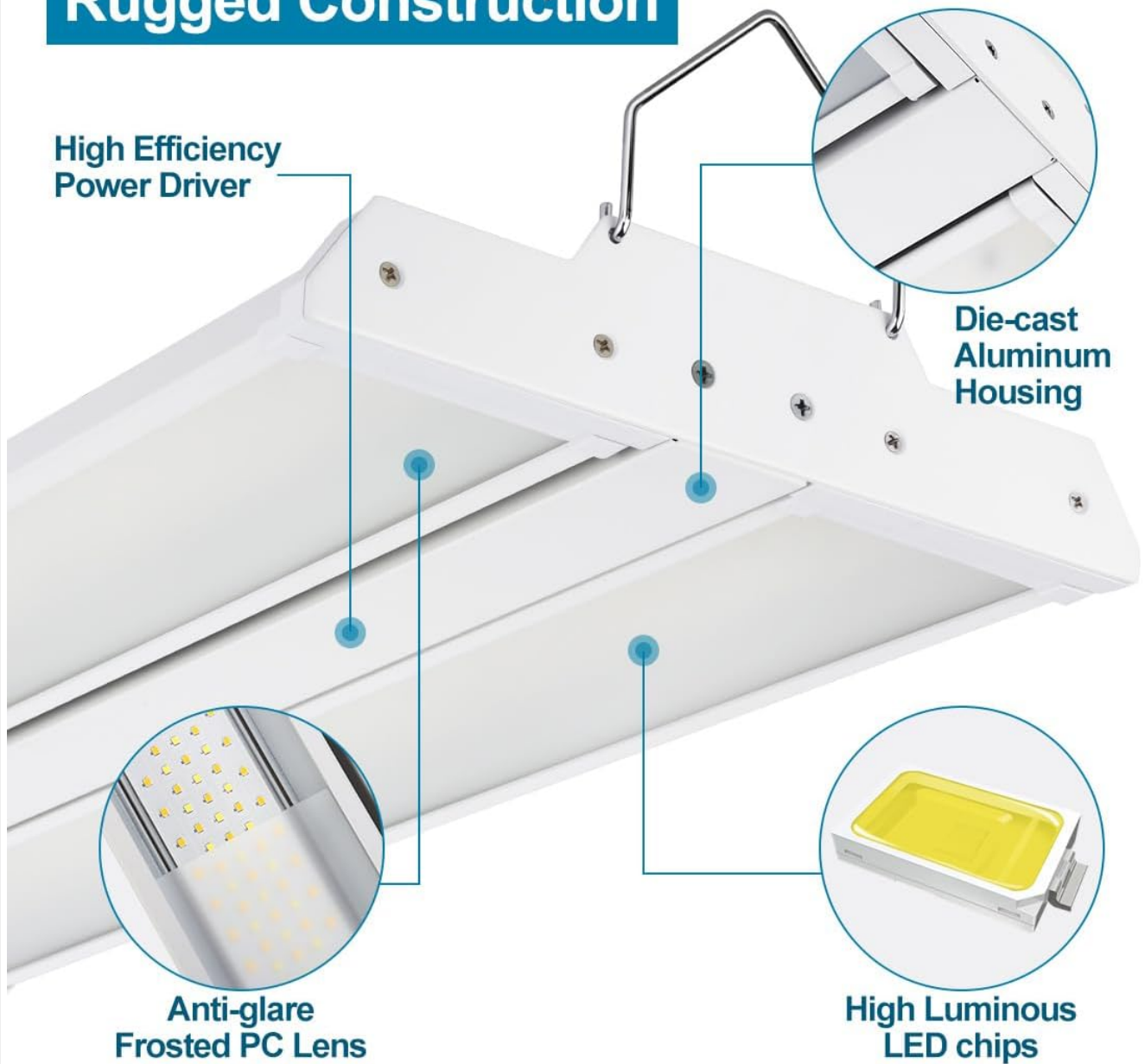

Image: A diagram illustrating the 360° rotatable feature of the light panels, showing how they can be adjusted for flexible lighting angles.

5. MAINTENANCE

Regular maintenance ensures optimal performance and longevity of your Xbuyee LED Shop Light.

- **Cleaning:** Disconnect power before cleaning. Use a soft, dry, or slightly damp cloth to wipe the exterior of the fixture. Avoid abrasive cleaners, solvents, or harsh chemicals that could damage the finish or electrical components.
- **Inspection:** Periodically inspect the fixture, mounting hardware, and wiring for any signs of damage, wear, or loose connections. Address any issues promptly.
- **LEDs:** The LED light source is integrated and not user-replaceable. The fixture has a long lifespan of approximately 50,000 hours.

6. TROUBLESHOOTING

If you encounter issues with your Xbuyee LED Shop Light, refer to the following common problems and solutions:

Problem	Possible Cause	Solution
Light does not turn on	No power supply; Loose wiring; Faulty switch/dimmer	Check circuit breaker; Verify all wiring connections are secure; Test switch/dimmer for functionality.
Light flickers or dims unexpectedly	Incompatible dimmer; Loose wiring; Power fluctuations	Ensure 0-10V dimmer compatibility; Check wiring connections; Consult an electrician for power supply issues.
Incorrect wattage or color temperature	Switches set incorrectly	Adjust the wattage and color temperature switches on the fixture to the desired settings.
Light output is too low	Wattage set too low; Dimmer setting too low	Increase wattage setting on the fixture; Adjust dimmer to a higher brightness level.

If the problem persists after attempting these solutions, please contact Xbuyee customer support.

7. SPECIFICATIONS

Detailed technical specifications for the Xbuyee 200W 2FT Linear High Bay LED Shop Light.

Attribute	Value
Brand	Xbuyee
Model	200W-2Pack
Wattage	200W (Tunable: 200W/150W/100W)
Brightness	28000 Lumens (at 200W)
Efficiency	140 lumens per watt
Color Temperature	4000K / 5000K Selectable
Voltage	100-277 Volts
Dimmable	0-10V Dimmable
Light Source Type	LED (SMD2835 chips)
Material	Die-cast aluminum, Polycarbonate Lens
Product Dimensions	23.6"L x 9.84"W x 1.96"H
Item Weight	14.87 pounds (for 2-pack)
Lifespan	50,000 hours
Installation Type	Chain Mount (Hook Mount)
Indoor/Outdoor Usage	Indoor
Certification	ETL Qualified

8. WARRANTY & SUPPORT

Xbuyee stands behind the quality of its products.

- **5-Year Warranty:** This product is covered by a 5-year warranty from the date of purchase. This warranty covers defects in materials and workmanship under normal use.
- **Customer Support:** For any issues, questions, or warranty claims, please contact Xbuyee customer support through the platform where the product was purchased. Provide your order number and a detailed description of the issue for prompt assistance.