

## PDP 049-023-BLSM

# PDP Gaming REMATCH GLOW Enhanced Wired Controller User Manual

Model: 049-023-BLSM



## 1. INTRODUCTION

This manual provides comprehensive instructions for the setup, operation, and maintenance of your PDP Gaming REMATCH GLOW Enhanced Wired Controller. This controller is officially licensed for Xbox Series X|S, Xbox One, and Windows PC, offering advanced features for an enhanced gaming experience.



Image 1.1: Front view of the PDP Gaming REMATCH GLOW Enhanced Wired Controller with Cherry Blossom design.

## 2. PACKAGE CONTENTS

Verify that all items are present in your package:

- PDP Gaming REMATCH GLOW Enhanced Wired Controller
- 8-foot (2.4m) Detachable USB-C Cable
- Instruction Manual (this document)

## 3. SETUP

### 3.1 Connecting the Controller

1. Locate the USB-C port on the top of your PDP Gaming REMATCH GLOW Enhanced Wired Controller.
2. Connect the smaller end of the included 8-foot USB-C cable to the controller's USB-C port.
3. Connect the larger USB-A end of the cable to an available USB port on your Xbox console (Xbox Series X|S,

Xbox One) or Windows PC.

4. The controller will automatically power on and connect to your device. The Xbox button on the controller will illuminate to indicate a successful connection.



Image 3.1: The detachable 8-foot USB-C cable provides a reliable wired connection.

### 3.2 Installing the PDP Control Hub App

For advanced customization, download the free PDP Control Hub App:

- On Xbox: Search for "PDP Control Hub" in the Xbox Store.
- On PC: Search for "PDP Control Hub" in the Microsoft Store.

Install the application and launch it with your controller connected to access customization options.



Image 3.2: The PDP Control Hub App allows for extensive controller customization.

## 4. OPERATING INSTRUCTIONS

### 4.1 Programmable Back Buttons

The controller features two programmable back buttons for quick access to frequently used functions.

- **Mapping:** Use the PDP Control Hub App to assign any standard controller button function to the back buttons.
- **Benefits:** This allows for faster reactions and improved ergonomics during gameplay, as you can keep your thumbs on the analog sticks.

# PROGRAM BACK BUTTONS

For Quicker Responses



Image 4.1: The programmable back buttons are located on the underside of the controller grips.

## 4.2 Audio Controls and Mic Mute

Integrated audio controls on the D-pad allow for convenient adjustments:

- **Volume Control:** Use the D-pad to adjust game and chat audio levels.
- **Mic Mute:** Double-tap the "Function" button to quickly mute or unmute your microphone.
- **Headset Connection:** Connect your headset via the 3.5mm audio jack located at the bottom of the controller.



# ON-BOARD CONTROLS

With the D-Pad

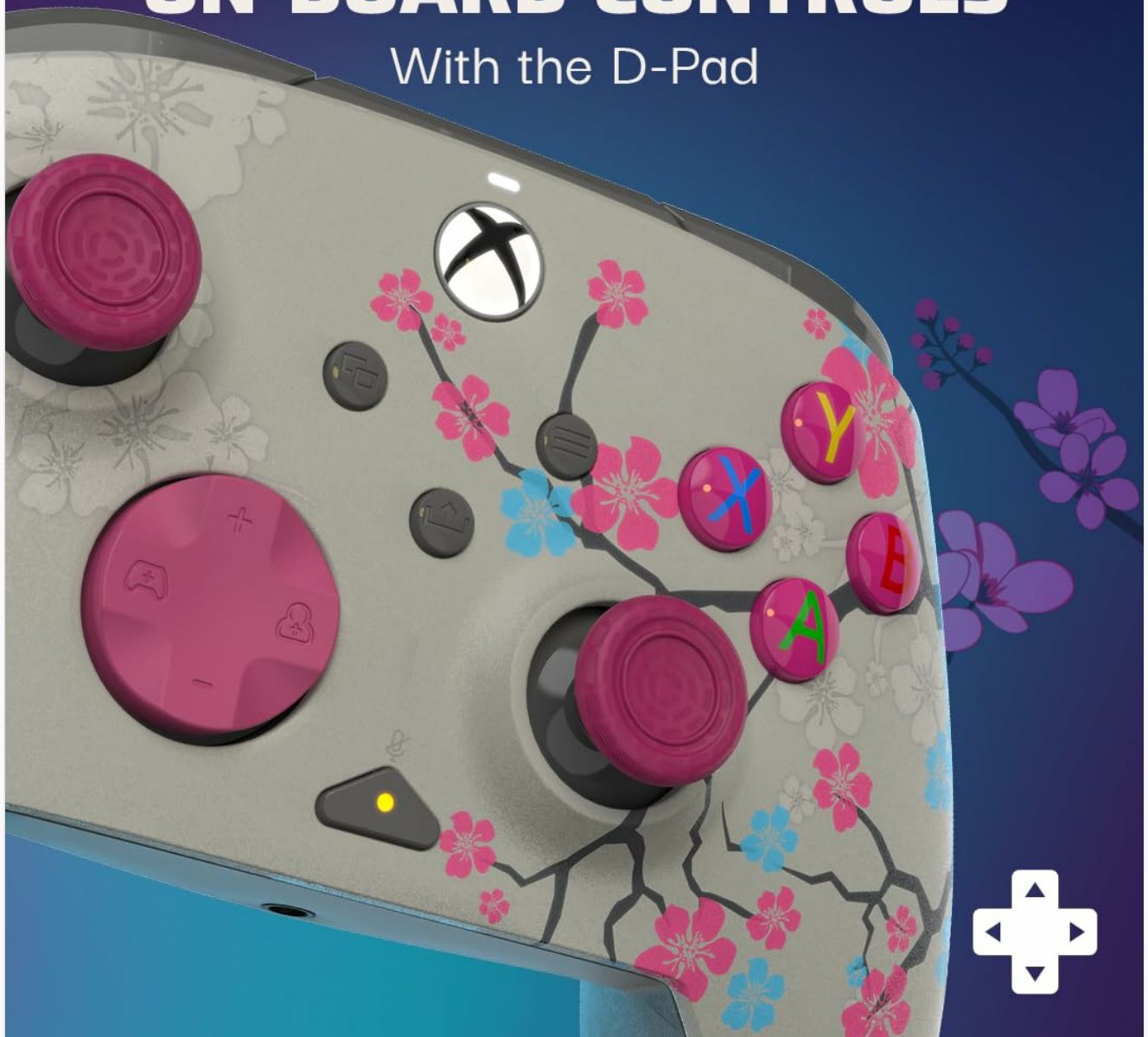

Image 4.2: On-board controls for audio adjustments and mic mute.

## 4.3 PDP Control Hub App Customization

The PDP Control Hub App provides extensive customization options:

- **Button Remapping:** Reassign any button to a different function.
- **Trigger Configuration:** Adjust trigger dead zones and sensitivity.
- **Dead Zone Adjustment:** Fine-tune analog stick dead zones for precise control.
- **Firmware Updates:** Keep your controller up-to-date with the latest performance enhancements and bug fixes.

## 4.4 Glow-in-the-Dark Feature

The controller's unique design elements glow in the dark after exposure to light. This is a cosmetic feature and does not affect controller functionality.

# GLOW IN THE DARK

## For Unique Design



Image 4.3: The controller's design glows in low-light conditions.

### 4.5 Share Button

Utilize the dedicated Share button to capture screenshots and video clips of your gameplay, making it easy to share your gaming moments.

## 5. MAINTENANCE

- **Cleaning:** Use a soft, dry cloth to clean the controller. Avoid abrasive cleaners or solvents.
- **Storage:** Store the controller in a cool, dry place away from direct sunlight and extreme temperatures.
- **Cable Care:** Avoid sharp bends or kinks in the USB-C cable to prevent damage.

## 6. TROUBLESHOOTING

- **Controller Not Responding:**
  - Ensure the USB-C cable is securely connected to both the controller and the console/PC.

- Try connecting the controller to a different USB port.
- Restart your console or PC.
- Test the controller on another compatible device if possible.

- **Audio Issues:**

- Verify your headset is fully plugged into the 3.5mm jack.
- Check the in-game and console/PC audio settings.
- Ensure the microphone is not muted (double-tap the Function button).

- **Customization App Not Working:**

- Ensure the controller is connected and recognized by your system.
- Close and reopen the PDP Control Hub App.
- Check for app updates in the Xbox or Microsoft Store.
- Consider reinstalling the PDP Control Hub App.

- **Firmware Update Issues:**

- Ensure a stable internet connection during firmware updates.
- Do not disconnect the controller during an update.
- If an update fails, try again or contact support.

## 7. SPECIFICATIONS

Feature	Detail
Model Number	049-023-BLSM
Compatibility	Xbox Series X S, Xbox One, Windows 10/11 PC
Connectivity	Wired (8-foot USB-C to USB-A cable)
Audio	3.5mm Headset Jack, On-board Audio Controls, Mic Mute
Special Features	Programmable Back Buttons, Dual Rumble Motors, Impulse Triggers, Glow-in-the-Dark Design, Dedicated Share Button, PDP Control Hub App Support
Dimensions	3.23 x 6.89 x 6.89 inches (8.2 x 17.5 x 17.5 cm)
Weight	10.6 ounces (300.5 grams)
Manufacturer	PDP

## 8. WARRANTY AND SUPPORT

### 8.1 Warranty Information

PDP products are designed for quality and performance. For specific warranty details regarding your PDP Gaming REMATCH GLOW Enhanced Wired Controller, please refer to the warranty card included with your product or visit the official PDP website.

### 8.2 Customer Support



If you encounter any issues not covered in this manual or require further assistance, please contact PDP Customer Support:

- **Online Support:** Visit the official PDP support website for FAQs, troubleshooting guides, and contact forms.
- **Contact Information:** Refer to the product packaging or PDP's official website for current customer service phone numbers or email addresses.

Please have your product model number (049-023-BLSM) and proof of purchase available when contacting support.



Related Documents - 049-023-BLSM

	<p><a href="#">PDP REMATCH Wired Controller for Xbox Quick Start Guide</a></p> <p>This guide provides instructions for setting up and using the PDP REMATCH Wired Controller for Xbox, including features like microphone muting, volume control, game/chat balance, back button programming, and hair trigger mode. It also details how to use the PDP Control Hub app for further customization.</p>
	<p><a href="#">REMATCH Wired Controller for Nintendo Switch: Quick Start Guide</a></p> <p>Quick start guide for the REMATCH Wired Controller for Nintendo Switch, covering initial setup, audio configuration, volume controls, and back button programming.</p>
	<p><a href="#">PDP Wired Controller for Xbox Quick Start Guide</a></p> <p>A quick start guide for the PDP Wired Controller for Xbox, covering initial setup, volume control, microphone muting, game/chat balance, and customization via the PDP Control Hub app. Includes warranty information in multiple languages.</p>
	<p><a href="#">PDP Wired Controller for Xbox Quick Start Guide and Warranty Information</a></p> <p>Get started with your PDP Wired Controller for Xbox. This guide provides quick setup instructions, details on volume and microphone control, and comprehensive limited warranty information.</p>
	<p><a href="#">PDP Wired Controller for Xbox Quick Start Guide</a></p> <p>Get started quickly with your PDP Wired Controller for Xbox. This guide provides setup instructions, button functions, and warranty information.</p>

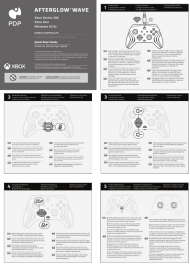

### [PDP Afterglow Wave Wired Controller: Quick Start Guide & Features](#)

Learn how to set up and use your PDP Afterglow Wave Wired Controller for Xbox Series X|S, Xbox One, and PC. Includes instructions on mute, volume, lighting effects, button mapping, and the PDP Control Hub app.