

HCMOBI RS1

HCMOBI RS1 Basic Elderly Mobile Phone User Manual

Model: RS1 | Brand: HCMOBI

1. INTRODUCTION

The HCMOBI RS1 is a 4G-LTE basic mobile phone designed for ease of use, particularly for seniors. It features large buttons, a clear display, loud volume, and essential functions like an SOS emergency button and speed dial. This manual provides detailed instructions for setting up, operating, and maintaining your RS1 mobile phone.



Image 1.1: The HCMOBI RS1 Basic Elderly Mobile Phone shown with its charging dock. The phone features a black casing, large physical buttons, and a small color display.

2. PACKAGE CONTENTS

Please check the package contents upon unboxing to ensure all items are present:

- HCMOBI RS1 Mobile Phone
- User Manual
- Battery
- Type-C USB Cable
- Charging Dock
- Charger (Power Adapter)

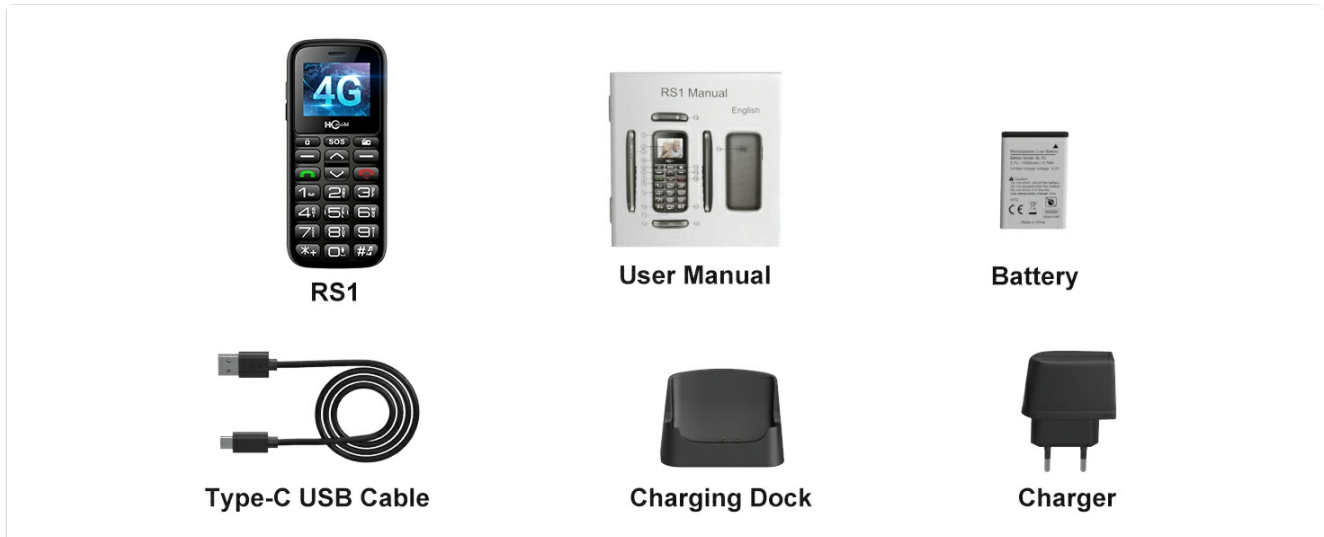

Image 2.1: An illustration showing the complete package contents, including the RS1 phone, user manual, battery, Type-C USB cable, charging dock, and charger.

3. PHONE OVERVIEW

The RS1 phone is designed with user-friendliness in mind. Key features include:

- **Large Buttons:** 14x9mm buttons to prevent accidental touches.
- **1.77-inch LCD Display:** Clear display with large text and icons.
- **Loud Speaker:** Enhanced audio for calls and notifications.
- **SOS Button:** Dedicated button for emergency calls and messages.
- **Dual SIM Support:** Allows use of two SIM cards simultaneously.
- **Flashlight:** Integrated LED flashlight for convenience.
- **FM Radio & MP3 Player:** Entertainment features.
- **Bluetooth 5.0:** For wireless connectivity.

Big Button & Loud Clear Sound



Image 3.1: A close-up view of the HCMOBI RS1 phone highlighting its large, clearly labeled buttons (14mm x 9mm) and the display showing large text, designed for easy visibility.



Image 3.2: The RS1 phone screen displaying icons for various functions including FM Radio, 4G LTE, SOS, Speed Dial, MP3 Player, Flashlight, Calendar, Big Button, Dual SIM, Bluetooth, SMS, and Menu.

Clear Loud Sound

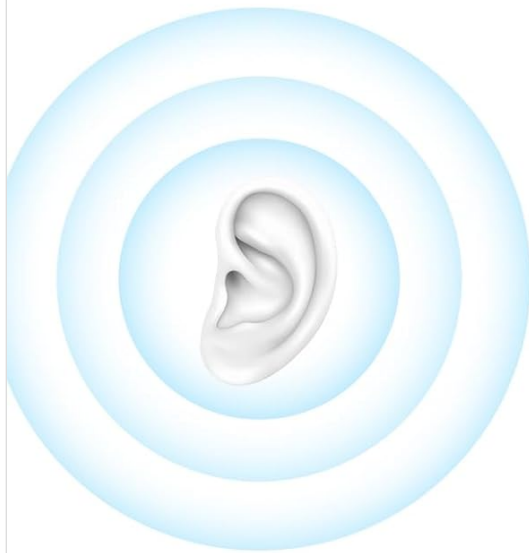

Image 3.3: An illustration demonstrating the clear loud sound feature of the HCMOBI RS1 phone, with sound waves emanating from the earpiece and speaker, and an ear icon for emphasis.

4. SETUP

4.1. Installing SIM Card(s) and Battery

The RS1 supports dual SIM cards and an optional SD card for expanded storage (up to 32GB).

1. Remove the back cover of the phone.
2. If present, remove the battery.
3. Locate the SIM card slots. Push back and open the metal slot cover.
4. Insert your SIM card(s) into the designated slots with the gold contacts facing down.
5. Push forward and lock the metal slot cover.
6. If using an SD card, insert it into the SD card slot.
7. Insert the battery, ensuring the contacts align correctly.

8. Replace the back cover.

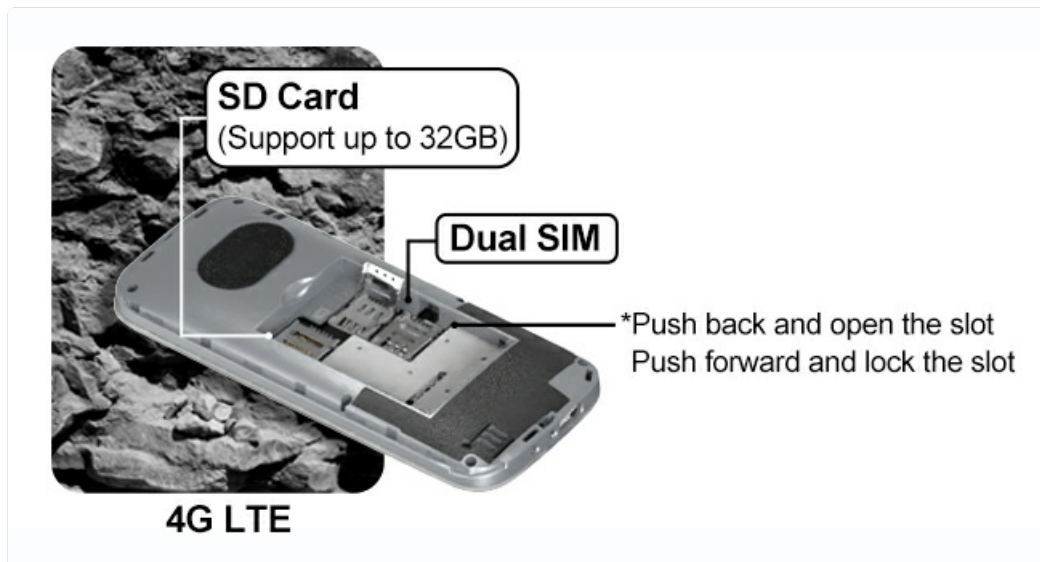

Image 4.1: A diagram illustrating the internal layout of the HCMOBI RS1 phone, showing the dual SIM card slots and the SD card slot (supports up to 32GB). Instructions for opening and locking the slots are also shown.

4.2. Charging the Phone

Before first use, fully charge the phone battery. The phone can be charged using the Type-C USB cable directly or via the charging dock.

1. **Using USB Cable:** Connect the Type-C USB cable to the phone's charging port and the other end to the charger. Plug the charger into a power outlet.
2. **Using Charging Dock:** Connect the charger to the charging dock. Place the phone onto the charging dock, ensuring it sits securely and the charging indicator appears on the screen.

A full charge typically takes approximately 3 hours. The 1000mAh battery provides 6-8 hours of talk time and over 10 days of standby time.



Image 4.2: The HCMOBI RS1 phone being charged. The left panel shows the phone connected directly via a Type-C USB cable, and the right panel shows the phone placed in its charging dock.

5. OPERATING INSTRUCTIONS

5.1. Power On/Off

- **To Power On:** Press and hold the **Red Call End/Power** button until the screen lights up.
- **To Power Off:** Press and hold the **Red Call End/Power** button until the power off options appear, then select "Power Off".

5.2. Making and Receiving Calls

- **To Make a Call:** Enter the phone number using the keypad and press the **Green Call** button.
- **To Answer a Call:** Press the **Green Call** button when the phone rings.
- **To End a Call:** Press the **Red Call End/Power** button.

5.3. SOS Emergency Function

The SOS button allows you to quickly contact pre-set emergency contacts in critical situations.

1. Setting SOS Contacts:

- From the main menu, navigate to "SOS".
- Select "SOS Contact".
- Choose an empty slot or an existing contact to edit.
- Enter the emergency contact number and save. You can set up to 5 emergency contacts.

2. Using the SOS Function:

- In an emergency, press and hold the dedicated **SOS** button on the back of the phone for 2 seconds.
- The phone will automatically call the pre-set emergency contacts one by one until one answers.
- An emergency SMS message will also be sent to all pre-set SOS contacts.



Image 5.1: A close-up view of the HCMOBI RS1 phone, highlighting the prominent red SOS button on the back, indicating its emergency function.

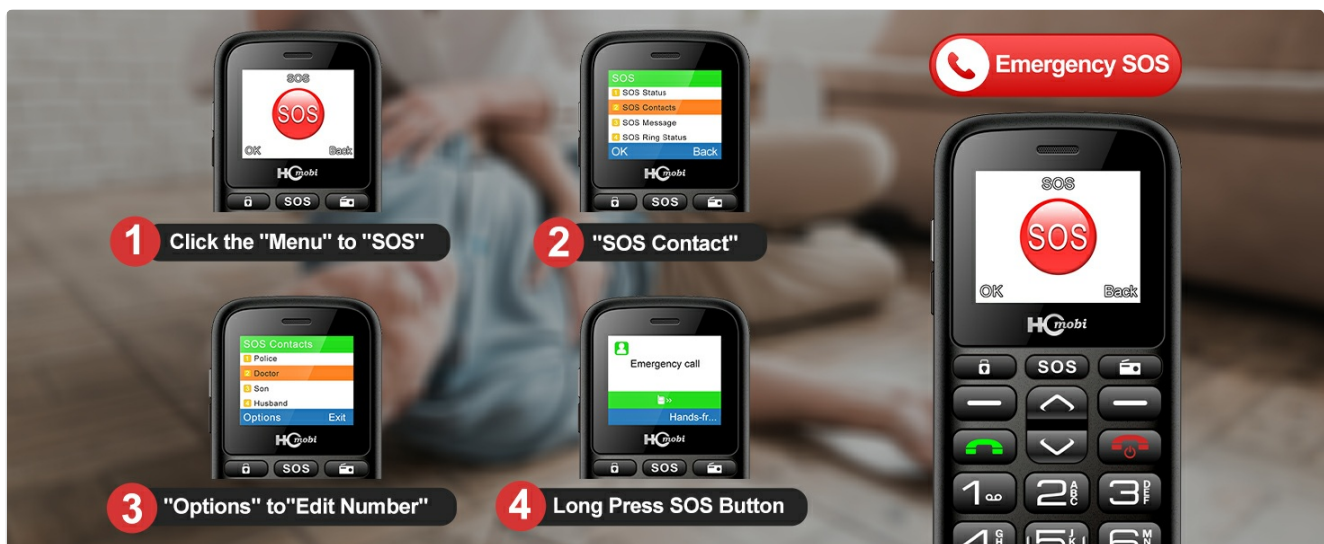

Image 5.2: A visual guide demonstrating the four steps to set up the SOS emergency function: 1. Click "Menu" to "SOS", 2. Select "SOS Contact", 3. "Options" to "Edit Number", and 4. Long press the SOS button to activate.



Image 5.3: The HCMOBI RS1 phone held in a hand, with the SOS button highlighted, against a blurred background of an ambulance, emphasizing its use for emergency calls and text messages.

5.4. Speed Dial

The RS1 allows you to set 8 speed dial buttons (keys 2-9) for quick access to important contacts.

1. Setting Speed Dial Contacts:

- Go to "Contacts" from the main menu.
- Select "Options" then "Others".
- Choose "Speed Dial".
- Select a number (2-9) and choose "Edit" to assign a contact or enter a new number.
- Save the contact.

2. Using Speed Dial:

- From the idle screen, long press the assigned number key (2-9) to dial the pre-set contact.

8 Speed Dials-Convenient Call

- Set up a preferred number, parents don't have to look in the phone book, one-click call

- Setting procedure:

Contact——Options——Others——Speed Dial——

Select a Number——Edit——Enter Phone Number——OK



Image 5.4: The HCMOBI RS1 phone keypad with numbers 2 through 9 highlighted, indicating their function as speed dial buttons. Examples of assigned contacts like "Son", "Wife", "Grandson", "Granddaughter", "Nick", "Jason", and "Jack" are shown.

Setting Procedure



Speed Dial for the Elderly



Image 5.5: A visual guide detailing the procedure for setting up speed dial contacts on the HCMOBI RS1 phone, starting from "Contact" and navigating through "Options", "Others", "Speed Dial", and "Edit".

5.5. Flashlight

To activate the built-in flashlight, press and hold the "0" button for 2 seconds from the idle screen. Repeat to turn it off.



Image 5.6: The HCMOBI RS1 phone with its high-bright flashlight activated, illustrating how to use the "0" key to turn it on and off.

5.6. Language Settings

You can change the display language of the phone.

1. From the main menu, select "Settings".
2. Navigate to "Phone settings".
3. Choose "Language settings".
4. Select "Display language" or "Writing language".
5. Choose your desired language (e.g., English, Español, Italiano).



Image 5.7: A visual guide showing the five steps to change the language settings on the HCMOBI RS1 phone: 1. Click "Menu" to "Settings", 2. Select "Phone settings", 3. Choose "Language settings", 4. Select "Display language/Writing language", and 5. Choose "English" or another desired language.



Image 5.8: The HCMOBI RS1 phone screen showing options for multilingual languages and large font display, emphasizing accessibility features.

6. MAINTENANCE

Proper care and maintenance will extend the life of your HCMOBI RS1 phone:

- Keep the phone dry. Moisture can damage electronic circuits.
- Avoid extreme temperatures. High temperatures can shorten the life of electronic devices and warp or melt certain plastics.
- Do not use harsh chemicals, cleaning solvents, or strong detergents to clean the phone. Wipe it with a soft, damp cloth.
- Handle the phone gently. Do not drop, knock, or shake it. Rough handling can break internal circuit boards and fine mechanics.
- Keep the phone away from dust and dirt, which can cause malfunction.

7. TROUBLESHOOTING

If you encounter issues with your HCMOBI RS1 phone, refer to the following common problems and solutions:

Problem	Possible Cause	Solution
---------	----------------	----------

Problem	Possible Cause	Solution
Phone does not turn on.	Battery is depleted or not properly installed.	Ensure the battery is correctly inserted and fully charged. Connect the phone to the charger for at least 30 minutes before attempting to power on.
Cannot make or receive calls.	No SIM card, SIM card not properly inserted, or no network signal.	Check if the SIM card is correctly installed. Ensure you are in an area with network coverage. Verify that the SIM card is active with your service provider. Note: Not compatible with CDMA carriers like Verizon, Sprint, Boost, AT&T.
Poor call quality or low volume.	Weak network signal, speaker/microphone obstruction, or volume settings.	Move to an area with better network reception. Ensure the speaker and microphone are not blocked. Adjust the call volume using the side buttons.
SOS function not working.	SOS contacts not set up or incorrect numbers.	Verify that emergency contacts are correctly programmed in the SOS settings. Ensure the phone has network signal to send calls/SMS.
Phone not charging.	Charger or cable faulty, or charging port/dock connection issue.	Check if the charger and USB cable are working correctly. Ensure the cable is securely connected to both the phone/dock and the power adapter. Try charging directly via cable if using the dock, or vice versa.

8. SPECIFICATIONS

Model Name	RS1
Brand	HCMOBI
Operating System	MOCOR RTOS
Cellular Technology	4G-LTE (Not compatible with CDMA Verizon, Sprint, Boost, AT&T)
Screen Size	1.77 Inches
Battery Capacity	1000mAh
Talk Time	6-8 Hours
Standby Time	Over 10 Days
Charging Time	Approx. 3 Hours
Connectivity	Type-C USB, Bluetooth 5.0
Special Features	SOS Emergency Button, Speed Dial, Dual SIM, FM Radio, Flashlight, Large Buttons, Loud Speaker
Product Dimensions	2.09 x 0.55 x 4.8 inches

Item Weight	6.7 ounces (190 grams)
-------------	------------------------



Image 8.1: An illustration highlighting the 1000mAh battery capacity of the HCMOBI RS1 phone.



9. WARRANTY AND SUPPORT

The HCMOBI RS1 Basic Elderly Mobile Phone comes with **a2-year warranty** from the date of purchase. For any questions, technical assistance, or warranty claims, please contact HCMOBI customer service. Our support team is available to provide assistance.

Please refer to the contact information provided with your purchase documentation or visit the official HCMOBI website for support details.

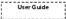
Related Documents - RS1

	<p>C8 Mobile Phone Quick User Guide - HCMobi</p> <p>Get started with your HCMobi C8 mobile phone. This quick user guide covers essential features, specifications, FCC compliance, and SAR information for the C8 model.</p>
	<p>S800 1328E Mobile Phone User Guide</p> <p>Comprehensive user guide for the S800 1328E mobile phone, covering setup, features, operations, safety, and care instructions.</p>

	<p>HOUSBAY GLOW Digital Alarm Clock User Manual - Setup, Features, and Operation</p> <p>Comprehensive user manual for the HOUSBAY GLOW digital alarm clock. Learn how to set the time, alarms, use the FM radio, nightlight, sleep timer, nap timer, and understand its features and specifications.</p>
	<p>RS1 Remote Controller User Manual - Shenzhen DBS Technology</p> <p>Comprehensive user manual for the Shenzhen DBS Technology RS1 electric skateboard remote controller, covering setup, operation, indicators, and troubleshooting.</p>
	<p>Falcon Ridge Polaris RZR RS1 Polycarbonate Rear Window Installation & Care Guide</p> <p>Detailed installation guide for the Falcon Ridge Polycarbonate Rear Window (PO-RS1-RW02) for the Polaris RZR RS1. Includes parts list, installation steps, return policy, and warranty information.</p>