

## Nexete BY06

# Nexete Universal Ceiling Fan Wall Remote Control (Model BY06) Instruction Manual

Model: BY06

## INTRODUCTION

---

This manual provides detailed instructions for the installation, operation, and maintenance of your Nexete Universal Ceiling Fan Wall Remote Control, Model BY06. This in-wall wired switch is designed to replace existing wall controls for ceiling fans, offering adjustable 3-speed fan control and light dimming capabilities. It is compatible with various ceiling fan receivers, including those from Hampton Bay, Harbor Breeze, and Hunter.

## IMPORTANT SAFETY INFORMATION

---

- **WARNING!** This switch requires connection to Live and Load wires only. **DO NOT connect the "NEUTRAL" supply wire of the electric circuit to the transmitter wall switch.** Doing so can cause damage to the transmitter and may result in fire.
- Always turn off power at the circuit breaker before installing or servicing the control.
- Installation should be performed by a qualified electrician or in accordance with local electrical codes.
- Ensure all wire connections are secure and properly insulated.
- This device is for indoor use only.

## PRODUCT FEATURES

---

# Product Features



## Power Switch

Control all the buttons



## “FAN OFF” Button

Turn off the fan



## 3 Fan Speed

High/Medium/Low



## Light Dimmer

Brightness or on/off

Image: Nexete Wall Remote Control with its key features labeled, including power switch, fan off button, 3 fan speeds (High/Medium/Low), and light dimmer function.

- **In-Wall Wired Switch:** Designed as a direct replacement for existing wall controls, requiring no neutral wire.
- **4 DIP Switches:** Features 16 selectable code frequencies to prevent interference and allow pairing with specific receivers.
- **3-Speed Fan Control:** Offers High, Medium, Low, and Fan Off settings.
- **Light Dimming Capability:** Press and hold the light button to cycle through the dimming range.
- **On/Off Power Switch:** A dedicated slide switch to turn the main power to the unit on or off.
- **Dual Control Option:** Can be used independently or in conjunction with a handheld remote control (receiver not included).
- **Standard Junction Box Mount:** Designed for easy installation into a standard electrical junction box.

## COMPATIBILITY

The Nexete BY06 wall control is designed for broad compatibility with various ceiling fan systems. It is a replacement for many popular remote models and works with specific receiver types.



The diagram shows the internal wiring of the Nexete BY06 wall control. A green ground wire is connected to the top terminal. An AC Live In wire is connected to the bottom left terminal, and a Live Out wire is connected to the bottom right terminal. A Receiver is connected to the top right terminal. The diagram also shows the internal wiring of the Receiver, including connections for AC 120V SUPPLY, WHITE, BLACK, and GREEN wires.

# COMPATIBILITY

- Works with Fan28R, FAN18R, FAN30R and UC7067FMRX receiver.
- Replacement of these Remotes.  
FCC ID/ Model:

2AAZPFAN53T/FAN-53T/  
L3HFANIIT/FAN-11T/  
KUJCE9103/E08BT/  
CHQ7030T/UC7030T(53T)

2AAZPFAN35T1/L3HFAN35T/  
L3HFAN35T1/KUJCE9603/  
CHQ7202T(35T)

L3H2010FANHD/FAN-HD/  
L3H2014FANHD/FAN-HD/  
FAN-HD5(HD5)

• Compatibility with UC-9050T/CHQ9051T/  
UC-7067(9050T)/UC-9050H(4 DIP Switches)



The image shows five different remote control models, each with a green checkmark indicating compatibility. The models are: 1. A black remote with a red button. 2. A white remote with a green button. 3. A yellow remote with a green button. 4. A white remote with a green button. 5. A white remote with a green button and four DIP switches.

Image: A compatibility chart listing various remote control models and FCC IDs, such as UC9050T, UC9050U, CHQ9051T, 53T, 35T, and HD5, indicating the Nexete BY06's compatibility.



# Compatibility



Compatible with most downrod style fans



Halogen & Incandescent Lamps



Please don't use with wall mounted fans or exhaust-type fans



Dimmable LED Lamps



Dimmable CFL Lamps



Image: A chart illustrating compatibility with fan types (most downrod style fans) and lamp types (Halogen, Incandescent, Dimmable LED, Dimmable CFL). It explicitly states incompatibility with wall-mounted or exhaust-type fans.

Specifically, it is compatible with the UC9050T, UC9050U, CHQ9051T, 53T, 35T, and HD5 remote models. It works with Fan28R, FAN18R, FAN30R, and UC7067FMRX receivers. This wall control is suitable for most downrod style ceiling fans and supports Halogen, Incandescent, Dimmable LED, and Dimmable CFL lamps. It is **not compatible** with wall-mounted fans or exhaust-type fans.

## SETUP AND INSTALLATION

### 1. DIP Switch Configuration



## 4 DIP Switches Free Pair No Interference

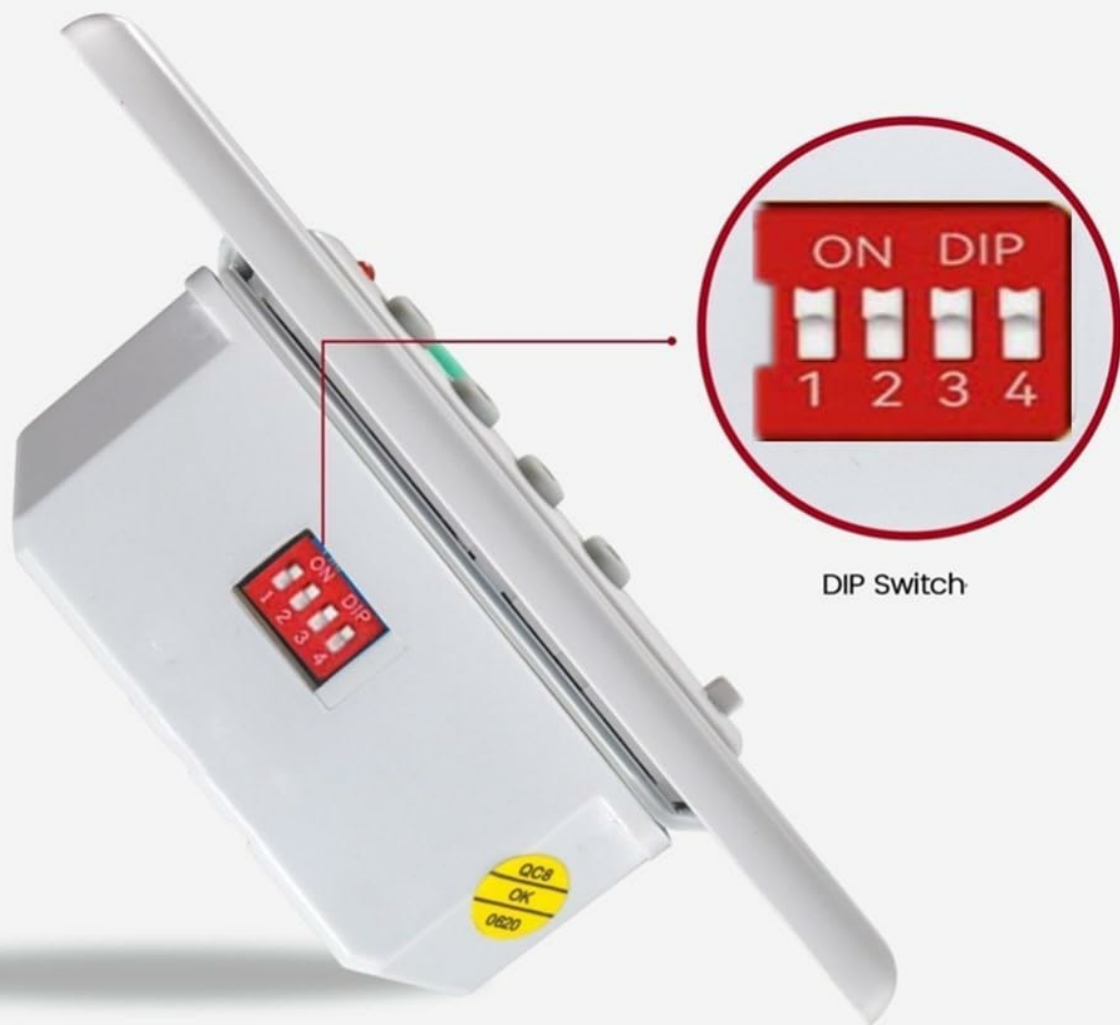

**Tips:**

1. It is easier to verify switch setting before installing.
2. Set the DIP switch to the same pattern as a regular remote/receiver.

Image: A detailed view of the 4 DIP switches located on the side of the wall control, showing their numbered positions and the 'ON' indicator. This image also includes tips for setting the switches.

1. Before installation, locate the DIP switches on your existing ceiling fan receiver (not included) and the Nexete BY06 wall control.
2. Set the 4 DIP switches on the Nexete BY06 wall control to the **exact same pattern** as the DIP switches on your ceiling fan receiver. This ensures proper communication.
3. It is easier to verify the switch settings before fully installing the unit into the wall.
4. If controlling multiple ceiling fans, set different DIP switch patterns for each fan and its corresponding wall control/remote to prevent interference.

## 2. Wiring Instructions

## Codes Chart

ON/1	0	0	4	8	12
0	1	5	9	13	
2	6	10	14		
3	7	11	15		

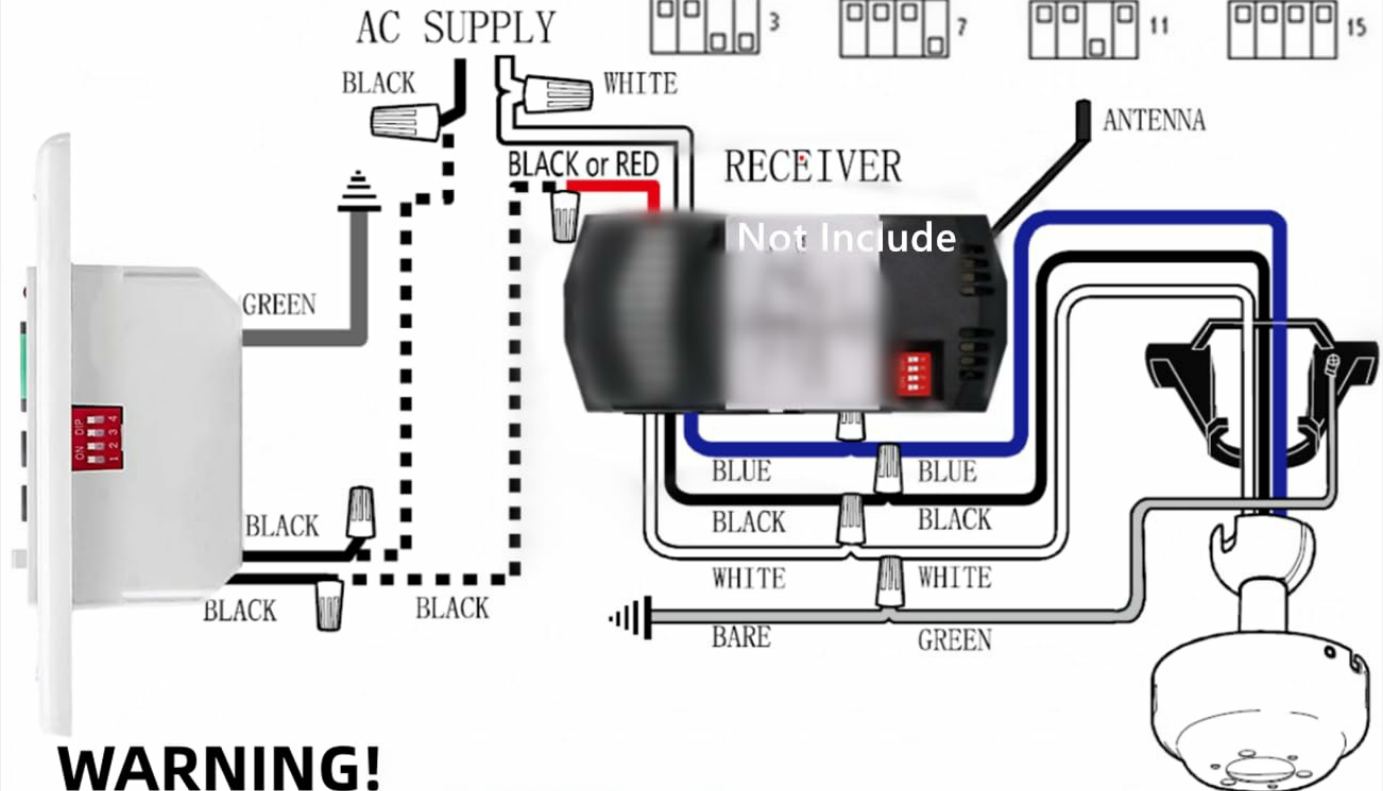

## WARNING!

Hook up "in series only"! Do not connect "Neutral" wire to transmitter wall switch, damage to the transmitter and possible fire could occur.

Image: A detailed wiring diagram illustrating how to connect the Nexete wall control to the AC supply, a ceiling fan receiver (not included), and the ceiling fan itself. A prominent warning advises against connecting a neutral wire to the wall switch.

1. **Turn off power:** Before beginning, ensure the power to the circuit is OFF at the main circuit breaker.
2. This wall control is designed to mount into a standard junction box.
3. Connect the wall control to the Live wire and Load wire only. This unit does **NOT** require a neutral wire connection.
4. Refer to the provided wiring diagram for specific connections. The receiver is not included with this product.
5. Secure all wire connections with wire nuts and ensure they are properly insulated.
6. Carefully push the wired switch into the junction box and secure it with screws. Attach the wall plate.
7. Once installation is complete, restore power at the circuit breaker.

## OPERATING INSTRUCTIONS



Image: The front panel of the Nexete wall control, displaying the fan speed buttons (HI, MED, LOW, FAN OFF), the LIGHT button, and the main OFF/ON slide switch.

## Fan Control

- **Power On/Off:** Use the slide switch at the bottom of the control to turn the main power to the fan and light on or off.
- **Fan Speed:** Press the **HI**, **MED**, or **LOW** buttons to select the desired fan speed.
- **Fan Off:** Press the **FAN OFF** button to turn the fan off.

## Light Control

- **Light On/Off:** Press the **LIGHT** button to turn the light on or off.
- **Dimming:** When the light is on, press and hold the **LIGHT** button to cycle through the dimming range. Release the button when the desired brightness is reached.

## Ceiling Fan Reverse Switch

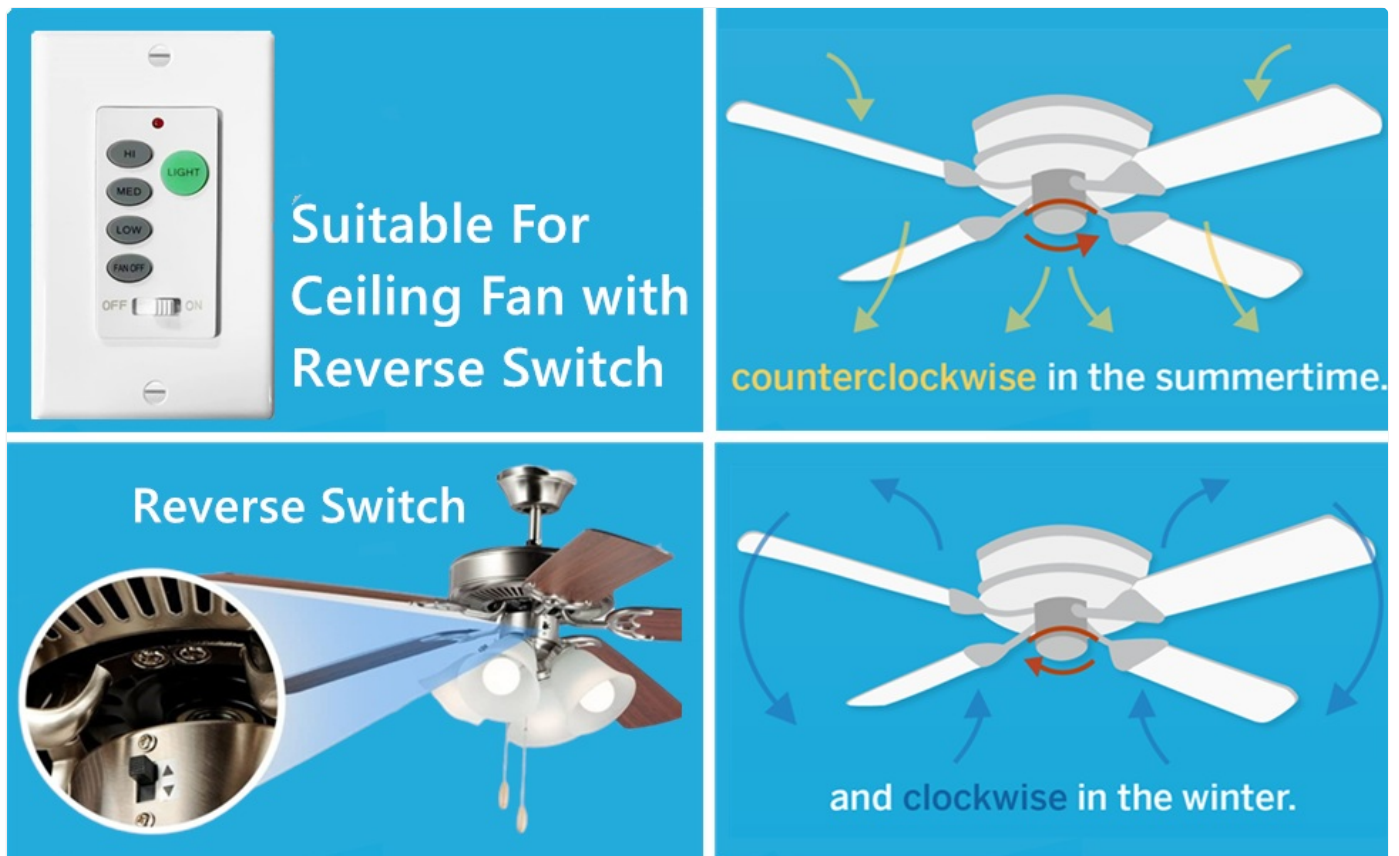

Image: A visual guide demonstrating the function of a ceiling fan's reverse switch, showing how counter-clockwise rotation is ideal for summer cooling and clockwise rotation for winter heat distribution.

Many ceiling fans include a reverse switch, typically located on the motor housing. This switch changes the direction of the fan blades. For optimal air circulation:

- **Summer Operation:** Set the switch for counter-clockwise rotation to create a downdraft, providing a cooling effect.
- **Winter Operation:** Set the switch for clockwise rotation to create an updraft, circulating warm air near the ceiling throughout the room.
- Always ensure the fan is completely off before changing the direction of the reverse switch.

## TROUBLESHOOTING

- **Fan or Light Not Responding:**
  - Ensure the main ON/OFF slide switch on the wall control is in the "ON" position.
  - Verify that the DIP switches on the wall control match the settings on your ceiling fan receiver.
  - Check the circuit breaker to ensure power is supplied to the fan.
  - Inspect wiring connections for any loose or incorrect connections, especially ensuring no neutral wire is connected to the wall switch.
- **Interference with Other Fans/Remotes:**
  - If another fan or remote is activating this ceiling fan, change the DIP switch settings on both the wall control and the receiver to a different, unique pattern.
- **Light Not Dimming:**
  - Ensure you are using dimmable light bulbs. Non-dimmable bulbs will not dim and may flicker or be damaged.
  - Press and hold the LIGHT button to activate the dimming function. A quick press will only turn the light on/off.



## SPECIFICATIONS

Attribute	Detail
Brand	Nexete
Model Number	BY06
Product Dimensions	5.3 x 4.8 x 2.8 inches
Item Weight	4.97 ounces
Power Source	120V AC (No Neutral wire Required)
Operation Mode	ON-OFF
Current Rating	1 Amps
Operating Voltage	120 Volts
Contact Type	Normally Closed
Connector Type	Clamp
Terminal	Screw
Circuit Type	1-way
Mounting Type	Wall Mount



Image: Physical dimensions of the Nexete wall control, indicating a height of 11.5 cm (4.52 inches) and a width of 7 cm (2.75 inches).





## WARRANTY AND SUPPORT

Specific warranty information for the Nexete Universal Ceiling Fan Wall Remote Control (Model BY06) is not provided in the product details. For warranty claims, technical support, or further assistance, please contact Nexete customer service directly through their official channels or the retailer where the product was purchased.

You can visit the Nexete Store for more information:[Nexete Store on Amazon](#)

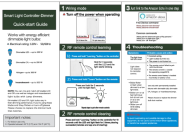

## Related Documents - BY06

	<p><a href="#">Nexete Smart Light Controller-Dimmer Quick-start Guide</a></p> <p>Quick-start guide for the Nexete Smart Light Controller-Dimmer, covering wiring, RF remote pairing, Amazon Alexa integration, and troubleshooting for various dimmable bulbs.</p>
<p>Wireless music headphones</p> <p>Model: LX-09, BY99, BY08, BY33, BY18, BY17, BY38, BY09, BY66, BY39, BY72, BY77, BY88, BY86, BY27, BY29, BY06, BY10, BY11, BY13.</p>  <p>Shenzhen Lanbiyi Technology Co., Ltd Instruction manual</p>	<p><a href="#">Wireless Music Headphones Instruction Manual - Shenzhen Lanbiyi Technology Co., Ltd</a></p> <p>Instruction manual for Shenzhen Lanbiyi Technology Co., Ltd wireless music headphones, covering product specifications, functions, key operations, packing list, and safety requirements. Includes model numbers LX-09, BY99, BY08, BY33, BY18, BY17, BY38, BY09, BY66, BY39, BY72, BY77, BY88, BY86, BY27, BY29, BY06, BY10, BY11, BY13.</p>
	<p><a href="#">Shenzhen Kuaiyou Network Services Co., Ltd. Declaration for Open Bluetooth Earphones - Model Differences</a></p> <p>Official declaration from Shenzhen Kuaiyou Network Services Co., Ltd. confirming that various models of Open Bluetooth Earphones share the same PCB board, circuit, and internal structure, with only the model numbers differing. Includes FCC ID 2BGQR-BY01 and a list of model numbers.</p>
	<p><a href="#">FCC Part 15.247 Test Report for Shenzhen Kuaiyou Network Services Co., Ltd. Open Bluetooth Earphones (Model BY01)</a></p> <p>This document details the FCC Part 15.247 compliance testing for the Shenzhen Kuaiyou Network Services Co., Ltd. Open Bluetooth Earphones, model BY01. It includes comprehensive test results for conducted emissions, radiated emissions, maximum peak output power, 20dB bandwidth, frequency separation, number of hopping channels, time of occupancy (dwell time), and out-of-band emissions, conducted by Shenzhen CTA Testing Technology Co., Ltd.</p>