

JOYBOS JOB184

JOYBOS Spin Mop & Bucket Set User Manual

Model: JOB184

[Introduction](#) [Safety](#) [Contents](#) [Setup](#) [Operation](#) [Maintenance](#) [Troubleshooting](#) [Specifications](#)

1. INTRODUCTION

Thank you for choosing the JOYBOS Spin Mop & Bucket Set. This manual provides essential information for the safe and effective use, assembly, and maintenance of your new cleaning system. This set features a hands-free self-cleaning mop with separate clean and dirty water compartments, microfiber mop pads, and an adjustable stainless steel handle for efficient cleaning.

2. IMPORTANT SAFETY INFORMATION

- Read all instructions before using the product.
- Keep out of reach of children and pets.
- Do not use with harsh chemicals that may damage the product or surfaces.
- Ensure the mop handle is securely assembled before use.
- Avoid excessive force when spinning the mop to prevent damage to the bucket mechanism.
- Always empty and clean the bucket after each use to prevent bacterial growth.

3. PACKAGE CONTENTS

Verify that all components are present in your package:

- Spin Mop Handle (telescopic, stainless steel)
- Mop Head (microfiber)
- Dual-Chamber Mop Bucket with Drainer





The complete JOYBOS Spin Mop and Bucket Set, including the mop handle, mop head, and the dual-chamber bucket.

4. SETUP AND ASSEMBLY

4.1. Assembling the Mop Handle

1. Unpack all components from the box.
2. Screw the handle sections together clockwise until secure.
3. Adjust the telescopic handle to your desired length by twisting the locking mechanism, extending the handle, and then twisting to lock it in place.

4.2. Attaching the Mop Head

1. Align the mop head with the base of the mop handle.
2. Press firmly until it clicks into place. Ensure it is securely attached before use.

4.3. Preparing the Bucket

The bucket is pre-assembled with its dual-chamber design. No additional assembly is required for the bucket itself.



Diagram showing the dimensions of the mop (50 inches / 127 cm height, 9.1 inches / 23 cm mop head diameter) and

the bucket (12.6 inches / 35 cm width, 7.1 inches / 18 cm height).

5. OPERATING INSTRUCTIONS

5.1. Filling the Bucket

1. Locate the water inlet on the bucket.
2. Fill the designated clean water compartment with water. You may add a small amount of floor cleaning solution if desired. Do not overfill.



Illustration of filling the mop bucket with water, highlighting its 11-liter capacity for cleaning an entire house.

5.2. Wetting the Mop Head

1. Place the mop head into the clean water compartment of the bucket.
2. Gently push the mop handle down to engage the spinning mechanism. This will wet and clean the mop head with fresh water.

5.3. Spinning and Wringing

1. After wetting, lift the mop head slightly to engage the wringing function.
2. Push the mop handle down repeatedly to spin and wring out excess water. The faster you push, the drier the mop head will become.
3. The bucket's design separates dirty water from clean water during this process.



Close-up of the mop bucket's spin mechanism, showing the dual-direction rotation for washing and wringing the mop head.

DISEÑO DE LIMPIEZA Y SEPARACIÓN



Diagram illustrating the innovative clean and dirty water separation design within the bucket, showing clear water for washing and residual water for disposal.

5.4. Mopping Technique

1. Once the mop head is at the desired dampness, begin mopping your floor.
2. The 360-degree swivel head allows for easy maneuverability around furniture and into corners.
3. The mop head can pivot 90 degrees to reach under low-clearance areas.



The mop head demonstrating its ability to pivot 90 degrees, allowing access to tight spaces and corners.



The mop head rotating 360 degrees to clean effectively under low furniture, indicating a clearance of 5cm.

6. CARE AND MAINTENANCE

6.1. Cleaning the Mop Head

- The microfiber mop pads are washable. Remove the mop head from the handle.
- Hand wash or machine wash the mop pad with mild detergent. Do not use bleach or fabric softener.
- Air dry the mop pad completely before reattaching or storing.

6.2. Cleaning the Bucket

- After each use, empty the dirty water from the bucket.
- Rinse the bucket thoroughly with clean water.
- Wipe down the interior and exterior of the bucket with a clean cloth.

6.3. Storage

- Store the mop and bucket in a dry, cool place away from direct sunlight.
- Ensure the mop head is dry before storing to prevent mildew.

7. TROUBLESHOOTING

Problem	Possible Cause	Solution
Mop head not spinning effectively.	Handle not fully engaged with spin mechanism; debris in mechanism.	Ensure handle is pushed down firmly and straight. Check for and remove any obstructions in the spin basket.
Mop head not wringing dry enough.	Insufficient spinning force or duration.	Push the handle down more rapidly and for a longer duration to increase spin speed and wringing effectiveness.
Water not separating properly.	Bucket overfilled; debris blocking separation channels.	Do not overfill the clean water compartment. Check and clear any blockages in the internal water channels.
Mop handle feels loose.	Handle sections not tightened; telescopic lock not secured.	Ensure all handle sections are screwed tightly. Twist the telescopic lock to secure the handle length.

8. PRODUCT SPECIFICATIONS





Feature	Detail
Brand	JOYBOS
Model Number	JOB184
Included Components	Mop Head, Bucket
Special Feature	Spin Mop, Clean/Dirty Water Separation
Item Weight	5.06 pounds (2.3 Kilograms)
Package Dimensions	13.19 x 12.91 x 10.28 inches
Color	White
Material	Microfiber (Head), Stainless Steel (Handle)
Handle Type	Telescopic
Batteries Required	No

9. WARRANTY AND SUPPORT

For warranty information or product support, please refer to the documentation included with your purchase or contact JOYBOS customer service through their official website or the retailer where the product was purchased. Please have your model number (JOB184) and purchase date available when contacting support.

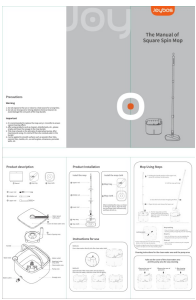
© 2025 JOYBOS. All rights reserved.

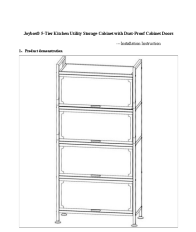
Related Documents - JOB184

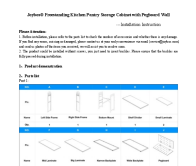
	<p>Joybos Square Spin Mop User Manual and Instructions</p> <p>A comprehensive guide for the Joybos Square Spin Mop, detailing product features, installation, usage steps, and maintenance for optimal cleaning performance. Learn how to assemble, use, and clean your spin mop system effectively.</p>
	<p>Joybos Metal Storage Cabinet Assembly Instructions</p> <p>Comprehensive guide for assembling the Joybos Metal Storage Cabinet, including step-by-step instructions and important cautions for a stable installation.</p>
	<p>Joybos 5-Tier Kitchen Utility Storage Cabinet Installation Guide</p> <p>Step-by-step installation instructions and parts list for the Joybos 5-Tier Kitchen Utility Storage Cabinet with Dust-Proof Cabinet Doors.</p>
	<p>JOYBOS Stackable Storage Bins: Assembly Guide</p> <p>A step-by-step guide detailing the assembly process for JOYBOS stackable storage bins, including unfolding side panels, securing the rear, and installing the top panel.</p>
	<p>Joybos Freestanding Kitchen Pantry Storage Cabinet with Pegboard Wall Installation Guide</p> <p>Comprehensive installation instructions for the Joybos Freestanding Kitchen Pantry Storage Cabinet with Pegboard Wall. Includes a detailed parts list and step-by-step assembly guide.</p>

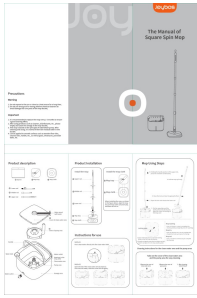

[Joybos Square Spin Mop User Manual and Instructions](#)

A comprehensive guide for the Joybos Square Spin Mop, detailing product features, installation, usage steps, and maintenance for optimal cleaning performance. Learn how to assemble, use, and clean your spin mop system effectively.