

[Manuals.plus](#) /

> [AIMIBO](#) /

> AIMIBO Wireless HDMI Transmitter and Receiver User Manual (Model HD Kit)

## AIMIBO HD Kit

# AIMIBO Wireless HDMI Transmitter and Receiver User Manual

Model: HD Kit

## 1. INTRODUCTION

---

Thank you for choosing the AIMIBO Wireless HDMI Transmitter and Receiver. This device allows for stable, high-definition video and audio transmission over a wireless 5.8G frequency band, supporting up to 1080P@60Hz resolution. This manual provides detailed instructions for proper setup, operation, and maintenance to ensure optimal performance and longevity of your device.

## 2. WHAT'S IN THE BOX

---

Please verify that all items are present in your package:

- 1 x Transmitter (TX)
- 1 x Receiver (RX)
- 2 x HDMI Cables
- 2 x USB Power Cables
- 1 x Micro-HDMI Adapter
- 1 x Mini-HDMI Adapter
- 1 x User Manual

# Packing List:

- |                   |                  |
|-------------------|------------------|
| 1 Transmitter *1  | 2 Receiver *1    |
| 3 USB C Cables *2 | 4 HDMI Cables *2 |
| 5 Mini HDMI *1    | 6 Micro HDMI *1  |



Figure 1: Package Contents. The image displays the transmitter, receiver, two USB-C cables, two HDMI cables, a Mini HDMI adapter, and a Micro HDMI adapter, along with the user manual.

## 3. PRODUCT OVERVIEW

The AIMIBO Wireless HDMI system consists of a Transmitter (TX) and a Receiver (RX), designed for seamless wireless video and audio transmission. Both units are compact and feature external antennas for enhanced signal stability.

# 1 X 4 RÉCEPTEURS - ÉCRANS MULTIPLES

1 émetteur peut être couplé à jusqu'à 4 récepteurs ou 4 téléphones portables/tablettes simultanément, branchez-le et reflétez instantanément votre vidéo, votre audio et vos images sur plusieurs écrans



## Prise en Charge du Mode Miroir et étendu

Figure 2: Transmitter (TX) and Receiver (RX) Units. The image shows the two main components of the wireless HDMI system, each with an adjustable antenna and connection ports.

### 3.1. Key Features

- **1080P@60Hz Resolution:** Supports full HD video output for clear visuals.
- **165ft/50m Transmission Range:** Stable signal transmission over long distances (Note: Range is reduced to 32ft/10m when passing through walls).
- **Low Latency:** Ultra-low latency of 0.1ms for real-time streaming.
- **Multi-Receiver Support:** One transmitter can connect to up to 4 receivers simultaneously.
- **Tablet as Mobile Screen:** Use your tablet as a wireless monitor via a dedicated app.
- **Adjustable Wireless Channels:** Select the most stable channel to minimize interference.
- **Plug-and-Play:** Factory pre-paired for immediate use without complex setup.
- **Wide Compatibility:** Compatible with various HDMI-enabled devices.

## 4. SETUP INSTRUCTIONS

The AIMIBO Wireless HDMI system is designed for easy plug-and-play setup. Follow these steps to get started:

#### 4.1. Basic Connection (Transmitter to Receiver)

1. Connect the HDMI cable and the USB-C power cable to the Transmitter (TX). Plug the TX into the HDMI output device (e.g., laptop, PC, camera).
2. Connect the HDMI cable and the USB-C power cable to the Receiver (RX). Plug the RX into the HDMI input device (e.g., TV, projector, monitor).
3. Wait approximately 5 seconds for the devices to establish a connection and begin streaming.



Figure 3: Basic Connection Method. This diagram illustrates connecting the transmitter to a laptop and the receiver to a TV, showing the wireless signal transmission.

#### 4.2. Connecting to a Mobile Device (Tablet/Phone as Monitor)

To use your iOS/Android phone or tablet as a second screen:

1. Connect the TX to your HDMI output device and power it on.
2. Install the "RScreen" application on your mobile device (available on app stores).
3. Connect your mobile device to the Wi-Fi network named "RScreen-xxx".
4. Open the RScreen app on your phone/tablet for synchronization.

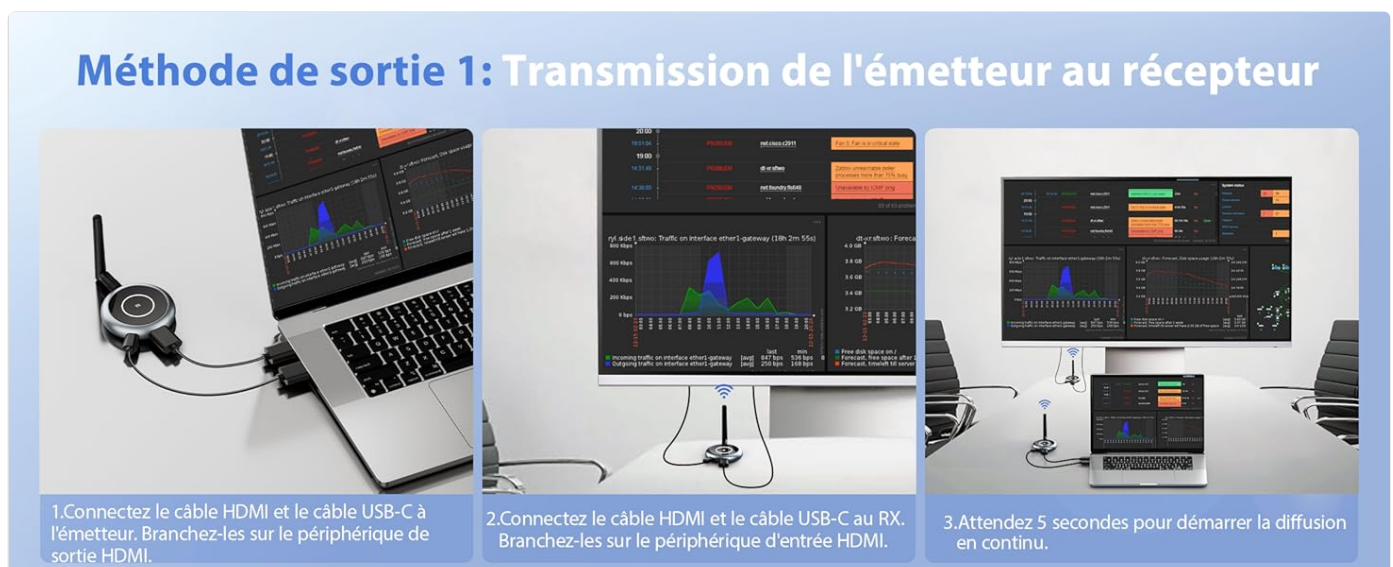

Figure 4: Mobile Device Connection. This image shows the steps to connect the transmitter to a mobile device using the RScreen app and Wi-Fi.

### 4.3. Connecting to Multiple Receivers (Up to 4 RXs)

The system supports connecting one transmitter to up to four receivers for multi-screen display:

1. Prepare multiple receivers and pair each individually to the transmitter (only necessary for initial setup).
2. Connect the receivers to their respective display screens and establish the connection by plugging the transmitter into an HDMI output device.
3. Wait a few seconds, and the screen will synchronize across all displays simultaneously.



Figure 5: Multi-Receiver Setup. This image demonstrates how one transmitter can broadcast to multiple receivers connected to different screens, ideal for conference rooms or large venues.

## 5. OPERATING INSTRUCTIONS

### 5.1. Multi-Screen Display Modes

The AIMIBO system supports both mirror and extended display modes, allowing flexible screen sharing across multiple displays or mobile devices.



Figure 6: 1x4 Receiver Multi-Screen Display. This image illustrates a setup where one transmitter broadcasts to four receivers, enabling

simultaneous display on multiple screens, supporting both mirror and extended modes.

## 5.2. Optimizing Wireless Performance

To ensure the best streaming experience, especially in environments with many Wi-Fi devices, you can adjust the wireless channels:

- Access the channel selection feature (usually through the RScreen app or a dedicated button on the device, refer to the app for specific instructions).
- Select the channel with the strongest signal or least interference to improve video fluidity.

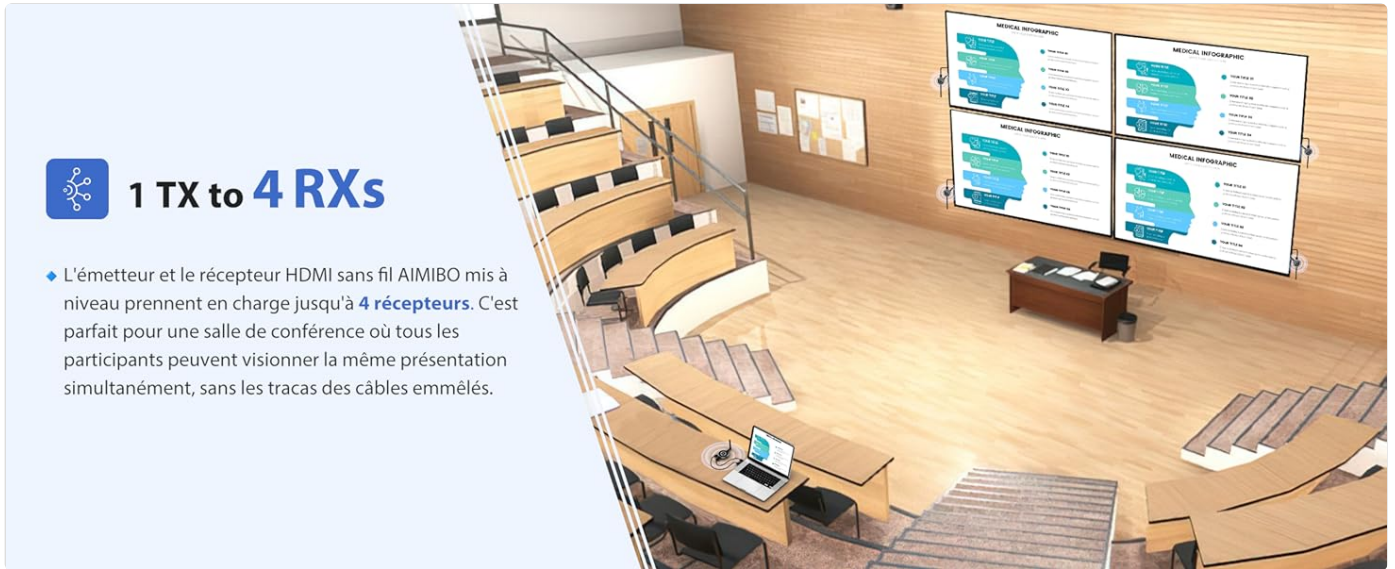

Figure 7: Adjustable Wireless Channels. This image shows a user selecting a wireless channel on a mobile device interface, indicating the ability to optimize signal quality.

## 5.3. Device Compatibility

The AIMIBO Wireless HDMI system is broadly compatible with a variety of devices:

Transmitter (TX) Compatible Devices	Receiver (RX) Compatible Devices
Laptop, PC, F-Fire TV, DVD/Blu-ray Player, Cable Box, Phone/Tablet, PS5/Xbox, DSLR/Camera, Surveillance Cameras, etc.	TV, Monitor, HDMI Splitter, Projector

# PLUG & PLAY



1080P 60Hz



165 Pieds  
50 Mètres



Transformez  
votre Tablette  
en Moniteur



Plusieurs écrans



Mode étendu



Figure 8: Wide Device Compatibility. This image displays various devices compatible with the transmitter (e.g., laptops, cameras, gaming consoles) and receiver (e.g., TVs, projectors), highlighting the system's versatility.

## 6. MAINTENANCE

- Keep the devices in a dry, cool environment, away from direct sunlight and extreme temperatures.
- Clean the devices with a soft, dry cloth. Do not use liquid cleaners or aerosols.
- Avoid dropping or subjecting the devices to strong impacts.
- Ensure proper ventilation around the units during operation to prevent overheating.

## 7. TROUBLESHOOTING (Q&A)

### Q: How to make video playback smoother?

A: Open the "RScreen" application and click on "Channel Selection". Then, select the channel with the longest green bar to reduce interference from nearby wireless connections.



Figure 9: Q&A - Smoother Video Playback. This image shows a group of people watching a projected video outdoors, with a text overlay explaining how to improve video fluidity by selecting a better wireless channel.

**Q: Even if the image is transmitted, there is no sound.**

A: Please check the audio settings of the output device and ensure it is set to stereo 2.0. It does not support Dolby, stereo 2.1, stereo 5.1, or stereo 7.1 output.

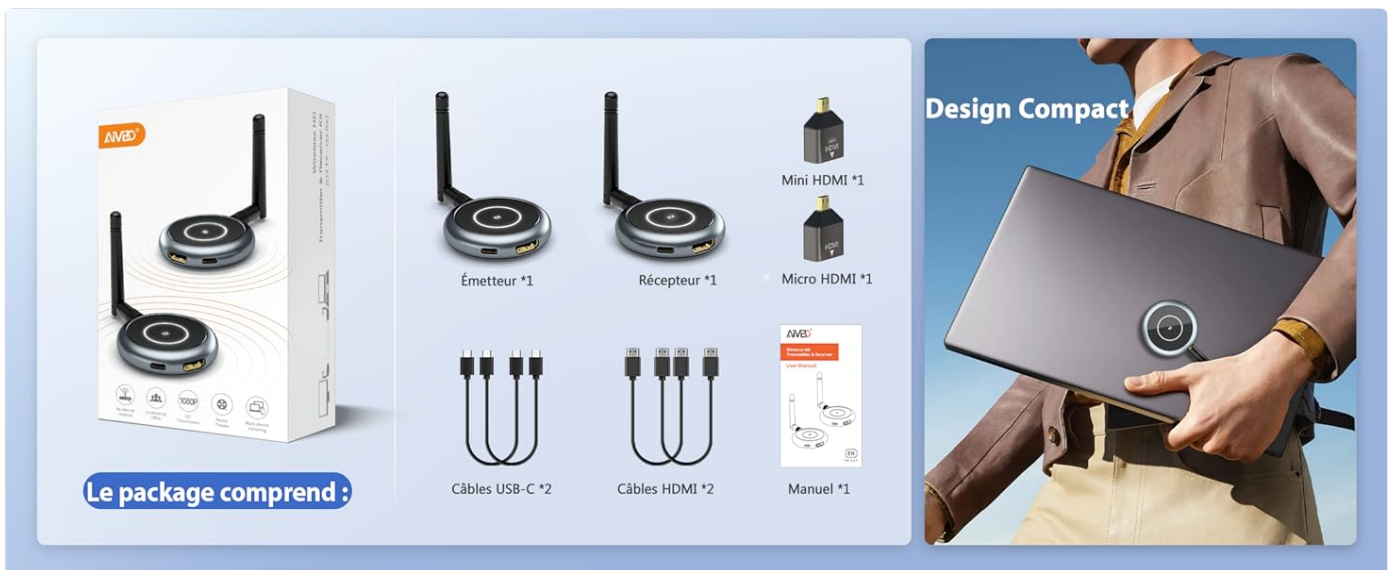

Figure 10: Q&A - No Sound Issue. This image depicts a business meeting with a large screen displaying data, and a text overlay addressing the common issue of no sound during transmission, advising to check audio settings.

**Q: How many HDMI devices can be streamed simultaneously by a single transmitter?**

A: The transmitter can be paired with multiple devices for simultaneous output. The maximum recommended number is 4 devices. You can choose to connect 4 receivers, 4 mobile devices, or a combination of both.



	 AIMIBO HDMI-Kit	 Type de forme en U-dish	 Type de forme de câble
Transparence confirmant l'authenticité	Oui	NON	NON
Plusieurs récepteurs	Prend en charge jusqu'à 4 récepteurs	NON	NON
Fonction d'émission	Peut refléter la sortie HDMI de l'appareil sur un appareil mobile	NON	NON
Changement de canal WLAN	Peut améliorer la fluidité vidéo et réduire les interférences lors des changements de canal	NON	NON
Antennes Puissantes	Les antennes externes sont plus stables que les antennes intégrées	Antenne Intégrée	Antenne Intégrée
Interface	HDMI / Mini-HDMI / Micro-HDMI	Seulement HDMI	Seulement HDMI
Résolution	1080P à 60 Hz HD	Seulement 1080P	Seulement 1080P
Latence	0,1 s	0,3 s (Dans les zones à forte utilisation du Wi-Fi, des retards peuvent survenir)	0,3 s (Dans les zones à forte utilisation du Wi-Fi, des retards peuvent survenir)
Distance de transmission	165 PI / 50 M	98 PI / 30 M	98 PI / 30 M

Figure 11: Q&A - Multiple Device Streaming. This image shows a large conference room with multiple screens displaying data, and a text overlay explaining the system's capability to stream to up to four devices simultaneously.

**Q: Why can't I continue playing videos when I leave the app to perform other tasks on my phone?**

A: This is because your phone disconnects from the TX device. To resume video playback, you must return to the Wi-Fi settings screen, reconnect to the "RScreen-xxx" network, and then you can continue watching videos.

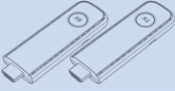
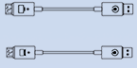
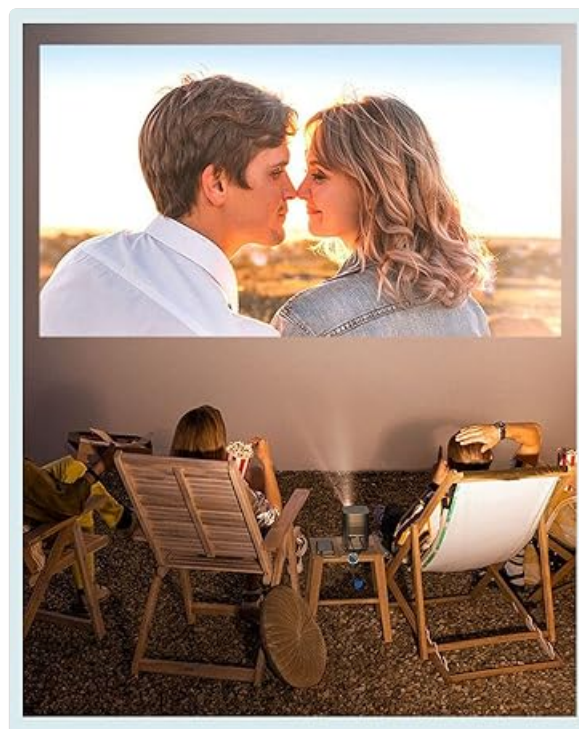

Figure 12: Q&A - App Interruption. This image shows a person working on an iPad connected to a Mac Mini, with a text overlay explaining why video playback might stop when switching apps on a mobile device and how to resume it.

## 8. SPECIFICATIONS

Feature	Detail
Brand	AIMIBO
Model Number	HD Kit (G70EU)

Feature	Detail
Connectivity Technology	HDMI, Wi-Fi, Wireless
Special Feature	Wireless HDMI Transmission, Up to 4 Receivers, Extended Range, Low Latency
Compatible Devices	Blu-ray, Camera, Personal Computer, Projector, Televisions
Total HDMI Ports	2
Connector Type	HDMI
Audio Output Mode	Stereo
Surround Sound Channel Configuration	5.1 (Note: Stereo 2.0 recommended for optimal performance)
Video Encoding	1080P
Output Power	2 Watts
Wattage	5 Watts
Number of Channels	2
Internet Applications Supported	Canal+, Cinemanow, Freesat/Freeview, Google TV, Hulu, Hulu Plus, Netflix, Pandora, Prime Video, Salto, Skype, Vudu, HBO, YouTube, iTunes
Control Method	Button Control, Application
Digital Media Format	Dolby
Item Dimensions (L x W x H)	7.5 x 7.5 x 0.8 centimeters
Item Weight	200 Grams
Color	Black
Country of Origin	China

## 9. WARRANTY AND SUPPORT

**Warranty:** The product comes with a 2-year warranty from the date of purchase. Please retain your proof of purchase for warranty claims.

**Technical Support:** For any technical assistance, troubleshooting, or inquiries regarding your AIMIBO Wireless HDMI system, please contact AIMIBO customer support. Professional technical support is available for the lifetime of the product.

You can often find contact information on the official AIMIBO website or through the retailer where you purchased the product.