

Mangoal Model A

Mangoal 4K Dash Cam Instruction Manual

Model A: Ford 1st Gen Maverick 2022-2024 (XL, XLT, Lariat)

Brand: Mangoal

1. SETUP

1.1 What's in the Box

Your Mangoal 4K Dash Cam package includes the following items:

- Mangoal OEM Look 4K Dashcam x1
- 64G MircoSD Card x1
- User Manual x1
- Lane Assist Plug Power Adapter x1
- Crowbar x1
- Strap x2
- T20 Star Screwdriver x1
- T25 Star Screwdriver x1

1.2 Installation

The Mangoal 4K Dash Cam is custom-fit for Ford 1st Gen Maverick 2022-2024 (Model A, XL, XLT, Lariat) to integrate seamlessly behind the rearview mirror, providing an OEM look without messy wiring.

Follow these steps for installation:

1. Carefully remove the plastic cover behind the rearview mirror using the provided crowbar.
2. Disconnect the rain sensor connector.
3. Connect the Y-cable from the dash cam to the rain sensor connector.
4. Remove the original screw holding the mirror base.
5. Mount the camera's base bracket using the provided T20 or T25 Star Screwdriver.

6. Install the dash cam onto the mounted bracket.
7. Connect the Y-cable to the dash cam.
8. Tuck any excess wiring neatly into the headliner using the crowbar.
9. Reinstall the plastic cover behind the rearview mirror.

For a visual guide, please refer to the installation videos below:

Your browser does not support the video tag.

Text Description: This video demonstrates the step-by-step installation process of the Mangoal Ford Maverick Dash Cam for 2022-2024 models. It shows how to remove trim, connect wiring, and secure the dash cam for a factory-integrated look.

Your browser does not support the video tag.

Text Description: This video provides an installation guide for the 2025 Ford Maverick Dash Cam, which shares a similar installation process with the 2022-2024 Model A. It covers wiring and mounting procedures.

Your browser does not support the video tag.

Text Description: This tutorial video from FiTCAMX Brand Store demonstrates the installation process for a dash cam compatible with Ford Maverick, Escape, Explorer, and Lincoln models, offering a general overview of the steps involved.

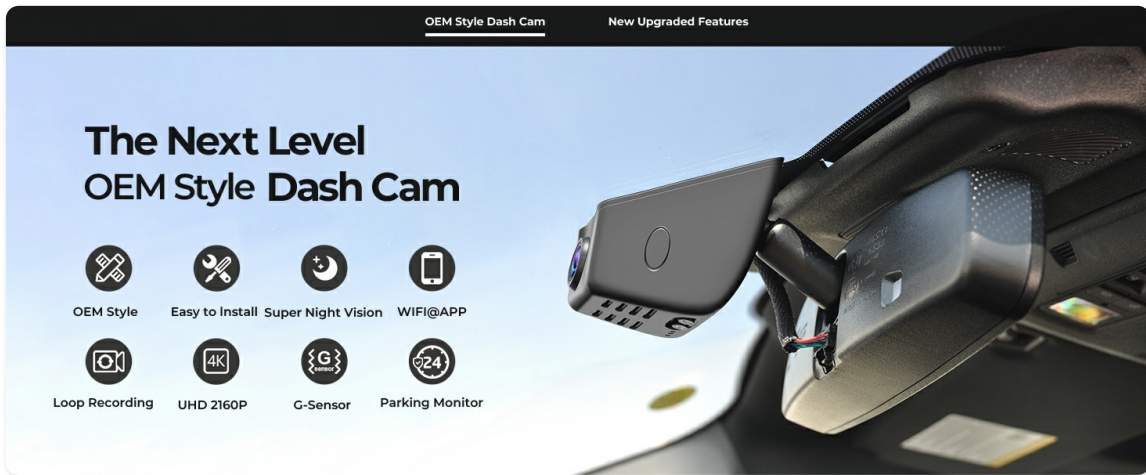

Text Description: Image showing the connection of the Lane Assist Plug Power Adapter to the vehicle's existing wiring for dash cam power. This method provides power to the dash cam.

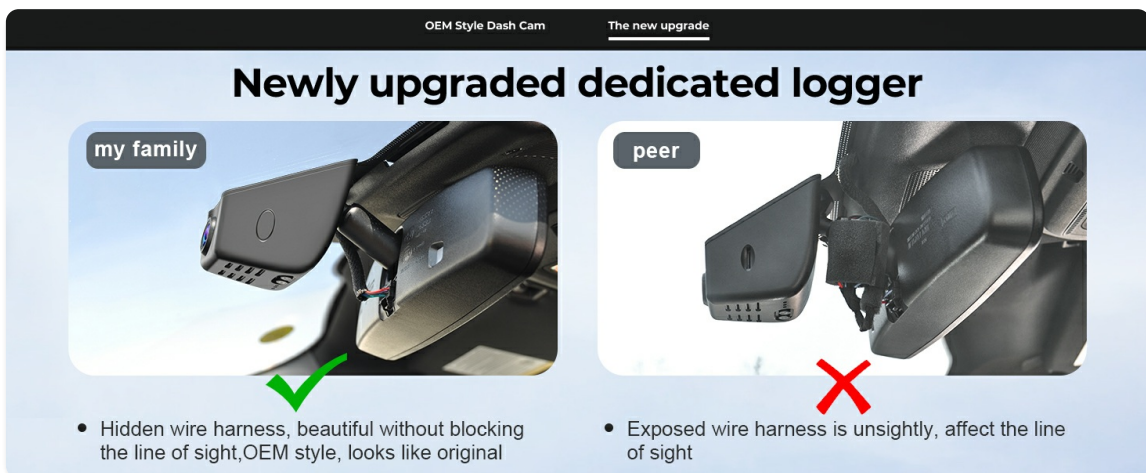

Text Description: A side-by-side comparison image showing the vehicle's rearview mirror area before and after the installation of the Mangoal OEM style dash cam, highlighting the integrated and clean appearance.

Endless Loop Recording

Every 1/3/5 min loop recording, the oldest videos will be overwritten when the SD card is full.

Recording time for different SD cards.

32G	64G	128G
2H	4H	8H



Text Description: Image illustrating the optimal placement of the dash cam to ensure it does not obstruct the driver's line of sight, emphasizing the OEM-like integration.

2. OPERATING INSTRUCTIONS

2.1 Powering On/Off

The dash cam powers on and off automatically with the vehicle's ignition when connected via the Lane Assist Plug Power Adapter. If using an OBD2 port power adapter, the dash cam will power on/off with the vehicle, but for parking monitoring, a Fuse Box Power Adapter (B0CXXXV4YG) is recommended to avoid potential vehicle battery issues.

2.2 Video Recording

The dash cam records in Ultra HD 2160P (4K) at 30 frames per second, utilizing an f/1.8 big aperture lens and CMOS IMX335 chip for high-definition video quality in various lighting conditions. It features:

- **Loop Recording:** Seamlessly records over the oldest footage when the 64GB MicroSD card is full, ensuring continuous recording.
- **G-Sensor:** Automatically detects sudden collisions or impacts and saves/locks the current video footage to a specified folder, preventing it from being overwritten.
- **Night Vision:** Enhanced low-light performance for clear video recording during nighttime driving.

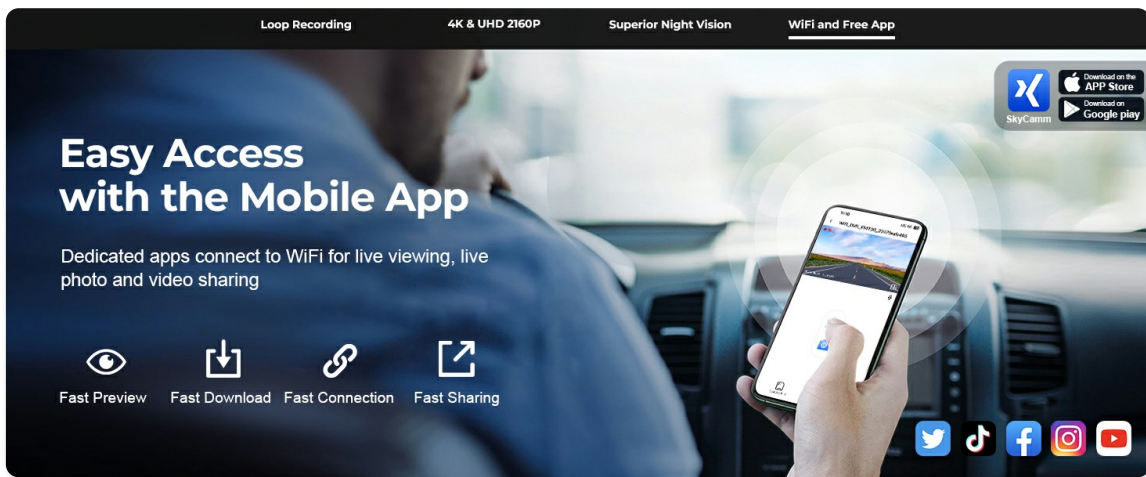

Text Description: An image illustrating the concept of loop recording, showing how older videos are overwritten when the SD card is full. It also provides a table of recording times for different SD card capacities (32GB, 64GB, 128GB).

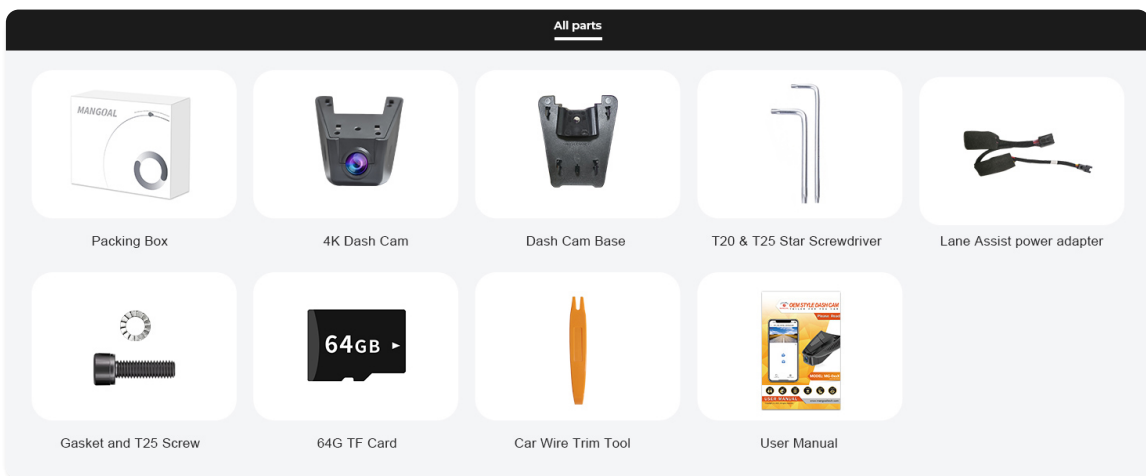

Text Description: This image highlights the superior night vision capabilities of the dash cam, featuring a Sony Sensor, f/1.8 aperture, WDR (Wide Dynamic Range), and a 6-layer lens for clear night recordings.

2.3 Parking Monitoring

The dash cam supports parking monitoring functionality. If this feature is desired, it is recommended to use a dedicated Fuse Box Power Adapter (B0CXXXV4YG) instead of the standard OBD2 power adapter to prevent potential vehicle battery drain due to irregular vehicle system updates.

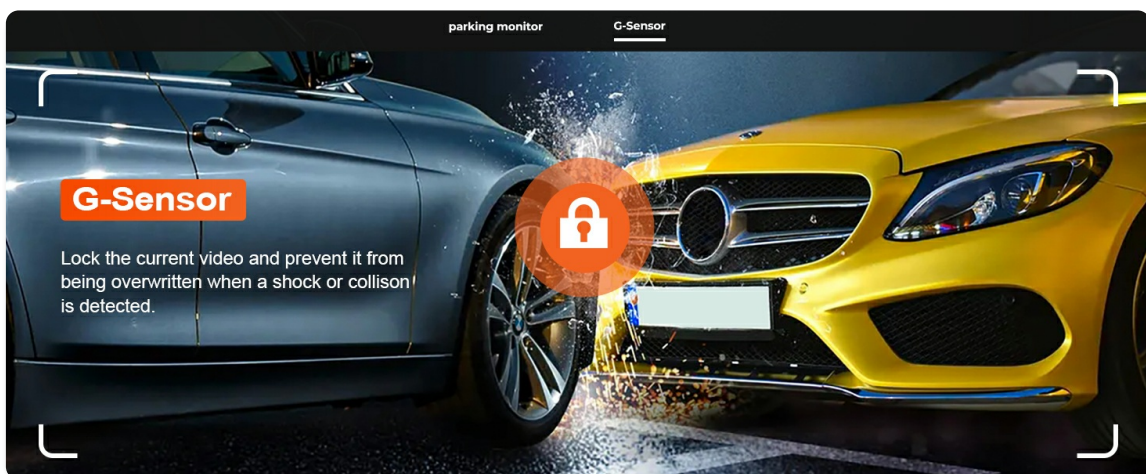

Text Description: An image depicting the Parking Monitor feature, which automatically switches to parking mode to provide 24-hour protection for your vehicle. It reiterates the recommendation for a Fuse Box Power Adapter for this function.



Text Description: Close-up image of the G-Sensor feature, indicating its ability to lock and protect current video footage from being overwritten when a shock or collision is detected.

2.4 Built-in WiFi and App Control

The dash cam features built-in WiFi for higher-definition and faster download speeds. Use the free user-friendly 'SkyCamm' app to:

- View real-time videos on your smartphone.
- Download or transfer important footage to your PC.
- Share videos on social media.

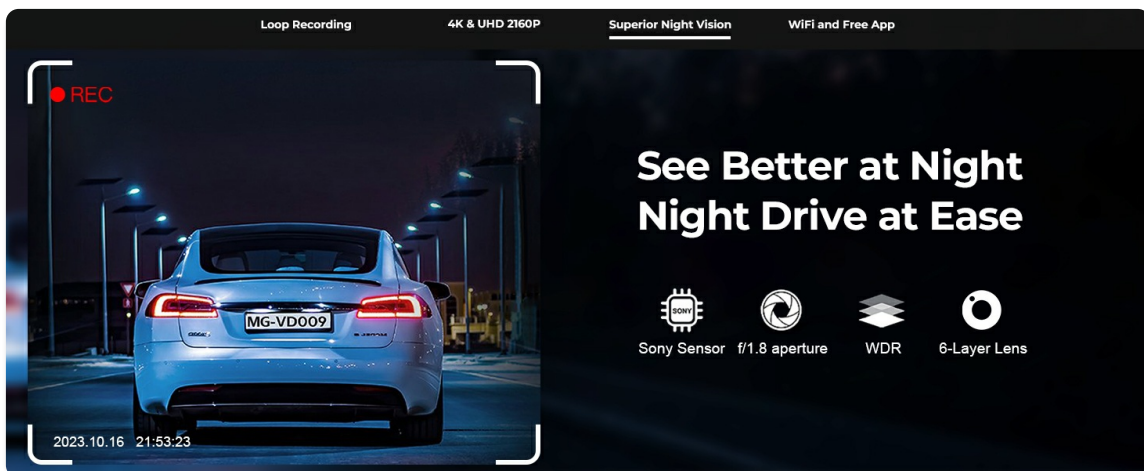

Text Description: An image showing a smartphone screen displaying the 'SkyCamm' app interface, demonstrating easy access to live viewing, photo, and video sharing features of the dash cam.

3. MAINTENANCE

3.1 Memory Card Management

The dash cam uses seamless loop recording, which means the oldest footage will be overwritten with new content when the 64GB MicroSD card is full. Regularly back up important videos to prevent loss. Periodically format the MicroSD card (e.g., once a month) to maintain optimal performance and prevent data corruption.

3.2 Cleaning

To ensure clear video quality, regularly clean the dash cam lens with a soft, lint-free cloth. Avoid

using harsh chemicals that could damage the lens or camera body.

4. TROUBLESHOOTING

If you encounter issues with your Mangoal 4K Dash Cam, please refer to the following common problems and solutions:

- **Dash Cam Not Powering On:** Ensure all cable connections are secure. If using an OBD2 adapter, verify it's correctly plugged in. If the issue persists, the OBD2 adapter might be faulty; consider trying the Lane Assist Plug Power Adapter or a Fuse Box Power Adapter.
- **WiFi Connection Issues:** Ensure the dash cam's WiFi is enabled. Try restarting both your smartphone's WiFi and the dash cam. Some users report conflicts with Apple CarPlay or Android Auto; temporarily disconnect these services when accessing the dash cam app.
- **App Functionality Problems:** Ensure you have the latest version of the 'SkyCamm' app installed. Clear the app's cache or reinstall it if necessary. Verify your smartphone's operating system is up to date.
- **Recording Errors or Footage Loss:** Check if the MicroSD card is properly inserted and not full. Format the MicroSD card (backing up important data first). Ensure the G-Sensor sensitivity is set appropriately to avoid unnecessary locking of footage or missed events.
- **Poor Video Quality:** Clean the dash cam lens. Ensure the camera is securely mounted and not vibrating. Check the video resolution settings in the app.

5. SPECIFICATIONS

Feature	Description
Video Capture Resolution	Front 4K 2160P
Field Of View	150 Degrees
Connectivity Technology	Wi-Fi
Special Features	Built-In Microphone, Built-In Speaker, Built-In Supercapacitor, OEM Style, Motion Sensing, Mute Function, Night Vision, Loop Recording, G-Sensor, Automatic Incident Detection, Parking Monitor, App Control
Batteries	1 Lithium Metal battery required (included)
Included Components	Mangoal OEM Look 4K Dashcam x1, 64G MircoSD Card x1, User Manual x1, Lane Assist Plug Power Adapter x1, Crowbar x1, Strap x2, T20 Star Screwdriver x1, T25 Star Screwdriver x1

6. WARRANTY AND SUPPORT

Your Mangoal 4K Dash Cam comes with a worry-free 12-month warranty. For any questions, technical assistance, or warranty claims, please contact our friendly customer service team.