

## Kasa Smart KS225

# Kasa Smart Dimmer Switch KS225: Matter Compatible, Single Pole

Model: KS225 | Brand: Kasa Smart

### 1. PRODUCT OVERVIEW

The Kasa Smart Dimmer Switch KS225 offers advanced lighting control for your home. It is Matter certified, ensuring broad compatibility with major smart home platforms. Key features include smart dimming, voice control, remote access, and scheduling capabilities.



Figure 1: Kasa Smart Dimmer Switch KS225 packaging and components.

### What's in the Box

- Kasa Smart Dimmer Switch (KS225) x1
- Wall Plate x1
- Wire Nuts x2
- Screws x2
- Quick Start Guide x1

## 2. SETUP AND INSTALLATION

The Kasa Smart Dimmer Switch KS225 requires a neutral wire for installation and operates on a 2.4GHz Wi-Fi connection. The Kasa app provides a guided, step-by-step installation process.

### Compatibility

This device is Matter certified, offering cross-platform compatibility with Apple Home, Amazon Alexa, Google Home, and Samsung SmartThings. Some platforms may require a Matter-compatible hub.



Figure 2: Matter compatibility across various smart home platforms.

## Brightness Control

Control the brightness of your lights in any room from the wall switch, apps, or voice assistants.  
Set the optimal dimming range for the perfect ambience.

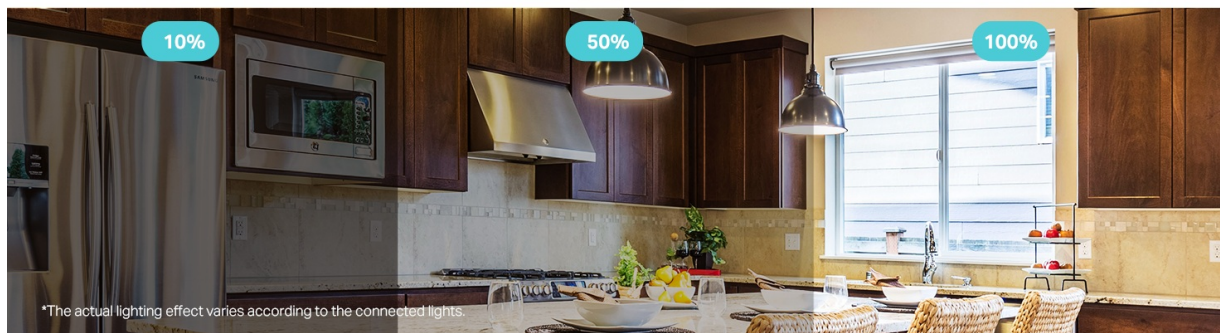

Figure 3: Examples of Matter-compatible hubs for different platforms.

## Wiring Guide

The Kasa Smart Dimmer Switch is designed to replace traditional single-pole switches. It supports max 600W Incandescent/LED/CFL bulbs. A neutral wire is required. Consult a qualified electrician if you are unsure about wiring.

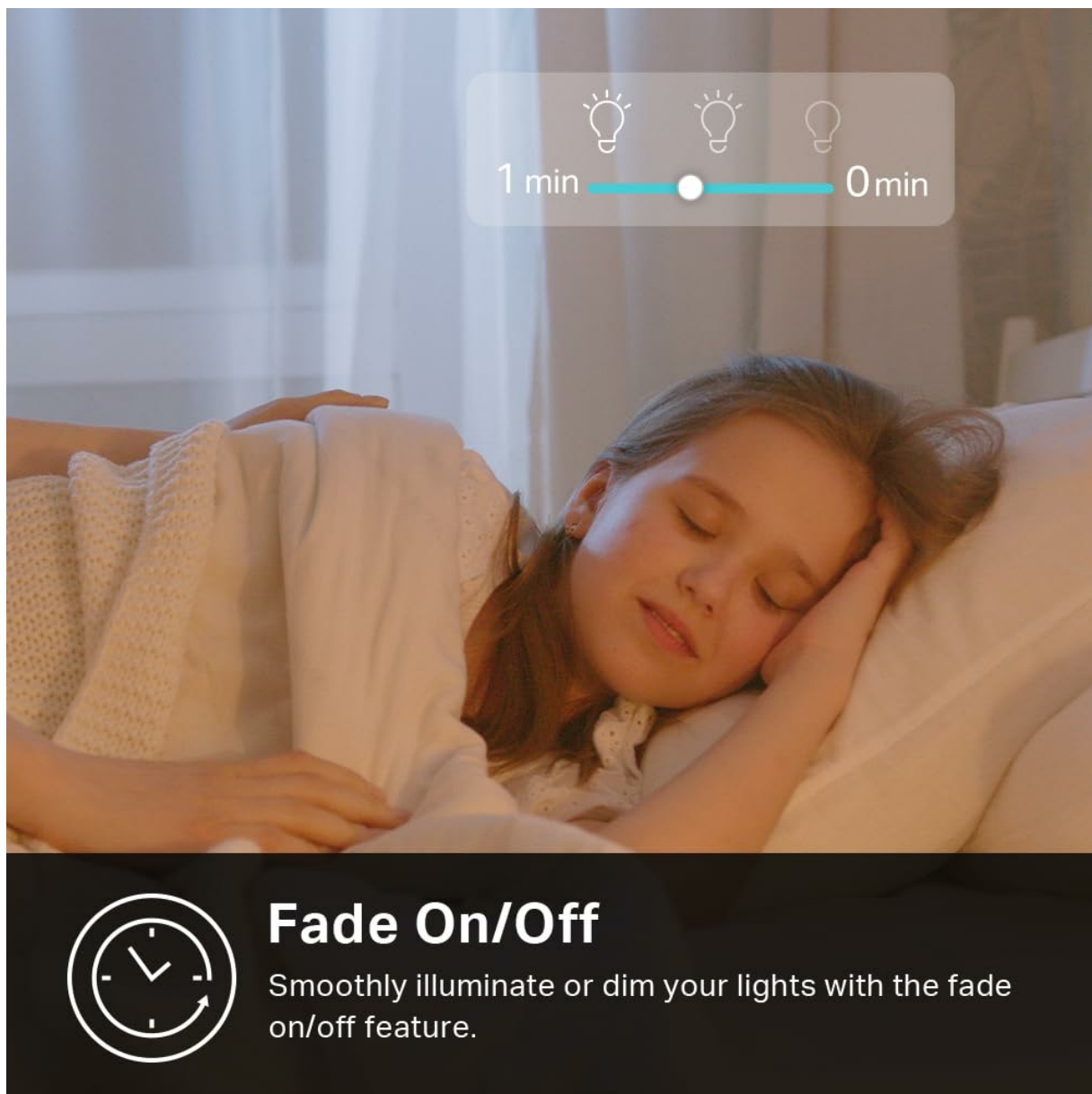



Figure 4: Basic wiring diagram for the KS225.

### Easy Installation Following the In-App Guide



**Guided Install**

The Kasa app includes detailed, easy-to-follow, step-by-step instructions for installation. It takes less than 30 minutes and uses common household tools.

- 1

Turn off the circuit breaker. Then remove your old wall switch. Label the Ground and Neutral wires.

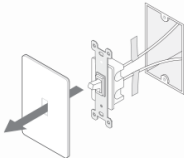

- 2

Turn on the circuit breaker. Use a voltage detector to identify the energized wire (Line wire). Then turn off the circuit breaker. Label the Line and Load wires.

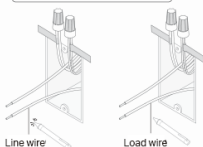
⚠ Take care to avoid electric shocks.

- 3

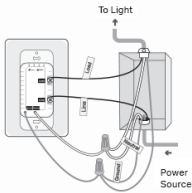
Connect the wires to the smart dimmer switch as



Ground: Usually green or copper.  
 Neutral: Usually white and not connected to the dumb switch.  
 Line: Usually black and coming from the circuit breaker.  
 Load: Usually black. One end is connected to the light.  
 Note: If you are unsure, consult a qualified electrician.

Figure 5: Easy installation steps as guided by the Kasa app.

## App Setup

Use the Kasa Smart app for Bluetooth onboarding or scan the Matter code with any Matter-compatible app (Alexa, Google Home, Apple Home) for setup.

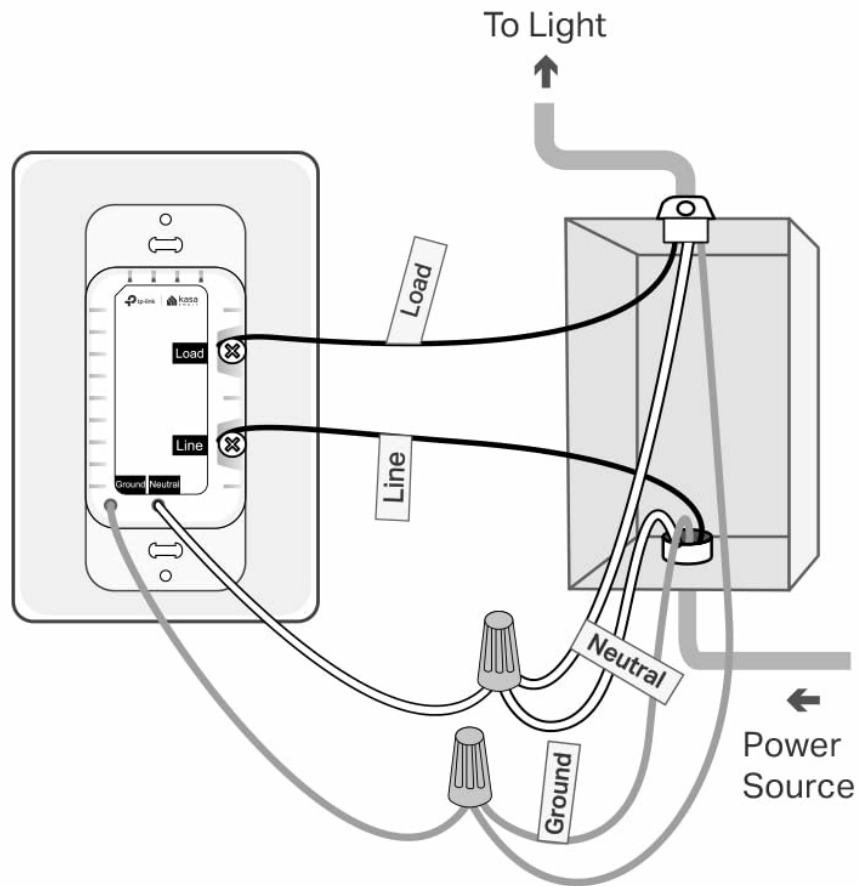

## Basic Wiring Guide

The Kasa Smart Dimmer connects to your existing wires but also needs a neutral wire. A ground wire is recommended and may be required in some regions.

Figure 6: Scan the QR code for Matter setup and access troubleshooting resources.  
For Matter setup videos and troubleshooting, visit the [TP-Link Support FAQ](#).

### 3. OPERATING INSTRUCTIONS

#### Smart Dimming

Adjust the light dimming range from 1% to 100% using the physical switch, the Kasa app, or voice commands. Ensure connected lights are dimmable.





## Control from Anywhere

Control your lights, ceiling fans, and other fixtures from anywhere via the Kasa Smart app.

Figure 7: Brightness control from 1% to 100%.

### Voice Control

Control your lights hands-free using voice commands with Siri, Amazon Alexa, or Google Assistant.

# Replace Your Traditional Single Pole Switch

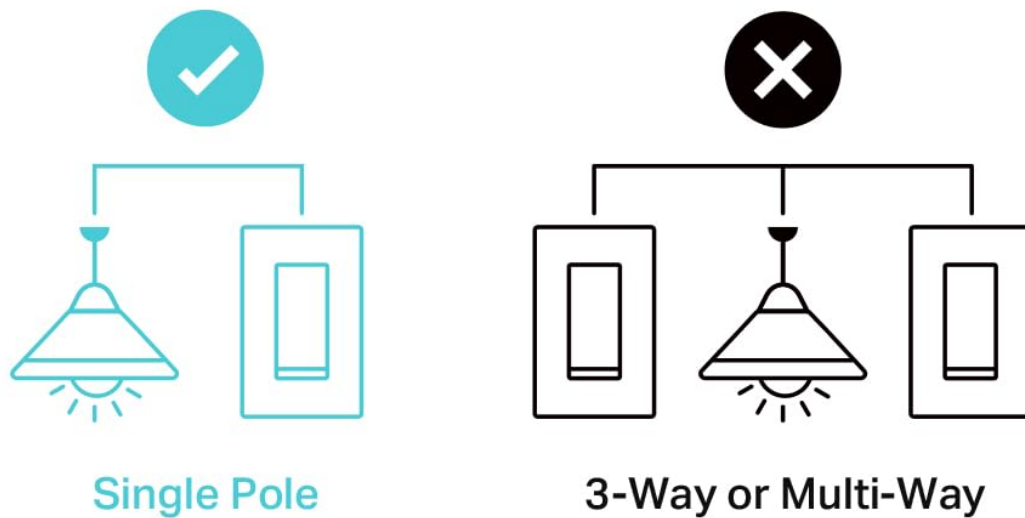

- Supports max **600W** Incandescent/LED/CFL bulbs
- Secure **2.4 GHz WiFi** network required
- Check for **neutral wires**

Figure 8: Voice control with smart assistants.

## Control From Anywhere

Monitor your light status and turn electronics on or off remotely using the Kasa App from your smartphone.

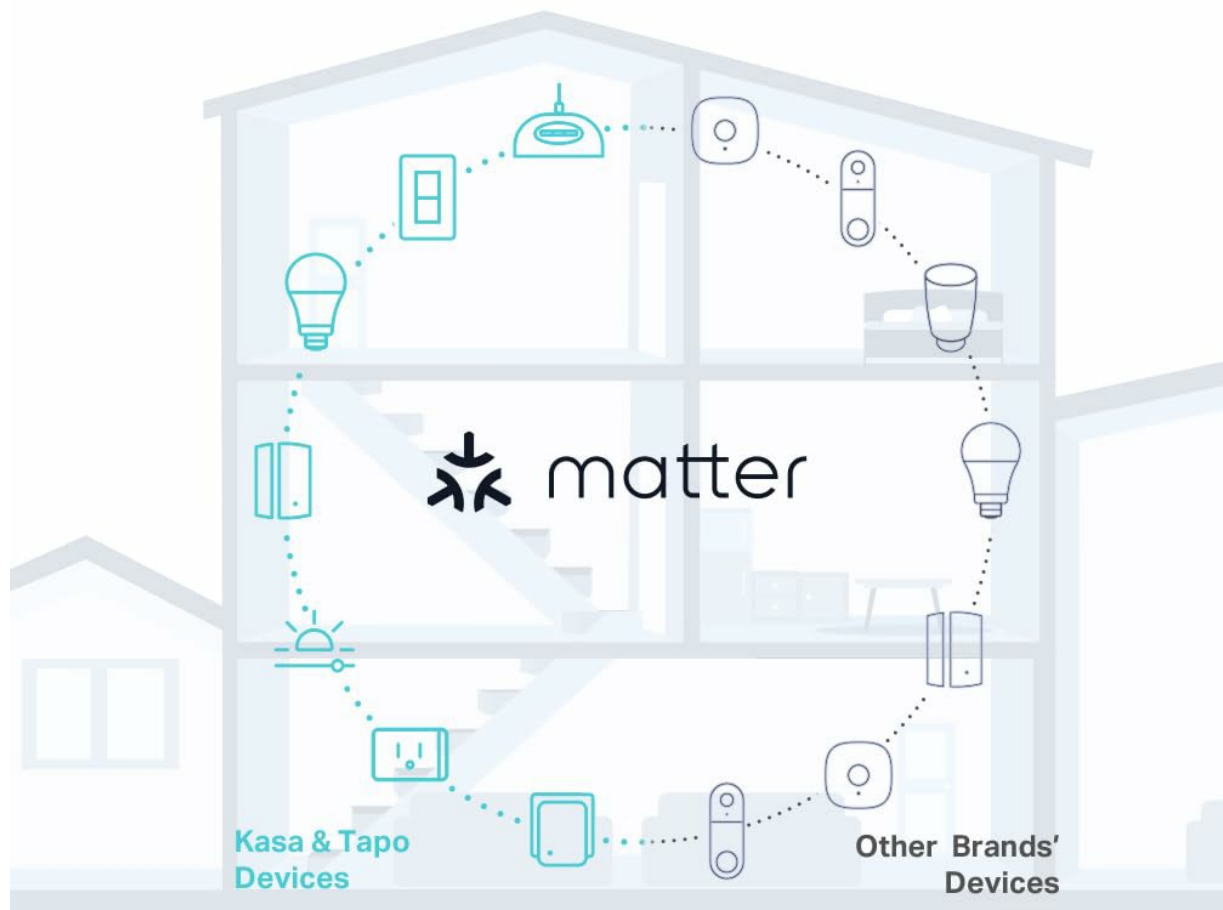

With Matter, users are no longer limited to specific smart home platforms. Integrate your Kasa Matter devices with other certified products into your preferred ecosystem.

Figure 9: Remote control via the Kasa Smart app.

### Advanced Scheduling & Timer

Set timer or countdown schedules for automatic on/off functionality. Utilize 'Away Mode' to randomly switch lights to simulate occupancy.

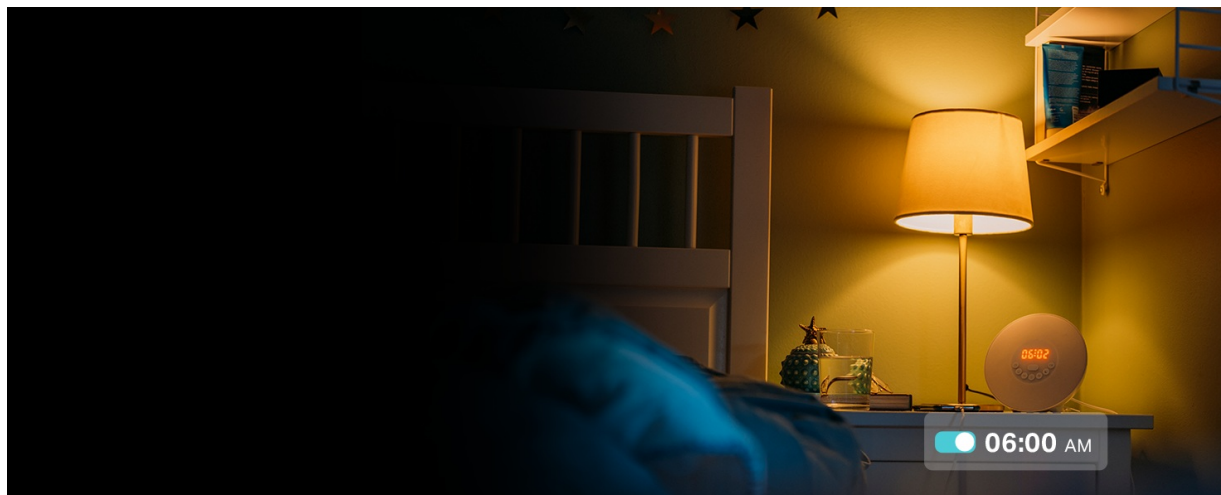

Figure 10: Advanced scheduling options in the Kasa app.

### Fade On/Off



Smoothly illuminate or dim your lights with the fade on/off feature, providing a gradual transition in lighting.

## Scan the QR Code



### Setup Videos

Matter setup for Amazon Alexa, Apple Home, Google Home, and SmartThings



### Troubleshooting & Help



## Frequently Asked Questions for Matter

Figure 11: Fade On/Off feature for gradual lighting changes.

## 4. MAINTENANCE

To maintain optimal performance of your Kasa Smart Dimmer Switch, ensure it is kept clean and free from dust. Periodically check for firmware updates through the Kasa app to benefit from the latest features and security enhancements. Always disconnect power at the circuit breaker before performing any physical maintenance on the switch.

## 5. TROUBLESHOOTING

If you encounter issues with your Kasa Smart Dimmer Switch, refer to the following general troubleshooting steps:

- **Connectivity Issues:** Ensure your 2.4GHz Wi-Fi network is active and the switch is within range. Restart your router and the smart switch.
- **App Control Problems:** Verify your Kasa app is updated to the latest version. Check your smartphone's internet connection.
- **Dimming Malfunctions:** Confirm that the connected light bulbs are dimmable. Non-dimmable bulbs may cause flickering or not dim at all.

- **Installation Errors:** Double-check all wiring connections against the provided diagram. Ensure the neutral wire is correctly connected. If unsure, consult a qualified electrician.
- **Matter Compatibility:** Ensure your Matter-compatible hub (if required) is properly set up and updated.

For more detailed troubleshooting and FAQs, please visit the [TP-Link Support website](#) or contact Kasa Smart customer support.

## 6. SPECIFICATIONS

Feature	Detail
Model Number	KS225
Product Dimensions	5.04 x 3.33 x 1.78 inches
Item Weight	6.38 ounces
Operating Voltage	120 Volts
Current Rating	2.5 Amps
Switch Type	One-way (Single Pole)
Material	Plastic
Connectivity	2.4GHz Wi-Fi, Matter Compatible
Manufacturer	TP-Link

## 7. WARRANTY AND SUPPORT

For warranty information and technical support, please refer to the official TP-Link website or contact Kasa Smart customer service directly. The Quick Start Guide included with your product also contains contact details and warranty specifics.

Online Support: [TP-Link Support](#)