

NICE DIGI X1

NICE DIGI Smart Keypad Door Lock with Handle (Model X1)

User Instruction Manual

1. PRODUCT OVERVIEW

The NICE DIGI Model X1 is a versatile smart keypad door lock designed for front and interior doors, offering multiple secure entry methods. This manual provides comprehensive guidance for its installation, operation, and maintenance.

- **Multiple Unlock Methods:** Access your door using fingerprint, mobile application control, custom codes, key fobs, or traditional mechanical keys. Alexa voice unlock is also available with a separate WiFi Gateway.
- **Easy Installation:** Designed for quick replacement of existing door handles, knobs, or deadbolts with minimal tools. No additional drilling is typically required.
- **App Management:** Grant permanent or time-limited access to family members, generate one-time passcodes for visitors, and monitor unlock records directly from the mobile application.
- **Enhanced Security:** Features a 0.3s fingerprint recognition, AES-256 smart encrypted chip, and an IP66 waterproof keypad for durability and security.



Figure 1: NICE DIGI Smart Keypad Door Lock (Model X1) with its various access components.

2. SETUP AND INSTALLATION

The Model X1 lock is designed for a straightforward installation process, typically taking around 5 minutes with a screwdriver. Ensure your door thickness is between 1-3/8" and 2".

2.1 Included Components

- Face Plate (1)
- Back Plate (1)
- Hardware Assembly (1)
- User Guide (1)
- Adjustable Latchbolt (1)
- Physical Key (2, duplicable)

- Key Fob (2, available for purchase, Card Frequency: 13.56MHz)

2.2 Installation Steps

1. **Prepare the Door:** Remove your existing door hardware. The Model X1 fits most standard American home front wooden doors.
2. **Install Latchbolt:** Insert the adjustable latchbolt into the door edge. Ensure it is oriented correctly for your door's swing.
3. **Install Exterior Assembly:** Place the exterior face plate onto the door, aligning it with the latchbolt.
4. **Install Interior Assembly:** Attach the interior back plate, connecting the necessary cables and securing it with screws.
5. **Insert Batteries:** Open the battery cover on the interior assembly and insert 4 AA batteries (not included).
6. **Test Operation:** After installation, test all functions (mechanical key, keypad, fingerprint) to ensure proper operation before closing the door.

DIY Installation in 5 mins



No extra drilling

5-mins easy installation with just a screwdriver (no included)

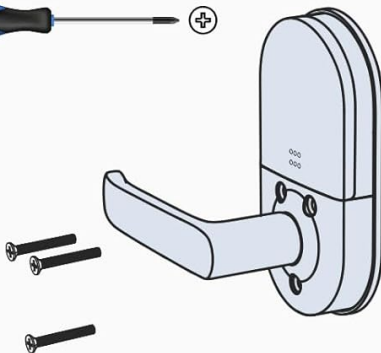

No Extra Drilling

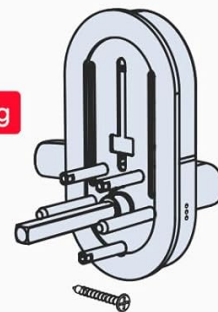
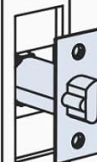

Door Thickness
1-3/8" ~ 2"

Size



Reversible Handle

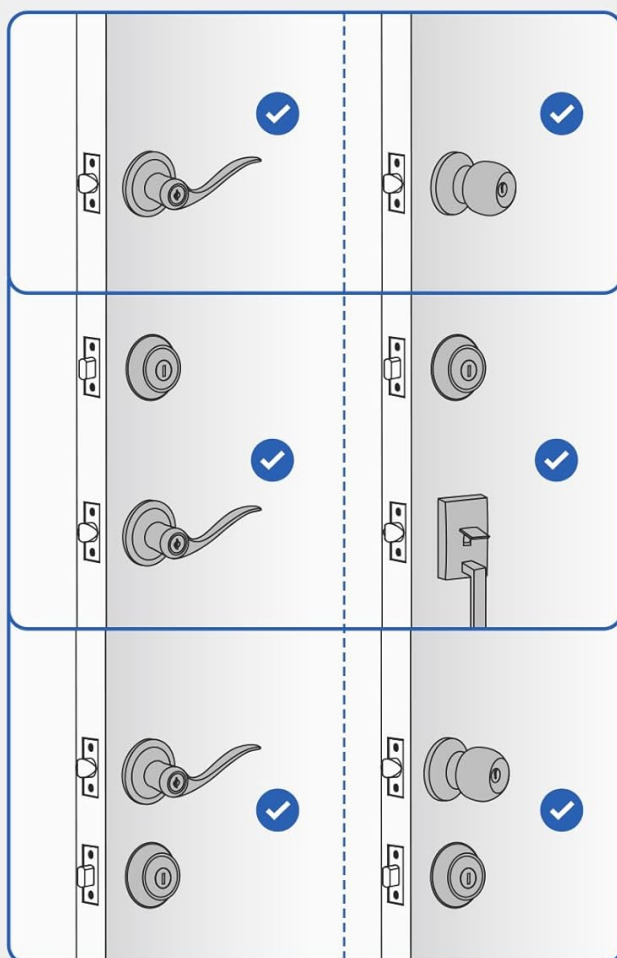

Figure 2: DIY Installation Guide for the Model X1 lock.

Wide Compatibility



Before



After

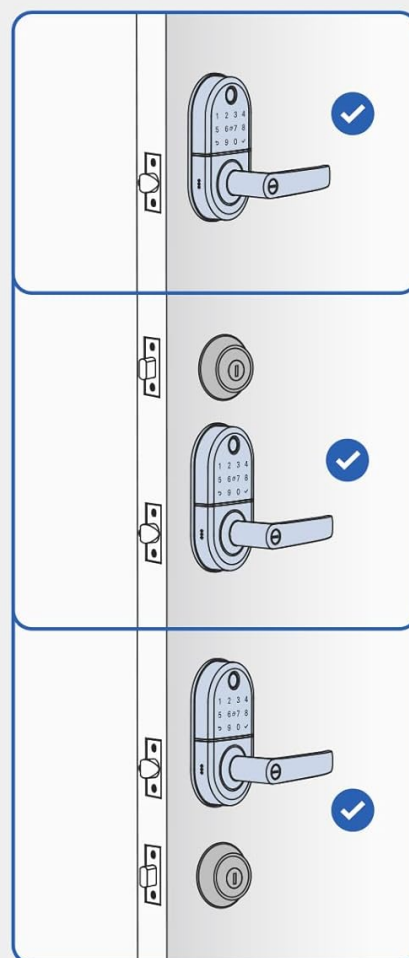

Figure 3: Wide compatibility with existing door hardware types.

2.3 Reversible Handle

The handle is reversible to fit both left and right-handed doors. Adjust the handle direction during installation as needed.

3. OPERATING INSTRUCTIONS

The Model X1 offers several convenient ways to unlock your door.

3.1 Unlocking Methods

- **Fingerprint:** Place your registered finger on the sensor for quick access. The lock features 0.3s fingerprint recognition.
- **Keypad:** Enter your programmed passcode on the illuminated keypad.
- **Key Fob:** Tap a registered key fob against the lock's sensor.

- **Mobile App:** Use the NICE DIGI app on your smartphone to unlock the door via Bluetooth.
- **Mechanical Key:** In case of emergency or battery depletion, use the physical key provided.
- **Alexa Voice Unlock:** (Requires WiFi Gateway, sold separately) Integrate with Amazon Alexa for voice-controlled unlocking.

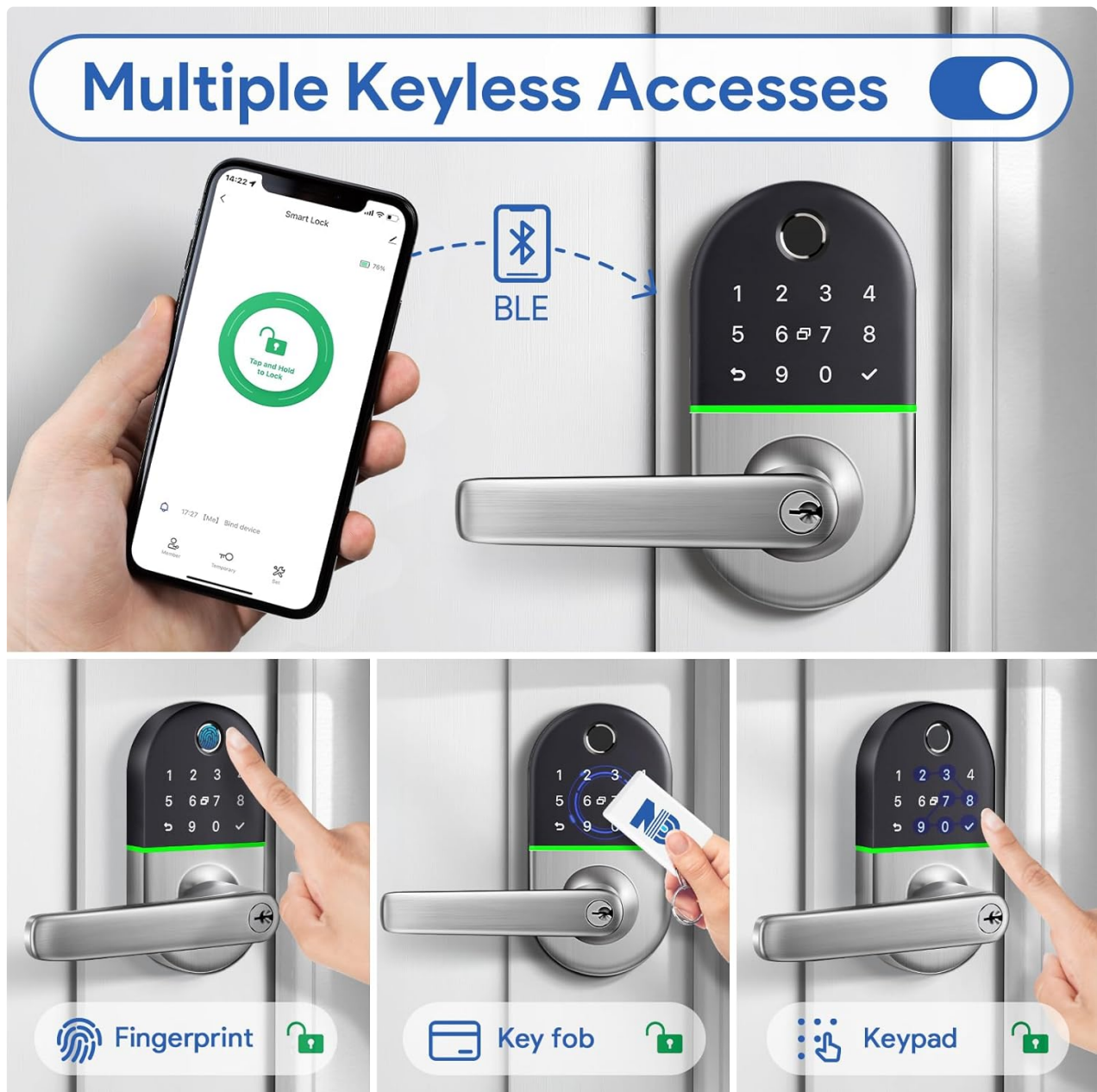

Figure 4: Multiple keyless access options for the Model X1.

Your Finger is Your Key



Figure 5: Fingerprint is your key, highlighting speed and security features.

3.2 Mobile App Control

The NICE DIGI app provides comprehensive control and management features:

- **Grant Access:** Easily add or remove users and assign permanent or time-limited access permissions.
- **Generate Passcodes:** Create one-time or temporary passcodes for guests or service providers remotely.
- **View History:** Access a detailed log of who unlocked the door and when.
- **Auto-Lock:** Configure the lock to automatically secure itself after a set period.
- **Family Management:** Manage access for multiple family members or properties.

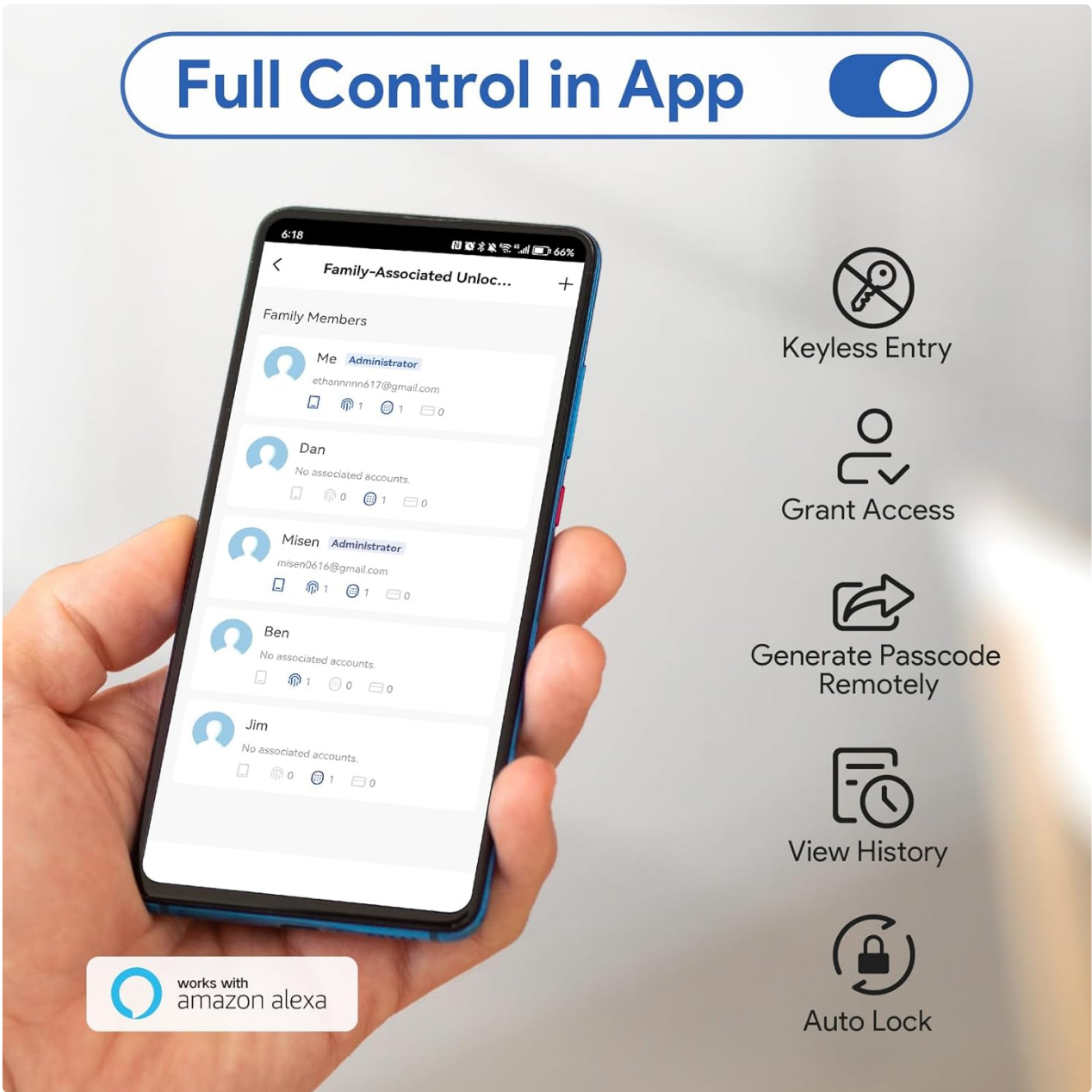

Figure 6: Full control of your lock via the mobile app.



Figure 7: Generating temporary passcodes for visitors.



Figure 8: Reviewing unlock history in the app.

4. MAINTENANCE

Proper maintenance ensures the longevity and optimal performance of your NICE DIGI smart lock.

4.1 Battery Management

The lock operates on 4 AA batteries (not included) and offers approximately 1 year of battery life. The app will notify you when battery levels are low. Replace all batteries simultaneously with new, high-quality alkaline batteries.



Figure 9: Battery compartment and estimated battery life.

4.2 Emergency Backup Power

In the event of complete battery depletion, the lock features a Type-C port for emergency backup power. Connect a portable power bank to this port to temporarily power the lock and gain access.



Figure 10: Emergency backup power via Type-C port.

4.3 Cleaning and Durability

The keypad is IP66 waterproof, offering protection against dust and strong jets of water. Clean the lock's exterior with a soft, damp cloth. Avoid abrasive cleaners or solvents that could damage the finish or electronic components.



Figure 11: IP66 Waterproof Keypad for enhanced durability.

5. TROUBLESHOOTING

This section addresses common issues you might encounter with your smart lock.

- **Lock Not Responding:** Check battery levels. If batteries are low or depleted, replace them or use the emergency Type-C backup power.
- **Fingerprint Reader Issues:** Ensure your finger is clean and dry. Re-register your fingerprint if recognition becomes inconsistent. In cold weather, some users have reported reduced performance; ensure the lock is not exposed to extreme cold for prolonged periods.
- **Keypad Not Working:** Verify that the lock has power. Ensure you are entering the correct passcode. Try resetting the lock if the issue persists (refer to the full user guide for reset instructions).
- **App Connectivity Problems:** Ensure Bluetooth is enabled on your smartphone and you are within range of the lock. Check if the app is updated to the latest version.
- **Auto-Lock Feature Not Engaging:** Verify the auto-lock settings within the mobile application. Ensure the door sensor (if applicable) is properly aligned and functioning.

For more detailed troubleshooting steps, please refer to the comprehensive User Guide PDF available online.

6. SPECIFICATIONS

Feature	Detail
Brand	NICE DIGI
Model Name	X1
Lock Type	Biometric, Combination Lock, Keypad
Special Features	Anti-Drill, Auto-Lock, Fingerprint, One-Touch Lock
Material	Aluminum
Color	Black-silver
Item Dimensions (L x W x H)	2.79 x 2.7 x 5.39 inches
Item Weight	2.66 pounds
Power Source	4 x AA Batteries (not included)
Emergency Power	Type-C Port
Connectivity Protocol	Bluetooth, Wi-Fi (with optional Gateway)
Control Method	App, Touch, Voice (with optional Gateway)
Included Components	Face Plate, Back Plate, Hardware Assembly, User Guide, Adjustable Latchbolt, 2 Physical Keys, 2 Key Fobs
UPC	709226220253

7. WARRANTY AND SUPPORT

NICE DIGI is committed to providing reliable security solutions and customer satisfaction.

7.1 Product Coverage

- **30-Day Money-Back Guarantee:** If you are not satisfied with your purchase, you may return it within 30 days for a full refund.
- **1-Year Product Coverage:** The Model X1 smart lock is covered by a 1-year warranty against manufacturing defects.
- **Lifetime After-Sales Support:** NICE DIGI provides lifetime technical support for your product.

7.2 Protection Plans

Extended protection plans are available for purchase:

- **3-Year Protection Plan:** Extends coverage for an additional 3 years.
- **4-Year Protection Plan:** Extends coverage for an additional 4 years.
- **Complete Protect:** A comprehensive plan covering eligible past and future purchases.



7.3 Additional Resources

For a detailed user guide and further assistance, please refer to the official PDF document:

[Download User Guide \(PDF\)](#)

For direct support, please visit the [NICE DIGI Store on Amazon](#) or contact customer service.

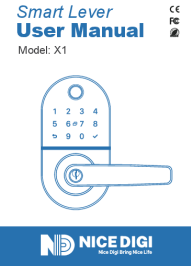
Related Documents - X1

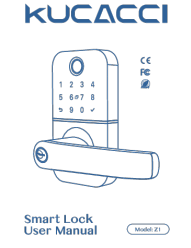
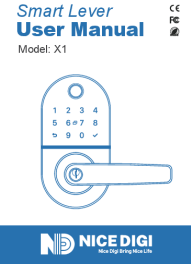
 <p>Smart Lever User Manual Model: X1</p>	<p>Nice Digi Smart Lever X1 User Manual</p> <p>Comprehensive user manual for the Nice Digi Smart Lever X1, covering installation, setup, app usage, features, and troubleshooting for this keyless entry smart lock.</p>
 <p>FINGERPRINT DOOR LOCK X1</p>	<p>X1 Fingerprint Door Lock User Manual and Installation Guide</p> <p>Comprehensive user manual for the X1 Fingerprint Door Lock, detailing installation, operation modes (fingerprint, password, card, key), user management, Wi-Fi connectivity via Tuya app, and factory reset procedures.</p>
 <p>KUCACCI</p> <p>Smart Lock User Manual Model Z1</p>	<p>KUCACCI Smart Lock User Manual - Model Z1</p> <p>Comprehensive user manual for the KUCACCI Smart Lock Model Z1, covering installation, setup, user guide, and troubleshooting. Learn how to install, pair with the NICE DIGI app, manage users, and use various unlocking methods.</p>
 <p>Smart Lever User Manual Model: X1</p>	<p>Nice Digi Smart Lever X1 User Manual</p> <p>Comprehensive user manual for the Nice Digi Smart Lever X1, covering installation, setup, app usage, features, and troubleshooting for this keyless entry smart lock.</p>

