

## GuuYebe LED-TESTER-TV-BACKLIGHT-TESTE-XXXXXXX

# GuuYebe LED Tester User Manual

Model: LED-TESTER-TV-BACKLIGHT-TESTE-XXXXXXX

Brand: GuuYebe

## 1. INTRODUCTION

The GuuYebe LED Tester is a specialized tool designed for efficiently testing TV LED backlight strips and individual LED lamp beads. It provides a safe and accurate method for identifying faulty LEDs, aiding in repair and replacement processes. This device features intelligent adjustment of output voltage and current, a soft start mode, and a clear digital display for precise measurements.

## 2. SAFETY INFORMATION

**Please read all safety instructions before operating the device.**

- **Input Voltage:** Ensure the input voltage is within the specified range of 85-265V.
- **Output Voltage:** The tester outputs 0-300V. Handle with care to avoid electric shock.
- **Probe Handling:** Do not connect the two test probes or terminals together for an extended period. Turn off the power when the device is not in use.
- The device is designed with intelligent voltage and current adjustment to prevent electric shock and sparking during short circuits. However, always exercise caution.

## 3. PACKAGE CONTENTS

Verify that all items are present in your package:

- GuuYebe LED Tester Unit
- Power Cord (US Plug)
- Universal Meter Probes (Red and Black)

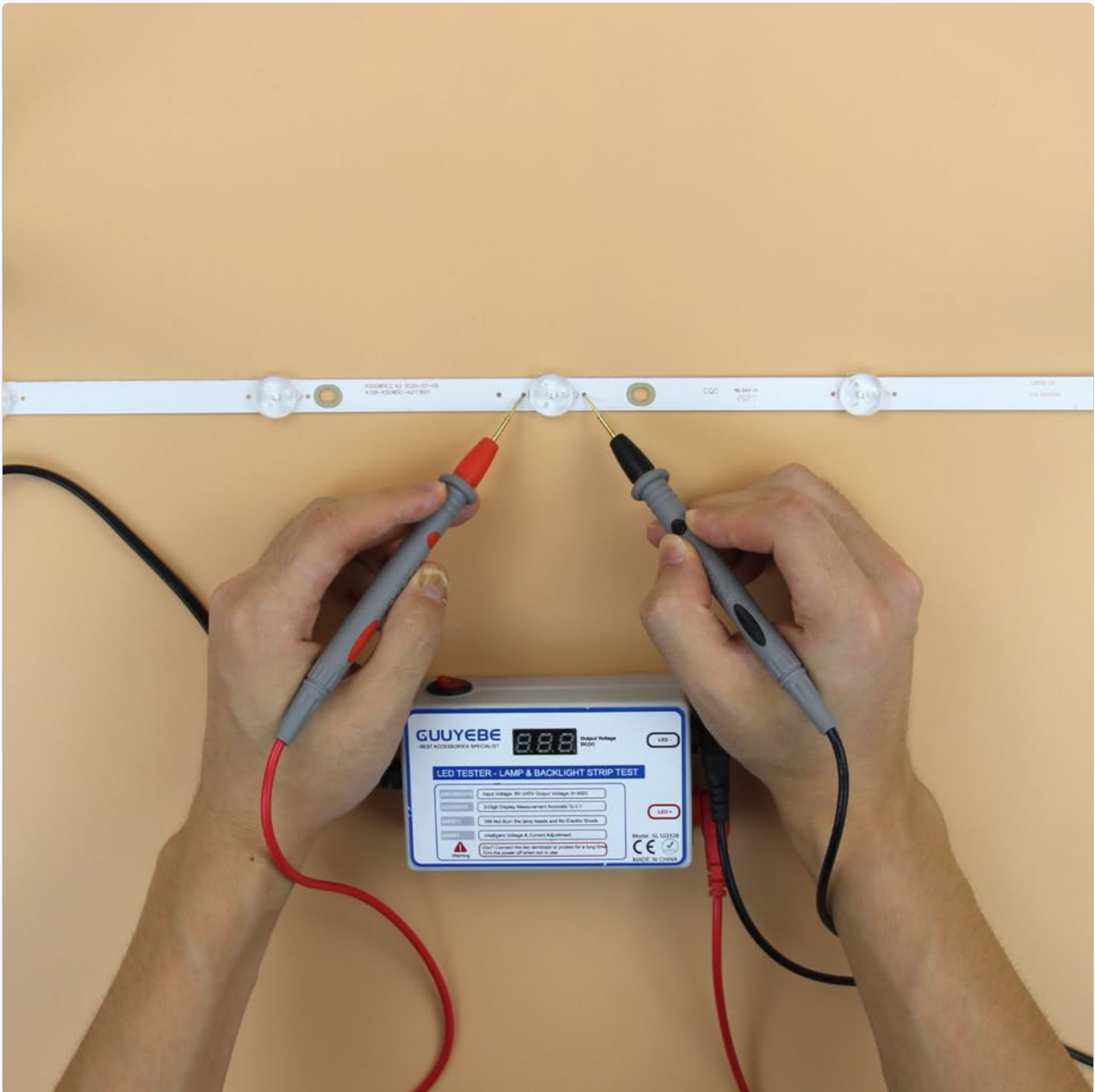

Image 3.1: Contents of the GuuYebe LED Tester package.

## 4. SPECIFICATIONS

Feature	Specification
Input Voltage	85-265V (International General)
Output Voltage	0-300V
Output Current	30mA
Measurement Accuracy	Accurate to 0.1V (3-Digit Display)
Model Number	LED-TESTER-TV-BACKLIGHT-TESTE-XXXXXXX

Power Source	Corded Electric
Color	Black
Dimensions	10.71 x 3.27 x 1.93 inches
Weight	8.78 ounces

## 5. SETUP

1. **Connect Power:** Plug the power cord into the tester unit and then into a standard electrical outlet (85-265V).
2. **Attach Probes:** Connect the red probe to the positive (+) terminal and the black probe to the negative (-) terminal on the tester unit.
3. **Power On:** Flip the power switch to the 'ON' position. The digital display will illuminate. Allow a few seconds for the voltmeter to stabilize and display the initial 300V reading. This indicates the soft start mode is active.



Image 5.1: The GuuYebe LED Tester with all components connected.

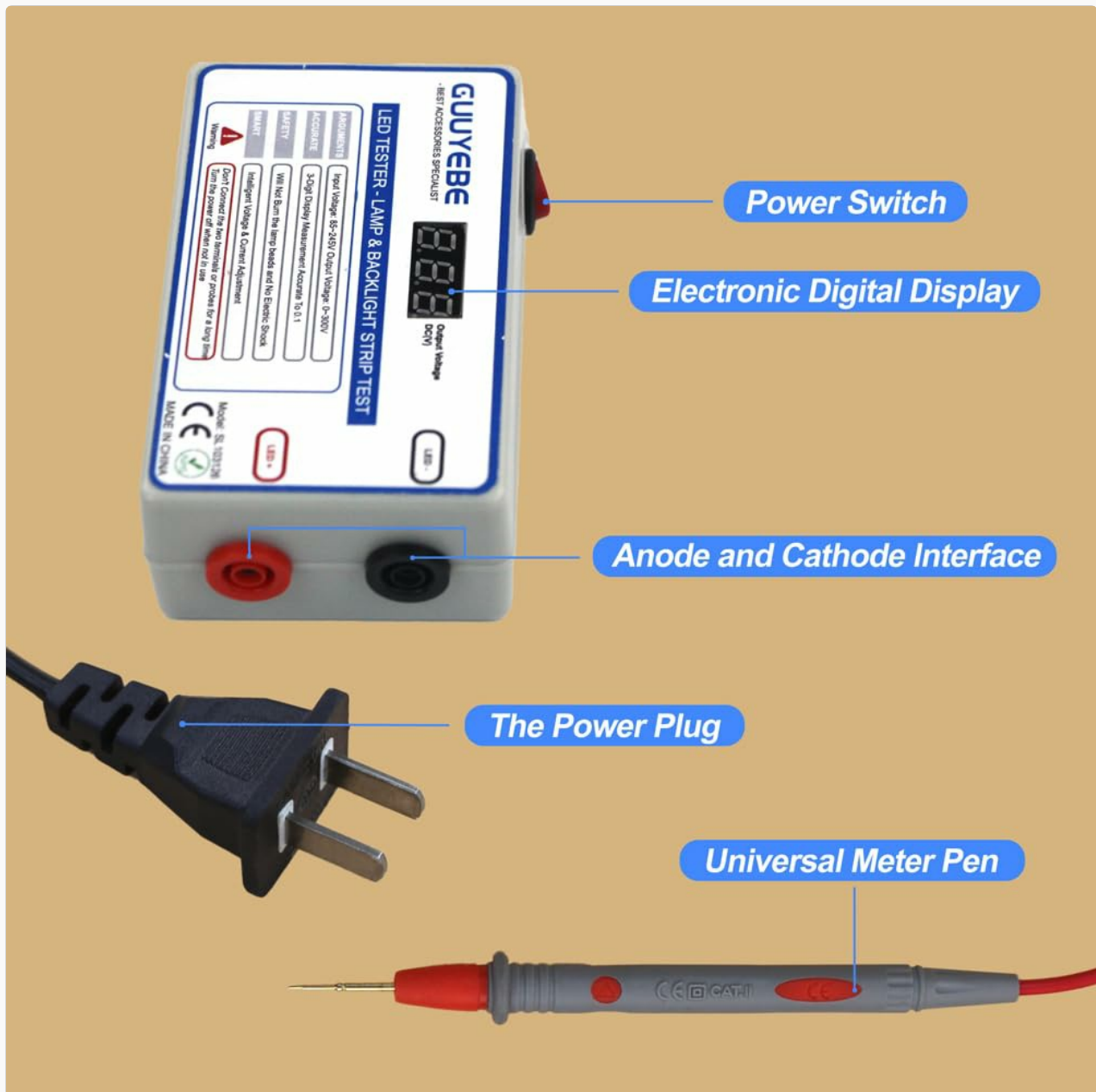

Image 5.2: Key components of the LED Tester.

## 6. OPERATING INSTRUCTIONS

The LED Tester is designed to safely test LED components. The output voltage automatically adjusts to the load, preventing damage to the LEDs.

### 6.1. Testing Individual LED Beads

1. Ensure the tester is powered on and probes are connected.
2. Identify the anode (+) and cathode (-) of the LED bead. The red probe connects to the anode, and the black probe to the cathode.
3. Carefully touch the tips of the probes to the respective terminals of the LED bead.

4. Observe the LED bead. If it lights up, it is functional. The digital display will show the forward voltage of the LED.

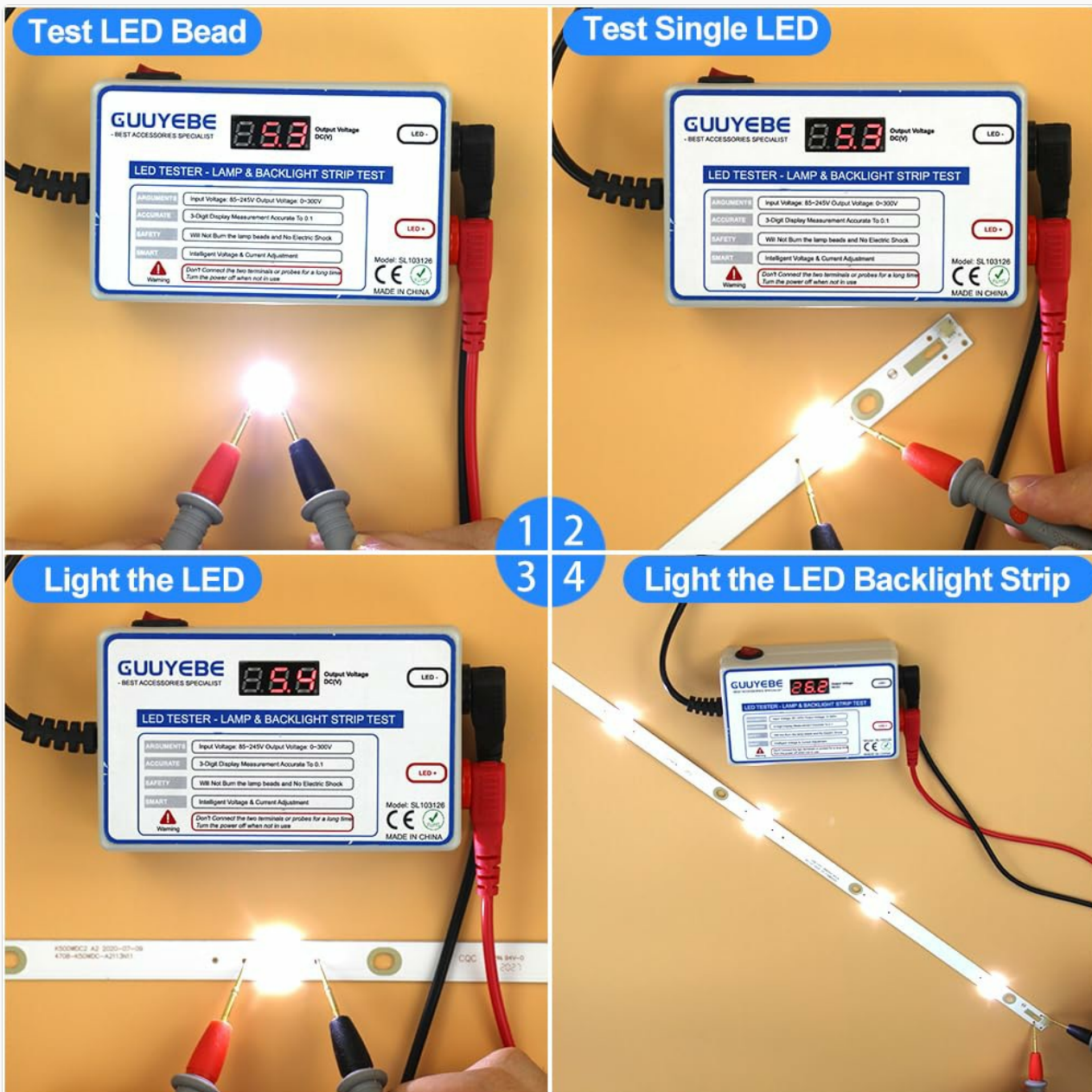

Image 6.1: Testing an individual LED bead.

## 6.2. Testing LED Backlight Strips

1. Ensure the tester is powered on and probes are connected.
2. Identify the positive (+) and negative (-) terminals on the LED backlight strip. These are usually marked.
3. Connect the red probe to the positive terminal and the black probe to the negative terminal of the LED strip.
4. The LED strip should illuminate. The digital display will show the total voltage across the strip. If only a portion of the strip lights up, or if some LEDs are dim, it indicates a fault within that section.

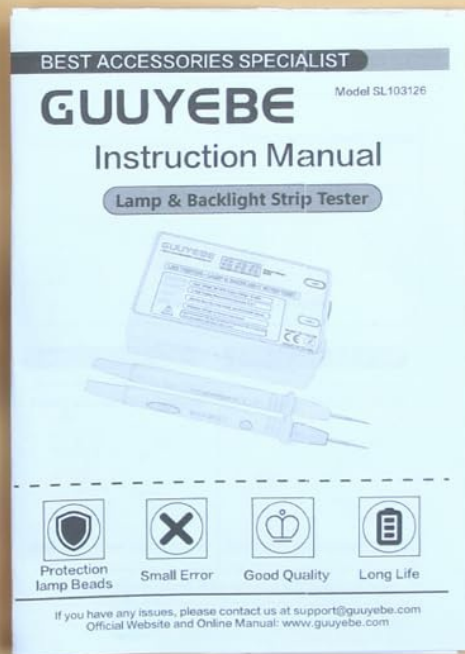

Image 6.2: Testing an LED backlight strip.

# Light or Test the LED Backlight Strip



Image 6.3: Visual representation of testing an LED backlight strip.

## 7. MAINTENANCE

- **Cleaning:** Wipe the device with a soft, dry cloth. Do not use abrasive cleaners or solvents.
- **Storage:** Store the LED Tester in a cool, dry place away from direct sunlight and extreme temperatures.
- **Probe Care:** Keep the probe tips clean and free from debris to ensure accurate contact.
- **Power Off:** Always turn off the device and unplug it from the power source when not in use for extended periods.

## 8. TROUBLESHOOTING

### Device does not power on:

Ensure the power cord is securely plugged into both the tester and a functional electrical outlet. Check the power switch is in the 'ON' position.

### LEDs do not light up during testing:

Verify that the probes are making good contact with the LED terminals. Confirm correct polarity (red to anode, black to cathode). The LED itself might be faulty.

### Inconsistent voltage readings:

Allow a few seconds after powering on for the device to stabilize. Ensure probes are clean and connections are secure. Environmental factors or a faulty component being tested can also affect readings.

### Digital display shows '300' continuously:

This is the normal idle state after the soft start. The voltage will drop and display the actual voltage when a load (LED) is connected.

## 9. WARRANTY AND SUPPORT

---

### 9.1. Warranty Information

The GuuYebe LED Tester comes with a **1-year warranty** from the date of purchase. This warranty covers manufacturing defects and malfunctions under normal use. Please retain your proof of purchase for warranty claims.

### 9.2. Customer Support

For any questions, technical assistance, or warranty claims, our customer support team is available **7 days a week, 24 hours a day**. You can reach us via email at [support@guuybe.com](mailto:support@guuybe.com). We also provide online installation services privately if needed.