

## Manuals+

[Q & A](#) | [Deep Search](#) | [Upload](#)

[manuals.plus](#) /

› [PINKCAT](#) /

› [PINKCAT Mini Wireless Keyboard and Mouse Combo User Manual](#)

## PINKCAT Mini Wireless Keyboard and Mouse Combo

# PINKCAT Mini Wireless Keyboard and Mouse Combo User Manual

Model: Mini Wireless Keyboard and Mouse Combo

## 1. INTRODUCTION

This manual provides instructions for the setup, operation, maintenance, and troubleshooting of your PINKCAT Mini Wireless Keyboard and Mouse Combo. Please read this manual thoroughly before use to ensure optimal performance and longevity of your device.

## 2. PACKAGE CONTENTS

- 1 x PINKCAT Mini Wireless Keyboard
- 1 x PINKCAT Wireless Mouse
- 1 x USB Nano Receiver (stored inside the mouse)
- 1 x User Manual



Image 2.1: The PINKCAT Mini Wireless Keyboard and Mouse Combo, including the USB receiver.

### 3. SETUP GUIDE

#### 3.1 Battery Installation

The keyboard requires two AAA batteries, and the mouse requires one AA battery. Batteries are not included.

1. **For the Keyboard:** Locate the battery compartment on the underside of the keyboard. Open the cover, insert two AAA batteries, ensuring correct polarity (+/-), and close the cover.
2. **For the Mouse:** Locate the battery compartment on the underside of the mouse. Open the cover, insert one AA battery, ensuring correct polarity (+/-), and close the cover.

#### 3.2 Connecting the USB Receiver

The USB nano receiver is stored in the battery compartment of the mouse for convenience during transport.

1. Remove the USB nano receiver from the mouse's battery compartment.
2. Plug the USB receiver into an available USB port on your computer (laptop, PC, Mac, etc.).
3. The keyboard and mouse will automatically connect to your computer. No additional drivers are required for installation.



Image 3.1: Location of the USB receiver inside the mouse.



Image 3.2: Illustration of plugging the USB receiver into a computer's USB port.

### 3.3 First Use

Once the batteries are installed and the USB receiver is plugged in, your keyboard and mouse are ready for

immediate use. The 2.4G wireless connection provides a reliable range of up to 10 meters (33 feet).

## 4. OPERATING INSTRUCTIONS

### 4.1 Keyboard Features

- **Ergonomic Design:** The keyboard features an optimal slope designed to reduce wrist strain during extended typing sessions.
- **Quiet Typing:** Equipped with a scissor-switch (X structure) mechanism, the keys offer a comfortable and quiet typing experience, suitable for various environments.
- **12 Multimedia Hotkeys:** Access common functions quickly using the Fn key in combination with the F1-F12 keys.

## Comfortable Typing Experience



Image 4.1: The ergonomic design of the keyboard, featuring an 8-degree natural angle for comfortable typing.



## **NEWEST SCISSOR-SWITCH**

More accurate, faster and quieter typing

Image 4.2: The scissor-switch key mechanism, designed for accurate, faster, and quieter typing.

# 12 Multimedia Shortcuts



## Combination Keys Description :

Fn + F1 : Media player	Fn + F7 : Pause / Play
Fn + F2 : Volume down	Fn + F8 : Stop
Fn + F3 : Volume up	Fn + F9 : Open browser
Fn + F4 : Mute	Fn + F10 : Open mailbox
Fn + F5 : Previous	Fn + F11 : Open computer
Fn + F6 : Next	Fn + F12 : Bookmark the page

Image 4.3: The keyboard layout, detailing the 12 multimedia shortcuts and their functions.

### Multimedia Shortcut Functions:

- **Fn + F1:** Media player
- **Fn + F2:** Volume down
- **Fn + F3:** Volume up
- **Fn + F4:** Mute
- **Fn + F5:** Previous track
- **Fn + F6:** Next track
- **Fn + F7:** Pause / Play
- **Fn + F8:** Stop
- **Fn + F9:** Open browser
- **Fn + F10:** Open mailbox
- **Fn + F11:** Open computer
- **Fn + F12:** Bookmark the page

## 4.2 Mouse Features

- **Adjustable DPI:** The mouse offers adjustable DPI settings (1000/1200/1600) to customize cursor sensitivity. Press the DPI button located on the top of the mouse to cycle through the settings.



Image 4.4: The mouse indicating its adjustable DPI settings of 1000, 1200, and 1600.

### 4.3 Smart Power Saving Mode

To conserve battery life, both the keyboard and mouse feature an automatic sleep function:

- After one minute of inactivity, the devices enter a light sleep mode.
- After 10 minutes of inactivity, they enter a deep sleep mode.

To wake the devices, simply press any key on the keyboard or move the mouse. This feature allows for continuous operation for up to 6 months on a single set of batteries.



Image 4.5: Illustration of the auto-sleep mode for power conservation.

## 5. COMPATIBILITY

The PINKCAT Mini Wireless Keyboard and Mouse Combo is compatible with a wide range of operating systems and devices:

- **Operating Systems:** Windows (2000 and later), Mac OS, Android, Linux, Chrome OS, DOS.
- **Compatible Devices:** Laptops, Personal Computers (PC), Tablets, Smart TVs, iMac.



Image 5.1: Visual representation of the wide compatibility with various devices and operating systems.

## 6. MAINTENANCE

### 6.1 Battery Replacement

When the devices stop responding or exhibit intermittent connectivity, it is likely time to replace the batteries. Follow the battery installation steps in Section 3.1.

### 6.2 Cleaning

To maintain the cleanliness and functionality of your keyboard and mouse:

- Use a soft, dry, lint-free cloth to wipe the surfaces.
- For stubborn dirt, slightly dampen the cloth with water or a mild, non-abrasive cleaner.
- Avoid spraying liquids directly onto the devices.
- Do not use harsh chemicals or abrasive materials.

## 7. TROUBLESHOOTING

If you encounter issues with your PINKCAT Mini Wireless Keyboard and Mouse Combo, please refer to the following common solutions:

- **No Response from Keyboard/Mouse:**
  - Ensure batteries are correctly installed and not depleted. Replace batteries if necessary.
  - Check if the USB receiver is securely plugged into a working USB port on your computer. Try a different USB port.
  - Move the keyboard and mouse closer to the USB receiver to rule out range issues.
  - Restart your computer.
- **Intermittent Connection/Lag:**
  - Ensure there are no large metal objects or other wireless devices (e.g., Wi-Fi routers, other wireless peripherals) causing interference between the devices and the receiver.
  - Move the USB receiver to a front USB port or use a USB extension cable to bring it closer to the

keyboard and mouse.

- Replace batteries.

- **Mouse Cursor Jumps or is Inaccurate:**

- Ensure the mouse is used on a clean, non-reflective surface.
- Adjust the mouse DPI setting using the DPI button.
- Clean the optical sensor on the underside of the mouse.

## 8. SPECIFICATIONS

Feature	Detail
Brand	PINKCAT
Model	Mini Wireless Keyboard and Mouse Combo
Connectivity	2.4G Wireless (USB Receiver)
Wireless Range	Up to 10 meters (33 feet)
Keyboard Dimensions	28.4 x 13 x 1.6 cm (11 x 5.12 x 0.63 inches)
Keyboard Weight	286 g
Mouse Dimensions	11 x 6.3 x 3.2 cm (4.3 x 2.5 x 1.3 inches)
Mouse Weight	55 g
Keyboard Battery	2 x AAA (not included)
Mouse Battery	1 x AA (not included)
Mouse DPI Settings	1000 / 1200 / 1600
Special Features	Ergonomic design, 12 multimedia hotkeys, quiet scissor-switch keys, auto-sleep mode
Compatibility	Windows, Mac OS, Android, Linux, Chrome OS, DOS
Color	Gray

# Compact Layout & Ultra-thin Design

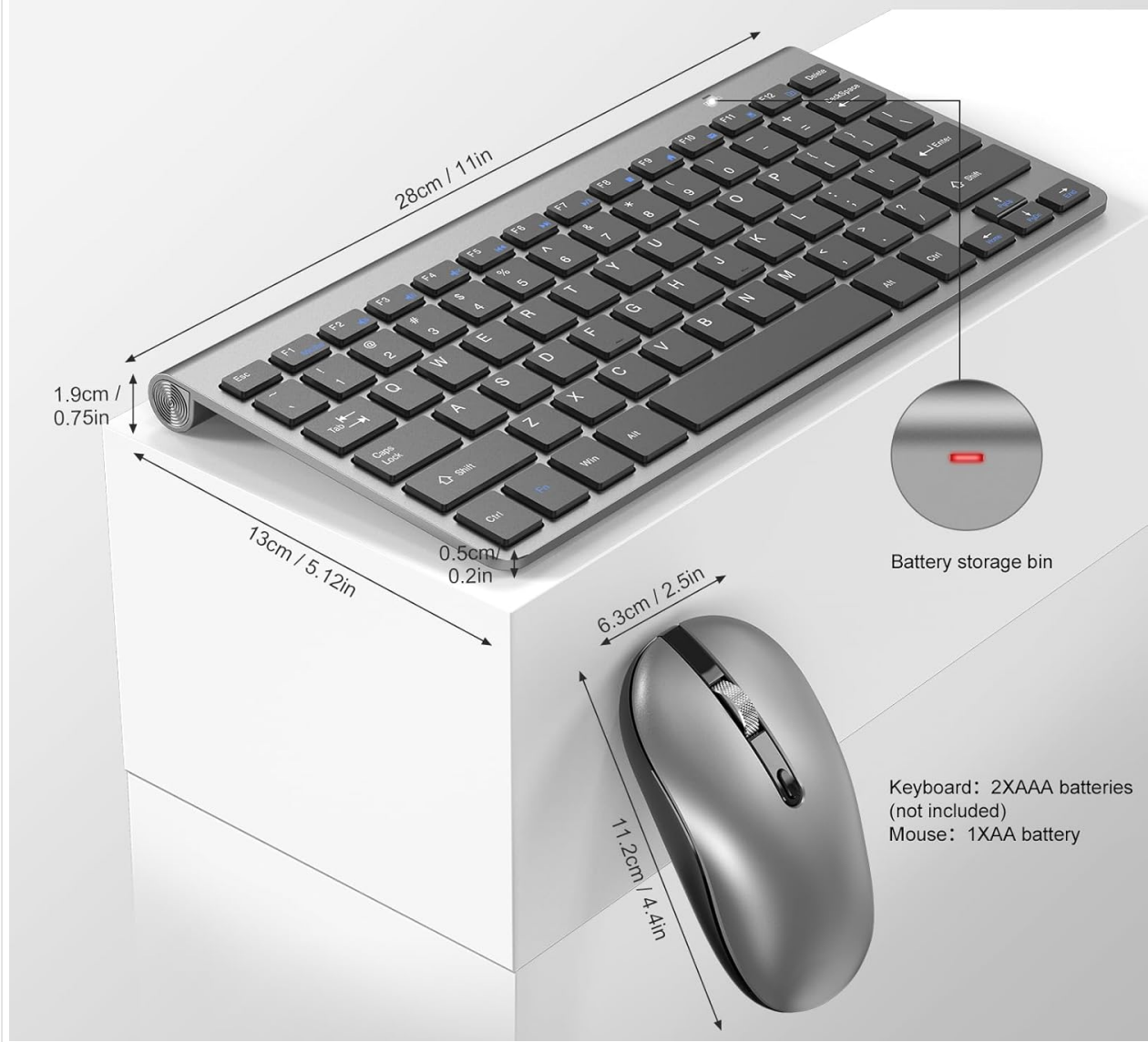

Image 8.1: Detailed dimensions of the keyboard and mouse.

## 9. SUPPORT

For any questions or assistance regarding your PINKCAT Mini Wireless Keyboard and Mouse Combo, please refer to the seller's support channels or contact information provided at the point of purchase. We are committed to providing support and service to ensure your satisfaction.