

SONOFF WTS01

SONOFF WTS01 High Precision Temperature Sensor User Manual

Model: WTS01 | Brand: SONOFF

1. INTRODUCTION

The SONOFF WTS01 is a high-precision waterproof temperature sensor designed as an accessory for SONOFF TH Elite and TH Origin smart switches. It enables accurate temperature monitoring in various environments, including moist conditions, making it ideal for a wide range of applications.



Image: The SONOFF WTS01 temperature sensor, featuring its probe and RJ9 connector.

WTS01 Waterproof Temperature Sensor

TH Elite/Origin accessory



Image: The WTS01 sensor submerged in water, demonstrating its waterproof capability, with a connected TH Elite/Origin device displaying temperature readings.

2. KEY FEATURES

- **Wide Compatibility:** Specifically designed to work seamlessly with SONOFF TH Elite and TH Origin smart switches, providing accurate temperature data to your smart home system.
- **Broad Measuring Range:** Capable of measuring temperatures from -40°C to $+115^{\circ}\text{C}$, making it suitable for diverse applications, from cold storage to warm environments.
- **Waterproof and Durable:** The sensor features a stainless steel probe that is waterproof, corrosion-resistant, and rust-proof, allowing for reliable use in moist or submerged conditions.
- **Extended Cable Length:** Equipped with a 150cm (1.5 meter) cable, providing flexibility for placement and connection to devices located farther away.
- **High Accuracy:** Ensures precise temperature readings with an accuracy of up to $\pm 0.5^{\circ}\text{C}$ over the range of -

10°C to 85°C.

Longer Cable Lengths

The 150cm cable is enough to connect to the device farther from the switch.



Wider measuring range

Measuring range from -40°C to +115°C ensures a wider application range and easier installation.

Image: Visual representation of the 1.5m cable length and the wide measuring range of -40°C to +115°C for the WTS01 sensor.

High Accuracy

Ensure accurate temperature with up to $\pm 0.5^{\circ}\text{C}$ temperature accuracy over the range of -10°C to 85°C .



Waterproof & Super-durable

The stainless steel probe is waterproof, corrosion-resistant, and rust-resistant, allowing you to use it in moist environments.

Image: Diagrams illustrating the high accuracy ($\pm 0.5^{\circ}\text{C}$) and the waterproof, durable design of the WTS01 stainless steel probe.

3. SETUP AND INSTALLATION

The SONOFF WTS01 temperature sensor is designed for simple plug-and-play installation with compatible SONOFF devices.

3.1 Connecting the Sensor

1. Ensure your SONOFF TH Elite or TH Origin device is powered off before connecting the sensor.
2. Locate the RJ9 (4P4C) interface port on your TH Elite or TH Origin device.
3. Carefully insert the RJ9 connector of the WTS01 sensor into the corresponding port until it clicks into place.
4. Once connected, you can power on your TH Elite or TH Origin device. The sensor will be automatically detected.

3.2 Placement Considerations

Place the stainless steel probe in the environment where temperature monitoring is required. Thanks to its waterproof design, it can be used in humid or wet locations, or even submerged in water.

Smaller Converter Board

Easily fits into a waterproof case and more.



Power Availability

The waterproof temperature sensor is available for SONOFF TH Origin/Elite, used to detect temperature.

Image: The WTS01 sensor connected to a SONOFF TH Origin device, and a comparison showing the TH Origin and TH Elite devices.

4. OPERATION

Once connected to a compatible SONOFF TH Elite or TH Origin device, the WTS01 sensor will immediately begin detecting and transmitting temperature data. The temperature readings will be displayed on the screen of your TH device (if applicable) and accessible through the eWeLink app on your smartphone or tablet.

The TH Elite/Origin device, in conjunction with the WTS01 sensor, allows you to:

- View real-time temperature readings.
- Set up automated scenes and smart rules based on temperature thresholds (e.g., turn on a fan if temperature exceeds a certain value).

- Monitor temperature history and trends.

5. MAINTENANCE

The SONOFF WTS01 sensor is designed for durability and requires minimal maintenance.

- **Cleaning:** If the probe becomes dirty, gently wipe it with a soft, damp cloth. Avoid using harsh chemicals or abrasive materials that could damage the stainless steel.
- **Inspection:** Periodically check the cable and connector for any signs of wear or damage. Ensure the connection to the TH device remains secure.
- **Storage:** When not in use, store the sensor in a clean, dry place away from extreme temperatures.

6. SPECIFICATIONS

Specification



Model	Cable length
WTS01	1.5m
Color	Product size
Black	50x6x6mm
Connector type	Accuracy over the range of
RJ9 (4P4C)	-10°C to 85°C
Working temperature	
-40~+115°C	

Image: A diagram summarizing the key specifications of the SONOFF WTS01 sensor.

Parameter	Value
Model	WTS01
Cable Length	1.5m
Color	Black
Connector Type	RJ9 (4P4C)
Working Temperature Range	-40°C ~ +115°C
Accuracy (over -10°C to 85°C)	±0.5°C
Product Size	50x6x6mm (probe dimensions)
Manufacturer	SONOFF
First Available Date	July 25, 2023



Image: The back of the SONOFF WTS01 packaging, showing detailed specifications and compliance information.

7. TROUBLESHOOTING

If you encounter issues with your SONOFF WTS01 sensor, consider the following:

- **No Temperature Reading:**

- Ensure the sensor is securely plugged into the RJ9 port of your TH Elite/Origin device.
- Verify that the TH Elite/Origin device is powered on and functioning correctly.
- Check if the eWeLink app is updated to the latest version.

- **Inaccurate Readings:**

- Ensure the sensor probe is not directly exposed to heat sources or extreme cold that might exceed its operating range.
- Clean the probe if there is any buildup that might affect its accuracy.
- Compare readings with another known accurate thermometer to confirm deviation.

- **Sensor Not Detected:**

- Unplug and re-plug the sensor.
- Restart your TH Elite/Origin device.
- Ensure your TH Elite/Origin device firmware is up to date.

If problems persist, please contact SONOFF customer support.

8. WARRANTY INFORMATION

The SONOFF WTS01 Temperature Sensor comes with a standard manufacturer's warranty. Please refer to the warranty card included with your product or visit the official SONOFF website for detailed warranty terms and conditions. Keep your purchase receipt as proof of purchase for warranty claims.

9. CUSTOMER SUPPORT

For technical assistance, product inquiries, or support, please contact SONOFF customer service:

- **Website:** sonoff.tech
- **Email:** support@itead.cc

When contacting support, please provide your product model (WTS01) and a detailed description of the issue.

© 2024 SONOFF. All rights reserved. This manual is subject to change without notice.

Documents - SONOFF – WTS01

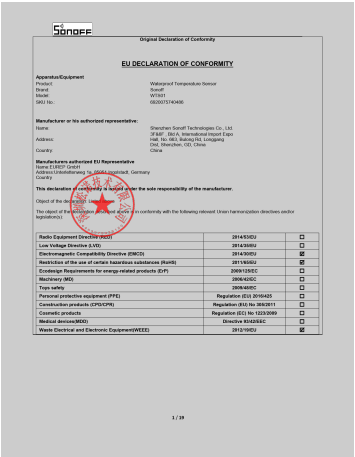

[\[pdf\]](#) User Manual Declaration of Conformity

Ryan G H Yang EU Declaration of Conformity User Manual SONOFF WTS01 CE DoC v 1753255418 cdn shopify s files 1 0742 9963 8001 |||

Original Declaration of Conformity Apparatus/Equipment Product: Brand: Model: SKU No.: EU DECLARATION OF CONFORMITY Waterproof Temperature Sensor Sonoff **WTS01** 6920075740486 Manufacturer or his authorized representative: Name: Address: Country: Shenzhen Sonoff Technologies Co., Ltd. 3F 6F , Bld A... lang:en score:41 filesize: 399.21 K page_count: 19 document date: 2024-05-22

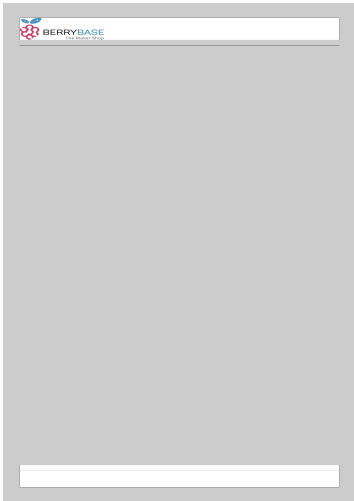

[pdf] Installation Guide Datasheet

Datasheet for Sonoff waterproof temperature sensor WTS01 THR316 320 RJ9 4P4C 1 50m The is a with connector and measures temperatures from 40°C to 115°C high accuracy THR316320 SON berrybase de en product datasheet 019234a60db470b6a80e287124f5001f create srsItd

AfmBOob9cnRD9ql8e3oijhozR82b0rXqZLzzlTEKTQRNjxV7FuKIoNR |||

Datasheet for Sonoff waterproof temperature sensor **WTS01** for THR316/320, RJ9 4P4C, 1.50m Page 1 Datasheet for Sonoff waterproof temperature sensor **WTS01** for THR316/320, RJ9 4P4C, 1.50m Page 2 Datasheet for Sonoff waterproof temperature sensor **WTS01** for THR316/320, RJ9 4P4C, 1.50m Sonoff waterpr...

lang:en score:32 filesize: 661.46 K page_count: 5 document date: 2025-07-25

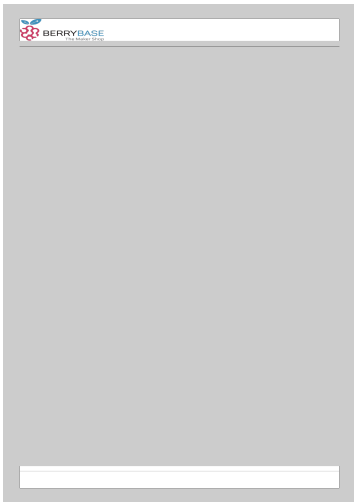

[pdf] Installation Guide Datasheet

Datasheet for Sonoff waterproof temperature sensor WTS01 THR316 320 RJ9 4P4C 1 50m The is a with connector and measures temperatures from 40°C to 115°C high accuracy THR316320 SON berrybase de en product datasheet 019234a60db470b6a80e287124f5001f create srsItd

AfmBOOpXhwFnNkX9nVixTMqY3qmObLVfluvRpiU elhGnHJzbtZ1thD |||

Datasheet for Sonoff waterproof temperature sensor **WTS01** for THR316/320, RJ9 4P4C, 1.50m Page 1 Datasheet for Sonoff waterproof temperature sensor **WTS01** for THR316/320, RJ9 4P4C, 1.50m Page 2 Datasheet for Sonoff waterproof temperature sensor **WTS01** for THR316/320, RJ9 4P4C, 1.50m Sonoff waterpr...

lang:en score:32 filesize: 661.46 K page_count: 5 document date: 2025-07-24

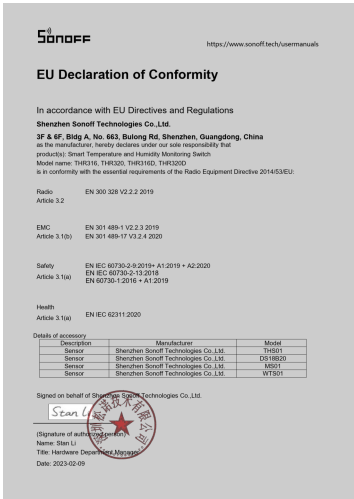

[pdf] Decleration of Conformity Accessories

Microsoft Word Declaration of Conformity DG06068 EU SONOFF Tech 9 févr 2023 — In accordance with Directives and Regulations Shenzhen Sonoff Technologies Co Ltd 3F 6F Bldg A No 663 Bulong Rd Guangdong China CE SENOR OF THR3 02 09 sonoff tech |||

https://www.sonoff.tech/usermanuals EU Declaration of Conformity In accordance with EU Directives a ... ogies Co.,Ltd. Signed on behalf of Shenzhen Sonoff Technologies Co.,Ltd. Model THS01 DS18B20 MS01 **WTS01** Signature of authorized person Name: Stan Li Title: Hardware Department Manager Date: 2023-...

lang:en score:26 filesize: 137.03 K page_count: 1 document date: 2023-02-09

[\[pdf\]](#) Borchure

2024 SONOFF V2024 07 16 1 giorno fa — Thermostat Voice Control NSPanel EU US 43 44 Rating Max Load LED load LED Gang Wireless SONOFF Product Brochure sonoff tech 10 |||

Shenzhen Sonoff Technologies Co.,Ltd Address 663 A 3F 6F, Bldg A, No. 663, Bulong Rd, Dafap ... 6,THR320:98x54x27.5mm THR316D,THR320D:98x54x31mm THR316,THR320:100g THR316D,THR320D:120g THS01,MS01,**WTS01**,RL560 TUV/CE/WWA/FCC/RoHS/SRRC * You can connect SONOFF RL560 seneor extension cable to the s...

lang:en **score:21** filesize: 10.99 M page_count: 54 document date: 2024-07-16

[\[pdf\]](#) Borchure

2024 SONOFF V2024 12 5V 2A 10 0W PC V0 40 5x34 5x21mm 43 1g USB Power Adapter Type I 5VUSB Input Output Casing material Size 1 giorno fa — Thermostat Voice Control NSPanel EU US 44 Rating Max Load LED load LED Gang Wireless SONOFF Product Brochure 2025 sonoff tech 04 |||

Shenzhen Sonoff Technologies Co.,Ltd Address 663 A 3F 6F, Bldg A, No. 663, Bulong Rd, Dafap ... 6,THR320:98x54x27.5mm THR316D,THR320D:98x54x31mm THR316,THR320:100g THR316D,THR320D:120g THS01,MS01,**WTS01**,RL560 TUV/CE/WWA/FCC/RoHS/SRRC * You can connect SONOFF RL560 seneor extension cable to the s...

lang:en **score:21** filesize: 18.6 M page_count: 52 document date: 2024-12-12

[\[pdf\]](#) Borchure

2024 SONOFF V2024 07 16 smart switch cz Jako společnost s vlastní značkou si SONOFF získala uznání za vynikající kvalitu produktů a špičkové technologické inovace T2EU2C RF T2EU3C T2EU1C 2C 3C Product Brochure cs user documents upload |||

Shenzhen Sonoff Technologies Co.,Ltd Adresa Address 663 A 3F 6F, Bldg A, No. 663, Bulong Rd, D ... 6,THR320:98x54x27,5mm THR316D,THR320D:98x54x31mm THR316,THR320:100g THR316D,THR320D:120g THS01,MS01,**WTS01**,RL560 TUV/CE/WWA/FCC/RoHS/SRRC THR316/THR320 * Mzete pipojit propojovac kabel senzoru SONOFF...

lang:it **score:20** filesize: 11.71 M page_count: 54 document date: 2025-01-28

[\[pdf\]](#) Decleration of Conformity Borchure

2025 SONOFF Product Brochure sonoff tech 04 POWCT DOC Official WATERPROOF BOX R2 PRODUCT BROCHURE Apr 14 — Wi Fi ZigBee |||

Shenzhen Sonoff Technologies Co.,Ltd Address 663 A 3F 6F, Bldg A, No. 663, Bulong Rd, Dafap ... 6,THR320:98x54x27.5mm THR316D,THR320D:98x54x31mm THR316,THR320:100g THR316D,THR320D:120g THS01,MS01,**WTS01**,RL560 TUV/CE/WWA/FCC/RoHS/SRRC * You can connect SONOFF RL560 seneor extension cable to the s...

lang:en **score:20** filesize: 10.96 M page_count: 52 document date: 2025-04-15

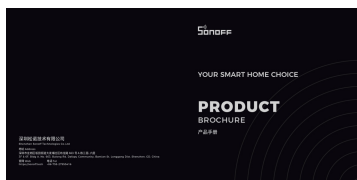
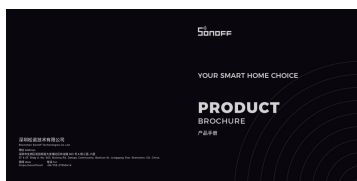
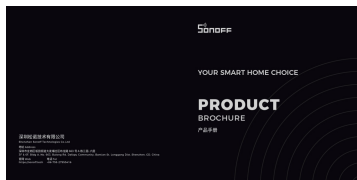

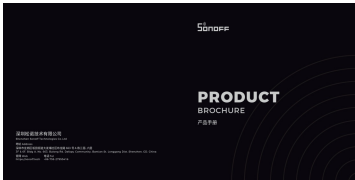

[pdf] Borchure

SONOFF 20230705 100 240V AC 50 60Hz BASICR2 Wi Fi Smart Switch WI Fi Material Box
Size Weight IEEE 802 11 b g n 2 4GHz PC V0 90x41x27mm SONOFF Product Brochure 2023 Latest
Version sonoff tech 07 |||

Shenzhen Sonoff Technologies Co.,Ltd Address 663 A 3F 6F, Bldg A, No. 663,
Bulong Rd, Dafap ... luded in the product, please purchase them separately.

ACCESSORIES Accessories ACCESSORIES **WTS01** Waterproof Temperature
Sensor Compatible Products TH Origin TH Elite Interface/Connector...

lang:en score:19 filesize: 24.43 M page_count: 67 document date: 2023-07-05



[pdf]

WTS01 V1 0 Nspanel PRO Sonoff Guia sonoff br 2025 03 |||

...

lang:en score:14 filesize: 2.25 M page_count: 1 document date: 2023-06-09

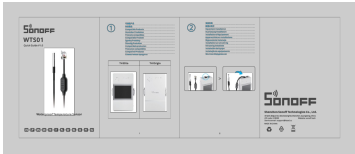

[pdf]

Declaration of Conformity

WTS01 V1 0 Read More DOC SONOFF Official sonoff tech 2023 11 |||

...

lang:en score:14 filesize: 2.25 M page_count: 1 document date: 2023-06-09

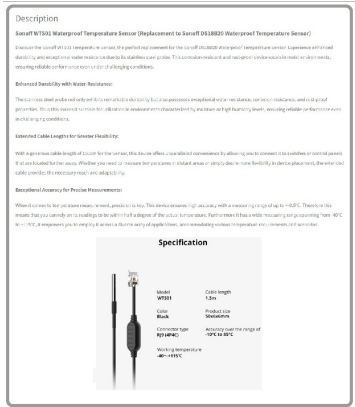

[pdf]

Sonoff WTS01 Waterproof Temperature Sensor Lite Glo Discover the perfect replacement for DS18B20
Experience enhanced durability WATERPROOF TEMPERATURE SENSOR srsltid

AfmBOooUEaObkeUQrnXME173xebwCoWoelt8y14WWdVb5MJqDTsOB3Uu liteglo co za 2023 09 |||

...

lang:en score:11 filesize: 1.61 M page_count: 1 document date: 2024-02-12