

[Manuals.plus](#) /

› [AIERBOZ](#) /

› Smart Fingerprint Door Lock User Manual

AIERBOZ YL-57A-Sliver

Smart Fingerprint Door Lock Instruction Manual

Brand: AIERBOZ
Model: YL-57A-Sliver

PRODUCT OVERVIEW

The AIERBOZ Smart Fingerprint Door Lock (Model YL-57A-Sliver) is an advanced 3-in-1 keyless entry system designed to provide secure and convenient access to your home, office, or apartment. It integrates biometric fingerprint recognition, Bluetooth APP control, and traditional mechanical key access, offering multiple unlocking options to suit your needs. This lock is built with high-quality zinc alloys for durability and features a sleek, modern design.



Figure 1: AIERBOZ Smart Fingerprint Door Lock (Model YL-57A-Silver) with its accompanying mobile application interface.

Key Features

- **3-Way Unlocking:** Offers keyless entry via biometric fingerprint, Bluetooth APP, and traditional mechanical keys for emergency backup.
- **Fast Biometric Recognition:** Recognizes fingerprints in approximately 0.3 seconds, supporting storage for up to 20 unique fingerprints.
- **Easy Installation:** Designed for straightforward installation with minimal tools, suitable for door

thicknesses between 1.26 to 1.89 inches and adjustable backset (2-3/8" or 2-3/4").

- **Smart Functionality:** View all visit records in the app, receive real-time unlock notifications, and get low battery reminders (red LED flash).
- **Convenience Modes:** Includes 'Passage Mode' for temporary unrestricted access and 'Silent Mode' for quiet operation.
- **Durable Construction:** Made from high-quality zinc alloys for enhanced strength and longevity.

MULTIFUNCTION

Because our smart lock has powerful features and long service life, it can protect your safety and that of your family.



- Multiple Users**
- App Control**
- Silent Mode**
- 3S Auto Lock**
- Passage Mode**
- 4°F~ +167°F**
- Easy To Install**

Figure 2: Overview of the smart lock's multifunction capabilities, including support for multiple users, app control,

INSTALLATION GUIDE

Proper installation is crucial for the optimal performance and security of your AIERBOZ Smart Fingerprint Door Lock. Please follow these steps carefully. A screwdriver is the primary tool required for installation.

Your browser does not support the video tag.

Video 1: Detailed installation guide for the YL-57A Smart Fingerprint Door Lock, demonstrating each step from disassembly to final assembly and testing.

Step-by-Step Installation:

1. **Disassemble the Lock:** First, remove the back cover screw from the lock body. Do not force the lock apart. Then, remove the two long screws located in the middle. Slowly separate the two lock bodies.
2. **Adjust Latch (if necessary):** The latch can be adjusted to fit your door's backset (2-3/8" or 2-3/4") by pressing the button on the side and extending or retracting the latch.
3. **Install Latch:** Insert the latch into the door's edge bore hole and secure it with screws. Ensure the latch is oriented correctly for your door's swing.
4. **Connect Power Cord:** Align the power cord from the exterior handle through the keyhole and into the interior side of the door.
5. **Install Exterior Handle:** Position the exterior handle, ensuring the spindle passes through the latch mechanism.
6. **Install Batteries:** Insert 4 AAA batteries into the battery box, observing correct polarity.
7. **Connect Battery Box:** Connect the battery box cable to the corresponding port on the interior lock body.
8. **Assemble Interior Handle:** Carefully align the interior handle with the exterior handle and the latch. Ensure the power cord is not pinched.
9. **Secure Interior Handle:** Fasten the interior handle to the exterior handle using the long screws.
10. **Install Back Cover:** Place the back cover over the interior handle and secure it with the remaining screws.
11. **Test Operation:** Test all unlocking methods (fingerprint, key, app) to ensure proper functionality.

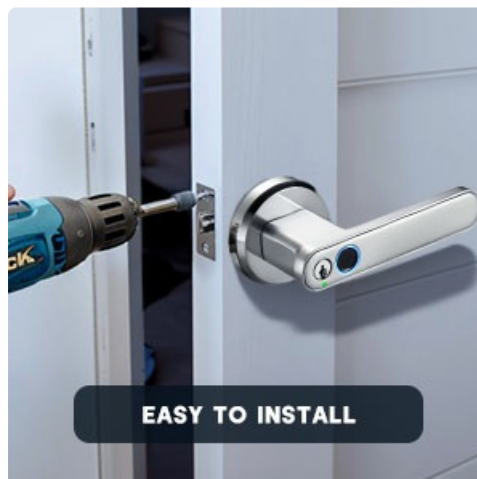

Figure 3: The smart lock is designed for easy installation, requiring only a few simple steps.

OPERATING INSTRUCTIONS

The AIERBOZ Smart Fingerprint Door Lock offers multiple convenient ways to unlock your door.

Unlocking Methods:

- **Fingerprint Unlock:** Place your registered fingerprint on the sensor. The lock will recognize your print and unlock the door within 0.3 seconds.
- **App Unlock (Bluetooth):** Use the dedicated mobile application to unlock the door via Bluetooth. Ensure your device is within range and Bluetooth is enabled.
- **Mechanical Key Unlock:** In case of battery depletion or other emergencies, use the provided mechanical key to unlock the door.

3 UNLOCKING WAYS

Advanced 3-in-1 fingerprint door lock: Biometric Fingerprint, App Control, Emergency Spare Key.

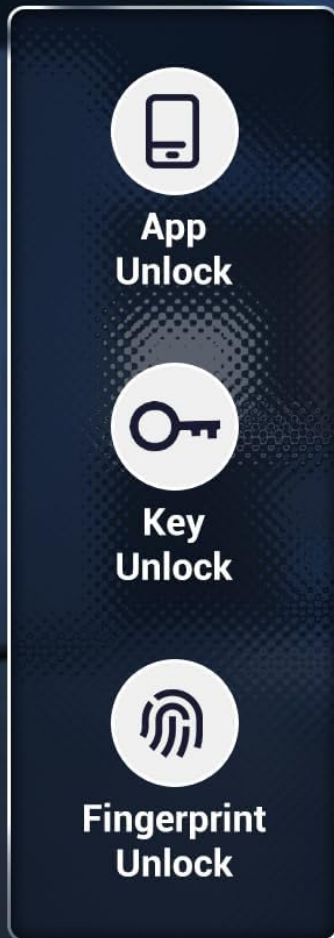

Figure 4: The three primary methods for unlocking the AIERBOZ Smart Fingerprint Door Lock.

Special Modes:

- **Passage Mode:** This mode allows the door to remain unlocked for continuous access without requiring authentication. It is useful for periods of high traffic or when you do not need the door to be secured. When activated, the fingerprint indicator may turn pink.
- **Silent Mode:** Activate Silent Mode via the app to disable audible feedback from the lock. This is

ideal for maintaining quiet environments, such as during sleep or work.

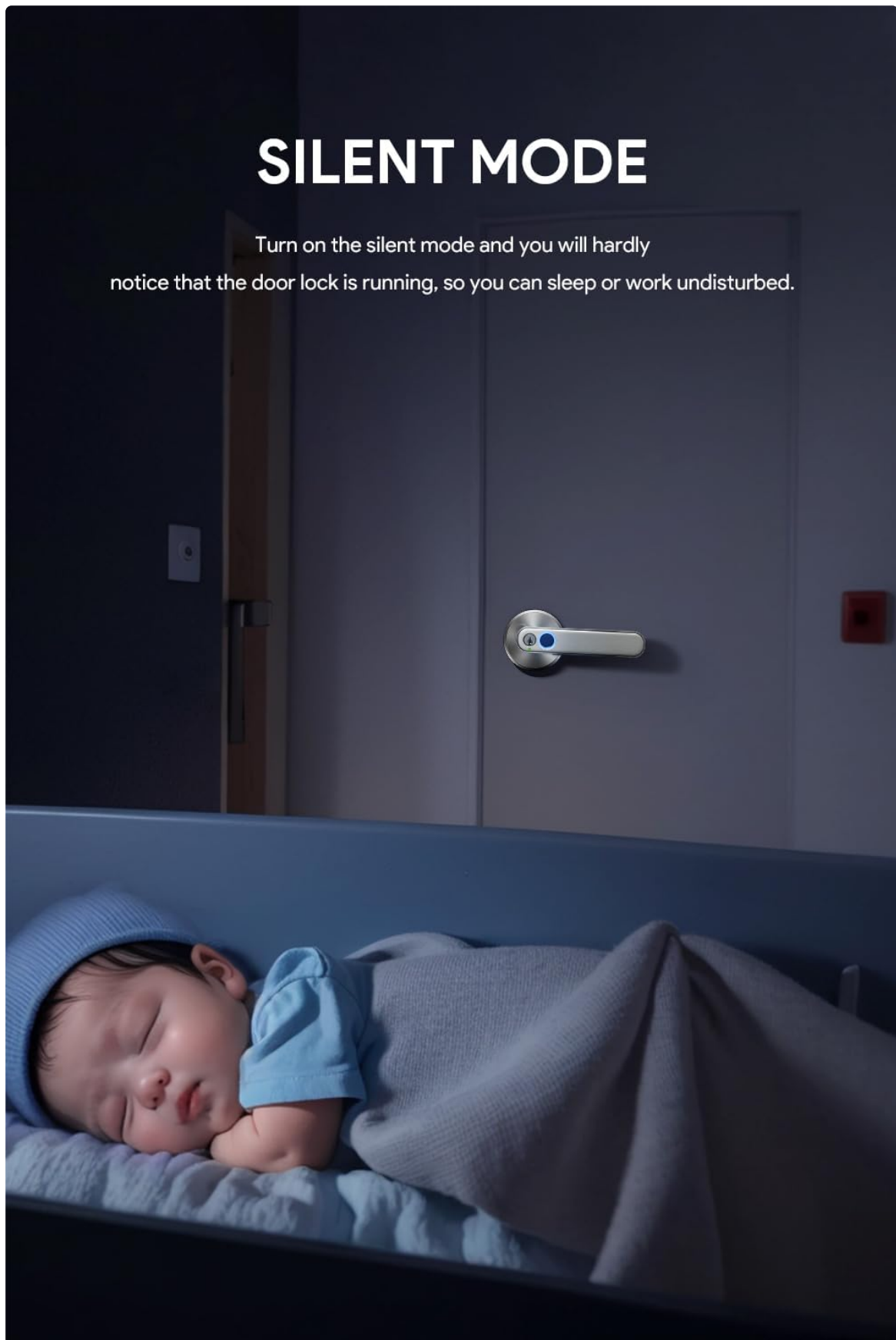

Figure 5: Silent Mode ensures the door lock operates without sound, ideal for undisturbed environments.

PASSAGE MODE

Convenient for children and the elderly to come in and out.

(The fingerprint collector indicator is pink)



Figure 6: Passage Mode provides convenient, temporary unrestricted access, suitable for children and the elderly.

MAINTENANCE

Regular maintenance helps ensure the longevity and reliable operation of your smart door lock.

Battery Replacement:

The lock will provide a low battery reminder by flashing a red LED light when the battery power is low. Replace the 4 AAA batteries promptly to ensure continuous operation. In an emergency, the mechanical key can be used to unlock the door even with depleted batteries.

LOW BATTERY REMINDER

When the red light is on, the battery power is not enough and needs to be replaced in time. And you can open the door with a spare key.



Figure 7: The lock provides a visual low battery reminder, and a mechanical key can be used as a backup.

Cleaning:

Wipe the lock's surface with a soft, damp cloth. Avoid using abrasive cleaners or solvents, as these can damage the finish and electronic components.

TROUBLESHOOTING

If you encounter issues with your smart door lock, refer to the following common problems and solutions:

Problem	Possible Cause	Solution
Lock not responding to fingerprint.	Fingerprint not registered or sensor is dirty.	Ensure your fingerprint is properly registered. Clean the fingerprint sensor with a soft, dry cloth. Try re-registering your fingerprint.
App cannot connect to the lock.	Bluetooth is off, app is outdated, or lock is out of range.	Ensure Bluetooth is enabled on your phone. Update the app to the latest version. Move closer to the lock. Restart the app or your phone.
Lock not responding to any method.	Batteries are dead.	Replace the batteries immediately. Use the mechanical key for emergency access.
Door does not lock automatically.	Auto-lock feature is disabled or Passage Mode is active.	Check app settings to ensure auto-lock is enabled. Deactivate Passage Mode if it is not needed.

PRODUCT SPECIFICATIONS

Specification	Detail
Brand	AIERBOZ
Model Name	Smart Fingerprint Door Lock
Item Model Number	YL-57A-Silver
Lock Type	Biometric
Color	Silver
Material	Zinc
Item Weight	2.88 pounds (1.31 Kilograms)
Product Dimensions	6.69 x 6.1 x 6.1 inches

Specification	Detail
Door Thickness Compatibility	1.26 ~ 1.89 inches
Adjustable Backset	2-3/8" (60mm) or 2-3/4" (70mm)
Power Source	4 x AAA Batteries (not included)
Connectivity Protocol	Bluetooth
Controller Type	Android, Hand Control, Mechanical knob
Recommended Uses	Bedroom, Hotel Room, Office
UPC	780669096155

WARRANTY AND SUPPORT

AIERBOZ stands behind the quality of its products. This Smart Fingerprint Door Lock comes with a standard manufacturer's warranty covering defects in materials and workmanship under normal use. Please refer to the product packaging or the official AIERBOZ website for specific warranty terms and duration.

For technical support, troubleshooting assistance, or warranty claims, please contact AIERBOZ customer service through the following channels:

- **Email:** support@aierboz.com (example)
- **Phone:** 1-800-XXX-XXXX (example)
- **Website:** [Visit the AIERBOZ Store on Amazon](#)

When contacting support, please have your product model number (YL-57A-Sliver) and purchase date ready.