



[Manuals.plus](#) /

› [MOUNT PRO](#) /

› MOUNT PRO Dual Monitor Stand (Model B0CBTP6HYC) Instruction Manual

MOUNT PRO B0CBTP6HYC

MOUNT PRO Dual Monitor Stand Instruction Manual

Model: B0CBTP6HYC

INTRODUCTION

This manual provides detailed instructions for the installation, operation, and maintenance of your MOUNT PRO Dual Monitor Stand. Please read these instructions carefully before assembly and use to ensure proper function and safety. The MOUNT PRO Dual Monitor Stand is designed to securely hold two computer screens ranging from 22 to 42 inches, with a maximum weight capacity of 33 lbs per monitor. It supports VESA mounting patterns of 75x75mm or 100x100mm.

SETUP AND INSTALLATION

The MOUNT PRO Dual Monitor Stand offers two primary installation methods: C-clamp mounting and grommet mounting. Choose the method that best suits your desk type.

1. Check Monitor Compatibility

Ensure your monitors are compatible with the stand's specifications:

- **Screen Size:** 22 to 42 inches
- **Weight Capacity:** Up to 33 lbs per monitor
- **VESA Patterns:** 75x75mm or 100x100mm

For monitors without VESA holes, a VESA adapter (sold separately) may be required.

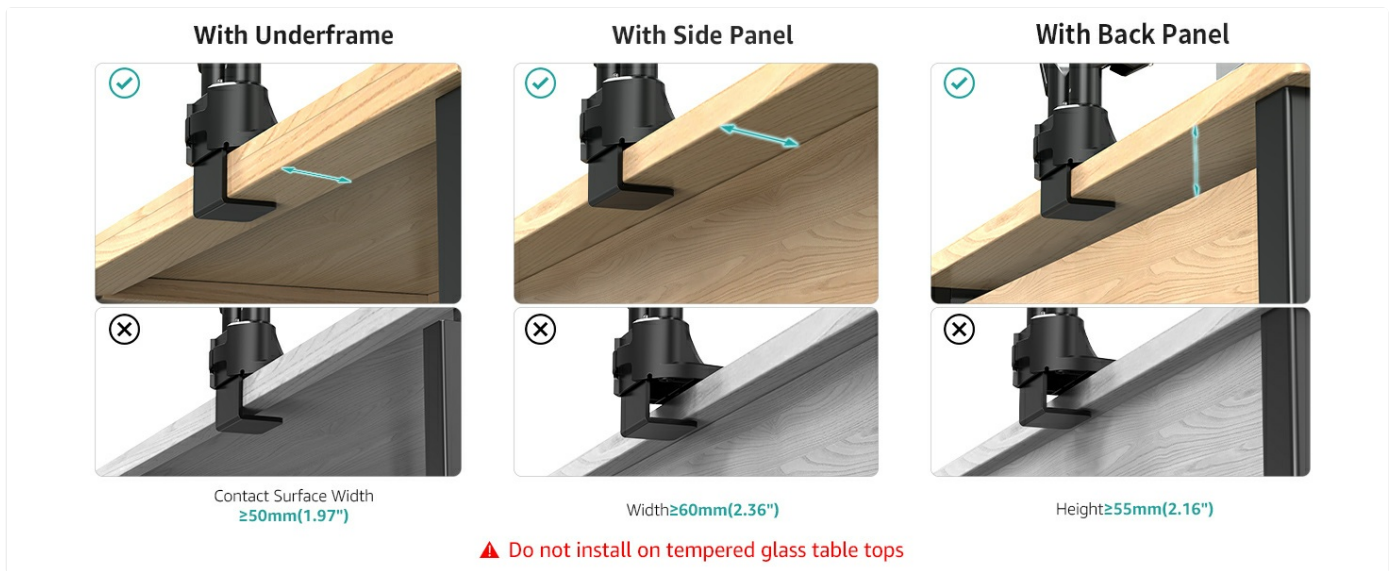

Figure 1: VESA Compatibility Check. This image illustrates how to identify VESA mounting holes on a monitor and suggests removing the original stand if necessary.

2. Choose Mounting Option

The stand supports two mounting types:

- **C-Clamp Mounting:** Suitable for desk thickness from 0.4" to 1.97". This method requires no drilling.
- **Grommet Mounting:** Suitable for desk thickness from 0.4" to 3.15". Requires a desk hole diameter of 0.4" to 2.4".

Important: Do not install on tempered glass table tops.

Two Installation Options

Clamp Mounting

Desk Thickness: 0.4"-1.97"



Grommet Mounting

Desk Thickness: 0.4"-3.15"

Hole Diameter: 0.4"-2.4"

Figure 2: Two Installation Options. This image displays the C-clamp method (top) and the grommet method (bottom) for attaching the monitor stand to a desk, along with their respective desk thickness and hole diameter specifications.



Figure 3: Desk Compatibility for C-Clamp. This diagram shows various desk edge configurations, indicating which are suitable for C-clamp mounting and explicitly warns against using the mount on tempered glass surfaces.

3. Attaching Monitors

The VESA plate is detachable for easy assembly. Attach the VESA plate to the back of your monitor using the provided screws, then slide the monitor onto the arm head until it locks securely.



Figure 4: Effortless Assembly. This image demonstrates the process of attaching a monitor to the stand using the detachable VESA plate, emphasizing the ease of installation.



Figure 5: Easy Monitor Locking. This diagram illustrates how the monitor slides onto the arm head and automatically locks into place, simplifying the attachment process.

OPERATING AND ADJUSTMENTS

The MOUNT PRO Dual Monitor Stand features gas spring arms for flexible and ergonomic adjustments.

1. Flexible Screen Adjustment

Adjust your monitors to achieve optimal viewing angles and ergonomic positions. The arms allow for:

- **Tilt:** +90° to -45°
- **Swivel:** 180°
- **Rotation:** 360° (for landscape or portrait viewing)
- **Max Extension:** Up to 23.58 inches
- **Max Height:** Up to 19.69 inches

Flexible Screen Adjustment



Swivel **180°**



Tilt **+90°/-45°**



Rotation **360°**



Figure 6: Flexible Screen Adjustment. This diagram shows the range of motion for swivel (180°), tilt (+90°/-45°), and rotation (360°), as well as the maximum extension (23.58") and height (19.69") of the monitor arms.

Flexible Adjustment

Swivel
+90°/-90°



Tilt
+90°/-45°

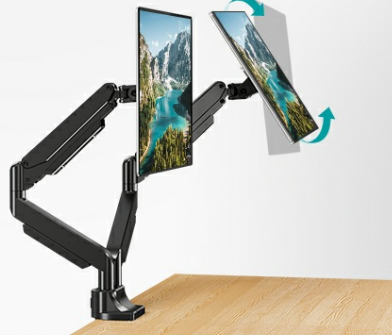

Rotation
360°



Figure 7: Multiple Screen Combinations. This image illustrates different display configurations possible with the dual monitor stand, including side-by-side, stacked, and angled setups.

2. Tilt and Tension Adjustment

To adjust the tilt and gas spring tension:

1. **Tilt Adjustment:** Loosen the tilting bolt (turn in "+" direction), adjust your monitor to the desired tilt angle, then retighten the tilting bolt (turn in "-" direction).
2. **Tension Adjustment:** Keep the arm in a horizontal position during adjustment.
 - If the monitor raises up, turn clockwise ("-") direction) to reduce tension for lighter monitors.
 - If the monitor falls down, turn counter-clockwise ("+" direction) to increase tension for heavier monitors.

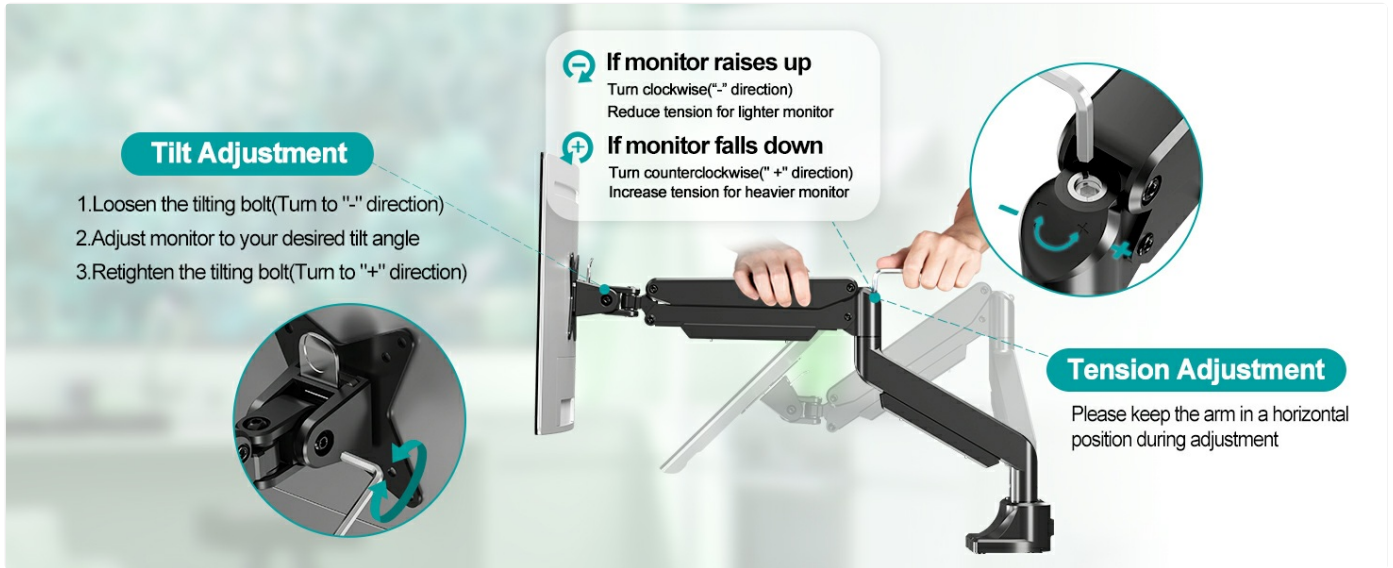

Figure 8: Tilt and Tension Adjustment. This diagram illustrates the steps for adjusting the monitor's tilt and the gas spring tension to accommodate different monitor weights and desired positions.

MAINTENANCE

Regular maintenance helps ensure the longevity and optimal performance of your monitor stand.

1. Cable Management

Utilize the integrated cable management system to keep your workspace tidy and prevent cable damage. Route cables along the arms and through the designated channels.

Cable Management

Hidden cable design for a clean and tidy look

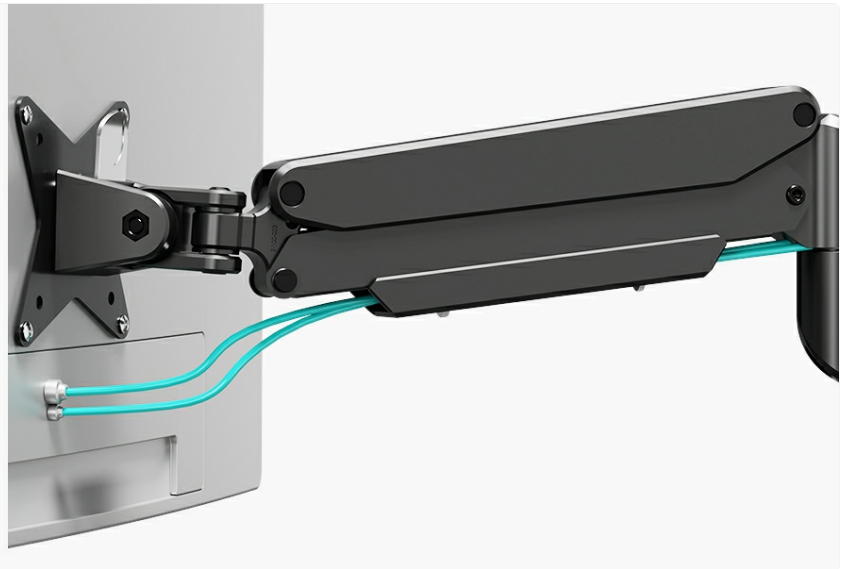

Figure 9: Cable Management. This image highlights the hidden cable design, demonstrating how cables can be routed through the monitor arm for a clean and organized desktop.

2. Cleaning

Wipe the stand with a soft, damp cloth. Avoid using abrasive cleaners or solvents that could damage the finish.

TROUBLESHOOTING

This section addresses common issues you might encounter with your monitor stand.

- **Monitor Sags or Does Not Stay in Position:** This indicates that the gas spring tension needs adjustment. Refer to the "Tension Adjustment" instructions in the Operating section. Ensure the arm is held horizontally during adjustment.
- **Monitor is Difficult to Move:** The gas spring tension might be too high. Refer to the "Tension Adjustment" instructions to reduce tension.
- **Monitor Does Not Tilt:** Ensure the tilting bolt is sufficiently loosened before attempting to adjust the tilt. Retighten after achieving the desired angle.
- **Stand is Unstable:** Verify that the C-clamp or grommet mount is securely tightened to the desk. Check desk compatibility to ensure it meets the thickness and material requirements.
- **Cables are Disorganized:** Utilize the integrated cable management channels along the arms to route and secure your cables.

SPECIFICATIONS

Feature	Detail
Brand	MOUNT PRO
Model	B0CBTP6HYC
Monitor Size Compatibility	22" to 42" (Ultrawide)
Weight Capacity	6.6 lbs to 33 lbs per monitor

Feature	Detail
VESA Compatibility	75x75mm, 100x100mm
Mounting Type	Tabletop Mount (C-Clamp or Grommet)
Movement Type	Rotate, Swivel, Tilt, Articulating
Tilt Range	+90° to -45°
Swivel Range	180°
Rotation Range	360°
Max Extension	23.58 inches
Max Height	19.69 inches
Material	Metal (Aluminum)
Color	Black
Item Weight	14.52 pounds



Figure 10: Product Overview with Specifications. This image shows the MOUNT PRO Dual Monitor Stand in use, highlighting its compatibility with 22"-42" monitors, 6.6-33 lbs weight capacity, and 75x75mm/100x100mm VESA patterns.

Design For Heavier Monitors



Max 33lbs



75 x 75mm
100 x 100mm



Max 42"



Figure 11: Design for Heavier Monitors. This image illustrates the stand's capability to support two large monitors, up to 42 inches and 33 lbs each, with VESA compatibility of 75x75mm or 100x100mm.

Multiple Screen Combinations

Different screen displays for flexible viewing



Figure 12: Screen to Wall Distance Guide. This diagram provides a table of recommended distances from the screen to the wall for different monitor sizes (15" to 42") to ensure proper clearance and movement.

WARRANTY INFORMATION

Specific warranty details are not provided in the product information. Please refer to the product packaging or contact MOUNT PRO customer support for warranty terms and conditions.

CUSTOMER SUPPORT

For technical assistance, missing parts, or any inquiries regarding your MOUNT PRO Dual Monitor Stand, please contact MOUNT PRO customer support through their official website or the retailer where the product was purchased.

PRODUCT VIDEOS

Extra Wide Monitor Stand Overview

Your browser does not support the video tag.

This video provides a demonstration of the MOUNT PRO Dual Monitor Stand, showcasing its ability to hold an extra-wide monitor and highlighting its adjustable features and cable management capabilities. The video illustrates the stability and flexibility of the stand for large displays.

