



Manuals.plus /

› Yitouniu /

› EWeLink Wireless Remote TH16 Switch WiFi Smart 16A Temperature Controller Sensor Module User Manual

Yitouniu Yitouniu-EWTH16

EWeLink Wireless Remote TH16 Switch User Manual

Model: Yitouniu-EWTH16

1. PRODUCT OVERVIEW

The Yitouniu EWeLink TH16 Smart Switch is a versatile device designed to integrate into your smart home system, enabling remote and automatic control of appliances. It features temperature monitoring capabilities, allowing connected devices to be turned on or off based on a preset temperature range. This module works in conjunction with the included waterproof DS18B20 temperature sensor to enhance your home's automation.

Key functionalities include real-time temperature monitoring, remote ON/OFF control, timing tasks, automatic mode based on temperature, manual control, smart scene triggering, and voice control compatibility with Amazon Alexa and Google Home.



Figure 1.1: EWeLink TH16 Smart Switch with connected DS18B20 temperature sensor.

2. WHAT'S IN THE BOX

- 1 x TH-16 Smart Switch (Relay housing, relay module)
- 1 x DS18B20 Sensor (Temperature probe)

Note: The sensor can only detect temperature. For humidity detection, a separate humidity sensor is required.

3. PRODUCT FEATURES

- **Wide Application:** Suitable for various uses including home brewing, fermentation, breeding, incubation, greenhouse temperature control, and more. Supports 85-250V, 16A MAX 3500W.
- **App Support:** Free eWeLink mobile application available for iOS and Android devices.
- **Sync Status:** Provides real-time device status and temperature monitoring directly to the eWeLink app. Temperature units (Celsius/Fahrenheit) are switchable.
- **Remote ON/OFF:** Control electrical devices from any location using the app, with high accuracy temperature readings from the waterproof DS18B20 sensor.
- **Voice Control:** Compatible with Amazon Alexa, Google Home, and Google Nest for convenient voice commands.
- **Timing Functions:** Supports up to 8 enabled countdown, single, or repeat timing tasks to automate device operation at specified times.
- **Auto Mode:** Configure the device to automatically turn on or off when the temperature falls within a specified range.
- **Manual Mode:** Allows for immediate manual control (ON/OFF) of the connected device.
- **Smart Scene Trigger:** Temperature values can be used as conditions to trigger other eWeLink smart devices.
- **Share Control:** Easily share control of your smart home devices with family members.
- **Energy Consumption Monitoring:** Monitor real-time energy consumption.



Figure 3.1: The Smart Switch integrates with the eWeLink app and is compatible with Amazon Alexa, Google Home, and Google Nest.



Figure 3.2: Examples of common usage scenarios for the TH16 Smart Switch.

4. SPECIFICATIONS

4.1. TH-16 Smart Switch

Attribute	Value
Model Number	Yitouniu-EWTH16
Input Voltage	AC85-250V
Max Current	16A
Max Power	3500W
Wireless Standard	WiFi 2.4GHz b/g/n
Product Dimensions	2.79"L x 1.65"W (7.09 x 4.19 cm)
Material	Plastic
Color	White

4.2. DS18B20 Sensor

Attribute	Value
Type	Waterproof temperature sensor
Probe	Stainless steel temperature probe
Temperature Measuring Range	-20°C ~ +100°C
Operating Voltage	3.0-5.5V
Length	1m
Weight	26g



Figure 4.1: Detailed view of the waterproof DS18B20 temperature sensor.

5. SETUP AND INSTALLATION

5.1. Wiring the Smart Switch

Before proceeding, ensure the main power supply to the circuit is turned OFF at the breaker to prevent electrical shock. The TH-16 Smart Switch requires a live (L) and neutral (N) input, and provides a switched live (L) and neutral (N) output to your appliance.

1. Identify the Live (L) and Neutral (N) wires from your power source.
2. Connect the Live wire from the power source to the "IN L" terminal on the switch.
3. Connect the Neutral wire from the power source to the "IN N" terminal on the switch.
4. Connect the Live wire of your appliance to the "OUT L" terminal on the switch.
5. Connect the Neutral wire of your appliance to the "OUT N" terminal on the switch.
6. Plug the DS18B20 temperature sensor into the designated port on the smart switch.

7. Secure all wire connections firmly.

Warning: Incorrect wiring can cause damage to the device or electrical hazards. If you are unsure, consult a qualified electrician.

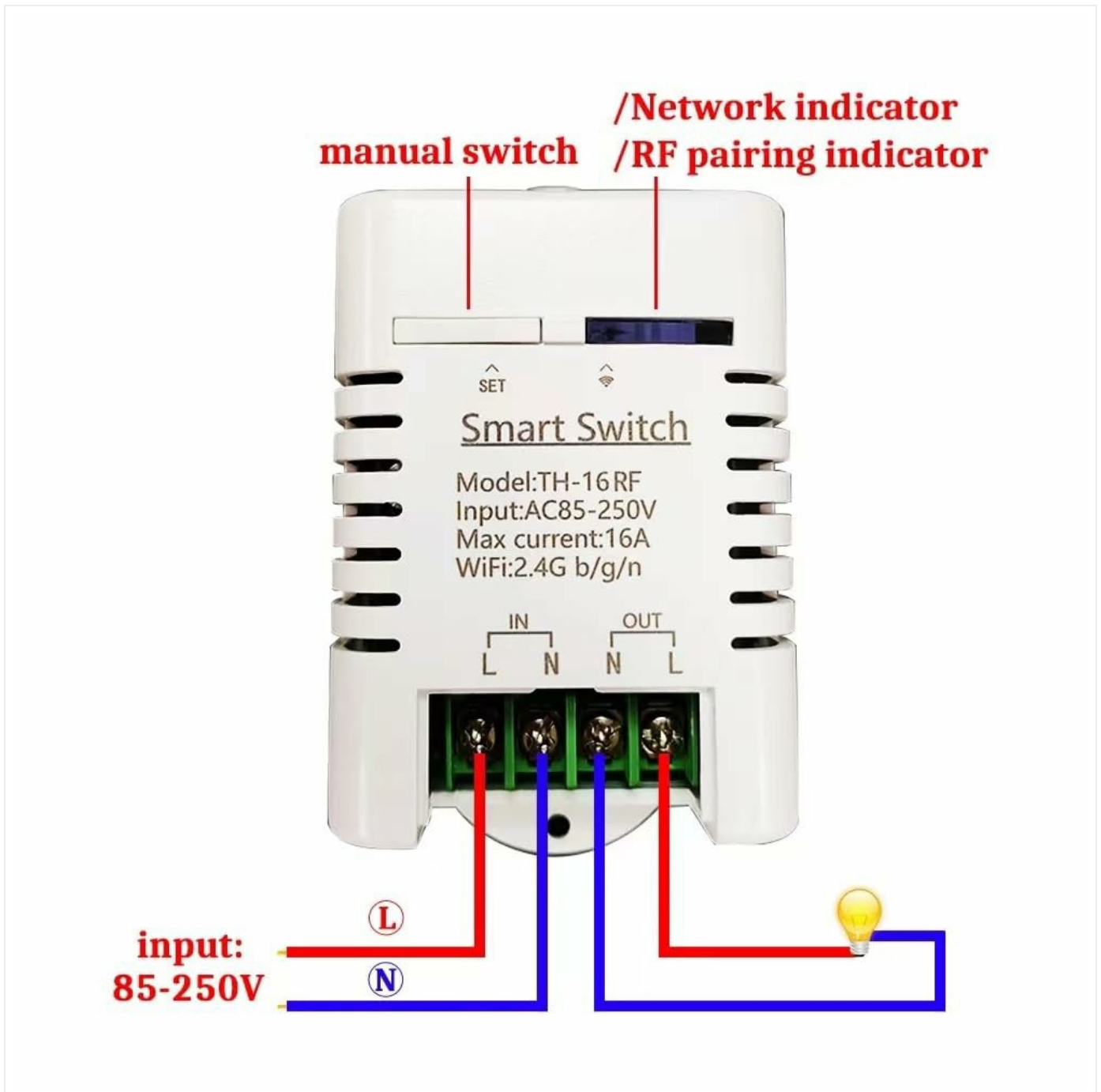

Figure 5.1: Wiring diagram for the TH-16 Smart Switch. Ensure correct Live (L) and Neutral (N) connections for both input and output.

5.2. App Pairing (eWeLink)

The smart switch operates on a 2.4GHz WiFi network. Ensure your mobile device is connected to a 2.4GHz WiFi network during the pairing process.

1. Download the "eWeLink" app from the App Store (iOS) or Google Play Store (Android).
2. Register an eWeLink account and log in.
3. Power on the TH-16 Smart Switch. The network indicator LED should be blinking rapidly (if not, press and hold the "SET" button for 5 seconds until it blinks rapidly to enter pairing mode).
4. Open the eWeLink app, tap the "+" icon at the bottom center, and select "Quick Pairing Mode".
5. Follow the on-screen instructions to connect the device to your WiFi network.
6. Once successfully paired, the device will appear in your eWeLink app, and the network indicator LED will become

solid.

6. OPERATING INSTRUCTIONS

6.1. Remote Control and Status Monitoring

After successful pairing, you can remotely turn the connected appliance ON or OFF from anywhere using the eWeLink app, provided your phone has network access. The app also displays the real-time status of the switch and the current temperature from the DS18B20 sensor.

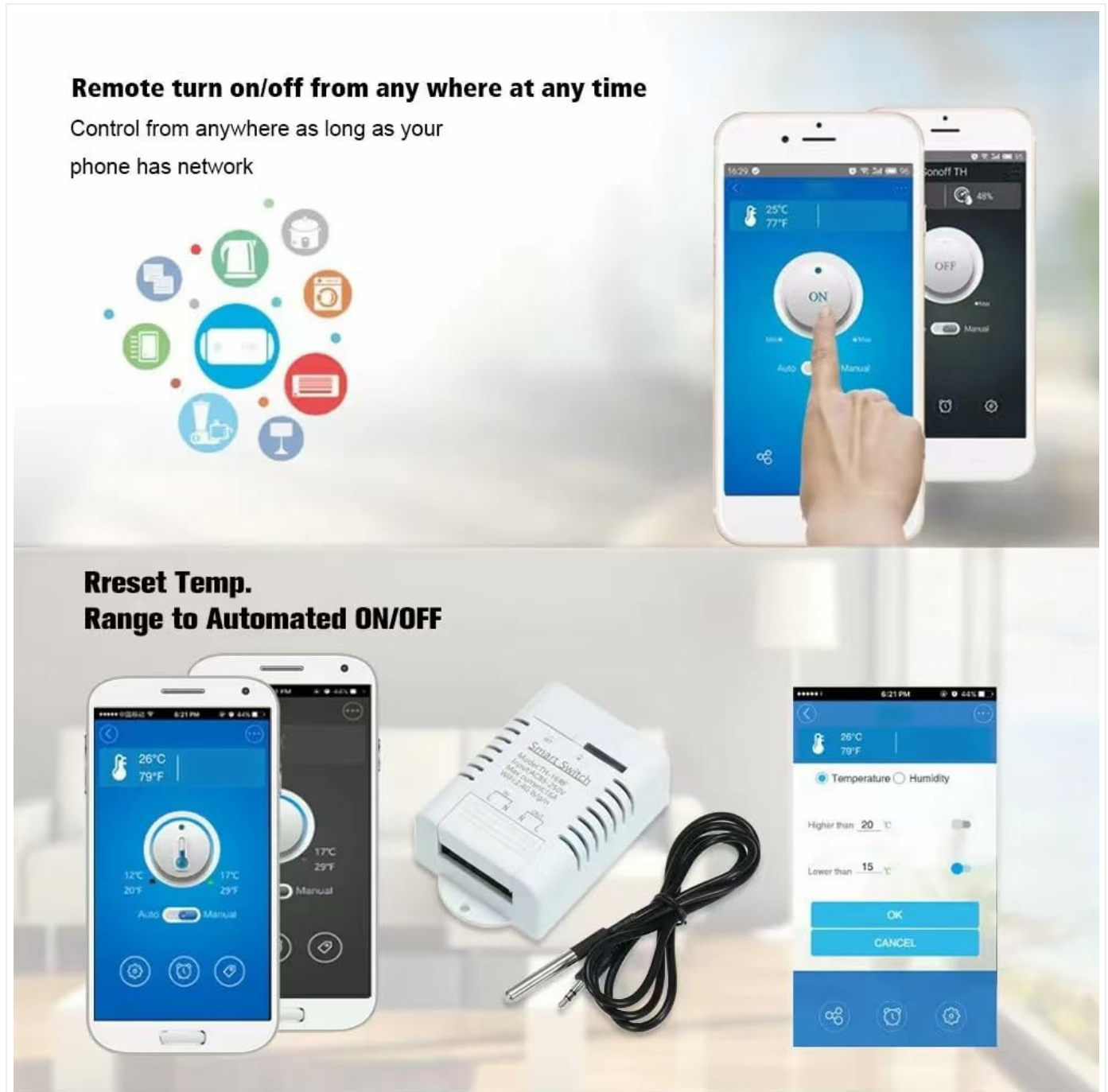

Figure 6.1: Remote control and temperature range setting via the eWeLink app.

6.2. Auto Mode (Temperature Control)

Set the switch to automatically turn ON or OFF based on a specified temperature range:

1. In the eWeLink app, select your TH-16 device.
2. Navigate to the "Auto Mode" settings.

3. Set the desired temperature range (e.g., turn ON when temperature is below X°C, turn OFF when temperature is above Y°C).
4. Confirm your settings. The device will now operate autonomously based on the temperature readings.

6.3. Manual Mode

For immediate control, you can switch to "Manual Mode" in the eWeLink app or use the physical button on the device to toggle the power ON/OFF.

6.4. Timing Functions

Schedule your devices to turn ON/OFF at specific times:

1. In the eWeLink app, select your TH-16 device.
2. Go to the "Timing" section.
3. You can set:
 - **Countdown Timers:** Turn ON/OFF after a set duration.
 - **Single Timers:** Turn ON/OFF at a specific time on a specific date.
 - **Repeat Timers:** Turn ON/OFF at specific times on selected days of the week.
4. Save your timing tasks.

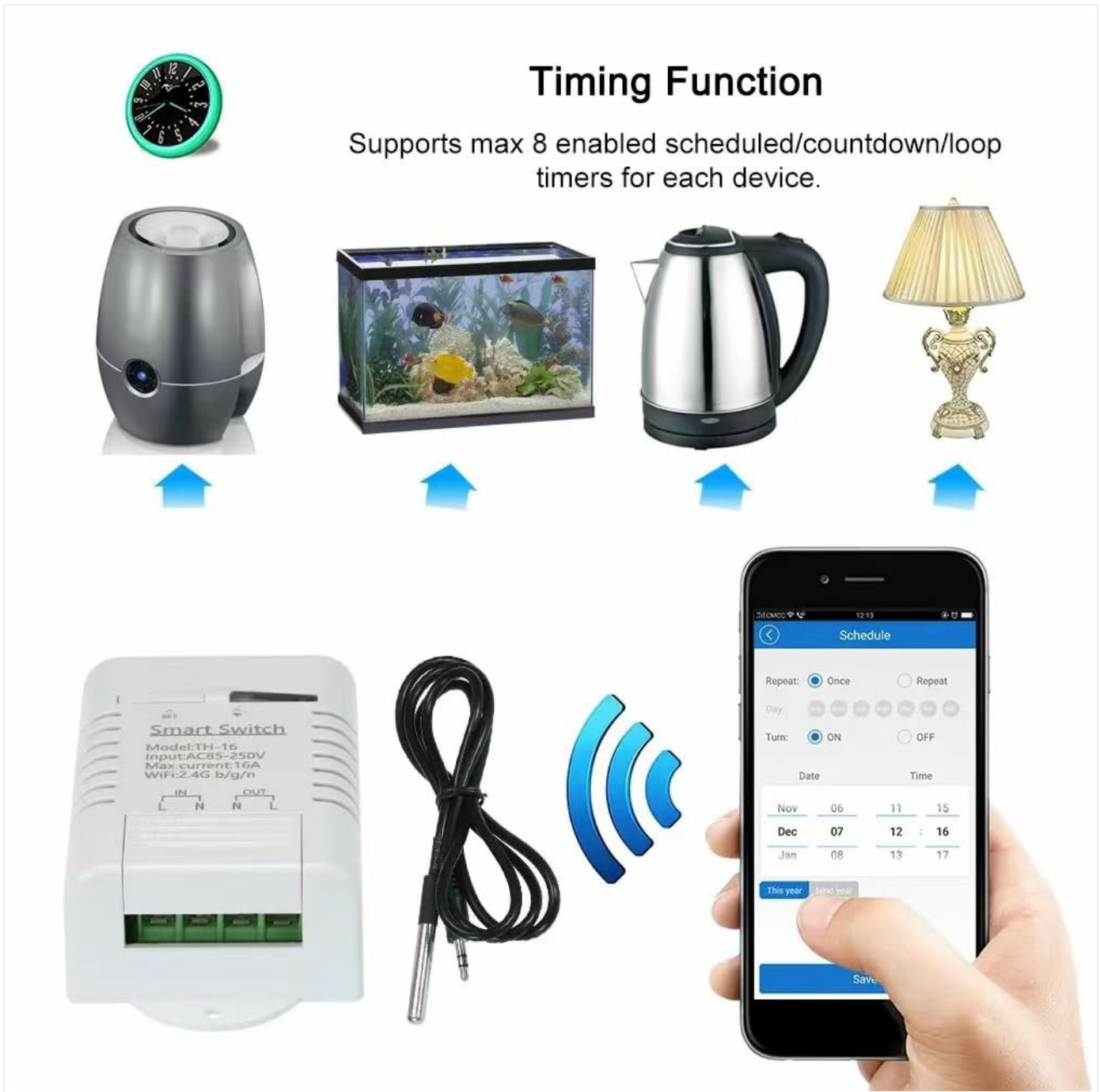

Figure 6.2: Setting up timing schedules within the eWeLink app.

6.5. Voice Control Integration

To use voice commands with Amazon Alexa or Google Home:

1. Ensure your TH-16 Smart Switch is successfully paired with the eWeLink app.
2. Open the Amazon Alexa app or Google Home app.
3. Enable the "eWeLink Smart Home" skill/service.
4. Link your eWeLink account.
5. Discover devices. Your TH-16 switch should now be controllable via voice commands (e.g., "Alexa, turn on the switch," "Hey Google, turn off the switch").

Voice Control

Compatible with "Amazon" Alexa, for Google Home, for Google Nest.



Figure 6.3: Voice control compatibility with Amazon Alexa and Google Home.

6.6. Share Control

You can share control of your TH-16 Smart Switch with family members or other users:

1. In the eWeLink app, select the device you wish to share.
2. Tap on the "Share" icon or navigate to the sharing settings.
3. Enter the eWeLink account email or phone number of the person you want to share with.
4. Set the permissions (e.g., control, view status, set timers).
5. The invited user will receive a notification and can accept the shared control.

Share control

You can share your equipment with your family, add some permissions, and let your family be free to control the Switch.

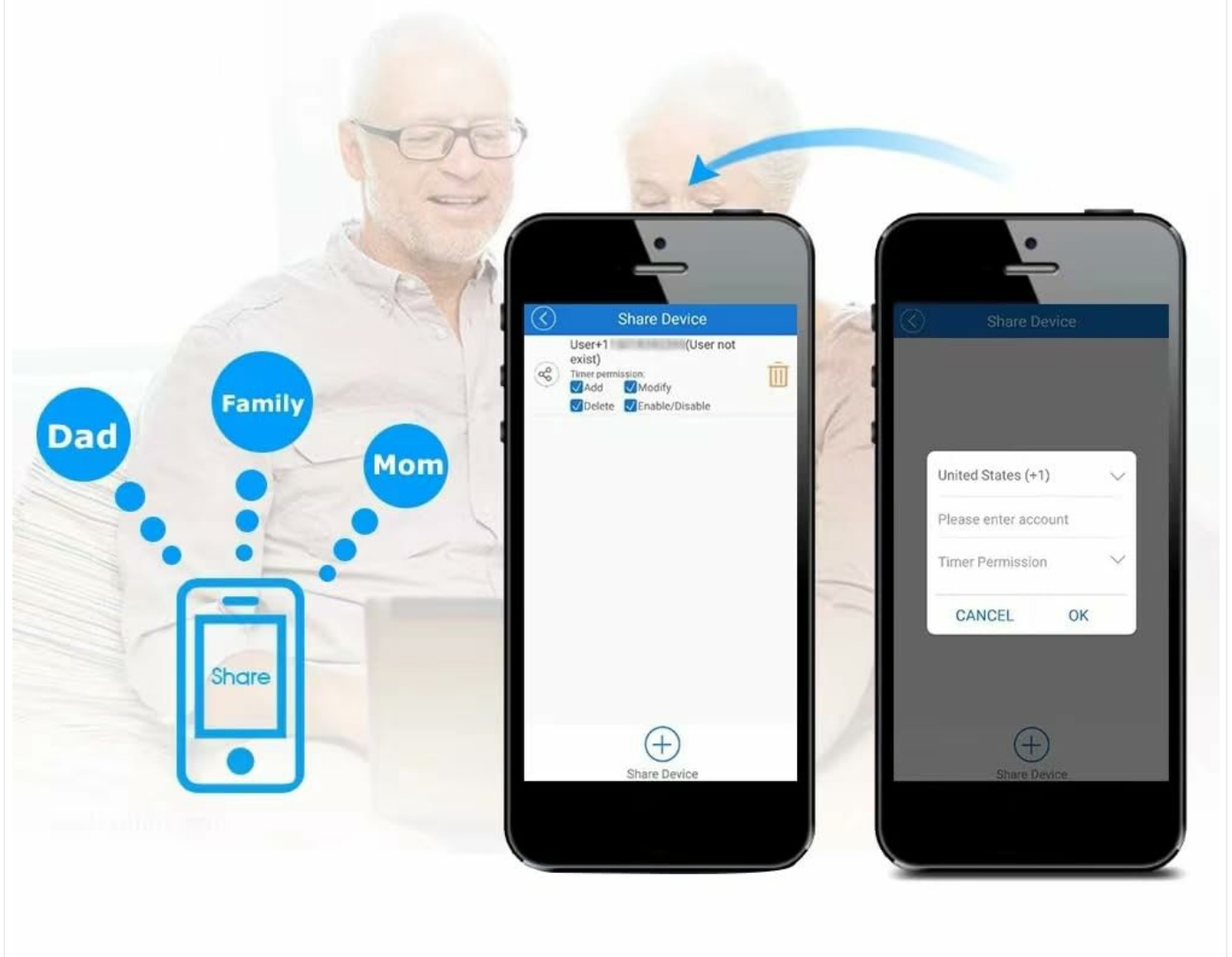

Figure 6.4: Sharing device control with other eWeLink users.

7. MAINTENANCE

- **Cleaning:** Wipe the device with a soft, dry cloth. Do not use abrasive cleaners or immerse the device in water.
- **Firmware Updates:** Regularly check the eWeLink app for available firmware updates to ensure optimal performance and security.
- **Sensor Care:** While the DS18B20 sensor is waterproof, avoid unnecessary exposure to harsh chemicals or extreme physical stress.
- **Network Stability:** Ensure your 2.4GHz WiFi network is stable and has good signal strength where the device is installed for reliable operation.

8. TROUBLESHOOTING

- **Device Offline in App:**

- Check if the device is powered on.
- Verify your WiFi router is working and the 2.4GHz network is active.
- Ensure the device is within range of your WiFi router.
- Try restarting the device and your router.
- If the issue persists, try re-pairing the device with the eWeLink app.

- **Cannot Pair Device:**

- Ensure your phone is connected to a 2.4GHz WiFi network (5GHz networks are not supported).
- Make sure the device is in pairing mode (network indicator blinking rapidly).
- Check your WiFi password for accuracy.
- Move the device closer to the router during pairing.

- **Voice Control Not Working:**

- Confirm the eWeLink skill/service is enabled and linked in your Alexa/Google Home app.
- Ensure your voice assistant device is online and connected to the same network.
- Try re-discovering devices in the Alexa/Google Home app.

- **Inaccurate Temperature Readings:**

- Ensure the DS18B20 sensor is securely plugged into the switch.
- Check for any physical damage to the sensor cable or probe.
- Verify the sensor is placed in an appropriate location, away from direct heat sources or drafts that could skew readings.

9. WARRANTY AND SUPPORT

This product comes with a standard manufacturer's warranty. For specific warranty terms and conditions, please refer to the documentation provided at the time of purchase or contact the seller directly. For technical support, troubleshooting assistance, or inquiries regarding product functionality, please reach out to the manufacturer or your point of purchase.

Manufacturer: Yitouniu

Date First Available: July 13, 2023

