

Manuals+

[Q & A](#) | [Deep Search](#) | [Upload](#)

Manuals.plus /

› **Halitaa /**

› Halitaa Shoe Cabinet with 2 Flip Drawers & Open Storage - Instruction Manual

Halitaa Halitaa

Halitaa Shoe Cabinet with 2 Flip Drawers & Open Storage - Instruction Manual

Model: Halitaa (Grey, 2-Drawers)

1. INTRODUCTION

Thank you for choosing the Halitaa Shoe Cabinet. This manual provides detailed instructions for the assembly, operation, and maintenance of your new shoe cabinet. Please read these instructions carefully before beginning assembly and retain this manual for future reference.



Image 1.1: Fully assembled Halitaa Grey Shoe Cabinet in an entryway setting.

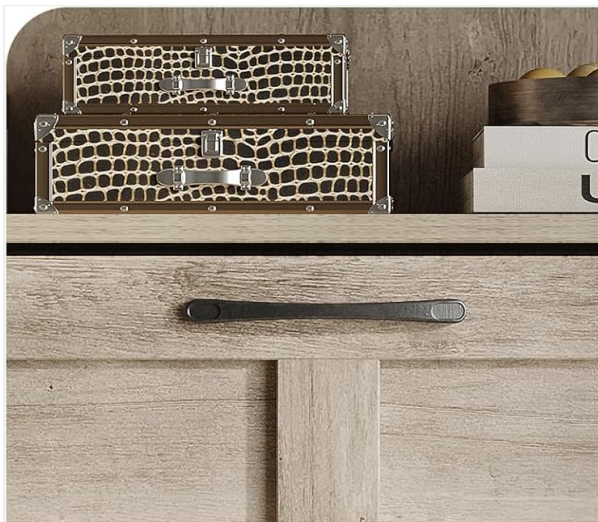

Metals Handle



Rustic Decor



Farmhouse Design



Stable Legs

Image 1.2: Detailed view of the cabinet's features, including metal handles, rustic decorative elements, farmhouse-style door design, and stable legs.

2. SAFETY INFORMATION

- Always assemble the product on a soft, clean surface to prevent scratches.
- Ensure all parts are securely fastened before use.
- **Anti-Tipping Kit:** This cabinet includes an anti-tipping kit to prevent accidental tipping. It is crucial to install this kit as instructed to ensure stability and safety, especially in households with children or pets.
- Do not overload the cabinet shelves or drawers.
- Keep small parts and packaging materials away from children.

Prevent Tip-over Incidents Ensuring your family's Safety

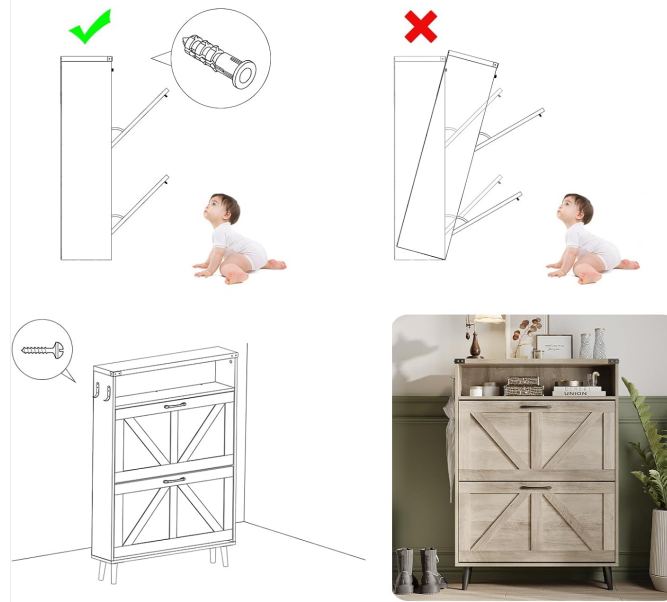

Image 2.1: Illustration of the anti-tipping mechanism installation. The diagram shows how to secure the cabinet to the wall using the provided hardware to prevent it from falling forward.

3. PACKAGE CONTENTS

Before assembly, verify that all components are present and undamaged. Refer to the included parts list in your packaging. If any parts are missing or damaged, please contact customer support.

Included Components: ONE SHOE CABINET (all necessary hardware and clear installation instructions are included).

4. ASSEMBLY INSTRUCTIONS

Assembly is required for this product. All parts are labeled, and detailed instructions are provided in the packaging. Follow the step-by-step guide carefully.

1. Unpack all components and lay them out on a clean, soft surface.
2. Identify each part using the provided labels and the parts list.
3. Follow the graphical instructions for connecting panels and installing hardware.
4. Ensure all screws and fasteners are tightened securely, but do not overtighten.
5. Install the anti-tipping kit as described in the safety section and the assembly guide.



Image 4.1: Detailed dimensions of the shoe cabinet, including overall height, width, depth, and internal drawer measurements.

5. OPERATING INSTRUCTIONS

5.1 Flip Drawers

The cabinet features two flip-down drawers, each containing two tiers of storage. To open, gently pull the metal handle. The drawers will tilt forward, providing access to your shoes.



Image 5.1: A view of the shoe cabinet with its flip drawers open, showcasing the internal storage capacity for shoes.

5.2 Adjustable and Removable Shelves

Each flip drawer includes a removable divider. This divider can be adjusted to two different positions or removed entirely to accommodate various shoe sizes and styles, such as boots or high heels.



Image 5.2: An illustration demonstrating how the internal shelf can be adjusted to two positions or removed to fit different shoe types.

5.3 Open Storage Space

The top surface and the open cubby above the flip drawers provide additional storage for accessories, keys, wallets, or decorative items.



Image 5.3: The open top shelf and surface of the cabinet, used for displaying decor or storing small items.

5.4 Side Hook Design

The cabinet includes a side hook for hanging items such as umbrellas or small bags, enhancing its functionality in an entryway.



Image 5.4: A detailed view of the side hook, demonstrating its use for hanging an umbrella.

6. MAINTENANCE

- **Cleaning:** Wipe the cabinet surfaces with a soft, damp cloth. Avoid harsh chemicals or abrasive

cleaners that may damage the finish.

- **Dusting:** Regularly dust the cabinet to maintain its appearance.
- **Hardware Check:** Periodically check all screws and fasteners to ensure they remain tight. Retighten if necessary.
- **Avoid Moisture:** Protect the cabinet from excessive moisture and direct sunlight to prevent warping or fading.

7. TROUBLESHOOTING

Problem	Possible Cause	Solution
Cabinet feels unstable or wobbly.	Screws are loose; anti-tipping kit not installed or improperly installed.	Ensure all assembly screws are tightened. Install the anti-tipping kit securely to a wall stud or appropriate anchor.
Drawers do not flip smoothly.	Obstruction in the drawer mechanism; uneven assembly.	Check for any items blocking the drawer's movement. Verify that the drawer components were assembled correctly and are level.
Shoes do not fit in the drawers.	Internal divider position is incorrect for shoe size.	Adjust or remove the internal divider within the flip drawer to accommodate larger shoes.

8. SPECIFICATIONS

Brand: Halitaa

Model Name: Halitaa

Color: Grey

Product Dimensions: 9.37"D x 31.5"W x 44.65"H

Item Weight: 51.8 Pounds

Material: Engineered Wood (Frame, Top, Back)

Handle Material: Metal

Mounting Type: Freestanding

Special Features: 2 Flip Drawers, Open Storage, Adjustable/Removable Shelves, Side Hook

Number of Shelves: 2 (internal to drawers) + 1 open top shelf

Assembly Required: Yes

9. WARRANTY AND SUPPORT

For any product problems, please contact Halitaa customer support. All inquiries will be addressed within 24 hours. Please refer to your purchase documentation for specific warranty details.

Contact: Refer to your purchase platform or the Halitaa official website for customer service contact information.

