



Manuals.plus /

› [Sortfle](#) /

› [Sortfle Roller Shade Motor RF Hub User Manual](#)

Sortfle AC520-02

Sortfle Roller Shade Motor RF Hub User Manual

Model: AC520-02

Brand: Sortfle

1. PRODUCT OVERVIEW

The Sortfle AC520-02 RF Hub is designed to integrate 433MHz electric roller shades with smart home ecosystems such as Amazon Alexa, Google Home, and SmartThings. This device acts as a bridge, enabling remote control, scheduled operations, and voice commands for your existing 433MHz curtain motors via a Wi-Fi connection. It supports long transmission distances and wall penetration control, allowing a single hub to manage multiple electric roller shades.



Figure 1: Sortfle AC520-02 RF Hub and accessories.

2. PACKAGE CONTENTS

Upon opening the product package, please verify that all the following items are included:

- 1 x Sortfle AC520-02 RF Hub
- 1 x User Manual
- 1 x USB Cable (for power, USB adapter not included)

If any items are missing or damaged, please contact customer support.

3. SETUP GUIDE

Follow these steps to set up your Sortfle RF Hub and connect it to your roller blinds.

3.1. App Download and Hub Preparation

1. **Download the Smart Life App:** Scan the QR code provided in the user manual or on the product packaging, or visit smartapp.tuya.com/smartlife to download the "Smart Life" application.

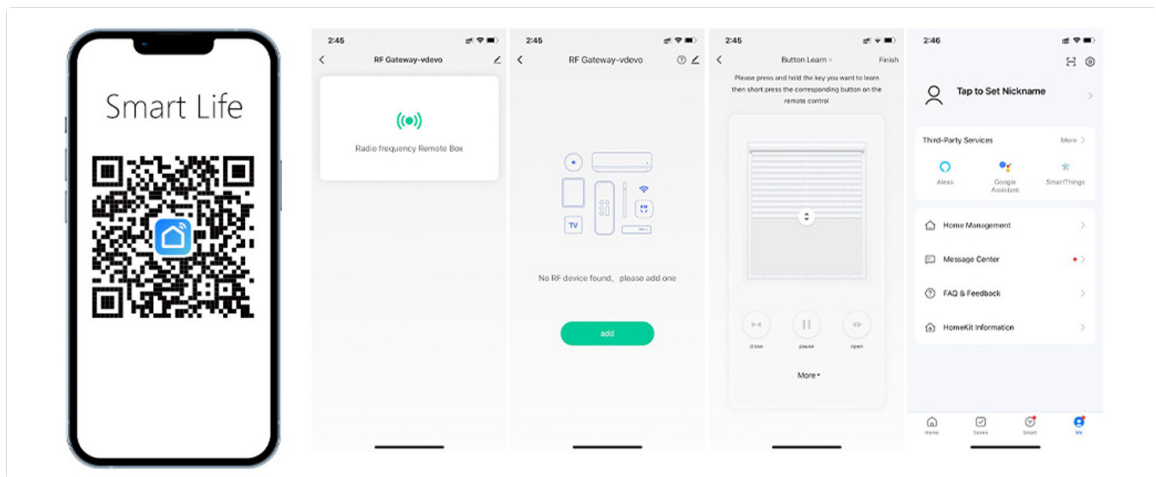

Figure 2: Smart Life App download via QR code and app interface examples.

2. **Connect and Reset the Hub:** Connect the provided USB cable to the RF Hub and a 5V USB power source (adapter not included). Press and hold the "Reset" button on the hub for 5 seconds to put it into pairing mode.

3.2. Adding the Hub to the Smart Life App

3. **Open Smart Life App:** Launch the Smart Life app on your smartphone.
4. **Add Device:** Click on "Add Device" within the app. The app will search for nearby devices.
5. **Enter Wi-Fi Information:** Follow the on-screen prompts to enter your Wi-Fi network's SSID and password. **Important: Ensure you are using a 2.4 GHz Wi-Fi network, as 5 GHz Wi-Fi is not supported.**
6. **Device Added:** Once the Wi-Fi information is entered correctly, the RF Hub will be successfully added to your Smart Life account.

3.3. Adding Roller Blinds to the Hub

7. **Prepare Roller Blind for Pairing:** Press the programming button on the roller blind motor head for one second. The roller blind will rotate once, indicating it is in pairing mode.
8. **Initiate Pairing in App:** In the Smart Life app, open the RF Hub interface. Click on "Radio frequency Remote Box," then click "Add." Next, select "Roller Blind."
9. **Confirm Pairing:** The hub will transmit pairing signals. The roller blind will rotate once in response, indicating a successful pairing.

For a visual guide on the setup process, please refer to the video below:

Your browser does not support the video tag.

Video 1: AC520-02 WiFi to 433 Remote Control Setup Guide.

4. OPERATING INSTRUCTIONS

4.1. App Control

Once your roller blinds are successfully paired with the RF Hub, you can control them directly from the Smart Life app. The app allows you to:

- Open and Close the blinds.
- Pause the blinds at any desired position.
- Set upper and lower limits for blind movement.
- Create schedules for automatic opening and closing at specific times.

APP Control
anytime anywhere

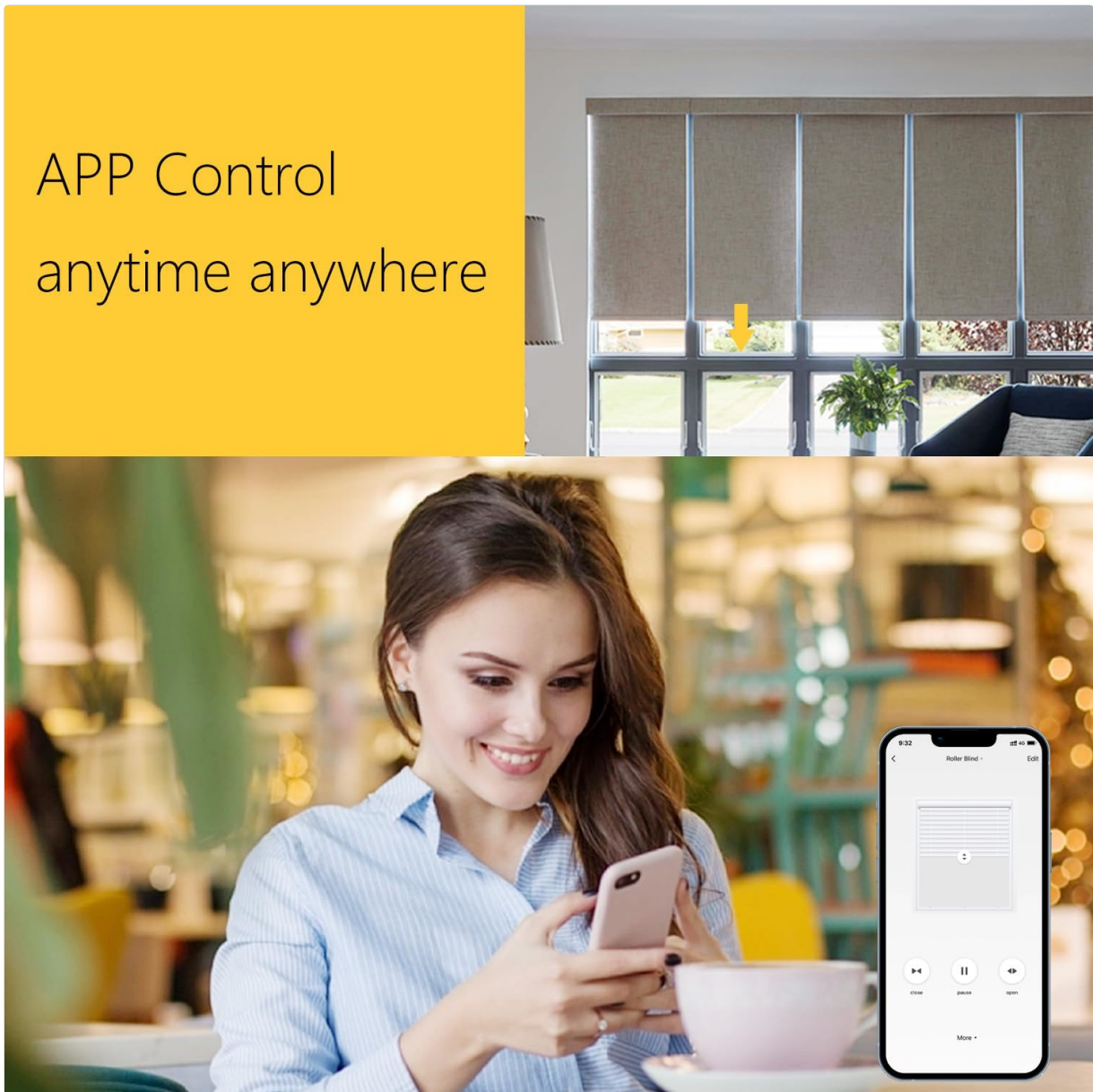

Figure 3: APP Control anytime anywhere.

4.2. Voice Control (Alexa & Google Home)

The Sortfle RF Hub is compatible with Amazon Alexa and Google Home, allowing for convenient voice control of your roller shades. After linking your Smart Life account to your Alexa or Google Home app, you can use simple voice commands.

Easy Voice Control



Figure 4: Easy Voice Control with smart assistants.

Example commands:

- "Alexa, close roller blinds."
- "Hey Google, open roller shades."

Ensure your smart assistant device is properly set up and connected to the same network as your RF Hub.

5. COMPATIBILITY

The Sortfle AC520-02 RF Hub is compatible with the following AOK Motor remote series:

- AC114 series
- AC123 series
- AC127 series
- AC136 series
- AC140 series
- AC141 series
- AC145 series
- AC153 series

Note: If your remote control is a different model, it may not be compatible. Please verify compatibility before purchase or contact customer support for assistance.



Figure 5: The RF Hub replaces traditional RF remote controls for smart integration.

6. SPECIFICATIONS

| | |
|----------------------------|----------------------------------------------------|
| Product Name | Smart Controller |
| APP Name | Smart Life |
| Wireless Technology | 2.4G Wi-Fi; RF 433Mhz |
| Adapter Output | 5V --- 1A |
| Working Temperature | -10°C – 5°C |
| Working Humidity | 10%~90% RH (no condensation) |
| Dimensions | 2.75 in x 2.75 in x 0.59 in (70mm x 70mm x 25.4mm) |
| Net Weight | 1.16 ounces (33.0g) |
| Color | Black |
| Material | Plastic |
| Power Source | DC |
| Voltage | 5 Volts |
| Wattage | 2 watts |

Small Design



| | |
|----------------------|-----------------------------|
| Product name: | Smart Controller |
| APP name: | Smart Life |
| Wireless technology: | 2.4G Wi-Fi; RF 433Mhz |
| Adapter output: | 5V--- 1A |
| Working temperature: | -10°C-5°C |
| Working humidity: | 10%~90% RH(no condensation) |
| Dimensions: | 2.75 inX2.75 inX0.59 in. |
| Net weight: | 33.0g |

Figure 6: Product dimensions and detailed specifications.

7. TROUBLESHOOTING

If you encounter issues with your Sortfle RF Hub, please refer to the following common troubleshooting steps:

- **Hub not connecting to Wi-Fi:** Ensure your Wi-Fi network is 2.4 GHz. Check your Wi-Fi password for accuracy. Move the hub closer to your router.
- **Roller blinds not pairing:** Make sure the roller blind motor is in pairing mode (rotates once after pressing its programming button). Ensure the hub is powered on and connected to Wi-Fi.
- **Voice control not working:** Verify that your Smart Life account is correctly linked to your Alexa or Google Home app. Check your internet connection. Ensure the voice commands are clear and match the device name in your smart assistant app.
- **Limited range:** While the hub supports wall penetration, extreme distances or multiple thick walls may affect signal strength. Consider repositioning the hub or using a Wi-Fi extender.
- **App issues:** Try restarting the Smart Life app or reinstalling it. Ensure your smartphone's operating system is up to date.

If problems persist, please contact Sortfle customer support for further assistance.

8. MAINTENANCE

The Sortfle RF Hub requires minimal maintenance. To ensure optimal performance and longevity:

- **Cleaning:** Wipe the device with a soft, dry cloth. Do not use liquid cleaners or abrasive materials.
- **Environment:** Keep the device in a dry environment, away from direct sunlight, extreme temperatures, and high humidity.
- **Firmware Updates:** Periodically check the Smart Life app for any available firmware updates for the RF Hub to ensure you have the latest features and bug fixes.

9. WARRANTY AND SUPPORT

Sortfle products come with a standard manufacturer's warranty. For detailed warranty information, including terms and conditions, please refer to the warranty card included in your product packaging or visit the official Sortfle website.

For technical support, troubleshooting assistance, or any product-related inquiries, please contact Sortfle customer service through the contact information provided in your user manual or on the official Sortfle website. Please have your product model number (AC520-02) and purchase details ready when contacting support.