

Desview TP170

Desview TP170 Teleprompter Instruction Manual

Model: TP170

1. INTRODUCTION

The Desview TP170 is a professional teleprompter designed for use with DSLR cameras, mirrorless cameras, camcorders, and tablets up to 17 inches. It features a high-definition beamsplitter glass, durable aluminum alloy construction, and remote control capabilities, making it suitable for various video production scenarios.

2. KEY FEATURES

- **17-inch High-Definition Beamsplitter Glass:** Features 70/30 visible light transmission and 7H hardness for clear text display without ghosting, even in bright conditions.
- **Wide Compatibility:** Supports DSLR/mirrorless cameras, camcorders, and tablets up to 17 inches.
- **Bluetooth Remote Control & App:** Control prompting text with the dedicated "Desview" app (iOS/Android) and included Bluetooth remote.
- **Wider Angle Shooting:** Designed to prevent vignetting with lenses wider than 24mm (horizontal) and 35mm (vertical). Includes a detachable sun hood.
- **Premium Aluminum Alloy Construction:** Durable and robust design with a high-quality feel.
- **Portable Carry Case:** Comes with a protective aluminum case for convenient storage and transport.

3. PACKAGE CONTENTS

Upon opening the package, verify that all components are present:

- Teleprompter Base
- Beamsplitter Glass + Sunshade Hood
- PTZ (Pan-Tilt-Zoom) Unit
- Prompting Device Clip
- Remote Control

- Convenient Aluminum Storage Suitcase
- Other accessories (e.g., screws, cables)

High Definition

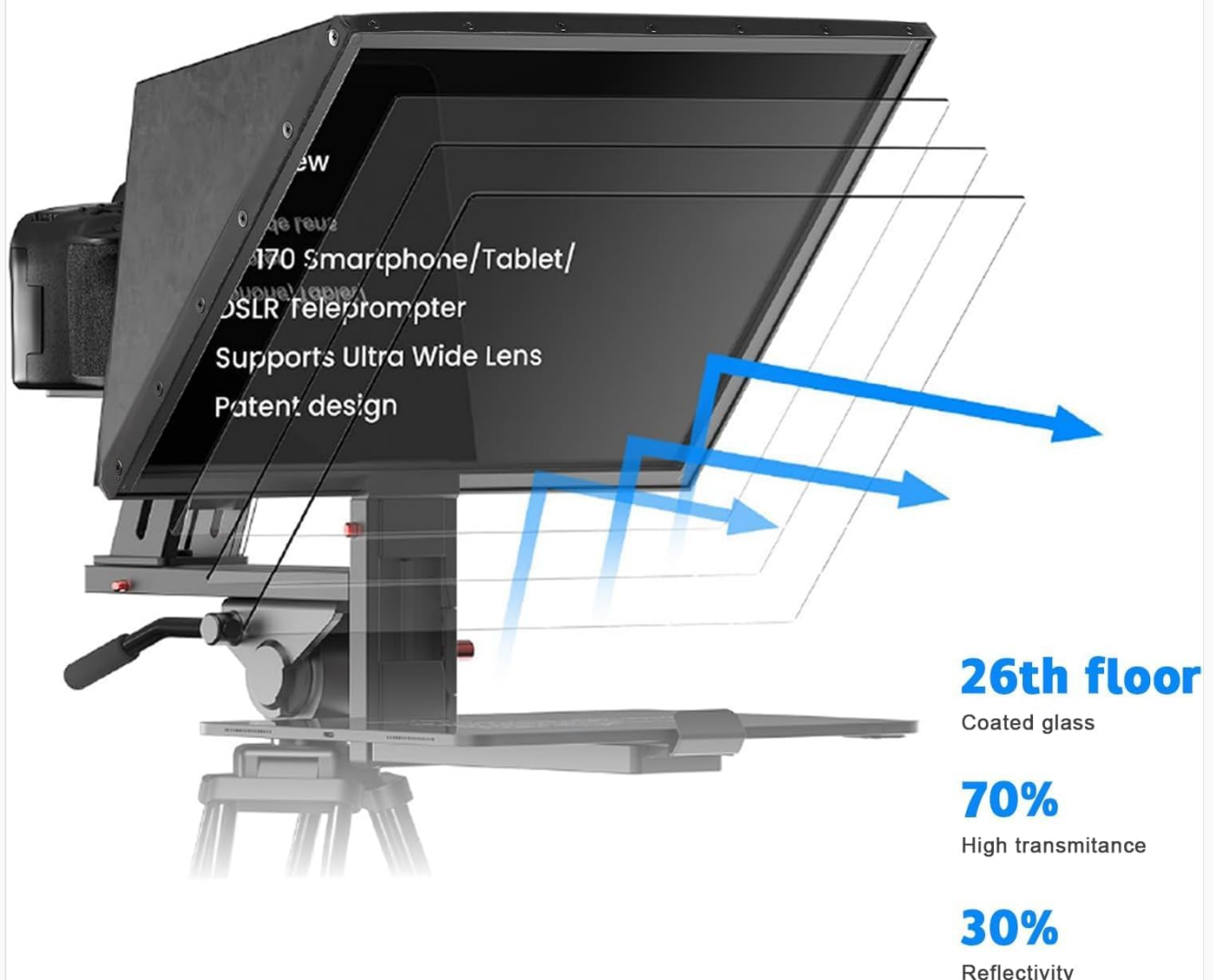

Figure 3.1: Desview TP170 Teleprompter components.

4. SETUP GUIDE

Follow these steps for proper assembly and setup of your Desview TP170 Teleprompter.

4.1. Video Guide: Teleprompter TP170 Use Techniques

Your browser does not support the video tag.

Video 4.1: A detailed video demonstrating the assembly and usage of the Desview TP170 Teleprompter. This video covers unboxing, component identification, assembly steps, camera mounting, and prompting device setup.

4.2. Step-by-Step Assembly

1. **Attach Teleprompter Base to Tripod:** Secure the teleprompter base to your camera tripod using the appropriate mounting screws. Ensure it is stable.

High Definition

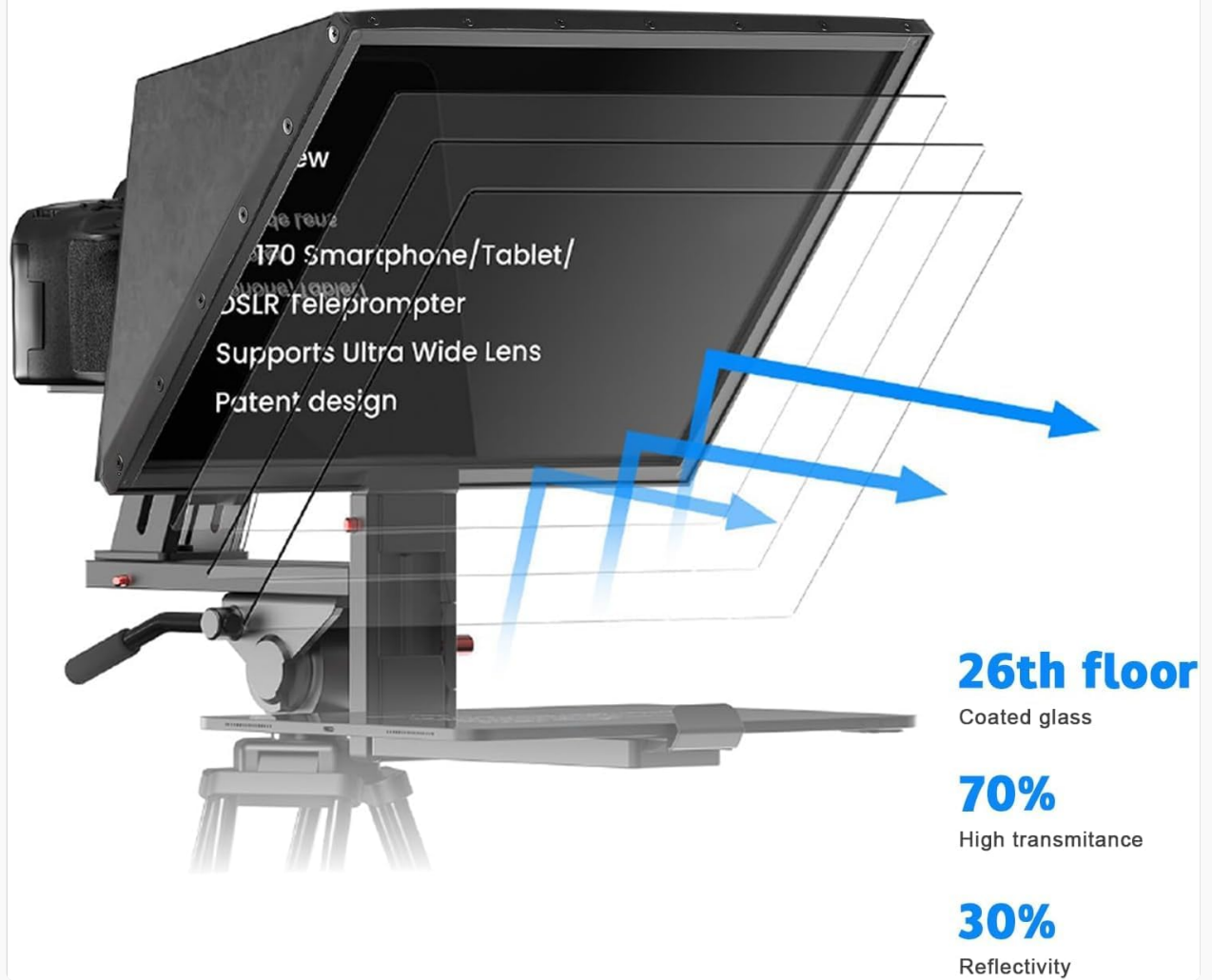

Figure 4.2.1: Securing the teleprompter base to a tripod quick release plate.

2. **Mount the PTZ Unit:** Attach the PTZ unit to the teleprompter base. This unit allows for vertical adjustment of the camera.



Figure 4.2.2: The PTZ unit attached to the base, illustrating adjustable stroke (50mm) and extension height (60-95mm).

3. **Install Beamsplitter Glass and Sunshade Hood:** Carefully insert the beamsplitter glass into the teleprompter hood. Then, attach the magnetic sunshade hood to the front of the teleprompter.

**HD display with High 70/30
Splitter Glass, No Ghost,
No Light Loss**

26
Layers Coated Glass

70%
Light Transmittance

30%
Reflectivity



Figure 4.2.3: Beamsplitter glass specifications.



Figure 4.2.4: Camera mounted with sunshade hood.

4. **Mount the Camera:** Attach your DSLR, mirrorless camera, or camcorder to the camera plate on the PTZ unit. Adjust its position to ensure the lens is centered with the beamsplitter glass.



Figure 4.2.5: DSLR camera mounted on the teleprompter.

5. **Attach Prompting Device Clip and Device:** Slide the prompting device clip onto the base. Place your tablet

or smartphone (up to 17 inches) onto the clip.

Support Tablet Horizontal/ Vertical Prompting Up to 17 inches

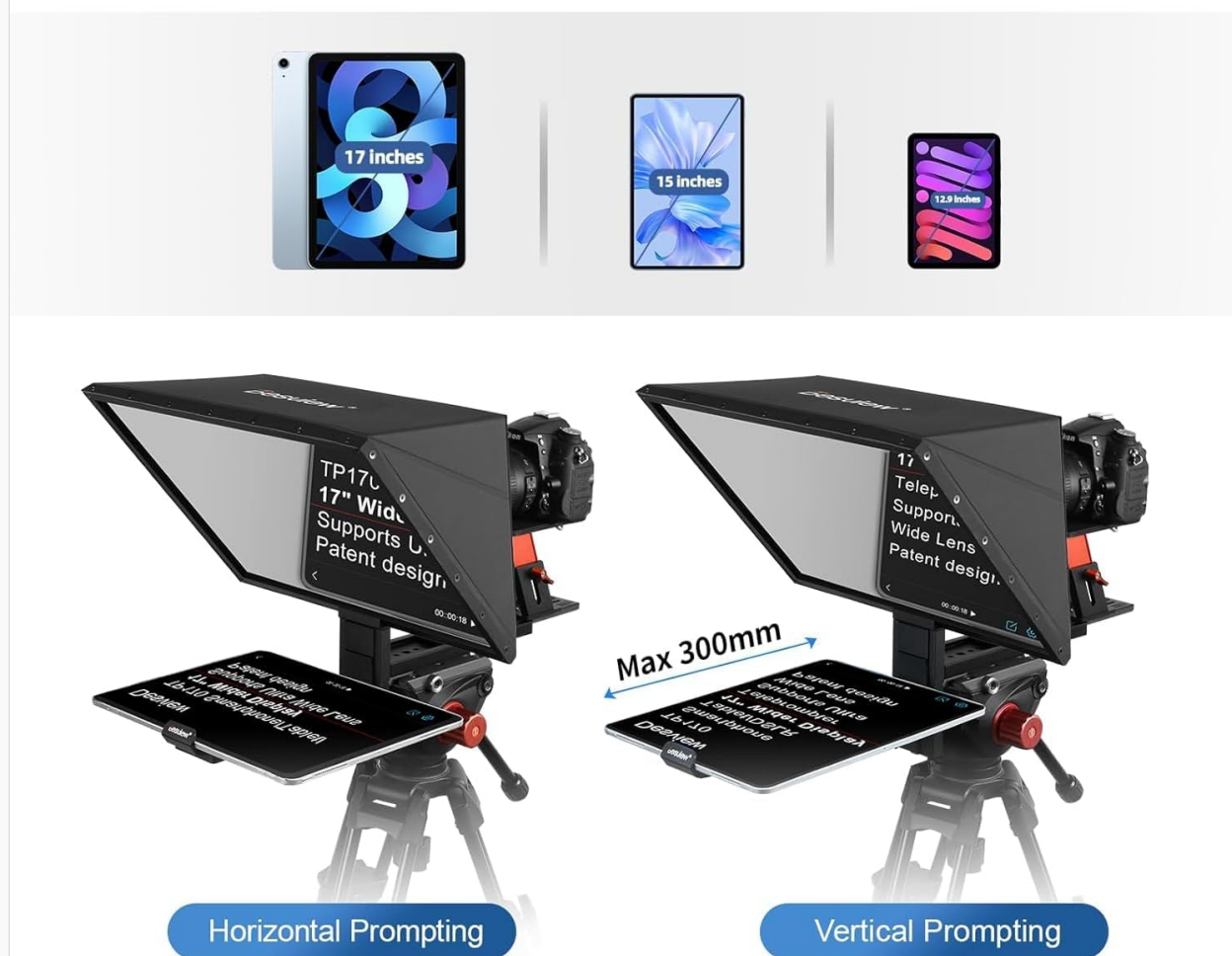

Figure 4.2.6: Horizontal and vertical prompting setup with a tablet.

5. OPERATION

5.1. Using the Desview App and Bluetooth Remote

The Desview TP170 teleprompter is controlled via a dedicated mobile application and a Bluetooth remote control.

1. **Download the App:** Search for "Desview" on the App Store (iOS) or Google Play (Android) and install the application on your prompting device (tablet or smartphone).
2. **Connect Bluetooth Remote:** Pair the included Bluetooth remote control with your prompting device.
3. **Load Script:** Open the Desview app and load your script.
4. **Control Prompting:** Use the Bluetooth remote to control functions such as turning pages, pausing, adjusting scroll speed, and changing text/background colors.

Teleprompter APP+Bluetooth

Teleprompter APP(iOS&Android) for smartphone/tablet can control to turn the page,pause,speed up down,change the text and background color



Figure 5.1.1: Desview app and Bluetooth remote control in use.



Figure 5.1.2: Bluetooth remote control functions.

5.2. Connecting External Devices for Prompting

The teleprompter supports various external devices for displaying scripts:

- **Smartphone Prompting:** Connect your smartphone to the teleprompter's display input (if available) or use it directly on the prompting device clip. Ensure the display is mirrored or extended.

- **Laptop Prompting:** Connect a laptop to the teleprompter's display input for larger script display. This is useful for longer scripts or complex presentations.

Your browser does not support the video tag.

Video 5.2.1: Demonstrates smartphone prompting (0:42 in video) and laptop prompting (0:47 in video) with the Desview TP170 Teleprompter.

5.3. Horizontal and Vertical Prompting

The teleprompter supports both horizontal and vertical orientations for your prompting device. Use the vertical L-bracket as needed to adjust the orientation.

Support Tablet Horizontal/ Vertical Prompting Up to 17 inches



Figure 5.3.1: Teleprompter configured for horizontal and vertical prompting.

6. MAINTENANCE AND CARE

- **Cleaning the Beamsplitter Glass:** Use a soft, lint-free cloth and a specialized glass cleaning solution. Avoid abrasive materials that could scratch the surface.
- **General Cleaning:** Wipe down the aluminum alloy frame and other components with a dry or slightly damp cloth. Do not use harsh chemicals.
- **Storage:** When not in use, store the teleprompter in its provided aluminum carry case to protect it from dust, moisture, and physical damage.

- **Handling:** Always handle the teleprompter with care, especially the beamsplitter glass, to prevent breakage or misalignment.



Figure 6.1: Storing the teleprompter in its carry case.

7. TROUBLESHOOTING

Problem	Possible Cause	Solution
Text appears blurry or ghosted.	Beamsplitter glass is dirty or improperly installed.	Clean the beamsplitter glass with a soft cloth and appropriate cleaner. Ensure the glass is seated correctly in its frame.
Remote control not responding.	Low battery, not paired, or out of range.	Replace batteries. Re-pair the remote with your device via Bluetooth. Ensure the remote is within operating range.
Vignetting (dark corners) in camera footage.	Camera lens too wide or improperly positioned.	Adjust camera position to center the lens. Ensure your lens is within the recommended focal length (e.g., >24mm horizontal, >35mm vertical).
Prompting device not fitting the clip.	Device size exceeds maximum supported.	Ensure your tablet or smartphone is up to 17 inches. Adjust the clip to its maximum extension.

8. SPECIFICATIONS

Feature	Detail
Model Number	Desview-TP170
Product Dimensions	7.87 x 14.17 x 11.42 inches
Item Weight	9.5 pounds (4.32 Kilograms)
Beamsplitter Glass	17 inch, 7H hardness, 70/30 visible light transmission
Compatible Devices	DSLR/Mirrorless Camera, Camcorder, Tablets/iPads up to 17 inches
Material	Aluminum Alloy

Feature	Detail
Color	Black
Control	Bluetooth Remote Control, "Desview" App (iOS/Android)
UPC	723884578723

9. WARRANTY AND SUPPORT

For warranty information and technical support, please refer to the official Desview website or contact their customer service directly. Keep your purchase receipt as proof of purchase for any warranty claims.
Official Desview Website: www.desview.com