

AILRINNI 29182-TY90

AILRINNI Smart Lock User Manual

Model: 29182-TY90

Brand: AILRINNI

INTRODUCTION

Welcome to the AILRINNI Smart Lock user manual. This guide provides detailed instructions for the installation, operation, and maintenance of your new smart lock. The AILRINNI Smart Lock offers multiple convenient and secure unlocking methods, including Bluetooth app control, fingerprint recognition, touchscreen keypad entry, and traditional mechanical keys. Designed for ease of use and high security, this lock is suitable for various environments such as homes, offices, bedrooms, and apartments.

PRODUCT OVERVIEW

Key Features

- **Multifunctional Unlocking:** Supports mobile phone application (BLE), digital passwords, semiconductor fingerprint identification, and traditional mechanical keys.
- **High Security:** Utilizes advanced semiconductor fingerprint technology for faster and more accurate recognition. Constructed from durable aluminum alloy for enhanced reliability.
- **Shared Access:** Easily share temporary, scheduled, or permanent access codes with family and friends via the mobile application.
- **Easy Installation:** Designed to meet most lever lock standards, requiring no hard wiring. Adjustable latch for various door sizes.
- **Versatile Application:** Ideal for residential and commercial use, including homes, offices, villas, and hotels.

Package Contents

Please verify that all components are present before beginning installation.



Image: All components included with the AILRINNI Smart Lock. This includes the main smart lock unit, latch bolt, strike plate, two mechanical keys, a user manual, a screwdriver, and various screws for installation.

- AILRINNI Smart Lock Unit (Front and Rear Handles)
- Latch Bolt
- Strike Plate
- Mechanical Keys (2)
- Mounting Screws and Accessories Kit
- User Manual (this document)
- Screwdriver

SPECIFICATIONS

| Feature | Detail |
|---------|--------|
|---------|--------|

| Feature | Detail |
|------------------------------|---|
| Model Number | 29182-TY90 |
| Brand | AILRINNI |
| Dimensions (L x W x H) | 22.91 x 16.51 x 16.51 cm |
| Item Weight | 800 g |
| Material | Plastic (with Aluminum Alloy components) |
| Color | Silver |
| Finish Type | Brushed |
| Lock Type | Biometric |
| Special Features | Fingerprint, Weather Resistant, Auto-Lock |
| Power Source | Batteries (Not Included) |
| Door Thickness Compatibility | 1-3/8 inch (35mm) to 2-3/16 inch (55mm) |
| Latch Compatibility | Adjustable 2-3/8 inch (60mm) or 2-3/4 inch (70mm) |

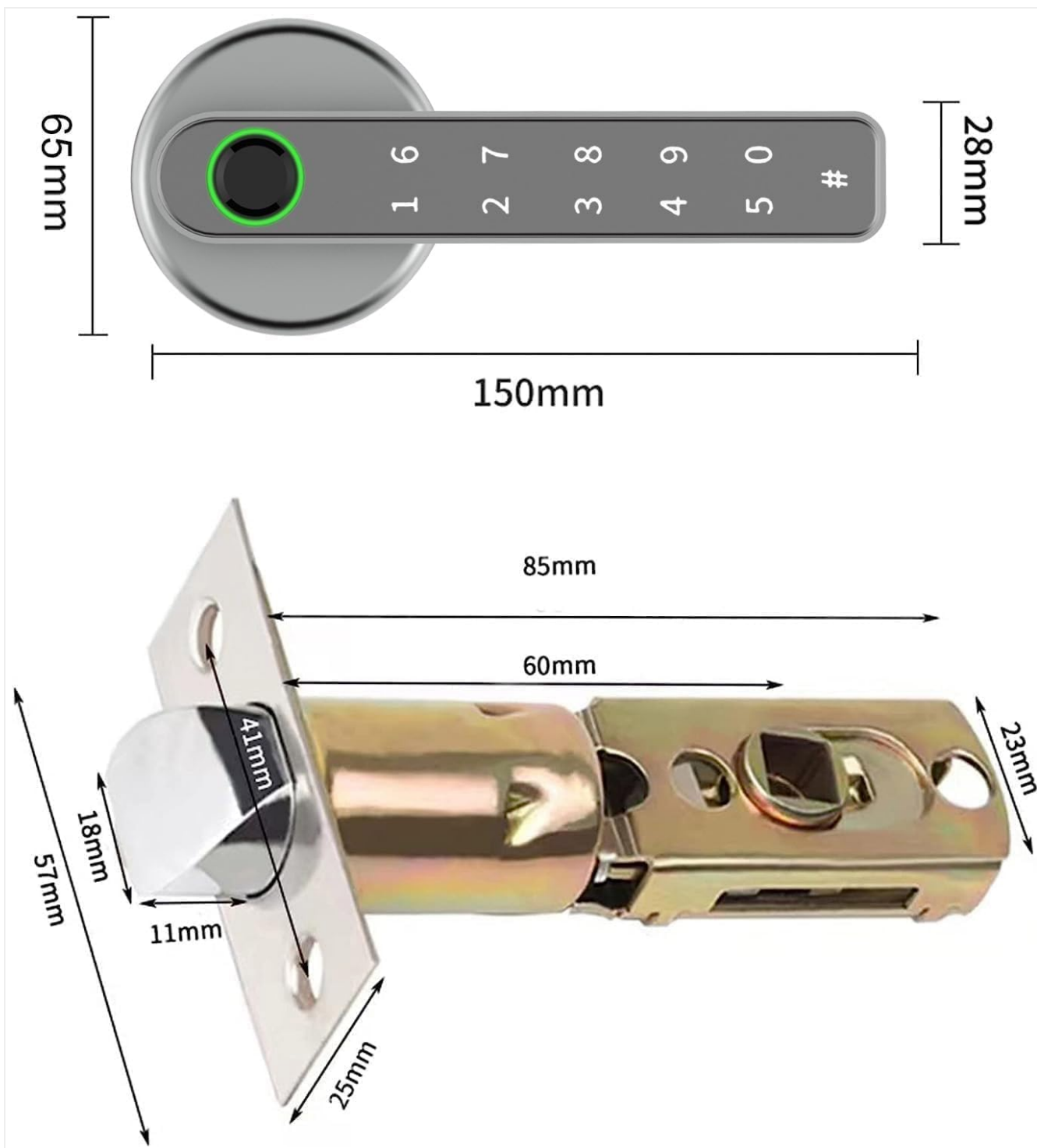

Image: Technical dimensions of the smart lock handle (150mm length, 65mm height, 28mm width) and the latch bolt (85mm length, 60mm backset, 57mm height).

Note: Batteries are not included and must be purchased separately. Please refer to the installation section for battery requirements.

SETUP AND INSTALLATION

Before installation, ensure your door meets the specified thickness and latch compatibility requirements. No hard wiring is required for this smart lock.

Pre-Installation Check

- Verify door thickness is between 1-3/8 inch (35mm) and 2-3/16 inch (55mm).
- Confirm latch backset is either 2-3/8 inch (60mm) or 2-3/4 inch (70mm).

- Ensure all package contents are present.

Installation Steps

1. **Prepare the Door:** If replacing an existing lock, remove it. Ensure the door boreholes are clean and clear.
2. **Install the Latch Bolt:** Insert the latch bolt into the door edge. Ensure the "UP" arrow on the latch is pointing upwards. Secure with screws.
3. **Install the Exterior Handle:** Feed the spindle and wires from the exterior handle through the latch bolt and door. Align the handle with the latch.
4. **Install the Interior Handle:** Connect the wires from the exterior handle to the interior handle. Align the interior handle with the mounting plate and secure it with screws.
5. **Insert Batteries:** Open the battery cover on the interior handle. Insert the required batteries (typically 4 x AAA, though not explicitly stated in specs, common for these locks).
6. **Test Operation:** Test the mechanical key, and ensure the handle operates smoothly.



Image: Simplified installation steps. Step 1 shows the latch bolt being inserted. Step 2 shows the exterior handle being placed. Step 3 shows the interior handle being attached to complete the installation.

Adjusting Handle Direction

The AILRINNI Smart Lock features a free handle design, allowing it to be opened from either the left or right side. Adjust the handle direction as needed during installation.

FREE HANDLE

You can open the door to the left or to the right

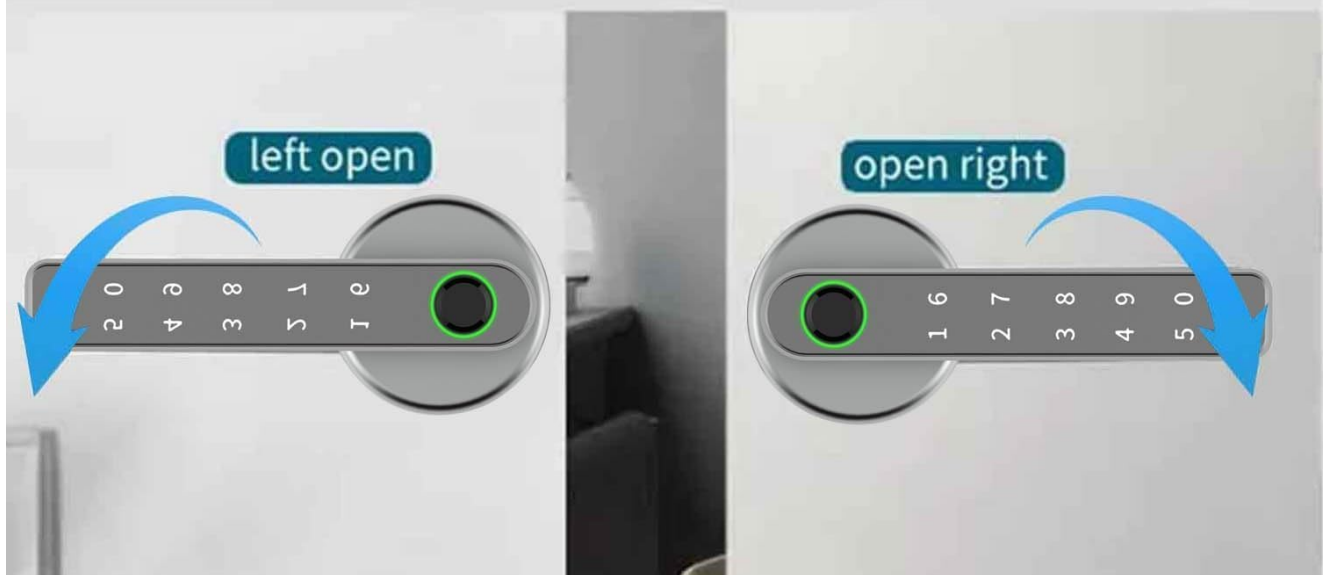

Image: Illustration of the "FREE HANDLE" feature, demonstrating how the handle can be rotated to accommodate both left-opening and right-opening doors.

OPERATING INSTRUCTIONS

Unlocking Methods

Your AILRINNI Smart Lock offers multiple ways to unlock for maximum convenience and security.

1. Mobile App Unlock (Bluetooth)

Download the compatible mobile application (e.g., Tuya Smart or Smart Life app) from your app store. Follow the in-app instructions to pair your lock via Bluetooth.



Image: Overview of the four primary unlocking methods: mobile app, fingerprint, PIN code, and mechanical key. The image also highlights compatibility with the Tuya Smart platform.

Once paired, you can unlock the door directly through the app, manage user access, generate temporary passwords, and view access logs.

2. Fingerprint Unlock

The smart lock features a semiconductor fingerprint sensor for quick and secure access.

1. **Adding Fingerprints:** Refer to the mobile app's instructions for adding new fingerprints. Typically, this involves placing your finger on the sensor multiple times from different angles.
2. **Unlocking:** Place your registered finger on the fingerprint sensor. The lock will unlock if the fingerprint is recognized.

3. Touchscreen Keypad Unlock

Use the integrated touchscreen keypad to enter a digital password.

1. **Setting Passwords:** Manage and set new digital passwords through the mobile application. You can create permanent, temporary, or one-time codes.
2. **Unlocking:** Enter your valid digital password on the keypad, then press the '#' key to confirm.

4. Mechanical Key Unlock

For emergency situations or as a backup, use the provided mechanical keys.

1. **Accessing Keyhole:** The keyhole is typically located at the bottom of the exterior handle.
2. **Unlocking:** Insert the mechanical key and turn to unlock the door.



Image: Close-up view highlighting the emergency key slot, the USB charging port for emergency power, the fingerprint sensor, and the mobile application interface for lock control.

MAINTENANCE

Battery Replacement

The smart lock is powered by batteries (not included). When the battery level is low, the lock will typically provide an audible or visual alert.

- Open the battery compartment on the interior handle.
- Remove old batteries and dispose of them properly.
- Insert new batteries, ensuring correct polarity.

- Close the battery compartment.

Note: If batteries completely drain, you can use the mechanical key or connect a power bank via the USB charging interface for emergency power to unlock the door and replace batteries.

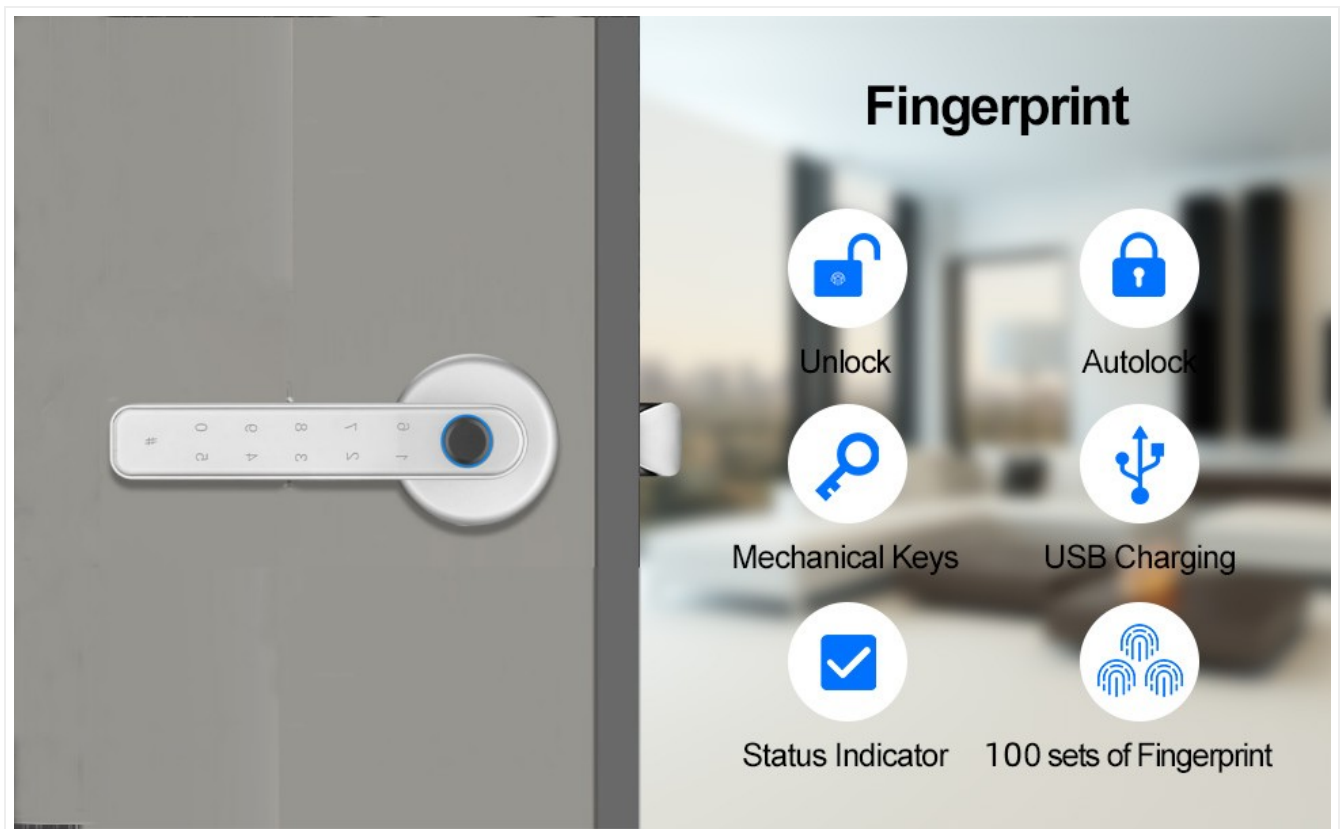

Image: A lifestyle shot of the AILRINNI Smart Lock installed on a door, emphasizing its user-friendly design for all ages.

Cleaning

Clean the lock's exterior with a soft, dry cloth. Avoid using abrasive cleaners, solvents, or harsh chemicals, as these can damage the finish and electronic components.

Environmental Considerations

While the lock is weather-resistant, extreme temperatures or prolonged exposure to direct moisture should be avoided to ensure optimal performance and longevity.

TROUBLESHOOTING

Common Issues and Solutions

Lock is not responding / No power

- **Check Batteries:** Ensure batteries are correctly inserted and have sufficient charge. Replace if necessary.
- **Emergency Power:** Use a power bank connected to the USB charging interface for temporary power.

Fingerprint not recognized

- **Clean Sensor:** Ensure the fingerprint sensor is clean and free of dirt or moisture.
- **Reposition Finger:** Try placing your finger on the sensor from different angles.
- **Re-register Fingerprint:** If issues persist, delete and re-register your fingerprint in the app.

Keypad not responding

- **Check Batteries:** Low batteries can affect keypad responsiveness.
- **Correct Code:** Ensure you are entering the correct digital password.
- **Reset:** If unresponsive, try removing and reinserting batteries to reset the lock.

Bluetooth connection issues

- **Enable Bluetooth:** Ensure Bluetooth is enabled on your mobile device.
- **App Permissions:** Verify the app has necessary Bluetooth permissions.
- **Proximity:** Ensure your device is within Bluetooth range of the lock.
- **Restart App/Phone:** Close and reopen the app, or restart your phone.

Lock does not auto-lock

- **Check Settings:** Verify auto-lock feature is enabled in the mobile app settings.
- **Door Alignment:** Ensure the door closes properly and the latch bolt extends fully into the strike plate.

If you encounter issues not listed here or require further assistance, please contact AILRINNI customer support.

WARRANTY AND SUPPORT

Warranty Information

The AILRINNI Smart Lock (Model 29182-TY90) comes with a **1-year warranty** from the date of purchase. This warranty covers manufacturing defects and malfunctions under normal use. It does not cover damage caused by misuse, unauthorized modification, accident, or improper installation.

Customer Support

For technical support, warranty claims, or any questions regarding your AILRINNI Smart Lock, please contact our customer service team.

- **Email:** ailrinni_trade@163.com
- **Online Support:** Refer to the official AILRINNI website for FAQs and additional resources.

Please have your product model number (29182-TY90) and purchase details ready when contacting support.