

V1

# Product Instruction Manual

Generic Vesken 4-Tier Shelf (Model V1)

## INTRODUCTION

This manual provides detailed instructions for the assembly, use, and maintenance of your Generic Vesken 4-Tier Shelf. Please read this manual carefully before assembly and use to ensure safe and optimal performance.

The Generic Vesken shelf is a versatile storage solution designed for various spaces such as bathrooms, kitchens, offices, and schools. Its tool-free assembly makes it quick and easy to set up.

## IMPORTANT SAFETY WARNINGS

- **Maximum Load Capacity:** Do not exceed the maximum load of **13 kg (28.6 lbs) per shelf**. Overloading can cause the shelf to collapse, leading to injury or damage.
- **Proper Assembly:** Ensure all parts are correctly assembled and securely connected before placing any items on the shelves. Improper assembly can lead to instability.
- **Stability:** Place the shelf on a flat, stable surface to prevent tipping.
- **Children and Pets:** Keep small children and pets away during assembly.
- **Cleaning:** Use a soft, damp cloth for cleaning. Avoid abrasive cleaners.

## PACKAGE CONTENTS

Before beginning assembly, verify that all components are present and undamaged.





*Image: The product packaging box, labeled "Shelf Unit", indicating the contents.*

**The package should contain the following:**

- Shelf components (shelves and support legs)
- Assembly instructions (this manual)

*Note: The shelf is designed for tool-free assembly, so no additional tools are required.*

## PRODUCT SPECIFICATIONS

Feature	Specification
Model Number	V1
Dimensions (W x D x H)	36 cm x 23 cm x 100 cm (14.2 in x 9.1 in x 39.4 in)
Maximum Load per Shelf	13 kg (28.6 lbs)
Number of Tiers	4
Distance Between Shelves	30 cm (11.8 in)
Product Weight	1.73 kg (3.8 lbs)
Assembly Type	Tool-free, Snap-together
Color	White

## SETUP AND ASSEMBLY

The Generic Vesken shelf is designed for quick and easy tool-free assembly. Follow these steps:

### Step 1: Unpack Components

Carefully remove all shelf components from the packaging. Lay them out on a clean, flat surface to identify all parts.



Image: Detailed assembly diagram illustrating the snap-together mechanism for the shelf components.

## Step 2: Assemble the Base

Identify the base shelf and the four shortest leg pieces. Insert the legs firmly into the designated slots on the underside of the base shelf until they click into place. Ensure they are securely seated.

## Step 3: Add Middle Shelves

Take the next set of leg pieces and attach them to the top of the legs already assembled on the base. Then, place the next shelf tier on top of these new leg pieces, pressing down firmly until it locks into place. Repeat this process for the remaining middle shelves, ensuring each tier is level and secure.

## Step 4: Attach the Top Shelf

Finally, attach the last set of leg pieces to the top of the previous tier, and then place the top shelf on these legs, securing it firmly. Verify that all connections are tight and the shelf is stable.





*Image: A fully assembled Generic Vesken 4-tier shelf, ready for use.*

*Tip: The design with upward-curved edges on all sides helps keep items securely in place on each shelf.*

## USAGE AND PLACEMENT

The Generic Vesken shelf is highly versatile and can be used in various environments:

- **Bathroom:** Ideal for storing toiletries, towels, and cleaning supplies.
- **Kitchen:** Suitable for pantry items, small appliances, or cooking essentials.
- **Office/Study:** Can hold books, stationery, or small office equipment.
- **School/Dorm Room:** Provides extra storage for personal items or study materials.



Image: The shelf positioned in a bathroom, holding various personal care products and towels.

# Shelf Unit Raf Ünitesi

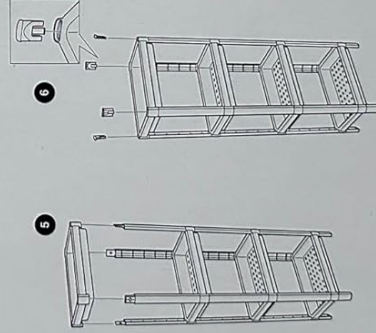
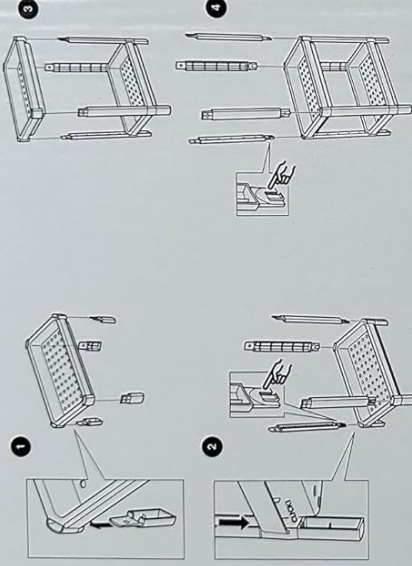

## UYARI! / WARNING!

Mobilyanın devrilmesi sonucu ciddi yaralanmalar meydana gelebilir. Devrilme riskini önlemek için dikkat ediniz.  
Serious injury may occur as a result of furniture tipping over. Take care to avoid the risk of tipping.

Beyaz  
White

Siyah  
Black

Gri  
Grey



KOD: 01M-0530

MADE IN Türkiye

Image: The shelf placed beside a bathroom sink, providing convenient storage for toiletries.



*Image: The shelf in a bathroom corner, neatly organizing towels and other small items.*



*Image: The shelf utilized in a kitchen setting, positioned next to a refrigerator, holding various kitchen supplies.*

#### **Key Usage Points:**

- Always distribute weight evenly across the shelves.
- Do not place excessively heavy or unstable items on the top shelf.
- Ensure the shelf is not exposed to extreme temperatures or direct sunlight for prolonged periods, as this may affect the material.

#### **CARE AND MAINTENANCE**

To ensure the longevity and appearance of your Generic Vesken shelf, follow these simple care instructions:

- **Cleaning:** Wipe the shelf clean with a soft cloth dampened with water and a mild, non-abrasive detergent or soap.

- **Drying:** Always wipe dry with a clean, dry cloth immediately after cleaning to prevent water spots.
- **Avoid Harsh Chemicals:** Do not use strong chemical cleaners, abrasive pads, or solvents, as these can damage the surface finish.
- **Regular Inspection:** Periodically check all connections to ensure they remain secure. If any part feels loose, re-snap it firmly into place.

## TROUBLESHOOTING

Problem	Possible Cause	Solution
Shelf is wobbly/unstable.	Parts not fully snapped together; uneven floor surface; overloaded shelf.	Ensure all leg and shelf connections are firmly clicked into place. Move the shelf to a flat, level surface. Reduce the weight on the shelves, ensuring it does not exceed 13 kg per shelf.
Items slide off the shelf.	Shelf is not level; excessive movement; items are too tall or unstable.	Verify the shelf is on a level surface. Ensure the shelf is not being bumped or moved frequently. Place taller or less stable items on lower shelves or in containers. The raised edges are designed to help prevent items from sliding off.
Difficulty assembling parts.	Parts not aligned correctly; insufficient force applied.	Ensure the male and female connectors are perfectly aligned before applying pressure. Apply firm, even pressure until you hear a click, indicating the parts are locked. Do not force if misaligned.

## WARRANTY AND SUPPORT

For information regarding warranty coverage or if you require technical support, please contact the seller or refer to your purchase documentation.

**Seller:** BEFA Quality Shopping

For further assistance, you may visit the product page on Amazon.de:[Product Page Link](#)