

## CAMECHO Radio Coche Bluetooth con Carplay

# CAMECHO 1 DIN Car Radio with 7-inch Motorized Touch Screen, Wireless CarPlay & Android Auto

Model: Radio Coche Bluetooth con Carplay

## INTRODUCTION

This manual provides detailed instructions for the installation, operation, and maintenance of your CAMECHO 1 DIN Car Radio. This unit features a 7-inch motorized touchscreen, Wireless CarPlay, Android Auto, Mirror Link, FM radio, USB, Type-C, AUX inputs, and microphone support. Please read this manual thoroughly before using the product to ensure proper functionality and safety.

## WHAT'S IN THE BOX

Carefully unpack the box and ensure all items are present:

- 1x CAMECHO 1 DIN Car Radio with Motorized Screen
- 1x Rear View Camera (if included in package)
- 1x Power Cable Harness
- 1x Remote Control
- 1x Microphone
- 1x RCA Cable Set
- 1x USB Cable
- Mounting Brackets and Screws
- User Manual

## PRODUCT OVERVIEW

The CAMECHO 1 DIN Car Radio is designed to enhance your in-car entertainment and connectivity. Its motorized 7-inch touchscreen provides a clear interface for various functions.

# USB/TF/AUX/MIC



Figure 1: Overview of Wireless CarPlay, Wireless Android Auto, and Wired Mirrorlink functionality.



Figure 2: Bluetooth hands-free calling and music streaming, alongside the FM Radio interface.

# 7-Farbige Tastenbeleuchtung

Unterstützen Sie siebenfarbige Hintergrundbeleuchtung, Sie können Ihre Lieblingsfarbe im Setup-Menü auswählen und Ihr Auto dekorieren



Figure 3: Front panel inputs including USB, Type-C, AUX, and Microphone ports.

# Motorized Retractable Screen



1 Angle the screen down

2 Angle the screen up

3 Expand the screen



The player screen angle is adjustable



Figure 4: Rear view camera display and customizable steering wheel control interface.

# Product Accessories

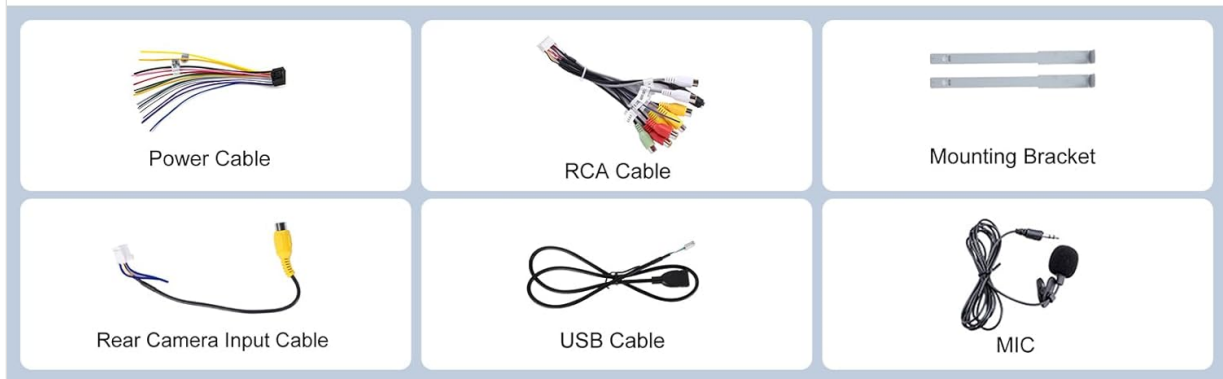
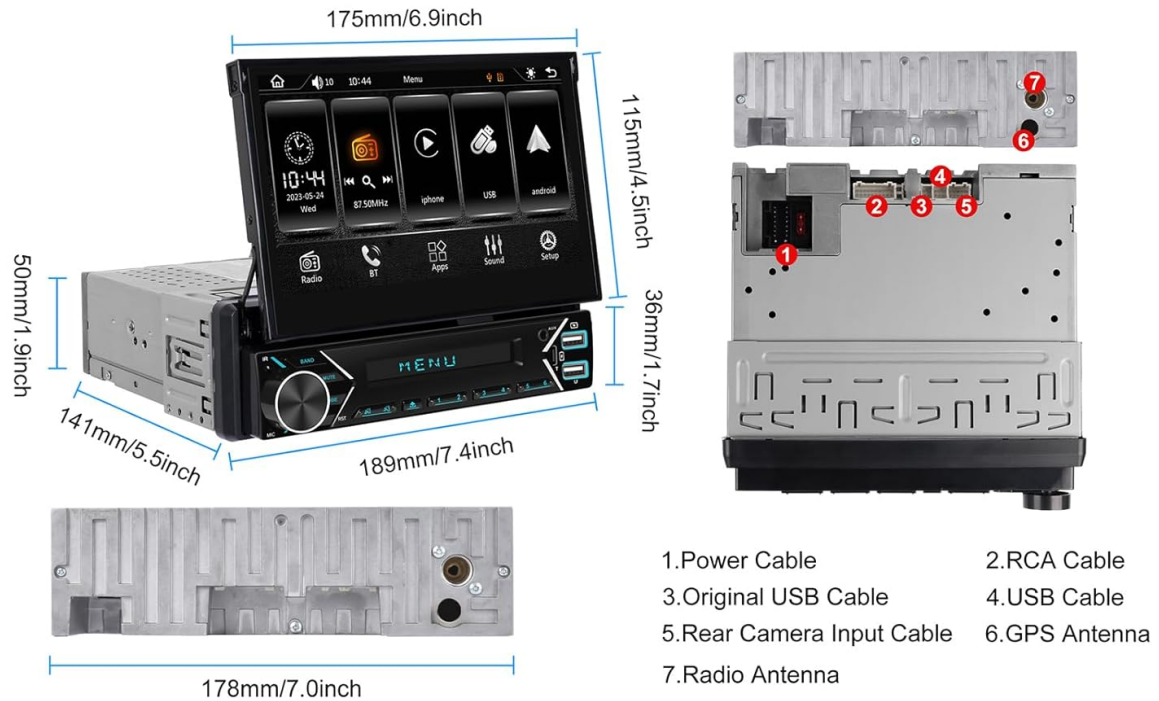

Figure 5: Customizable 7-color key button illumination.



Figure 6: The motorized retractable screen can be angled down, up, and expanded, with an adjustable player screen angle of up to 95 degrees.



Figure 7: Product dimensions and a visual representation of the included accessories.

## SETUP AND INSTALLATION

Professional installation is recommended for this car radio. Ensure the vehicle's power is disconnected before beginning installation.

### Wiring Connections

Refer to the wiring diagram for proper connections. The main power harness connects to your vehicle's power, ground, and accessory wires. Ensure all connections are secure to prevent malfunctions.



Figure 8: Detailed wiring harness connections for the car radio.

### Rear View Camera Connection

To connect the rear view camera:

1. Connect the yellow RCA video cable from the camera to the 'CAMIN' input on the car radio.
2. Connect the camera's power cable (red wire to +12V, black wire to GND) to the vehicle's reverse light power source.
3. Connect the trigger wire (often labeled 'BACK' or 'REVERSE' on the power cable) from the car radio's harness to the positive lead of the vehicle's reverse light. This ensures the display automatically switches to the camera view when reversing.



Figure 9: Diagram illustrating the connection of the rear view camera to the car radio and vehicle's reverse light system.

## Installation Video

Video 1: This video demonstrates the automatic screen retraction, key light settings, and connections for CarPlay, Android Auto, Mirror Link, and the reversing camera. It provides a visual guide for initial setup and feature overview.

## OPERATING INSTRUCTIONS

### Motorized Screen Operation

The 7-inch screen is motorized and can be adjusted for optimal viewing. Use the physical buttons or touchscreen controls to angle the screen up or down, and to expand or retract it. The screen angle is adjustable up to 95 degrees.

### Wireless CarPlay and Android Auto

Connect your iPhone via Wireless CarPlay or Android phone via Wireless Android Auto to access navigation, music, calls, and messages directly on the car radio's screen. Ensure Bluetooth is enabled on your phone and pair it with the car radio. Follow the on-screen prompts for authorization.



Figure 10: Wireless CarPlay interface for seamless iPhone integration.



Figure 11: Wireless Android Auto interface for seamless Android phone integration.

### Mirror Link Function

Synchronize your smartphone screen (Android 10.1/iOS 13.4 or higher) with the car radio via Mirror Link using an original USB cable. This allows you to view apps, videos, and mobile content directly on the car's display. The first connection may require scanning a QR code to download mirroring software.



Figure 12: Mirror Link functionality for displaying smartphone content.

## Bluetooth 5.1

The unit features Bluetooth 5.1 for clear hands-free calls and high-quality wireless music playback. Pair your phone with the car radio via Bluetooth settings. Once paired, you can make/receive calls and stream audio.



Figure 13: Bluetooth interface for hands-free calls and music streaming.

## FM Radio

Access the FM radio function to listen to your favorite stations. The unit supports 18 preset stations and provides real-time traffic, news, and weather information where available.



Figure 14: FM Radio interface and Equalizer (EQ) adjustment screen.

## Steering Wheel Control

The car radio is compatible with original steering wheel controls, allowing you to manage functions safely and quickly without taking your hands off the wheel. Access the 'Wheel' settings in the menu to configure the controls.

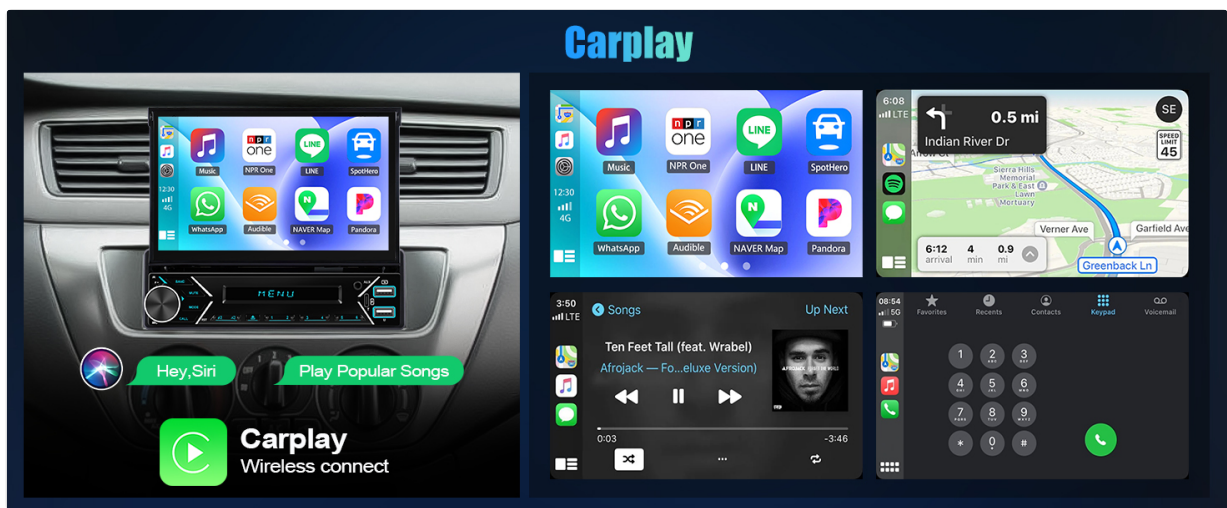

Figure 15: Interface for setting up steering wheel controls.

## Multimedia Playback

The unit supports multiple inputs for multimedia playback, including USB, Type-C, and AUX. Connect MP3 players, mobile phones, or USB drives to enjoy music and videos. The Type-C port also offers fast charging for compatible devices.



Figure 16: Various multimedia input options and device charging capabilities.

## Key Light Settings

Customize the ambiance of your car's interior with 7-color customizable key lights. Access the settings menu to select your preferred color.

## MAINTENANCE

To ensure the longevity and optimal performance of your CAMECHO car radio, follow these maintenance guidelines:

- **Cleaning:** Use a soft, dry cloth to clean the screen and unit. Avoid abrasive cleaners or solvents.
- **Software Updates:** Periodically check the manufacturer's website for any available software updates to ensure continued compatibility and improved performance.
- **Environmental Conditions:** Operate the unit within the specified temperature range (-20°C to 70°C) to prevent damage.

## TROUBLESHOOTING

If you encounter issues with your car radio, refer to the following common troubleshooting steps:

- **No Power:** Check all power connections, including the fuse. Ensure the ignition is on.
- **No Sound:** Verify speaker connections, volume levels, and audio source selection. Check the EQ settings.
- **Screen Not Responding:** Try restarting the unit. If the issue persists, perform a factory reset (refer to the settings menu).
- **CarPlay/Android Auto Not Connecting:** Ensure Bluetooth is paired and the USB cable (for wired connection) is original and functioning. Check phone settings for permissions.
- **Rear Camera Not Displaying:** Verify the camera's video and power connections. Ensure the reverse gear is engaged and the trigger wire is correctly connected.

For persistent issues, contact customer support.

SPECIFICATIONS

Feature	Specification
Brand	CAMECHO
Model Name	Radio Coche Bluetooth con Carplay
Product Dimensions	19 x 27 x 10 cm; 1.84 kg
Screen Type	7-inch Capacitive Touch Screen, Motorized Retractable IPS HD
Screen Resolution	1024x600
Connectivity Technology	Wireless CarPlay, Wireless Android Auto, Mirror Link (USB), Bluetooth 5.1, USB Type-A, USB Type-C, AUX
Audio Output Mode	Speakers, RCA Audio Output
Speaker Surround Sound Channel Configuration	5.1
Output Power	4x45 Watts
Operating System	F133 Stable System
Amplifier Chip	TDA7388
Operating Temperature	-20°C to 70°C
Special Features	Touchscreen, 7-Color Customizable Backlight, Steering Wheel Control Support, Rear Camera Input
Compatible Devices	Android and Apple compatible devices

WARRANTY AND SUPPORT

For any questions, technical assistance, or warranty claims, please contact CAMECHO customer support.  
Email: [CAMECHOVIP@126.com](mailto:CAMECHOVIP@126.com)

Please have your product model and purchase information ready when contacting support.



Figure 17: Contact information for customer support.