

IVANKY VCD10

iVANKY FusionDock Max 1 Thunderbolt 4 Docking Station User Manual

Brand: IVANKY | **Model:** VCD10

1. INTRODUCTION

This manual provides detailed instructions for the setup, operation, and maintenance of your iVANKY FusionDock Max 1 Thunderbolt 4 Docking Station. Please read this manual thoroughly before using the product to ensure optimal performance and longevity.



Image 1: iVANKY FusionDock Max 1 Docking Station. This image displays the docking station in both vertical and horizontal orientations, highlighting its compact design and the array of available ports on its front and rear panels.

2. PRODUCT OVERVIEW

The iVANKY FusionDock Max 1 is a 20-in-1 docking station designed to expand the connectivity of compatible Mac devices. It features dual Thunderbolt 4 chips for high-speed data transfer and supports multiple external displays.

Port Layout

Dual Thunderbolt 4 Chips Bulit-in

Seamless, Lag-Free Transmission

40Gbps

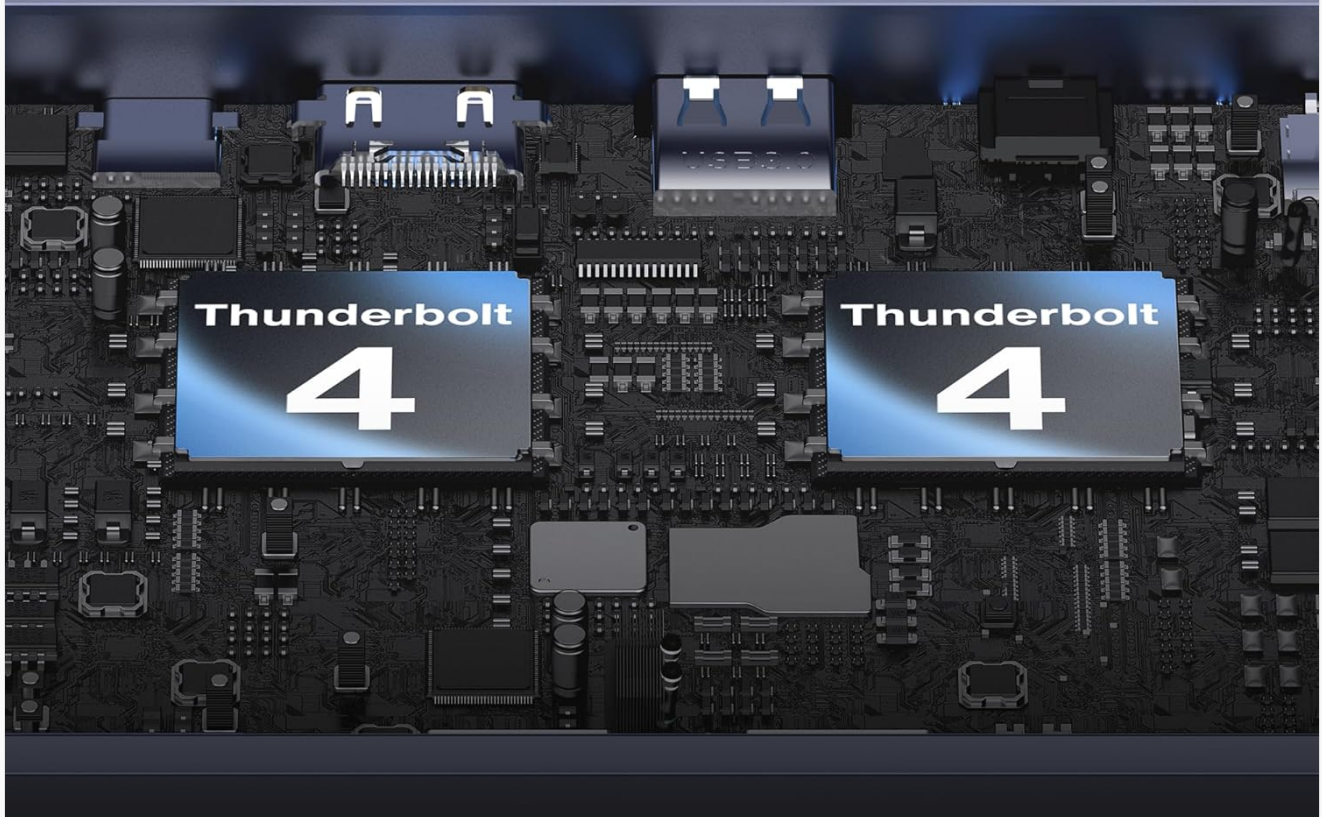

Image 2: Port Layout Diagram. This diagram illustrates the comprehensive port configuration on both the front and rear of the FusionDock Max 1, with clear labels for each connection type.

• Front Ports:

- 1 x Downstream Thunderbolt 4 Port (40Gbps, 15W)
- 2 x USB-A 10Gbps Ports
- 1 x USB-C 10Gbps Port with 30W Power Delivery (PD)
- 1 x 3.5mm Mic & Headset Combo Jack
- 1 x SD/TF 4.0 Card Slot (up to 312Mb/s)

• Rear Ports:

- 2 x Upstream Thunderbolt 4 Ports (40Gbps, 100W PD to host)
- 3 x Downstream Thunderbolt 4 Ports (40Gbps, 15W)
- 2 x HDMI 2.0 Ports (up to 4K@60Hz)
- 2 x USB-A 10Gbps Ports
- 1 x 2.5 Gigabit Ethernet Port (RJ45)

- 1 x Optical Toslink Audio Port
- 1 x 3.5mm Line-out Port
- 1 x Kensington Security Slot
- 1 x DC IN 180W Power Input

3. SETUP INSTRUCTIONS

1. **Connect Power:** Connect the provided 180W power adapter to the DC IN port on the rear of the docking station and then to a power outlet.
2. **Connect to Host Device:** Use the two included Thunderbolt 4 cables to connect your Mac to the two Upstream Thunderbolt 4 ports on the rear of the docking station. Ensure both cables are securely connected.
3. **Connect Displays:** Connect your external monitors to the available Thunderbolt 4 ports (using appropriate adapters if necessary) or the HDMI 2.0 ports on the rear of the docking station. Refer to the compatibility section for display configuration limits based on your Mac model.
4. **Connect Peripherals:** Connect your USB devices, Ethernet cable, SD/TF cards, and audio devices to the corresponding ports on the front and rear of the docking station.
5. **Driver Installation (Ethernet):** For the 2.5 Gigabit Ethernet port to function properly, ensure you update to the latest RJ45 driver. This may require downloading the driver from the iVANKY support website.

4. OPERATING INSTRUCTIONS

Display Configuration

The iVANKY FusionDock Max 1 supports various display configurations depending on your Mac's processor. Refer to the compatibility section for detailed information.

Pioneering Quad-6K Display: A First for Visionaries

Support four external displays at up to 6K 60Hz.



Note: HDMI ports have a maximum resolution of 4K at 60Hz.

Image 3: Quad 6K Display Setup. This image illustrates a MacBook Pro connected to the FusionDock Max 1, extending its display across four external 6K monitors, demonstrating the dock's multi-display capability.

Data Transfer

The dock provides high-speed data transfer capabilities:

- **Thunderbolt 4 Ports:** Up to 40Gbps for rapid data transfer between compatible Thunderbolt devices.
- **USB 3.2 Ports:** 7 USB ports (5 USB-A, 2 USB-C) supporting up to 10Gbps data transfer.
- **SD/TF 4.0 Card Slot:** Supports data transfer speeds up to 312Mb/s.

How many displays can be connected to a MacBook?

Compatible Device



Single Display



Macbook Air/Pro
(2020 M1)



Macbook Air/Pro
(2022 M2)



MacBook Air/Pro
(2023 M3)



Mac mini
(M1/M2/M4)



Dual Displays



Mac mini (M2 Pro)



MacBook Pro
(M1/M2/M3/Pro)



MacBook
(M4/M4/Pro)



Quad Displays



MacBook Pro
(M1/M2/M3/M4 Max)

Incompatible Devices:



MacBook Intel Series (2011-2020)



Windows Laptop



Chrome Laptop

Image 4: High-Speed Data Transfer. This image shows an external hard drive connected to the dock, highlighting the 10Gbps data transfer capability of the USB 3.2 ports, which is twice as fast as standard USB 3.0.

Power Delivery

The dock features a 180W power adapter, providing power to your connected devices:

- **Laptop Charging:** Up to 96W Power Delivery to your connected Mac via the upstream Thunderbolt 4 ports.
- **USB-C PD Port:** Up to 30W Power Delivery for charging compatible USB-C devices.

Note: For better transfer stability, do not connect external storage devices to the 30W PD USB-C port.

Import, Organize and Backup in a Snap.

40Gbps

Laptop Host

10Gbps

4*USB-A
2*USB-C

312Mbps

SD/TF 4.0
Card Slots

2X Faster Than
USB 3.0

USB 3.1

10Gbps

USB 3.0

5Gbps

Image 5: Rapid Multi-Device Charging. This image demonstrates the dock's ability to charge a MacBook Pro at up to 100W and an iPhone at up to 30W simultaneously, showcasing its power delivery capabilities.

5. COMPATIBILITY

Supported Devices and Display Configurations

The iVANKY FusionDock Max 1 is specifically designed for Mac devices with Apple Silicon. Display output capabilities vary by Mac chip type:

- **2021/2023 MacBook Pro (M1/M2/M3 Max chips):** Supports up to quad extended displays at 6K@60Hz.
- **2021/2023/2024 MacBook Pro (M4 or M1/M2/M3/M4 Pro chips):** Supports up to dual extended displays at 6K@60Hz.
- **2020/2022 Mac series (M1/M2/M3 chips):** Supports a single extended display at 6K@60Hz.

FusionDock Max 1 with Dual Build-in Thunderbolt 4 Chips

The Missing Piece for Mac with Apple Silicon



Image 6: Important Compatibility Notes. This graphic provides crucial information regarding HDMI port resolution limits, the requirement for a full-functional USB-C or HDMI port on monitors, microphone compatibility with the front audio port, RJ45 driver updates, and a specific note about macOS 14.4 sleep behavior.

Incompatible Devices

This docking station is **not compatible** with the following devices:

- Any Windows Laptops
- Any Chrome Laptops
- MacBook Intel Series (2011-2020)

Exceptional Thermal Design for Peak Performance

Adaptable design merges flawlessly with your vision



Image 7: Device Compatibility Overview. This chart visually summarizes which Mac models (M1/M2/M3, M1/M2/M3/M4 Pro, M1/M2/M3/M4 Max) are compatible and how many displays they can support, alongside a clear indication of incompatibility with Intel Macs, Windows, and Chrome laptops.

Detailed Display Resolution Compatibility

The following tables provide detailed resolution and refresh rate compatibility for different Mac chipsets:

6K@60Hz Display Configurations

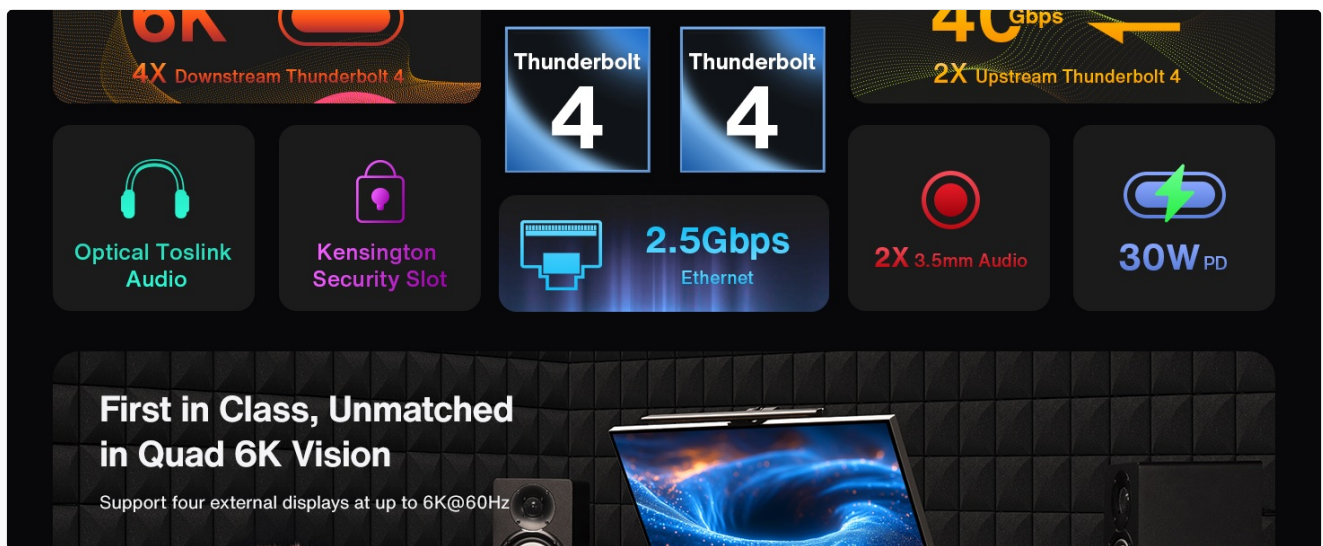

Image 8: 6K@60Hz Display Compatibility. This table details the support for single, dual, and triple 6K@60Hz displays across various Apple Silicon Mac models, including M1/M2/M3, Pro/Max chips, and notes incompatibility with Intel Macs.

4K@120Hz/144Hz Display Configurations



Image 9: 4K@120Hz/144Hz Display Compatibility. This table outlines the support for single, dual, and quad 4K displays at high refresh rates (120Hz/144Hz) for different Apple Silicon Mac configurations.

2K@144Hz/165Hz Display Configurations



Image 10: 2K@144Hz/165Hz Display Compatibility. This table details the support for single, dual, and quad 2K displays at high refresh rates (144Hz/165Hz) for different Apple Silicon Mac configurations.

Ultrawide and Other Resolutions

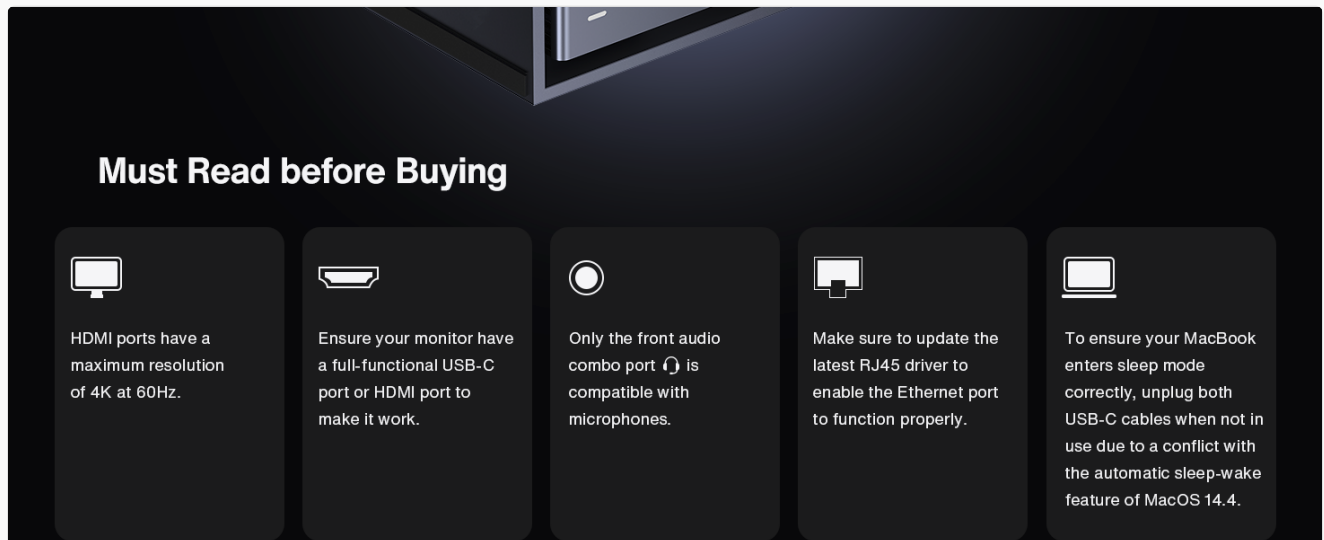

Image 11: Ultrawide Display Compatibility. This table provides compatibility information for various ultrawide resolutions and refresh rates, such as 5120x1440 and 3440x1440, across different Apple Silicon Mac models.

Note: All display solutions are capable of downward compatibility with various resolutions and frame rates, including support for 5K, 4K, 2K, etc.

6. MAINTENANCE

- **Cleaning:** Use a soft, dry cloth to clean the exterior of the docking station. Avoid liquid cleaners or abrasive materials.
- **Ventilation:** Ensure the docking station is placed in a well-ventilated area. Do not block the ventilation openings. The device may run warm during operation, which is normal.
- **Storage:** When not in use for extended periods, disconnect the power adapter and store the dock in a cool, dry place.



Image 12: Exceptional Thermal Design. This diagram illustrates the internal thermal management system of the FusionDock Max 1, designed to dissipate heat and maintain peak performance.

7. TROUBLESHOOTING

- **No Display Output:**
 - Ensure both Thunderbolt 4 cables are securely connected between the dock and your Mac.
 - Verify that your Mac model supports the number of displays you are attempting to connect (refer to the Compatibility section).
 - Check monitor input settings and cable connections.
 - Ensure the RJ45 driver is updated for Ethernet functionality.
- **MacBook Not Charging:**
 - Confirm the 180W power adapter is correctly connected to the dock and a power outlet.
 - Ensure your Mac is connected to the upstream Thunderbolt 4 ports.
- **Intermittent Connections/Disconnections:**

- Ensure all cables are firmly seated.
 - Avoid moving the MacBook excessively while connected to prevent accidental disconnections.
 - If experiencing issues with macOS 14.4 and sleep mode, unplug the dual USB-C cables when not in use to ensure your MacBook can enter sleep mode properly.
- **Audio Issues:**
 - Ensure the front audio combo port is compatible with your microphone.
 - Check audio output settings on your Mac.

For further assistance, please refer to the official [Troubleshooting Guide \(PDF\)](#) or contact customer support.

8. SPECIFICATIONS

Feature	Detail
Product Dimensions	6.73 x 3.69 x 1.96 inches
Item Weight	1.75 pounds
Model Number	VCD10
Brand	IVANKY
Color	Midnight Blue
Hardware Interface	Thunderbolt 4
Special Feature	Plug and Play
Compatible Devices	MacBook Pro (Apple Silicon)
Power Adapter	180W
Laptop Power Delivery	Up to 96W
USB-C PD Output	Up to 30W
Thunderbolt 4 Data Speed	40Gbps
USB 3.2 Data Speed	10Gbps
SD/TF Card Speed	Up to 312Mb/s (SD/TF 4.0)
Ethernet Speed	2.5 Gigabit



9. WARRANTY AND SUPPORT

The iVANKY FusionDock Max 1 comes with a **24-month warranty** from the date of purchase. iVANKY is committed to providing responsive customer service and lifetime technical support.

If you encounter any problems with your docking station, please contact iVANKY customer support:

- **Email:** support@ivanky.com
- **Response Time:** Within 24 Hours

Related Documents - VCD10

 <p>iVANKY</p> <p><small>Product details & guarantee</small></p> <p><small>ivanky@support.com</small></p> <p><small>www.ivanky.com</small></p>	<p>iVANKY 20-in-1 Thunderbolt 4 Docking Station User Guide and Warranty Information</p> <p>Comprehensive guide to the iVANKY 20-in-1 Thunderbolt 4 Docking Station, covering troubleshooting tips for port connectivity and display resolution, along with details on the 18-month limited warranty and 54-month extended warranty registration.</p>
 <p>iVANKY</p> <p><small>Product Details & Guarantee</small></p> <p><small>ivanky@support.com</small></p> <p><small>www.ivanky.com</small></p>	<p>iVANKY FusionDock Pro 1: Product Details, Usage Tips, and Warranty Information</p> <p>A comprehensive guide to the iVANKY FusionDock Pro 1 docking station, covering installation of DisplayLink drivers for triple display on macOS, troubleshooting common issues, and details of the 18-month limited warranty.</p>
	<p>iVANKY Fusion Wireless Charger Pro 1st Gen (VEA02) User Manual</p> <p>Official user manual for the iVANKY Fusion Wireless Charger Pro (1st Gen, model VEA02). Learn about product introduction, components, specifications, usage instructions, precautions, and troubleshooting.</p>