



Manuals.plus /

› KIDLEDUCT /

› KIDLEDUCT WS001 Wireless Remote Sensor Instruction Manual

KIDLEDUCT TR02

KIDLEDUCT WS001 Wireless Remote Sensor Instruction Manual

Model: TR02

[Introduction](#)

[Setup](#)

[Operation](#)

[Maintenance](#)

[Troubleshooting](#)

[Specifications](#)

[Support](#)

1. INTRODUCTION

This manual provides instructions for the KIDLEDUCT TR02 Wireless Remote Sensor, designed for use with the WS001 base station. This sensor measures and displays outdoor temperature and humidity, transmitting data wirelessly to a compatible base station.

Key features include:

- Compatibility with KIDLEDUCT WS001 model only.
- Temperature display in Celsius (°C) or Fahrenheit (°F).
- Integrated wall mount and table stand for flexible placement.
- Wireless transmission range up to 330 feet (100 meters) in open air.



Figure 1: Front view of the KIDLEDUCT TR02 Wireless Remote Sensor.

2. SETUP

2.1 Package Contents

- KIDLEDUCT TR02 Wireless Remote Sensor
- Instruction Manual (this document)

Note: 2 x AA batteries are required and not included.

2.2 Battery Installation

1. Locate the battery compartment cover on the back of the sensor.
2. Remove the cover by sliding it downwards or unlatching it.
3. Insert two (2) AA batteries, ensuring correct polarity (+ and -).
4. Replace the battery compartment cover.

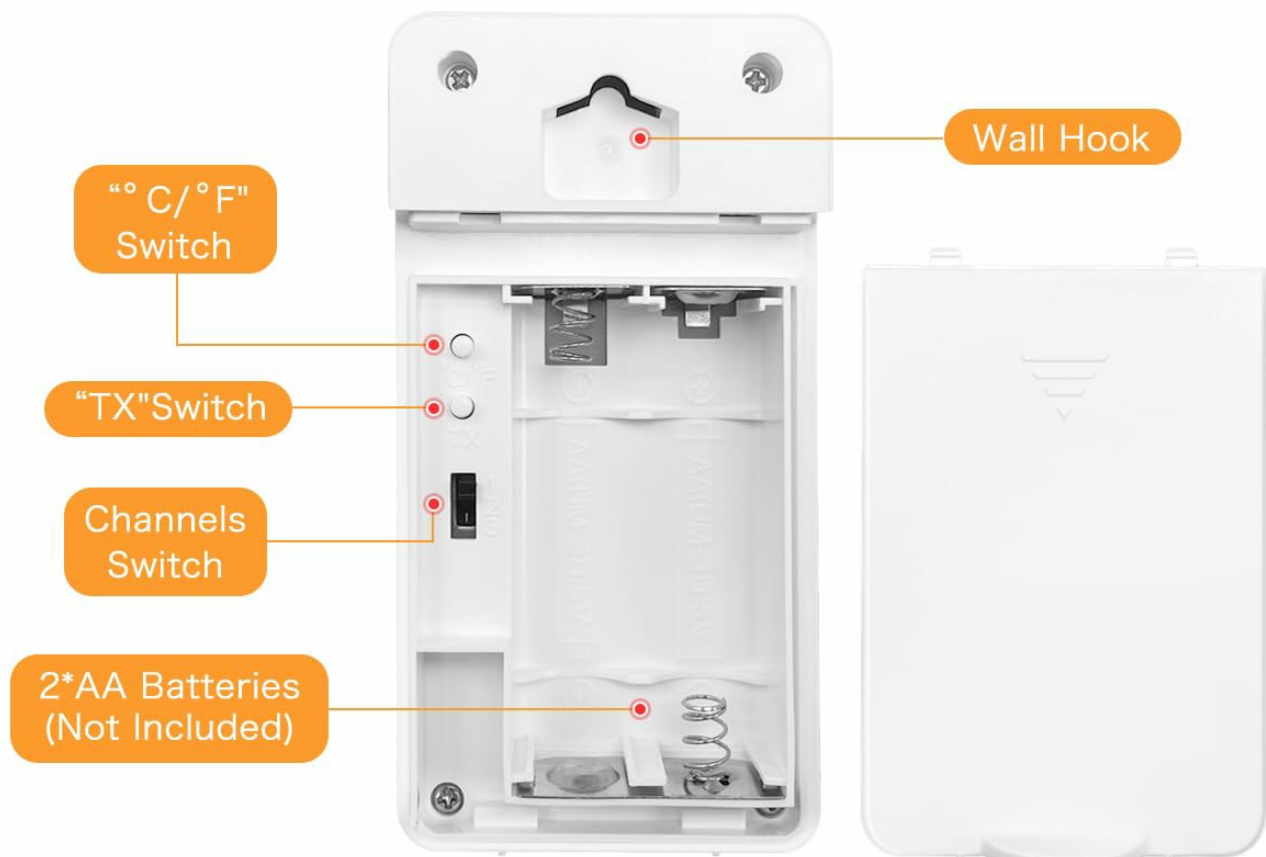

Figure 2: Back view of the sensor, illustrating the battery compartment, C/F switch, TX switch, and Channel switch.

2.3 Channel Selection

The sensor supports multiple channels to avoid interference if you are using more than one remote sensor. Locate the "Channels Switch" inside the battery compartment (refer to Figure 2). Set the switch to your desired channel (e.g., 1, 2, or 3). Ensure this channel matches the channel selected on your WS001 base station for this sensor.

2.4 Pairing with WS001 Base Station

To establish a connection between the remote sensor and your WS001 base station:

1. Ensure batteries are installed in the remote sensor and the channel is selected.
2. If your base station is already running, it is recommended to power cycle it. Unplug the base station, wait several seconds, then plug it back in. The base station typically searches for remote sensors upon startup.
3. Press the "TX" (Transmit) button located inside the battery compartment of the remote sensor (refer to Figure 2). The transmit signal LED on the front of the sensor will flash.
4. The base station should now display readings from the remote sensor on the selected channel. If not, repeat steps 2 and 3.

Note: After restarting the base station, you may need to reset its time zone or other settings.

2.5 Mounting the Sensor

For accurate readings and optimal performance, consider the following mounting guidelines:

- Mount the sensor vertically.
- Choose a location that is well-shaded and protected from direct sunlight and rain. Direct sunlight can cause temperature readings to be inaccurately high.
- Recommended locations include a North-facing wall, 6 inches below eaves, or under a deck rail.
- Ensure the sensor is within the maximum transmission range of 330 feet (100 meters) from the base station. Walls, floors, and other obstructions can reduce this range.

3. OPERATION

3.1 Display Overview



Figure 3: Sensor display with indicators for outdoor temperature, outdoor humidity, and transmit signal LED.

The sensor's front display shows the current outdoor temperature and humidity. A small LED indicates when a signal is being transmitted.

3.2 Temperature Unit Selection (°C/°F)

To switch between Celsius and Fahrenheit temperature units, locate the "C/°F Switch" inside the battery compartment (refer to Figure 2). Use a small pointed object (like a pen tip) to toggle the switch to your preferred unit.

3.3 Manual Data Transmission

The sensor automatically transmits data periodically. If you wish to force an immediate data transmission, press the "TX" button inside the battery compartment (refer to Figure 2). The transmit signal LED will flash, indicating data has been sent.

4. MAINTENANCE

4.1 Battery Replacement

When the display on the sensor becomes dim or stops updating, it is time to replace the batteries. Follow the steps in Section 2.2 "Battery Installation" to replace the two (2) AA batteries. Always replace both batteries at the same time with new ones.

4.2 Cleaning

To clean the sensor, wipe it with a soft, damp cloth. Do not use abrasive cleaners or solvents, as these may damage the casing or electronic components. Ensure no moisture enters the battery compartment or other openings.

5. TROUBLESHOOTING

Problem	Possible Cause	Solution
No readings on base station / Sensor not connecting.	<ul style="list-style-type: none"> • Incorrect channel selection. • Sensor out of range. • Low or dead batteries. • Base station not searching for sensors. • Interference. 	<ul style="list-style-type: none"> • Ensure the channel switch on the sensor matches the channel set on the base station. • Move the sensor closer to the base station. • Replace batteries in the sensor. • Power cycle the base station (unplug, wait, plug back in) and then press the "TX" button on the sensor. • Relocate the sensor or base station away from potential sources of interference (e.g., large metal objects, other wireless devices).
Inaccurate temperature readings.	<ul style="list-style-type: none"> • Sensor exposed to direct sunlight. • Sensor near a heat source or vent. 	<ul style="list-style-type: none"> • Relocate the sensor to a shaded area, such as a North-facing wall, under eaves, or a deck rail. • Ensure the sensor is not placed near appliances or vents that emit heat.
Sensor display is blank or dim.	<ul style="list-style-type: none"> • Low or dead batteries. • Incorrect battery installation. 	<ul style="list-style-type: none"> • Replace both AA batteries with new ones. • Verify that batteries are inserted with correct polarity.

6. SPECIFICATIONS

Feature	Detail
Model Number	TR02
Compatibility	KIDLEDUCT WS001 Base Station
Power Source	2 x AA Batteries (not included)
Transmission Range	Up to 330 ft (100 m) in open air
Mounting Type	Wall Mount, Table Stand
Color	White
Item Weight	0.07 Kilograms (approx. 68 g)
Package Dimensions	10.49 x 6.1 x 4.19 cm

7. WARRANTY AND SUPPORT

7.1 Warranty Information

Specific warranty details for the KIDLEDUCT TR02 Wireless Remote Sensor may vary by region and retailer. Please refer to the documentation provided at the time of purchase or contact your retailer for warranty terms.

7.2 Customer Support

For technical assistance, troubleshooting not covered in this manual, or general inquiries, please contact KIDLEDUCT customer support through their official website or the contact information provided with your purchase.