

**Manuals+**

[Q & A](#) | [Deep Search](#) | [Upload](#)

manuals.plus /

› [Rapoo](#) /

› [Rapoo MT760L Wireless Bluetooth Mouse User Manual](#)

**Rapoo MT760L**

# Rapoo MT760L Wireless Bluetooth Mouse User Manual

Model: MT760L

## 1. PRODUCT OVERVIEW

---

The Rapoo MT760L is a multi-device wireless mouse designed for versatility and comfort. It supports Bluetooth 5.0/3.0 and 2.4GHz wireless connections, allowing seamless switching between up to four devices. Key features include adjustable DPI settings, an ergonomic design, and M+ Cross-Computer Technology for enhanced workflow.



Image: The Rapoo MT760L wireless mouse, showcasing its ergonomic shape and the two included USB dongles.

### Package Contents:

- 1 x Rapoo MT760L Wireless Mouse
- 1 x USB-C Charging Cable (USB-A to USB-C)
- 2 x USB Dongles
- 1 x User Manual (this document)

## 2. SETUP

---

### 2.1 Charging the Mouse

Before initial use, fully charge the mouse. Connect the provided USB-C charging cable to the mouse's USB-

C port and the other end to a USB power source (e.g., computer USB port, wall adapter). The green LED indicator will turn on during charging and turn off when fully charged. A full charge typically takes 3 hours and provides up to 90 days of usage, depending on frequency and device conditions.



Image: The Rapoo MT760L mouse being charged via its USB-C port, illustrating the charging process and battery life.

## 2.2 Connecting via 2.4GHz USB Dongle

1. Locate the USB dongle(s) stored in the magnetic absorption compartment at the bottom of the mouse.
2. Turn on the mouse using the power switch located on the bottom.
3. Plug one of the USB dongles into an available USB-A port on your computer.
4. The mouse should automatically connect. The 2.4G connection indicator LED will be off, indicating a successful connection.

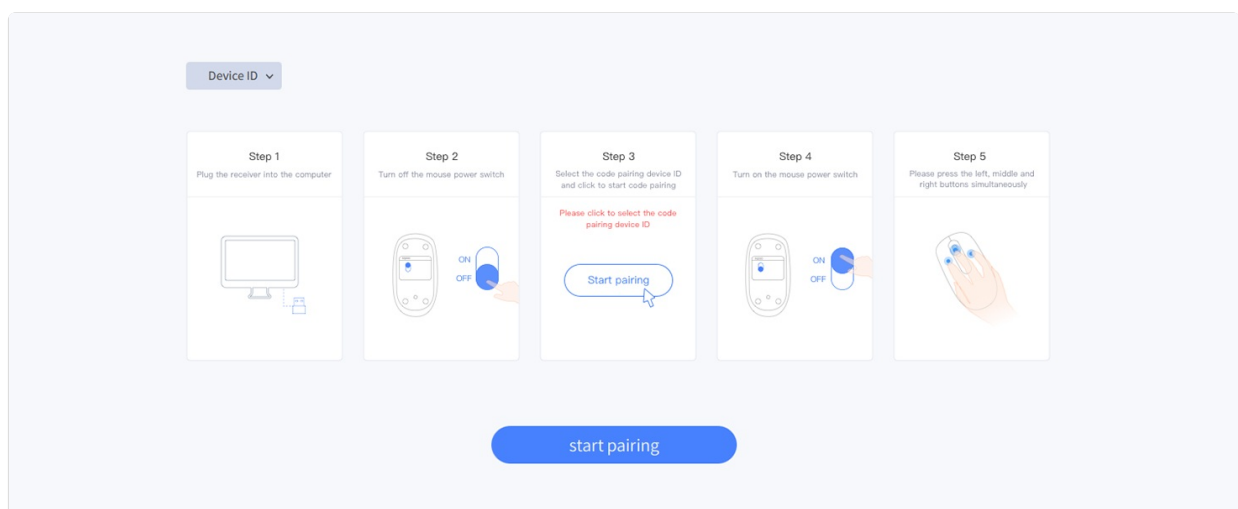

Image: A step-by-step diagram illustrating how to pair the mouse using the 2.4GHz USB dongle, including turning on the mouse and plugging in the receiver.

## 2.3 Connecting via Bluetooth (BT 3.0/5.0)

The MT760L supports up to three Bluetooth connections.

1. Turn on the MT760L mouse. The device light will start to blink rapidly.
2. Press the device switch button (located on the bottom of the mouse) to select the desired Bluetooth channel (1, 2, or 3). The corresponding indicator LED will start to blink fast.
3. Keep pressing the device switch button for at least 3 seconds to enter Bluetooth pairing mode. The selected channel's indicator LED will flash slowly.
4. On your device (computer, laptop, cell phone, iPad), go to Bluetooth settings and search for available devices. Select "Rapoo MT760L" to connect.
5. Once connected, the blinking will stop.

## BLUETOOTH3.0 AND 5.0

1. Turn on Mt760L. Device light starts to blink rapidly.
2. Press the device switch button to select the device channel.
3. Keep Pressing the device switch button at least 3 seconds to Bluetooth pairing. Blinking stops.
4. Connect the mouse with your Bluetooth device. Blinking stops.
5. Done. Bluetooth compatibility of the product is related to the host device and the installed software version. The product may be partially incompatible.

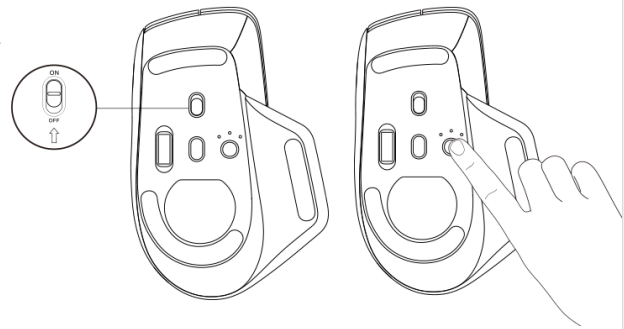

Image: A diagram illustrating the Bluetooth pairing process for the Rapoo MT760L, showing the device switch button and LED indicators.

## 2.4 M+ Cross-Computer Technology Setup

This feature allows seamless control and file transfer between multiple computers. It requires the installation of specific software and a shared network connection.

1. Download and install the Rapoo M+ software from the official Rapoo website ([rapoo.com/search?kw=MT760](http://rapoo.com/search?kw=MT760)) on all computers you wish to connect. This function is compatible with Windows systems only.
2. Ensure all connected computers are on the same Wi-Fi or Ethernet network.
3. Follow the instructions within the M+ software to configure cross-computer control and file transfer settings.



Image: An illustration demonstrating the M+ Cross-Computer Technology, showing a mouse controlling two separate computers and transferring files between them.

## 3. OPERATING INSTRUCTIONS

### 3.1 Button Functions

- **Left/Right Click Buttons:** Standard mouse functions.
- **Scroll Wheel (Center):** Used for vertical scrolling.
- **DPI Button:** Located below the center scroll wheel. Press to cycle through DPI settings.

- **Side Scroll Wheel:** Located on the left side. Used for horizontal scrolling in compatible applications.
- **Forward/Back Buttons:** Located below the side scroll wheel. Used for navigation in web browsers and file explorers.

## 8 Programmable Buttons



Note: This function is only compatible with Windows systems.

Image: The Rapoo MT760L mouse with labels indicating its 8 programmable buttons, including the main clicks, scroll wheels, and side buttons.

### 3.2 Adjusting DPI

The mouse offers four adjustable DPI (Dots Per Inch) levels: 600, 1200, 1600, and 3200. Press the DPI button to cycle through these settings. The green LED indicator will blink once for 600 DPI, twice for 1200 DPI, three times for 1600 DPI, and four times for 3200 DPI.

# 4 ADJUSTABLE DPI LEVELS



Image: A circular diagram illustrating the four adjustable DPI levels (600, 1200, 1600, 3200) available on the Rapoo MT760L mouse.

## 3.3 Switching Between Devices

To switch between connected Bluetooth devices, press the device switch button on the bottom of the mouse. The corresponding LED (1, 2, or 3) will illuminate to indicate the active connection. For 2.4GHz connections, if using M+ Cross-Computer Technology, simply move the cursor to the edge of the screen to switch between computers.



Image: The underside of the Rapoo MT760L mouse, highlighting the device switch button and the compartment for storing the USB dongle.

### 3.4 M+ Cross-Computer Technology Usage

Once configured with the M+ software, you can seamlessly move your mouse cursor from one computer screen to another by simply moving it to the edge of the display. This also enables direct transfer of text, images, and files between the connected computers (requires both computers to be on the same network).

### 3.5 Surface Compatibility

The MT760L utilizes a high-performance laser sensor, providing precise tracking on various surfaces such as wood, metal, cloth, plastic, and paper. It is not suitable for use on glass or mirror surfaces.



# Works On Most Surfaces

Based on PixArt Laser technology,  
it can be used on surfaces such as leather, paper, resin, etc



Image: The Rapoo MT760L mouse positioned on a textured surface, with icons indicating its compatibility with materials like wood, resin, leather, and paper.

## 4. MAINTENANCE

### 4.1 Cleaning

To clean the mouse, use a soft, dry cloth. For stubborn dirt, a slightly damp cloth can be used, ensuring no moisture enters the device. Avoid using harsh chemicals or abrasive materials.

### 4.2 Battery Care

The mouse is equipped with an 800mAh Li-Po rechargeable battery. To prolong battery life, avoid exposing the mouse to extreme temperatures. Charge the mouse when the low power indicator (green LED blinks) is active.

## 5. TROUBLESHOOTING

- **Mouse not connecting:**

Ensure the mouse is powered on. For 2.4GHz, check if the USB dongle is securely plugged into the



computer. For Bluetooth, verify the mouse is in pairing mode and selected on your device's Bluetooth settings. Try re-pairing the mouse.

- **Erratic scrolling:**  
Ensure the mouse sensor is clean. If using M+ software, ensure it is updated to the latest version. Try re-pairing the mouse or connecting to a different USB port/Bluetooth channel.
- **M+ Cross-Computer Technology not working:**  
Confirm that the Rapoo M+ software is installed on all computers and that all computers are connected to the same network (Wi-Fi or Ethernet). Ensure the software is running and configured correctly.
- **DPI not changing:**  
Press the DPI button firmly. Observe the green LED indicator for feedback on DPI level changes.
- **Buttons not responding:**  
Check battery level. If the issue persists, try re-pairing the mouse or restarting your computer.

## 6. SPECIFICATIONS

Feature	Detail
Model Number	MT760L
Product Dimensions	3.94 x 3.15 x 1.97 inches (100 x 80 x 50 mm)
Item Weight	3.53 ounces (100 g)
Connectivity Technology	Bluetooth 5.0/3.0, 2.4GHz Wireless
Movement Detection	Laser
Adjustable DPI	600, 1200, 1600, 3200
Programmable Buttons	8
Battery Type	800mAh Lithium Polymer (Li-Po)
Charging Port	USB-C
Battery Life	Up to 90 days (varies with usage)
Special Features	Ergonomic Design, Portable, Rechargeable, M+ Cross-Computer Technology, Side Scroll Wheel

# WIDE COMPATIBILITY



Windows



Mac OS



Android



Weight: 3.74oz / 106g

Image: The Rapoo MT760L mouse shown with its physical dimensions and compatibility icons for Windows, Mac OS, and Android operating systems.

## 7. WARRANTY AND SUPPORT

### 7.1 Warranty Information







For detailed warranty information, please refer to the product packaging or visit the official Rapoo website. Warranty terms and conditions may vary by region.

### 7.2 Technical Support and Drivers

For technical assistance, driver downloads, and software updates (including M+ software), please visit the official Rapoo support website:

<https://www.rapoo.com/search?kw=MT760>

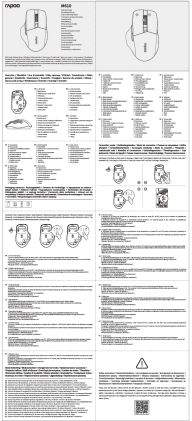
## Related Documents - MT760L

	<p><a href="#">Rapoo MT760L/MT760M Multi-mode Wireless Mouse User Manual</a></p> <p>Comprehensive user manual for the Rapoo MT760L and MT760M multi-mode wireless mice. Learn about features, setup, connection modes (2.4GHz, Bluetooth), DPI settings, and ergonomic design for enhanced productivity.</p>
	<p><a href="#">Rapoo MT760L Multi-Mode Wireless Mouse User Manual</a></p> <p>This document provides instructions and specifications for the Rapoo MT760L Multi-Mode Wireless Mouse, covering setup, features, and troubleshooting.</p>
	<p><a href="#">Rapoo MT760L/MT760M Wireless Mouse User Manual</a></p> <p>User manual for the Rapoo MT760L and MT760M wireless optical mice, detailing features, setup, and usage.</p>
	<p><a href="#">Rapoo MT760L/MT760M Mouse User Manual</a></p> <p>User manual for the Rapoo MT760L and MT760M wireless mice, providing setup, usage, and troubleshooting information.</p>
	<p><a href="#">Rapoo M610 Multi-mode Wireless Mouse Quick Start Guide</a></p> <p>Concise guide to setting up and using the Rapoo M610 multi-mode wireless mouse, covering connection modes, device switching, and basic operation for optimal performance.</p>
	<p><a href="#">Rapoo M200 Multi-Mode Wireless Mouse: Connection Guide and FCC Compliance</a></p> <p>User guide for the Rapoo M200 multi-mode wireless mouse, detailing 2.4GHz and Bluetooth connection steps, indicator light meanings, and FCC compliance information.</p>



[pdf] Quick Start Guide Datasheet Guide

Gergana Valcheva MT760L 9 nov 2024 — USB charging cable Quick Start Guide Adjustable 4000 DPI HD sensor 10 mouse Windows® XP Vista 7 8 11 Bluetooth 2 4GHz switch button keyboard 922488 Data Sheet ENG turascandinavia storage

C3CB4CFEDA61EE39FD8E750A696340D9554839FCEC5C5B46A2ABE4F06AC4F4D3

b752128d289d4587bb8cc16efb6650dd media dcc70defc1734e95ac45feb608c4e4c4 |||

Multi-Mode Wireless Mouse **MT760L** Multi-mode Wireless connection Automatically switch among multiple devices 4000 Adjustable 4000 DPI HD sensor Eco-friendly rechargeable battery More information at [www.rapoo-eu.com](http://www.rapoo-eu.com) Multi-Mode Wireless Mouse **MT760L** This advanced wireless mouse offers superior comfo...

lang:en score:37 filesize: 288.34 K page\_count: 2 document date: 2023-11-30



[pdf]

ЕС ДЕКЛАРАЦИЯ ЗА СЪОТВЕТСТВИЕ NeoxShop czIdentifikace výrobku Wireless Mouse MT760L Grey Black V příloze A najdete seznam všech výrobků na něž se toto prohlášení vztahujeCE

MT760Lneoxshop.cz images CE Rapoo |||

E EN ISO/IEC 17 ... 27 2665 PC Bleiswijk Netherlands : Wireless Mouse **MT760L** Grey Black , ...

lang:en score:36 filesize: 405.47 K page\_count: 46 document date: 2024-03-19



[pdf]

Gergana Valcheva MT760L Sie verfügt über die Multimodus Funkverbindung von Rapoo mittels einer zuverlässigen 2 4 GHz Funkübertragung Bluetooth 0 oder 5 und RAPOO DB DE cdn reichelt de documents datenblatt E500 |||

Kabellose Multimodus-Maus **MT760L** Multimodus-Funkverbindung Automatisches Umschalten zwischen mehreren Gerten 4000 Einstellbarer HD-Sensor mit 4000 DPI Umweltfreundlicher Akku Mehr Informationen unter [www.rapoo-eu.com](http://www.rapoo-eu.com) Kabellose Multimodus-Maus **MT760L** Diese fortschrittliche kabellose Maus bietet be...

lang:de score:34 filesize: 258.35 K page\_count: 2 document date: 2023-11-30



[\[pdf\]](#) Declaration of Conformity

Download MT760L Rapoo eu doc 2620393 20240319 rapoo 2024 03 |||

E EN ISO/IEC 17050-1 : DOCIP 2620393 / EU-AR: Rapoo Europe B.V. Prismalaan West 27 2665 PC Bleiswijk Netherlands : : Rapoo Europe B.V. Prismalaan West 27 2665 PC Bleiswijk Netherlands : Wireless Mouse MT760M Grey Black , , . A : : Restricti...

lang:en score:27 filesize: 404.71 K page\_count: 46 document date: 2024-03-19



[\[pdf\]](#) Declaration of Conformity

eu doc 2620387 20240319 secure productip public view get document id 11795137 |||

E EN ISO/IEC 17050-1 : DOCIP 2620387 / EU-AR: Rapoo Europe B.V. Prismalaan West 27 2665 PC Bleiswijk Netherlands : : Rapoo Europe B.V. Prismalaan West 27 2665 PC Bleiswijk Netherlands : Wireless Mouse **MT760L** Grey Black , , . A : : Restricti...

lang:en score:25 filesize: 405.47 K page\_count: 46 document date: 2024-03-19

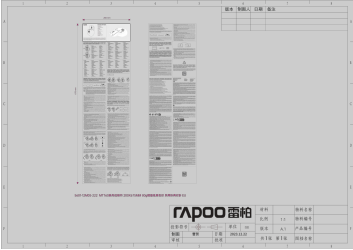

[Rapoo MT760L/MT760M Mouse User Manual](#)

User manual for the Rapoo MT760L and MT760M wireless mice, providing setup, usage, and troubleshooting information.

lang:en score:18 filesize: 4.67 M page\_count: 1 document date: 2024-03-25



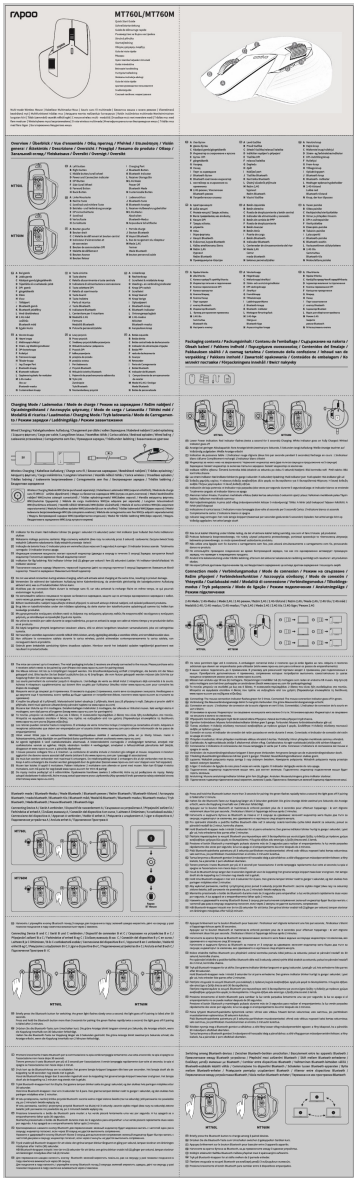

[Rapoo WM1 Wireless Charging Module Quick Start Guide and Compliance Information](#)

A concise guide to the Rapoo WM1 Wireless Charging Module, including setup, safety instructions, conformity information, and disposal guidelines, presented in an SEO-optimized HTML format.

lang:en score:16 filesize: 14.28 M page\_count: 7 document date: 2024-08-13

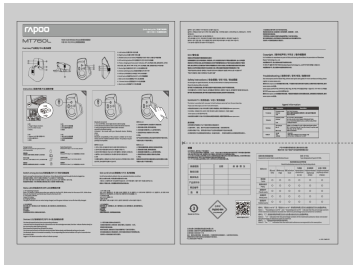

### [Rapoo MT760L Multi-Mode Wireless Mouse User Manual](#)

This document provides instructions and specifications for the Rapoo MT760L Multi-Mode Wireless Mouse, covering setup, features, and troubleshooting.

lang:en **score:15** filesize: 1.63 M page\_count: 1 document date: 2023-08-02



### [\[pdf\] Catalog](#)

NEUHEITEN FÜR BUSINESS UND PRIVAT 1 099 95 Mit dem PiEnergy Mini können Sie Ihren Raspberry Pi mit einer Spannung ECOVACS WINBOT W2 Fensterputzroboter Fensterreinigung so effizient sicher complete cdn reichelt de bilder blaetterkatalog BL092024 catalogs BL 2024 09 ||| elektronik The best part of your project BEST OF REICHELTE THE BEST PART OF YOUR PROJECT NEUHEITEN ... 80SRO LOGITECH K380SSW LOGITECH K380SWS 52,95 49,95 48,95 Farbe rosa schwarz wei Multimodus-Maus **MT760L** Automatisches Umschalten zwischen mehreren Gerten Die **MT760L** koppelt das Arbeitsgert automati...

lang:de **score:9** filesize: 24.8 M page\_count: 52 document date: 2024-09-03