

Koda LM030164-1

Koda LED Power Failure Nightlight/Flashlight (3-Pack) Instruction Manual

Model: LM030164-1



INTRODUCTION

This manual provides detailed instructions for the Koda LED Power Failure Nightlight/Flashlight. This versatile 3-in-1 device functions as an automatic nightlight, an emergency light during power outages, and a portable handheld flashlight. Please read these instructions carefully before use to ensure proper operation and safety.

WHAT'S IN THE BOX

- 3 x Koda LED Power Failure Nightlight / Flashlight units



Image: Three Koda LED Power Failure Nightlight/Flashlights, illustrating the product package contents.

PRODUCT OVERVIEW

The Koda LED Power Failure Nightlight/Flashlight features a compact design with multiple functionalities. It includes a light panel, a power button, a motion sensor, and a retractable plug for wall mounting and portability.

A nightlight, emergency light, & portable flashlight all in one!



Image: Diagram illustrating the dimensions of the Koda LED Power Failure Nightlight/Flashlight (5.47 in / 13.9 cm height, 1.65 in / 4.2 cm width, 1.3 in / 3.3 cm depth).

Key Features



Automatic Nightlight



Automatic ON
During Power Failure



Portable Handheld Flashlight



Motion Sensor &
Dark-Detection Sensor

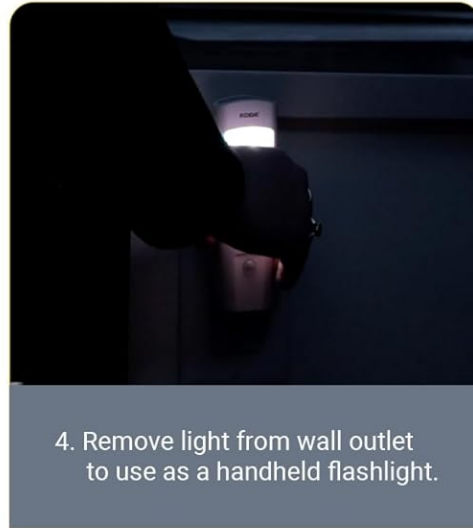
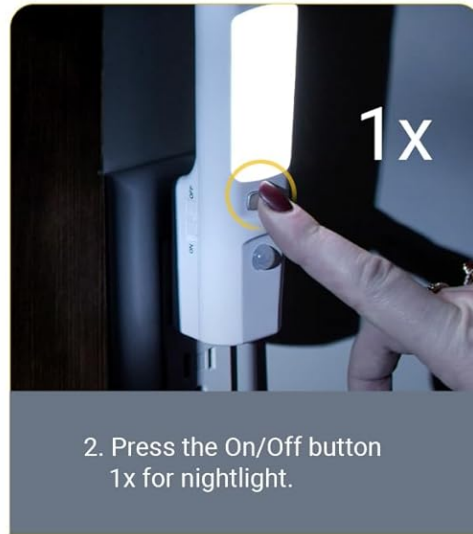
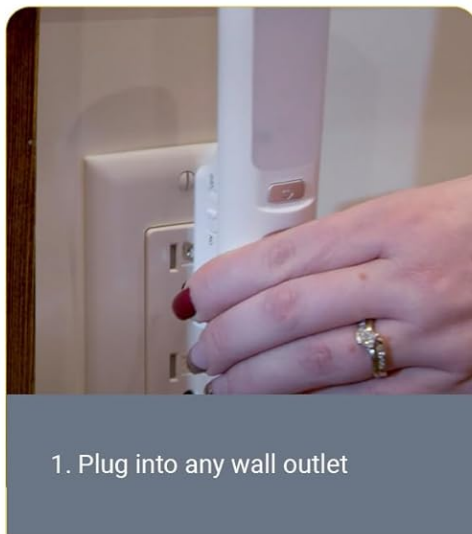

Image: Visual summary of key features including Automatic Nightlight, Automatic ON During Power Failure, Portable Handheld Flashlight, and Motion Sensor & Dark-Detection Sensor.

SETUP

1. **Plug into Wall Outlet:** Insert the retractable plug into any standard 120V AC wall outlet. Ensure the unit is securely seated. The device will begin charging its internal battery.
2. **Initial Charge:** For optimal performance, allow the unit to charge for at least 24 hours before first use or after an extended period of non-use.

Easy Installation



*For additional light settings and to activate motion sensor, please see product manual.

Image: Step-by-step guide showing how to plug the device into an outlet and activate nightlight or flashlight modes.

OPERATING INSTRUCTIONS

Nightlight Mode (Motion Sensor & Dark-Detection)

- With the unit plugged into a wall outlet, press the power button once. The nightlight will activate.
- The integrated dark-detection sensor will automatically turn on the nightlight when the ambient light is low.
- The motion sensor will detect movement in its range and increase the brightness of the nightlight for a short period, then dim back down when no motion is detected.

An automatic emergency light during power failure



Image: The Koda LED Nightlight functioning in a kitchen setting, providing soft illumination.

Power Failure Mode

- When plugged into an active outlet, the device continuously monitors for power interruptions.
- In the event of a power outage, the front panel will automatically illuminate at full brightness, providing immediate emergency lighting.
- The internal rechargeable battery provides up to 3 hours of continuous light during a power failure.

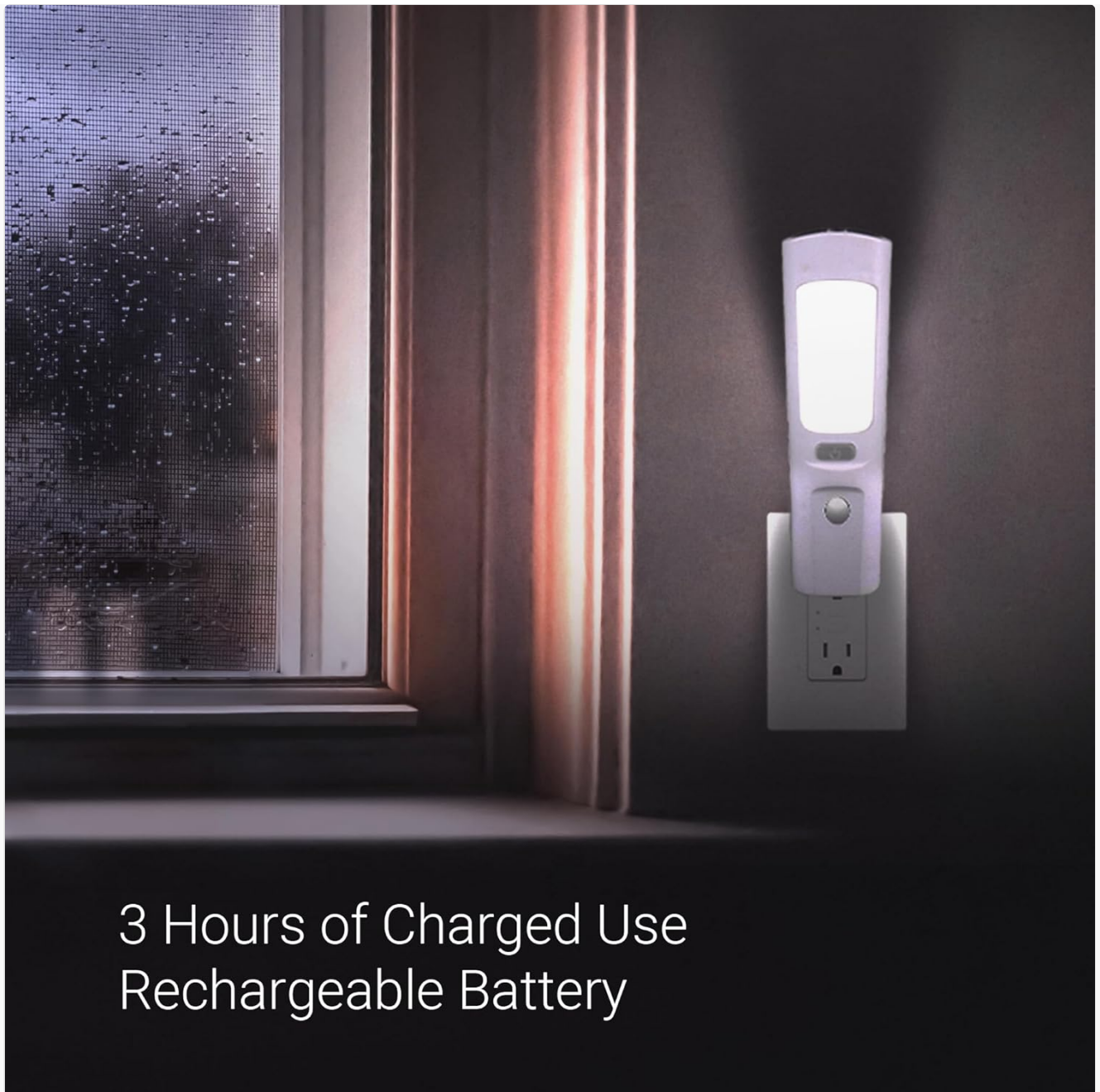

3 Hours of Charged Use Rechargeable Battery

Image: The Kodu LED Nightlight plugged into an outlet, highlighting its rechargeable battery and 3-hour runtime.

Handheld Flashlight Mode

- To use as a handheld flashlight, simply unplug the unit from the wall outlet.
- Press the power button twice to activate the flashlight function.
- The retractable plug can be folded into the unit for a more comfortable grip.

Your browser does not support the video tag.

Video: This video demonstrates the Kodu LED Power Failure Nightlight/Flashlight's 3-in-1 functionality, including how it charges in a standard outlet, its light-sensing automatic night mode, motion detection, automatic illumination during power outages, and its use as a handheld flashlight.

MAINTENANCE

- **Cleaning:** Wipe the unit with a soft, dry cloth. Do not use abrasive cleaners or solvents.
- **Battery Care:** To maintain battery health, ensure the unit is regularly plugged into an outlet for charging. If stored for extended periods, charge the unit every 3-6 months.

- **Indoor Use Only:** This device is designed for indoor use. Do not expose to water or extreme temperatures.

TROUBLESHOOTING

| Problem | Possible Cause | Solution |
|---|--|---|
| Nightlight does not turn on in the dark. | Insufficient darkness detected by the photo sensor. | Ensure the area is sufficiently dark. The sensor may require very low light levels to activate. Relocate to a darker area if necessary. |
| Motion sensor not activating. | Motion sensor switch is off or obstructed. | Check the side switch to ensure the motion sensor is enabled. Clear any obstructions from the sensor's view. |
| Light does not turn on during a power outage. | Battery is not charged or unit is not properly plugged in. | Ensure the unit is continuously plugged into a working outlet to keep the battery charged. Allow 24 hours for a full charge. |
| Flashlight mode not working. | Incorrect button press or low battery. | Press the power button twice quickly to activate flashlight mode. Ensure the unit is charged. |
| Short battery life in flashlight or power failure mode. | Battery not fully charged or aging battery. | Ensure the unit is consistently plugged in for charging. Battery life may decrease over time with repeated use. |

SPECIFICATIONS

- **Model Number:** LM030164-1
- **Power Source:** Corded Electric (Plug-in)
- **Light Source Type:** LED
- **Number of Light Sources:** 2
- **Flashlight Output:** 30 lumens
- **Battery:** 1 Lithium Ion battery required (internal, rechargeable)
- **Battery Size:** 83.7V, 250 mAh
- **Battery Run Time (fully charged):** Up to 3 hours
- **Power Consumption:** 0.49 Watts
- **Efficiency:** 61 lumens per watt
- **Product Dimensions:** 6.5"D x 6.5"W x 2"H (approximate)
- **Item Weight:** 12 ounces
- **Indoor/Outdoor Usage:** Indoor
- **Water Resistance Level:** Water Resistant (not waterproof)
- **UPC:** 840010301649

SAFETY INFORMATION

- Do not disassemble or modify the device.
- Keep away from water and moisture.
- Do not expose to open flames or extreme temperatures.
- Ensure the unit is securely plugged into a functional outlet.

- This product contains a lithium-ion battery. Dispose of responsibly according to local regulations.

WARRANTY AND SUPPORT

For warranty information or technical support, please refer to the Koda product packaging or visit the official Koda website. Contact information for customer service is typically provided with your purchase documentation.

