

VAIS Technology GSR-GM05-w/Tuner Kit

VAIS Technology GSR-GM05-w/Tuner Kit SiriusXM Satellite Radio Add-on Adapter Instruction Manual

Model: GSR-GM05-w/Tuner Kit

1. INTRODUCTION

The VAIS Technology GSR-GM05-w/Tuner Kit is designed to seamlessly integrate SiriusXM Satellite Radio into your vehicle's existing factory radio system. This adapter preserves the original aesthetic and functionality of your vehicle's dashboard by eliminating the need for additional mounts or FM modulation adapters. Enjoy a vast array of music, sports, news, and entertainment channels through your factory radio controls.

2. WHAT'S INCLUDED

The GSR-GM05-w/Tuner Kit includes the following components:

- GSR Interface Adapter
- GSR USB Cable
- Power Harness
- Vehicle Antenna
- SiriusXM Tuner SXV300

What's Included

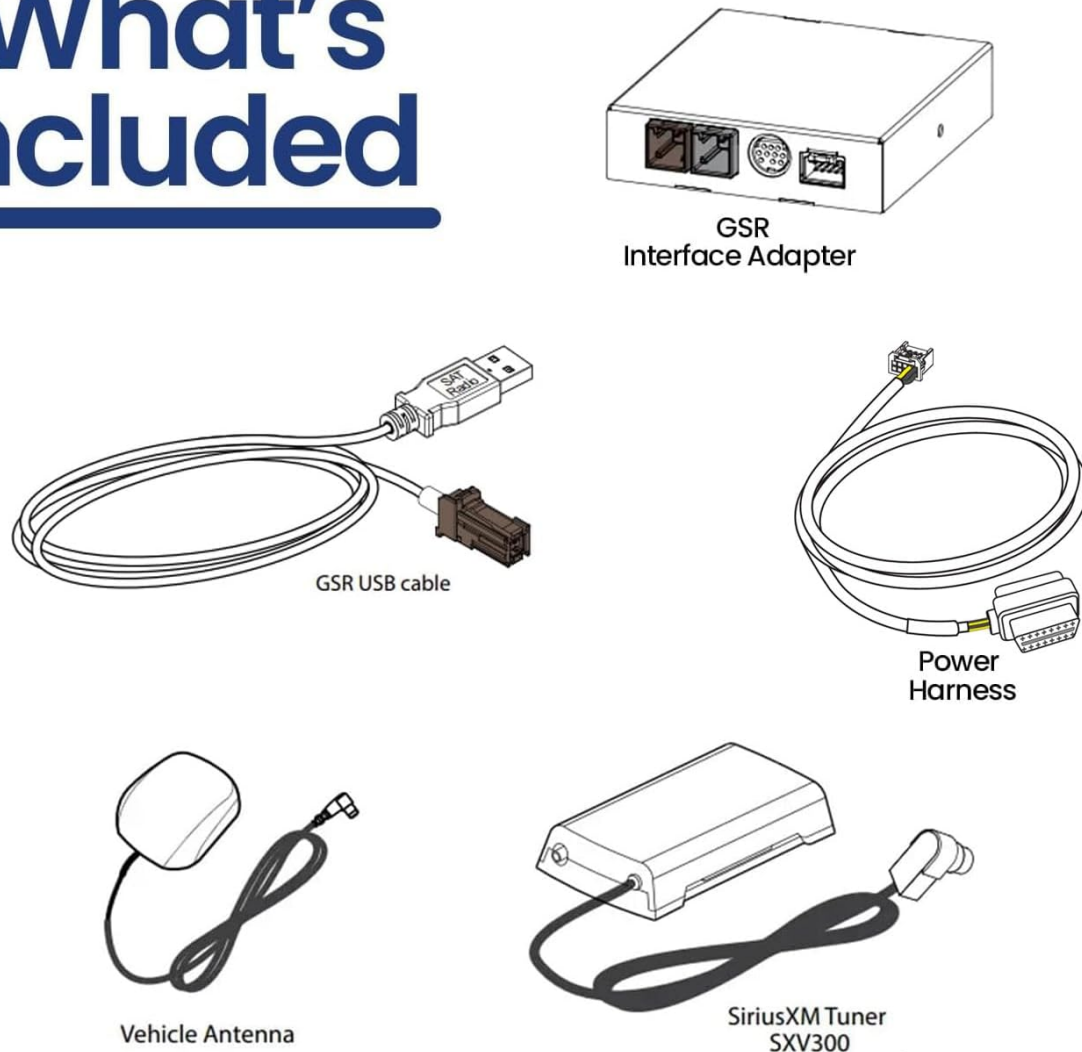

**Vehicle Antenna
and SiriusXM Tuner
SXV300 are included
in GSR-TKIT only**

Figure 2.1: All components included in the VAIS Technology GSR-GM05-w/Tuner Kit. This includes the GSR Interface Adapter, GSR USB cable, Power Harness, Vehicle Antenna, and SiriusXM Tuner SXV300.

3. PRODUCT OVERVIEW: GSR CONNECTORS AND PORTS

Familiarize yourself with the connectors and ports on the GSR Interface Adapter:

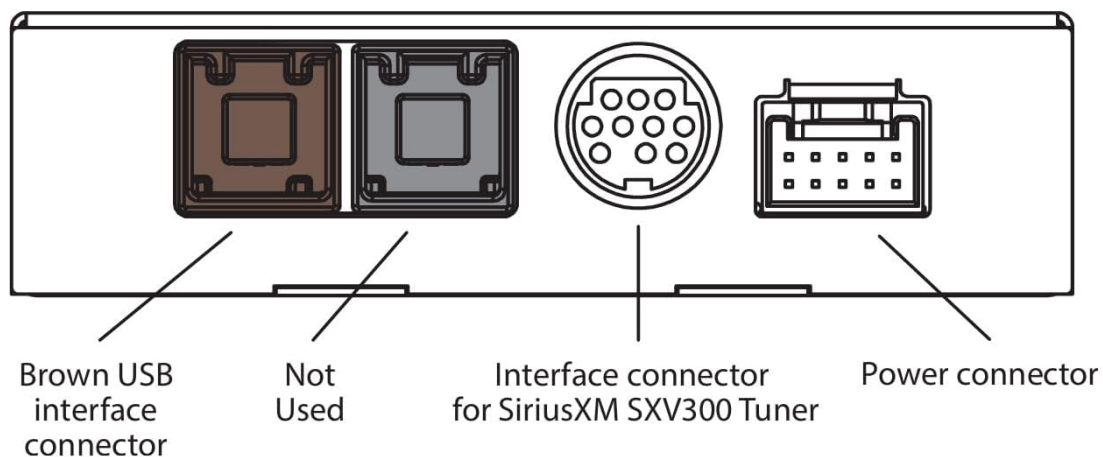

GSR

Connectors and Ports

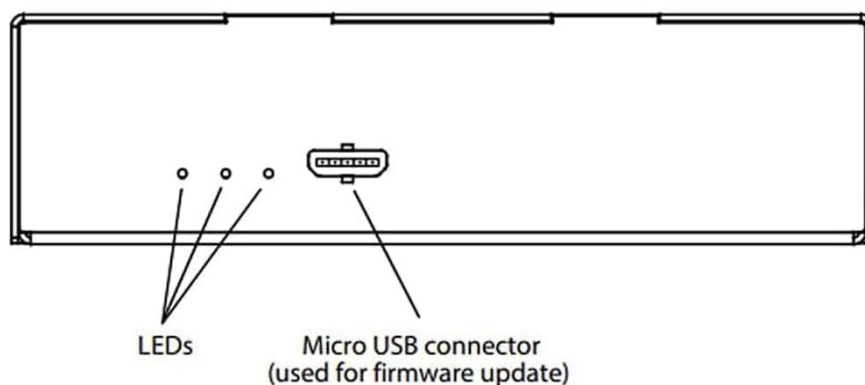

Figure 3.1: Front and rear views of the GSR Interface Adapter, detailing the Brown USB interface connector, a port labeled 'Not Used', the Interface connector for SiriusXM SXV300 Tuner, the Power connector, LED indicators, and a Micro USB connector for firmware updates.

4. COMPATIBILITY

The VAIS GSR-GM05 is specifically designed for select Factory GM models. Ensure your vehicle model is listed below for proper functionality:

- Camaro (2022-2023) - With Factory USB
- Malibu (2021-2025) - With Touch Screen and Factory USB
- Silverado/Sierra (2022 Sierra) - With Factory USB
- Silverado/Sierra (2023-2025) - With Factory USB
- Suburban/Tahoe (2021-2024) - With Factory USB
- Trailblazer (2021) - With Wireless CarPlay

VAIS Technology SiriusXM Integration Application Guide

Compatible with Select GM Model

GM				
	Blazer	2019-2021	With Factory USB	GSR-GM03
	Camaro	2019-2021	Without Wireless CarPlay	GSR-GM03
		2022-2023	With Factory USB	GSR-GM05
	Colorado/Canyon	2016-2017	7" Screen with USB port (NOT 4.2" screen)	GSR-GM01
		2018		GSR-GM02
		2019-2021	With Touch Screen and Factory USB	GSR-GM03
		2016-2017		GSR-GM01
	Cruze	2018		GSR-GM02
		2019		GSR-GM03
	Equinox	2018		GSR-GM01
		2019-2021		GSR-GM03
	Enclave	2019		GSR-GM04
	Encore GX	2020		GSR-GM03
		2016-2017		GSR-GM01
	Malibu	2018		GSR-GM02
		2019-2020		GSR-GM03
		2021-2025		GSR-GM05
	Regal	2018	With Factory USB	GSR-GM02
		2019-2020		GSR-GM03
		2016-2017	With Touch Screen Radio	GSR-GM01
		2015-2017	With Non Touch Screen Radio	GSR-GM02
		2018	With Factory USB	GSR-GM02
		2019	Classic & 2500HD (Old body style)	GSR-GM02
			All-New Silverado	GSR-GM03
		2020-2021	With Factory USB	GSR-GM03
		2022 Silverado	With Factory USB	GSR-GM03
		2022 Sierra	With Factory USB	GSR-GM05
		2023-2025	With Factory USB	GSR-GM05
	Sonic	2017	With Factory USB	GSR-GM01
		2018-2020		GSR-GM03
	Spark	2017		GSR-GM02
		2018-2022		GSR-GM03
	Suburban/Tahoe	2018-2020		GSR-GM04
		2021-2024		GSR-GM05
	Trailblazer	2021	Without Wireless CarPlay	GSR-GM03
			With Wireless CarPlay	GSR-GM05
	Traverse/Acadia	2018-2019	With Factory USB	GSR-GM02
		2020-2021		GSR-GM03
	Terrain	2018-2021		GSR-GM03
		2016		GSR-GM02
	Trax	2017		GSR-GM01
		2018-2020		GSR-GM03

Figure 4.1: A detailed application guide showing compatibility of VAIS Technology SiriusXM integration with various GM models, including Blazer, Camaro, Colorado/Canyon, Cruze, Equinox, Enclave, Encore GX, Malibu, Regal, Silverado/Sierra, Sonic, Spark, Suburban/Tahoe, Trailblazer, Traverse/Acadia, Terrain, and Trax, along with specific years and required factory features.

5. INSTALLATION

Follow these steps to install your VAIS Technology GSR-GM05-w/Tuner Kit:

1. **Connect OBD II Connector:** Connect the OBD II connector to your vehicle's OBD II port for power.
2. **Connect GSR to Factory USB Port:** Plug the VAIS adapter into the factory USB data port to send SiriusXM data to the radio. This port can typically be found on the dashboard or in the center console.
3. **Install Antenna on the Roof:** For the best Satellite Radio reception, install the antenna on the highest point of the vehicle. It must be mounted outside the vehicle.
4. **Mount Everything Behind the Panels:** Secure the GSR and SiriusXM tuner behind the dash panels.



Connect OBD II Connector

Connect the OBD II connector to the OBD II connection in the vehicle for power



Connect GSR to Factory USB Port to feed SiriusXM

Route and insert the provided USB-A or USB-C cable into the appropriate USB port. This port can typically be found on the dashboard or in the center console.



Install Antenna on the Roof

For the best Satellite Radio reception, install antenna on the highest point of the vehicle, and must be mounted outside the vehicle



Mount Everything Behind the Panels

Mount the GSR and the SiriusXM Vehicle Tuner behind the dash and secure in place

Figure 5.1: Visual guide illustrating the four main installation steps: connecting the OBD II connector, plugging the GSR into the factory USB port, installing the antenna on the vehicle's roof, and mounting the components behind the dash panels.

5.1. Installation Videos

Video 5.1.1: This video demonstrates how to add SiriusXM to your factory original radio using the VAIS adapter, highlighting the seamless integration.

Video 5.1.2: A guide on how to properly install the SiriusXM antenna for optimal reception.

Video 5.1.3: This video illustrates how to add SiriusXM to your factory radio in minutes using a GSR adapter, showcasing the quick and easy process.

6. OPERATING INSTRUCTIONS

Once installed, adding and enjoying SiriusXM is straightforward:

1. Locate the USB port in your vehicle's dashboard where the adapter is connected.
2. Activate your SiriusXM subscription.
3. Turn on your vehicle and select SiriusXM from the source menu on your factory radio.
4. Use your factory radio controls to browse channels, add presets (up to 36), and enjoy SiriusXM content.



Figure 6.1: This image demonstrates the ease of use, showing how to add SiriusXM to your original factory radio using steering wheel controls, browse channels and add presets, and highlights that the unit connects discreetly behind the dash or via USB.

Crafted with precision and advanced technology, this add-on adapter delivers crystal-clear sound reproduction, allowing you to enjoy your favorite SiriusXM channels



Figure 6.2: A dashboard view of a vehicle's infotainment system, displaying various audio sources including AM, FM, Bluetooth, and SXM (SiriusXM), indicating seamless integration.

Navigate through your SiriusXM channels with ease using the intuitive controls and user-friendly interface of the VAIS adapter



Figure 6.3: Another dashboard view of a vehicle's infotainment system, showing SiriusXM as an audio source option, reinforcing the intuitive controls and user-friendly interface of the VAIS adapter for navigating channels.

7. MAINTENANCE

The VAIS Technology GSR-GM05-w/Tuner Kit requires minimal maintenance. Ensure all connections remain secure and free from debris. Periodically check the antenna for any damage or obstructions that might affect signal reception. Keep the interior of your vehicle clean to prevent dust buildup around the installed components.

8. TROUBLESHOOTING

If you encounter issues with your SiriusXM adapter, consider the following:

- **No Signal:** Verify the antenna is correctly mounted on the highest point of the vehicle with a clear view of the sky. Check all cable connections for tightness.
- **No Audio:** Ensure SiriusXM is selected as the audio source on your factory radio. Check the volume levels on both your radio and the SiriusXM system.
- **Intermittent Signal:** Confirm the antenna cable is not pinched or damaged. Avoid placing the antenna near other antennas or obstructions.

- **Subscription Issues:** Contact SiriusXM customer service to verify your subscription status and activation.
- **Adapter Not Recognized:** Ensure the USB data port is functioning correctly and the adapter is securely plugged in.

9. SPECIFICATIONS

Feature	Detail
Product Dimensions	5 x 1 x 9 inches
Item Weight	1 pound (16 ounces)
Model Number	GSR-GM05-w/Tuner Kit
Brand	VAIS Technology
Connectivity Technology	USB
Tuner Technology	Internet Radio
Power Source	DC power supply
Compatible Devices	Factory Radio
UPC	793611840751

10. WARRANTY AND SUPPORT

For warranty information and technical support, please refer to the official VAIS Technology website or contact their customer service directly. Keep your purchase receipt for warranty claims.