

RL LIVE YOUR LIGHT R52121131

User Manual for Reality Leuchten R52121131 Maxi LED Table Lamp

Model: R52121131 | Brand: RL LIVE YOUR LIGHT

1. INTRODUCTION

This manual provides essential information for the safe and efficient use of your Reality Leuchten R52121131 Maxi LED Table Lamp. Please read these instructions carefully before operating the device and retain them for future reference. The MAXI table lamp is a versatile, battery-powered lighting solution designed for various applications, including kitchens, workplaces, and workshops. Its modern matte white design and touch-switchable brightness levels offer adaptability and energy efficiency.





Image 1.1: The Maxi LED Table Lamp, showcasing its sleek matte white finish and minimalist design.

2. IMPORTANT SAFETY INSTRUCTIONS

- Read all instructions before use.
- Do not expose the lamp to water or excessive moisture.
- Use only the provided USB-C cable and power adapter for charging.
- Do not attempt to disassemble or modify the lamp. This will void the warranty and may cause damage or injury.
- Keep the lamp away from heat sources and direct sunlight.
- Ensure the lamp is placed on a stable surface when in use.
- This product contains a non-replaceable LED light source. Do not attempt to replace the LED.
- Dispose of the product responsibly according to local regulations for electronic waste.

3. PACKAGE CONTENTS

Please check that all items listed below are included in your package:

- Maxi LED Table Lamp (lamp head with integrated battery)
- Lamp Base
- Magnetic Adhesive Button
- Magnetic Clamp
- USB-C Charging Cable
- Power Adapter
- User Manual (this document)



Image 3.1: All included components: the lamp head, the base, a magnetic clamp, a magnetic adhesive button, and the USB-C charging cable with power adapter.

4. SETUP AND ASSEMBLY

The Maxi LED Table Lamp offers flexible mounting options due to its magnetic connection system.

4.1. Using with the Lamp Base

1. Place the lamp base on a flat, stable surface.
2. Align the magnetic bottom of the lamp head with the top of the lamp base. The lamp head will securely attach magnetically.
3. Adjust the angle of the lamp head as desired.



Image 4.1: The Maxi lamp fully assembled on its circular base, demonstrating its stable and upright position.

4.2. Using with the Magnetic Clamp

1. Attach the magnetic clamp to a suitable surface, such as a table edge or shelf. Ensure the clamp is securely fastened.
2. Align the magnetic bottom of the lamp head with the magnetic point on the clamp. The lamp head will attach.

3. Adjust the lamp head to direct light as needed.

4.3. Using with the Magnetic Adhesive Button

1. Clean the desired surface thoroughly where you wish to mount the lamp.
2. Remove the protective film from the adhesive side of the magnetic button.
3. Press the magnetic button firmly onto the clean surface for at least 30 seconds. Allow the adhesive to set for a few hours before attaching the lamp.
4. Once the adhesive is set, align the magnetic bottom of the lamp head with the magnetic button. The lamp head will attach.
5. Adjust the lamp head to direct light as needed.

5. OPERATING INSTRUCTIONS

5.1. Charging the Lamp

- Locate the USB-C charging port on the lamp head.
- Connect the provided USB-C cable to the lamp and the power adapter.
- Plug the power adapter into a standard wall outlet.
- The charging indicator light (if present) will illuminate to show charging status.
- A full charge typically takes approximately 2 to 3 hours.
- Once fully charged, the lamp provides approximately 2 hours of illumination at maximum brightness.

5.2. Turning On/Off and Adjusting Brightness

The lamp features a touch sensor for control.

1. **To Turn On:** Lightly touch the sensor area on the lamp head. The lamp will turn on at the lowest brightness setting.
2. **To Adjust Brightness:** Continue to lightly touch the sensor area. Each subsequent touch will cycle through the three available brightness levels (low, medium, high).
3. **To Turn Off:** After cycling through all brightness levels, the next touch will turn the lamp off.

RL

live your light



Image 5.1: Visual representation of key features: USB-C charging, magnetic attachment, integrated battery, and touch-sensitive operation.

6. CARE AND MAINTENANCE

- **Cleaning:** Disconnect the lamp from any power source before cleaning. Wipe the lamp with a soft, dry cloth. Do not use abrasive cleaners, solvents, or harsh chemicals, as these may damage the finish.
- **Storage:** If storing the lamp for an extended period, ensure it is fully charged and store it in a cool, dry place. Recharge the battery every 3-6 months to maintain its lifespan.
- **Battery Care:** Avoid fully discharging the battery frequently. For optimal battery life, charge the lamp before the battery is completely depleted.

7. TROUBLESHOOTING

Problem	Possible Cause	Solution
Lamp does not turn on.	Battery is depleted.	Charge the lamp using the provided USB-C cable and adapter.
Lamp does not turn on.	Touch sensor not responding.	Ensure your finger is clean and dry. Lightly touch the sensor area.
Lamp does not charge.	Charging cable or adapter is faulty.	Check connections. Try a different compatible USB-C cable and adapter if available.
Short operating time after full charge.	Battery degradation or operating at highest brightness.	Battery lifespan naturally decreases over time. Operating at lower brightness levels will extend battery life.

8. PRODUCT SPECIFICATIONS

Feature	Detail
Model Number	R52121131
Brand	RL LIVE YOUR LIGHT
Manufacturer	Reality Leuchten
Material	Metal
Color	Matte White
Light Source Type	Integrated LED
Power Consumption	2 Watts
Luminous Flux	200 lm
Voltage	5 Volts
Battery Type	Integrated, rechargeable
Charging Time	Approx. 2-3 hours
Operating Time (Full Charge)	Approx. 2 hours (at max brightness)
Switch Style	Touch Sensor (3-step dimming)
Product Dimensions (L x W x H)	12 x 20 x 36 cm (approx. 4.7 x 7.9 x 14.2 inches)
Item Weight	620 g (approx. 1.37 lbs)
Energy Efficiency Rating	F

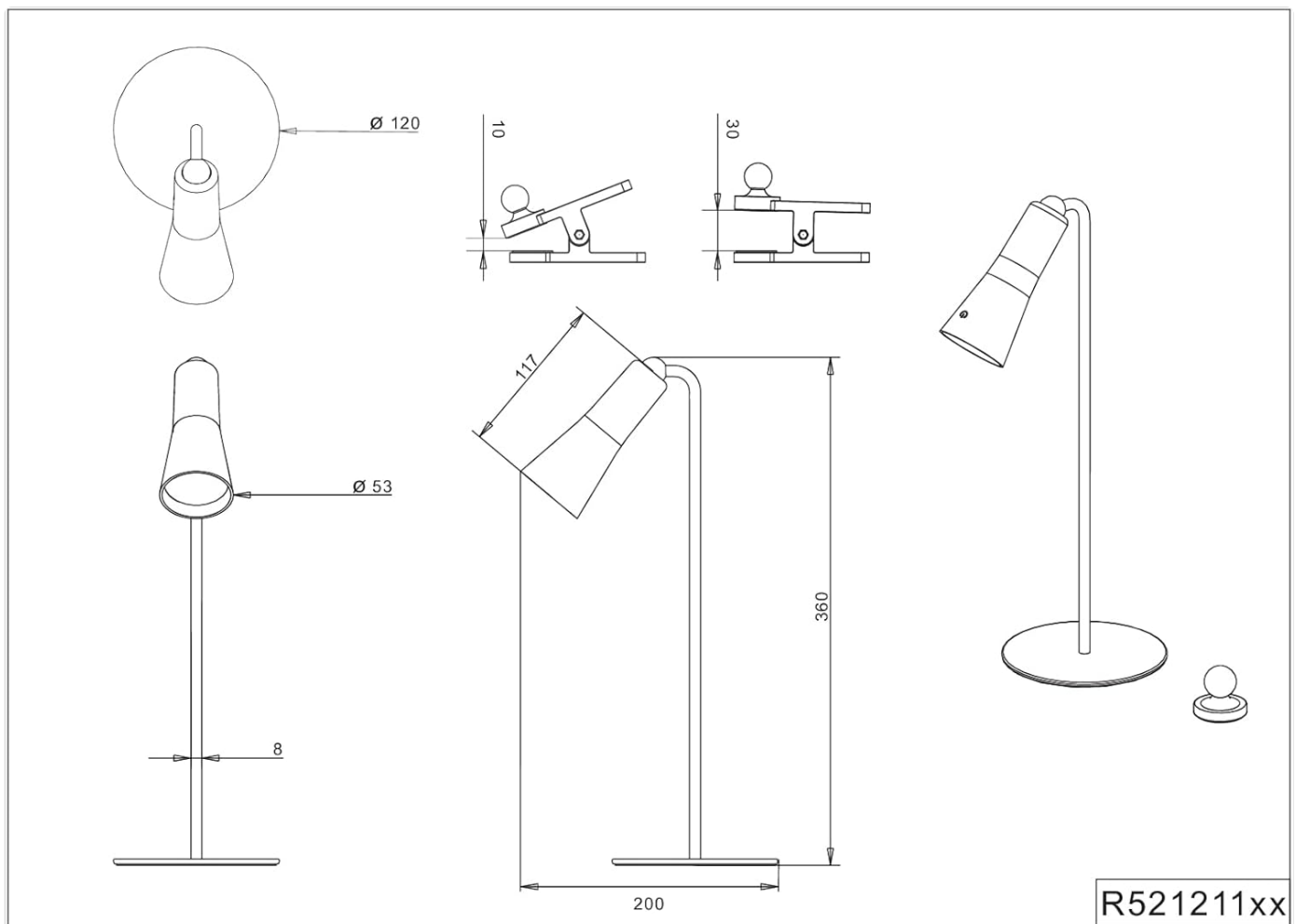

Image 8.1: Detailed technical drawing showing the dimensions of the lamp and its components in millimeters.



Image 8.2: The energy efficiency label for the Maxi LED Table Lamp, indicating a rating of F.







9. WARRANTY AND SUPPORT

Information regarding specific warranty terms is not provided in the product details. For warranty claims or technical support, please refer to the retailer where the product was purchased or contact the manufacturer, Reality Leuchten, directly through their official website or customer service channels.

© 2023 RL LIVE YOUR LIGHT. All rights reserved.

This manual is for informational purposes only. Specifications are subject to change without notice.

Related Documents - R52121131

	<p>RL LED Rechargeable Table Lamp R521761XX - Safety & Specifications</p> <p>Concise guide to the RL LED rechargeable table lamp (Art.Nr. R521761XX), detailing essential safety warnings in multiple languages, product specifications, charging information, and manufacturer details.</p>
	<p>Vivilumens S22 White Noise Wireless Charger Table Lamp User Manual</p> <p>User manual for the Vivilumens S22, a white noise wireless charger table lamp with Bluetooth speaker and adjustable phone holder. Includes specifications, operating instructions for wireless charging, table lamp, white noise machine, and wireless speaker, along with important notes and FCC statement.</p>
	<p>MIBOXER TRI-C1 AC Triac RF+Push Dimmer Installation Guide</p> <p>Detailed guide for the MIBOXER TRI-C1 AC Triac RF+Push Dimmer, covering features, parameters, wiring, installation, and operation for dimmable LED, filament, and halogen lamps.</p>
	<p>MIBOXER TRI-PW AC Triac Dimmer: WiFi, 2.4G RF, Push Control, App & Voice Control Guide</p> <p>User manual and guide for the MIBOXER TRI-PW AC Triac Dimmer. Learn about features, parameters, connection diagrams, remote control pairing, smartphone app control (Tuya Smart), Alexa, and Google Home voice assistant integration.</p>
	<p>Reality R32201106 LED Pendant Light: Safety and Installation Guide</p> <p>Official safety warnings and installation instructions for the Reality R32201106 LED pendant light. Includes product specifications and manufacturer details from Reality Leuchten GmbH.</p>
	<p>Reality Laredo R20026942 Outdoor Wall Light with Sensor - Installation and Safety Guide</p> <p>This document provides safety instructions and assembly guidance for the Reality Laredo R20026942 outdoor wall light, featuring a built-in sensor. Includes technical specifications and installation steps.</p>