

ZMJH A102S-W

ZMJH A102S-W Smart Electric Bidet Toilet Seat User Manual

Model: A102S-W | Brand: ZMJH



1. INTRODUCTION

This manual provides comprehensive instructions for the installation, operation, and maintenance of your ZMJH A102S-W Smart Electric Bidet Toilet Seat. Please read this manual thoroughly before installation and use to ensure proper function and safety.

2. IMPORTANT SAFETY INFORMATION

Always follow basic safety precautions when using electrical appliances to reduce the risk of fire, electric shock, and injury. This appliance is for household use only.

- Ensure the product is connected to a properly grounded outlet.
- Do not immerse the product in water or other liquids.
- Unplug the product during lightning storms or when unused for long periods.
- Keep the power cord away from heated surfaces.
- Do not operate if the cord or plug is damaged.
- Supervise children to ensure they do not play with the appliance.

3. PACKAGE CONTENTS

Verify that all components are present before beginning installation:

- ZMJH A102S-W Smart Electric Bidet Toilet Seat
- Wireless Remote Control
- Installation Hardware Kit (bolts, nuts, mounting plate, T-valve)
- Water Supply Hose / PE Pipe
- User Manual



Image: ZMJH A102S-W Smart Electric Bidet Toilet Seat with its remote control, showcasing the main product and its primary interface.

4. PRODUCT FEATURES

The ZMJH A102S-W Bidet Toilet Seat offers a range of advanced features for enhanced hygiene and comfort:

- **Water Heater with 3 Temperature Settings:** Provides instant and continuous warm water for washing.
- **Heated Seat with 3 Temperature Settings:** Ensures comfort, especially in colder environments.
- **Water Pressure with 3 Settings:** Adjustable water pressure for personalized cleaning.
- **Warm Air Dryer with 3 Levels:** Reduces the need for toilet paper by providing a gentle drying function.
- **Rear and Front Wash (Vortex Wash):** Dedicated nozzles for thorough posterior and feminine cleansing.

- **Remote Control:** Conveniently adjust settings from a wireless remote.
- **Illuminating LED Night Light:** A soft blue light for visibility during nighttime use.
- **Stainless Steel Nozzle:** Hygienic and self-cleaning nozzle for optimal sanitation.
- **Hybrid Heating Technology:** Ensures a continuous supply of warm water.
- **Save Preferred Settings:** Customize and save your favorite settings for quick access.

MUTIPLE FUNCTIONS: We Focus On Your Experience.



**ADJUSTABLE
WARM WATER**



**ADJUSTABLE
WATER PRESSURE**



**MASSAGE &
SPA WASH**



**CONSTANT
WARM WATER**



**ADJUSTABLE
WARM AIR**



Image: Diagram illustrating the various adjustable functions of the bidet seat, such as warm water, water pressure, massage, and warm air.

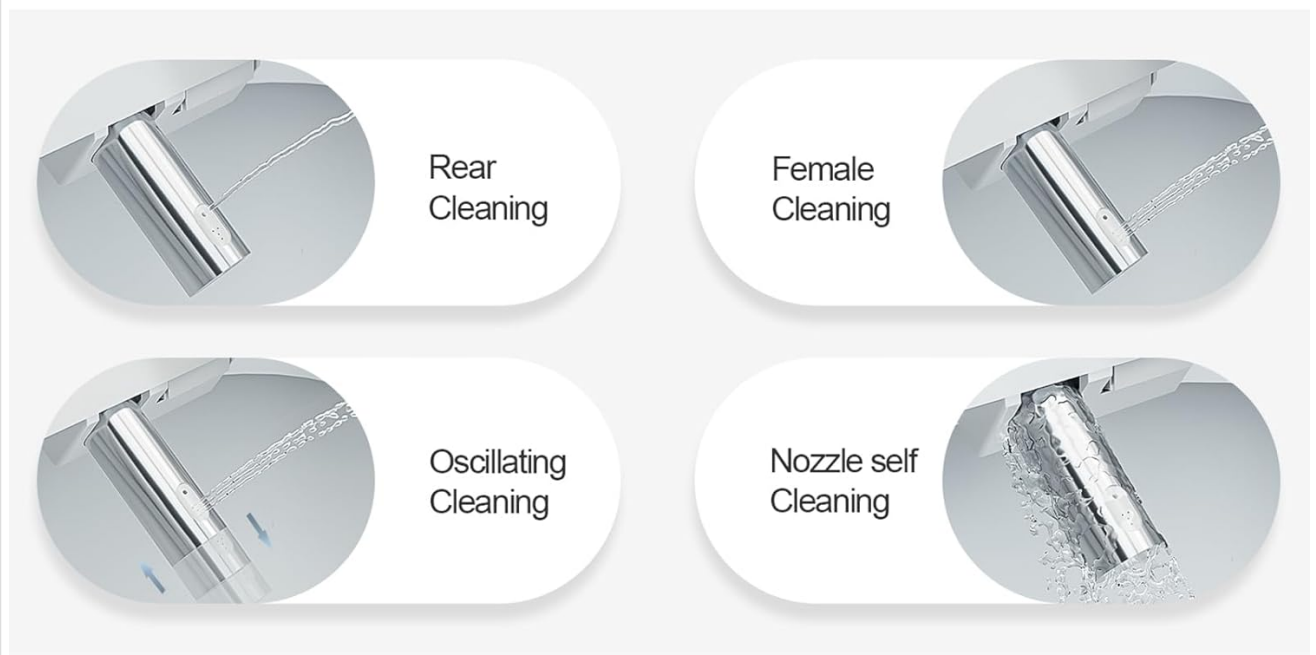

Image: Close-up view of the stainless steel nozzle, highlighting its self-cleaning capability and different wash modes: Rear Cleaning, Female Cleaning, and Oscillating Cleaning.

5. SETUP AND INSTALLATION

Installation is designed to be straightforward. Ensure you have an electrical outlet near your toilet. If not, professional installation of an outlet may be required.

1. **Prepare the Toilet:** Turn off the water supply to your toilet. Flush the toilet to drain the tank.
2. **Remove Existing Seat:** Detach your current toilet seat.
3. **Install Mounting Plate:** Place the mounting plate on the toilet bowl, aligning it with the bolt holes. Secure it using the provided bolts and nuts. Ensure the rubber nuts are slightly wet before insertion for easier installation and a tight fit.
4. **Connect T-Valve:** Disconnect the existing water supply hose from the toilet tank. Install the provided T-valve between the toilet tank and the water supply hose.
5. **Connect Bidet Water Hose:** Attach one end of the provided PE pipe (water supply hose for the bidet) to the T-valve. Connect the other end to the water inlet on the side of the bidet toilet seat.

6. **Slide Bidet Seat into Place:** Carefully slide the bidet toilet seat onto the installed mounting plate until it clicks securely into position.
7. **Restore Water and Power:** Turn the water supply back on and check for leaks. Plug the bidet seat into a grounded electrical outlet.

STAINLESS STEEL NOZZLE

Powerful Water Spray
Provides An Effective Clean



SIDE CONTROL

Multi-functional side
control operating



HEATED SEAT

Adjustable 3Levels
Constant Temperature

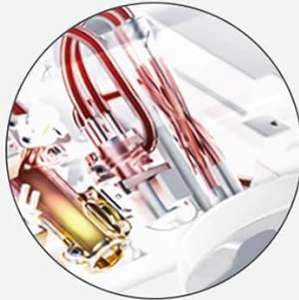

UNLIMITED HOT WATER

No Cold Water Shock . Ever

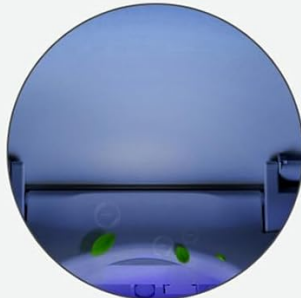

NIGHT LIGHT

Night Light and DeodorizeBuilt In
Damper Close Seat Slowly



DRYER

Adjustable 3Levels
Warm Air Temperature

Image: Visual guide demonstrating the connection of the T-valve and water supply hose to the bidet seat.



Image: The ZMJH bidet toilet seat fully installed on a standard toilet, showing its sleek appearance and connection to the water line.

Your browser does not support the video tag.

Video: A user demonstrating the unboxing and installation process of the ZMJH Smart Bidet Toilet Seat, including connecting the water supply and placing the seat.

6. OPERATING INSTRUCTIONS

Your ZMJH bidet seat can be operated using the wireless remote control or the side control panel on the seat itself.

6.1 Remote Control Functions

WIRELESS REMOTE

Two AAA batteries need to be prepared

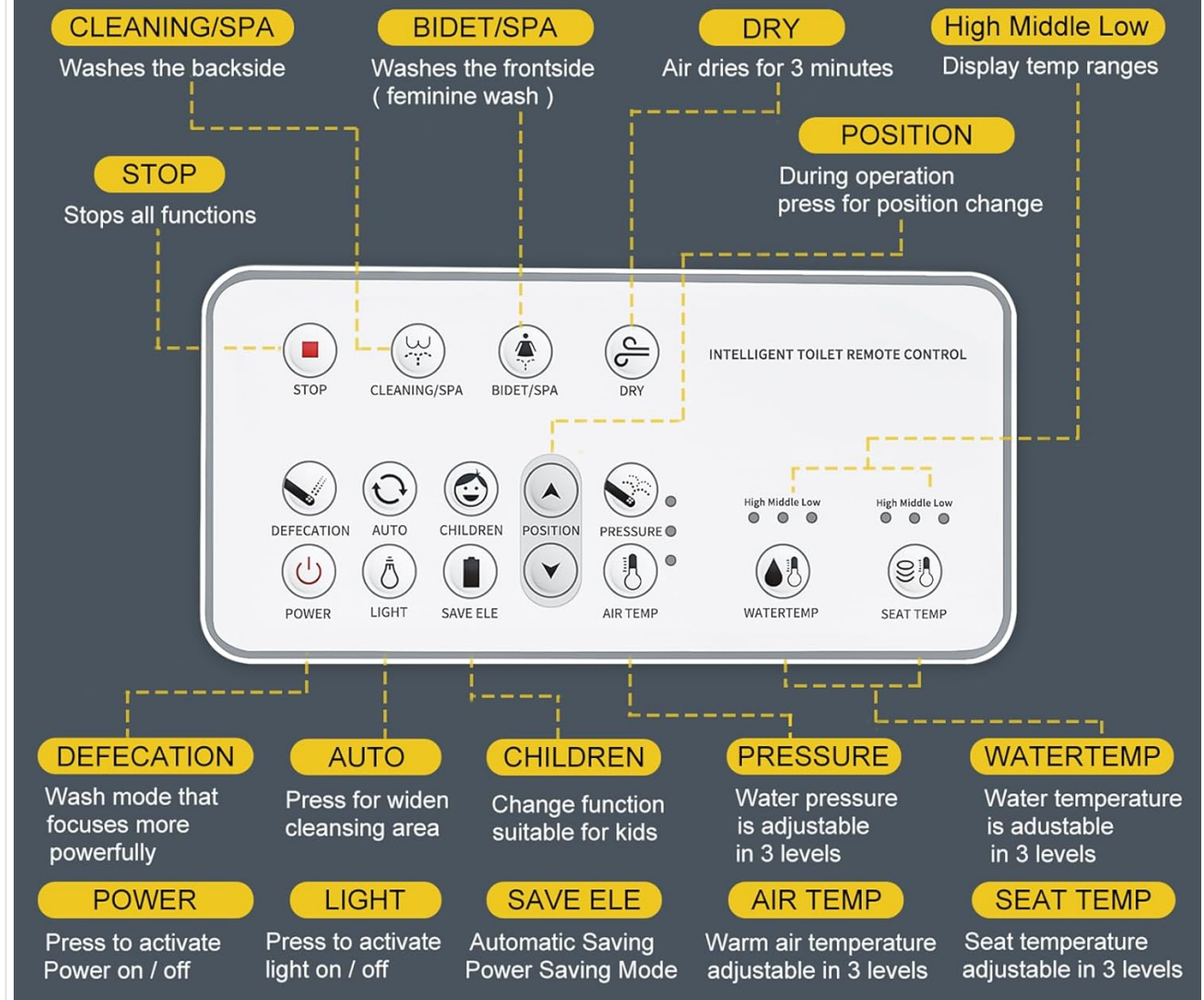

Image: A comprehensive diagram of the remote control, detailing each button's function for various bidet operations and settings.

- **STOP:** Stops all current functions.
- **CLEANING/SPA:** Activates the rear wash function.
- **BIDET/SPA:** Activates the feminine wash function.
- **DRY:** Initiates the warm air drying cycle (lasts for 3 minutes).
- **DEFECATION:** Provides a focused wash mode to assist with bowel movements.
- **AUTO:** Activates a wider cleansing area.
- **CHILDREN:** Engages a gentle wash and dry cycle suitable for children.
- **POSITION (Up/Down Arrows):** Adjusts the nozzle position.
- **PRESSURE (Dots):** Adjusts water pressure (3 levels).
- **AIR TEMP (Thermometer Icon):** Adjusts warm air temperature (3 levels).
- **WATERTEMP (Water Drop Icon):** Adjusts water temperature (3 levels).
- **SEATTEMP (Seat Icon):** Adjusts heated seat temperature (3 levels).
- **POWER:** Turns the unit on/off.
- **LIGHT:** Toggles the night light on/off.

- **SAVE ELE:** Activates the automatic power-saving mode.

6.2 Side Control Panel

Basic functions can also be accessed directly from the side of the bidet seat, useful if the remote is misplaced or batteries are low.



Image: Close-up of the multi-functional side control panel on the bidet seat, offering essential controls.

6.3 Night Light

The cool blue LED night light provides gentle illumination, making it easier to use the toilet in the dark without turning on bright overhead lights.

Your browser does not support the video tag.

Video: A demonstration of the bidet's night light feature, showing the blue illumination within the toilet bowl.

7. MAINTENANCE

Regular cleaning and maintenance will ensure the longevity and hygienic operation of your bidet seat.

- **Nozzle Cleaning:** The stainless steel nozzle has a self-cleaning feature. Activate it regularly via the remote control. For manual cleaning, gently wipe the nozzle with a soft cloth and mild, non-abrasive cleaner.
- **Exterior Cleaning:** Wipe the exterior surfaces of the bidet seat with a soft, damp cloth and a mild detergent. Avoid harsh chemicals or abrasive cleaners that could damage the finish.
- **Filter Cleaning:** Periodically check and clean the water inlet filter to prevent blockages and maintain optimal water pressure. Refer to the detailed manual for specific instructions on accessing and cleaning the filter.
- **Winterization (if applicable):** If the bidet seat will be exposed to freezing temperatures, ensure all water is drained from the unit to prevent damage.

8. TROUBLESHOOTING

If you encounter any issues, refer to the following common troubleshooting tips:

Problem	Possible Cause	Solution
No power/Unit not turning on	Not plugged in; power outage; circuit breaker tripped.	Ensure unit is securely plugged in. Check power supply and circuit breaker.
No water spray/Low pressure	Water supply valve closed; clogged filter; low household water pressure.	Open water supply valve. Clean the water inlet filter. Check household water pressure.

Problem	Possible Cause	Solution
Water temperature inconsistent	Water heater setting too low/high; external water temperature fluctuations.	Adjust water temperature setting on remote. Allow time for water to heat up.
Heated seat not working	Seat temperature setting too low; power-saving mode active.	Adjust seat temperature setting. Deactivate power-saving mode if desired.

For further assistance, please contact ZMJH customer support.

9. SPECIFICATIONS

- **Model Number:** A102S-W
- **Brand:** ZMJH
- **Color:** White
- **Material:** Acrylonitrile Butadiene Styrene (ABS)
- **Shape:** Oval (Elongated)
- **Product Dimensions:** 20"L x 15"W
- **Item Weight:** 10 Pounds
- **Voltage:** 110 Volts
- **UPC:** 749684842901
- **Included Components:** Smart Bidet Toilet Seat, Remote Control, Installation Kit
- **Batteries Required for Remote:** Yes (not included)

Bidet Toilet Seat Fit Check

Our Products Are Suitable For The Following Sizes, Please Check Carefully Before Purchase.



Image: A diagram illustrating how to check if the bidet seat fits elongated or round toilet bowls, including required dimensions and electrical outlet placement.

10. WARRANTY AND SUPPORT

For warranty information, product registration, or technical support, please refer to the contact details provided on the ZMJH official website or your purchase documentation. Keep your proof of purchase for warranty claims.