

[manuals.plus](#) /

› [AIKE](#) /

› [AIKE Touch-Free Shower Shampoo Dispenser Wall Mount Triple Chambers 3 x 10 fl.oz. Battery Operated Model AK1903 White Instruction Manual](#)

AIKE AK1903

AIKE Touch-Free Shower Shampoo Dispenser Instruction Manual

Model: AK1903

INTRODUCTION

Thank you for choosing the AIKE Touch-Free Shower Shampoo Dispenser. This manual provides detailed instructions for the proper installation, operation, and maintenance of your new dispenser. Designed for convenience and hygiene, this triple-chamber, battery-operated unit offers a touch-free solution for dispensing shampoo, conditioner, and shower gel, helping to keep your bathing space organized and tranquil. Its inductive operation makes it handicap-friendly, and the IPX7 waterproof rating ensures durability in wet environments.



Image: Front view of the AIKE Touch-Free Shower Shampoo Dispenser, showing three clear chambers filled with different liquids and a hand positioned below the sensor for dispensing.

SAFETY INFORMATION

- Do not submerge the entire unit in water for extended periods, despite its IPX7 rating. The IPX7 rating ensures protection against temporary immersion (up to 1 meter for 30 minutes), but it is primarily designed for rinsing and splash resistance.
- Ensure batteries are inserted with correct polarity.
- Keep out of reach of small children.
- Use only the recommended type and number of batteries (4 AA batteries).
- Do not mix old and new batteries, or different types of batteries.
- Dispose of used batteries responsibly according to local regulations.
- Avoid using abrasive cleaners or solvents on the dispenser's surface.
- Ensure the wall surface is dry, clean, and smooth before adhesive installation to prevent the dispenser from falling.

PACKAGE CONTENTS

Please check the box for the following items:

- AIKE Touch-Free Shower Shampoo Dispenser (Model AK1903)
- 3M Adhesive Mounting Tape
- Screw Mount Kit (screws and wall anchors)
- User Manual

PRODUCT OVERVIEW

The AIKE AK1903 dispenser features three independent chambers for different liquids, each with its own dispensing mechanism and sensor. The main unit houses the battery compartment and the electronic components that control the touch-free operation.



TRE SISTEMI OPERATIVI

Funzionamento indipendente, nessuna interferenza.

Image: An internal diagram of the dispenser highlighting the three separate operating systems and the battery placement, indicating independent functionality.

Key Components:

- **Liquid Chambers:** Three transparent chambers for holding shampoo, conditioner, shower gel, or other compatible liquids.
- **Infrared Sensors:** Located at the bottom of each dispensing nozzle for touch-free activation.
- **Dispensing Nozzles:** Outlets for the dispensed liquid.
- **Battery Compartment:** Located on the back or top of the unit, requiring 4 AA batteries.
- **Indicator Lights:** Blue LED lights illuminate during dispensing.

SETUP

1. Battery Installation

1. Locate the battery compartment cover, usually on the top or back of the dispenser.
2. Open the cover.
3. Insert 4 new AA batteries, ensuring correct polarity (+/-) as indicated inside the compartment.
4. Close the battery compartment cover securely.

2. Filling the Chambers

1. Remove the top lid of the dispenser.
2. Carefully pour your desired liquid (shampoo, conditioner, shower gel) into each of the three separate chambers. Do not overfill.
3. Replace the top lid firmly.

3. Mounting the Dispenser

The dispenser supports both adhesive and screw mounting options. Choose the method most suitable for your wall surface.



Image: An illustration detailing various wall surface types, indicating which are suitable for adhesive installation (marble, steel, ceramic, mirror, glass) and which are suitable for screw installation (painted wall, wallpaper, rough surface, rustic tile, wooden).

Adhesive Installation (Recommended for smooth surfaces)

1. Clean the desired wall surface thoroughly. Ensure it is dry, clean, and smooth.
2. Peel the protective backing from the 3M adhesive tape.
3. Align the adhesive plate on the back of the dispenser with the chosen spot on the wall.
4. Press firmly for at least 30 seconds, ensuring all sections of the tape are pressed down and air bubbles are removed, especially at the top of the adhesive.

5. Allow the adhesive to cure for 24 hours before hanging the dispenser or filling it with liquids to ensure maximum adhesion.
6. Ensure there is at least 25 cm (approximately 10 inches) of clear space below the dispenser for optimal use.

Durante l'installazione, tutte le sezioni del nastro devono essere premute saldamente e le bolle d'aria devono essere rimosse, specialmente nella parte superiore dell'adesivo, contrassegnata dal riquadro rosso nel diagramma sottostante.

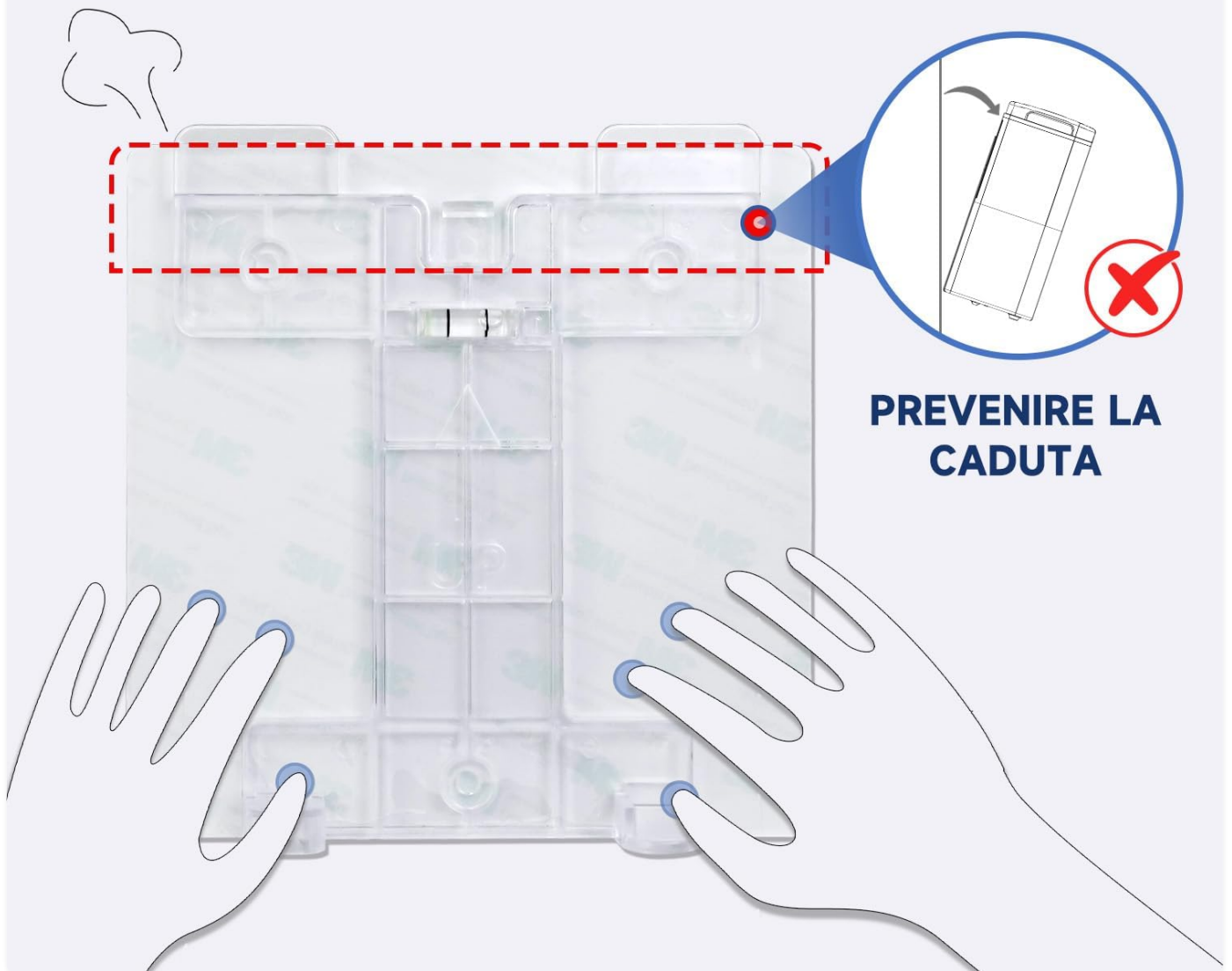

Image: A diagram illustrating the correct method for applying the adhesive mounting tape, with a red box highlighting the importance of pressing firmly and removing air bubbles from the top section to prevent the dispenser from falling.



Lasciare almeno 25 cm di spazio sotto il dispenser del sapone.

Image: The dispenser mounted on a bathroom wall, with a measurement indicating a minimum of 25 cm (approximately 10 inches) of space required underneath for proper operation.

Screw Installation (For rough or painted surfaces)

1. Hold the mounting plate against the wall at the desired height and mark the screw hole positions with a pencil.
2. Drill pilot holes at the marked positions. Insert wall anchors if necessary.
3. Secure the mounting plate to the wall using the provided screws.
4. Carefully slide the dispenser onto the mounted plate until it clicks securely into place.

OPERATING INSTRUCTIONS

The AIKE dispenser uses infrared sensors for touch-free operation, ensuring a hygienic experience.

1. Place your hand directly under the desired dispensing nozzle. The infrared sensor will detect your hand.
2. The blue indicator light above the chamber will illuminate, and the dispenser will automatically release a measured amount of liquid.

3. Remove your hand once the desired amount is dispensed. The dispenser will stop automatically.
4. To dispense more liquid, simply place your hand under the sensor again.

The dispenser features five variable dispensing levels. To adjust the volume, press and hold the power button (if available, or refer to specific model instructions for volume adjustment) until the indicator light flashes, then release and press again to cycle through levels. The product description mentions "five variable levels" but does not specify how to adjust them. Assuming a common method for such devices.

MAINTENANCE

Cleaning

Thanks to its IPX7 waterproof rating, the AIKE dispenser can be easily cleaned to maintain its appearance and hygiene.

- For general cleaning, simply rinse the exterior of the dispenser directly with water.
- Wipe down with a soft, damp cloth and mild soap if needed.
- Do not use harsh chemicals, abrasive cleaners, or scouring pads, as these can damage the finish.
- Ensure the dispensing nozzles are clear of any dried liquid buildup.



Image: The AIKE dispenser being rinsed under running water, demonstrating its IPX7 waterproof capability for easy cleaning.

Refilling

When a chamber is low on liquid, simply remove the top lid and refill as described in the "Filling the Chambers" section under Setup.

TROUBLESHOOTING

Problem	Possible Cause	Solution
Dispenser not working / No liquid dispensed.	Batteries are dead or incorrectly installed. Chamber is empty. Sensor is blocked or dirty. Liquid is too thick.	Replace batteries with new AA batteries, ensuring correct polarity. Refill the chamber. Clean the sensor area with a soft cloth. Dilute the liquid with a small amount of water if it's too viscous.
Dispenser falls off the wall.	Improper adhesive installation. Wall surface not suitable for adhesive.	Ensure wall is clean, dry, and smooth. Reapply adhesive tape, pressing firmly and allowing 24 hours to cure before use. Consider using screw installation for rough or painted surfaces.
Liquid leaks from the dispenser.	Lid not properly sealed. Dispenser damaged.	Ensure the top lid is securely closed. Contact AIKE support if the unit is damaged.

SPECIFICATIONS

Feature	Detail
---------	--------

Feature	Detail
Model Number	AK1903
Brand	AIKE
Color	White
Material	Plastic
Product Dimensions (L x W x H)	8.58" x 3.11" x 6.61" (21.9 cm x 7.9 cm x 16.8 cm)
Liquid Volume per Chamber	Approx. 10 fl.oz. (300 ml)
Total Liquid Volume	Approx. 30 fl.oz. (887.21 ml)
Power Source	4 x AA Batteries (not included)
Waterproof Rating	IPX7
Mounting Options	3M Adhesive Tape, Screw Mount

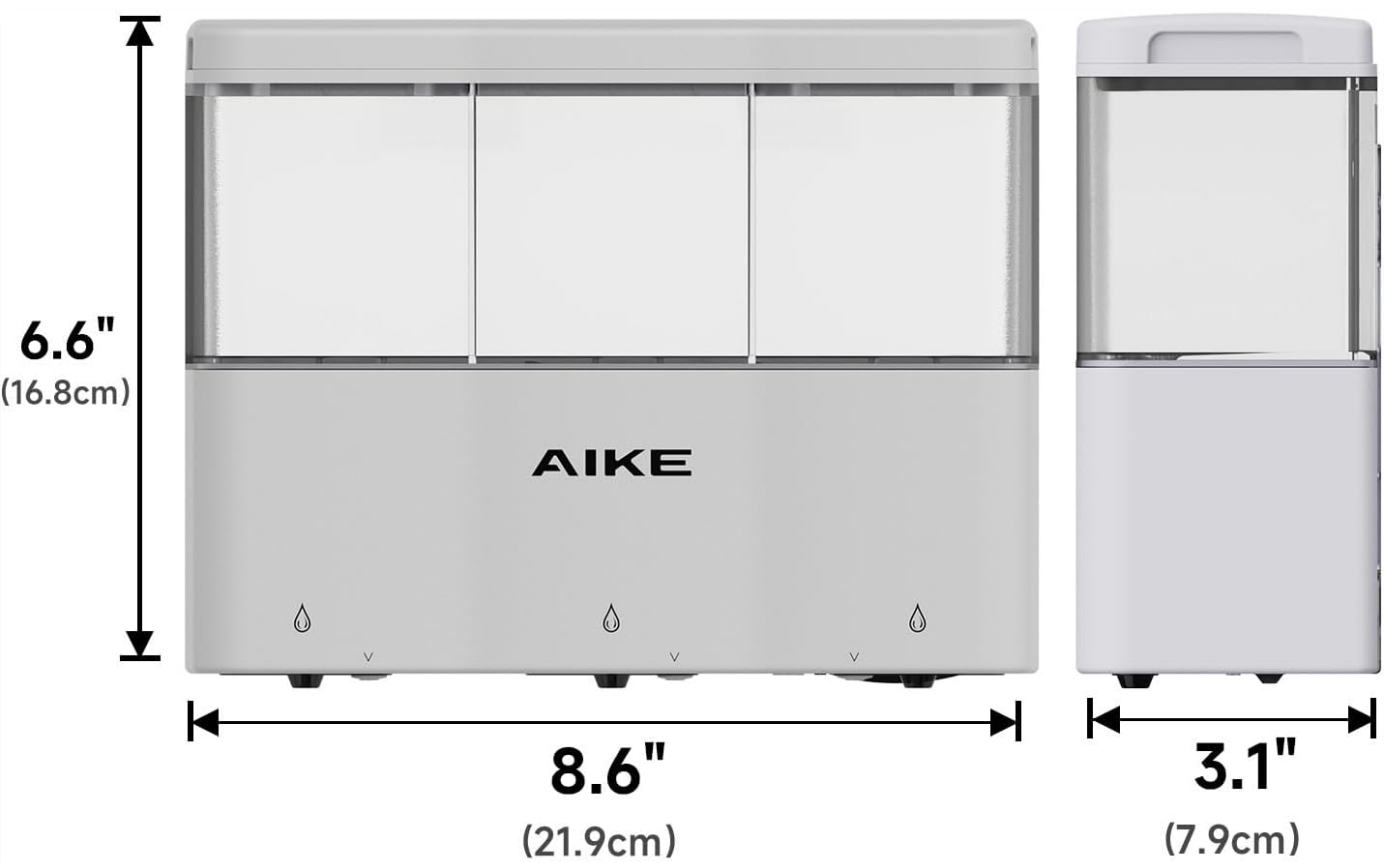

Dimensioni : 16,8 cm x 21,9 cm x 7,9 cm

Capacità : 320 ml per camera

Batteria : Richiede 4 batterie AA (non incluse)

Image: A detailed diagram illustrating the dimensions of the AIKE dispenser, including length, width, and height in both inches and

centimeters.





WARRANTY AND SUPPORT

The AIKE Touch-Free Shower Shampoo Dispenser comes with a one-year manufacturer warranty from the date of purchase. For any questions, concerns, or support needs, please contact AIKE support via Amazon message or our dedicated support email. We are committed to providing excellent customer service and are happy to assist you.

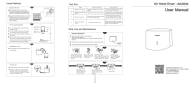

© 2023 AIKE. All rights reserved.

Related Documents - AK1903

	AIKE AK1333 Automatic Soap Dispenser User Manual and Specifications Detailed user manual and specifications for the AIKE AK1333 Automatic Sensor Soap Dispenser, including how to use, warnings, packing list, and liquid adjustment features.
	AIKE AK1205 Automatic Soap Dispenser User Manual User manual for the AIKE AK1205 Automatic Soap Dispenser. Provides detailed instructions on installation, operation, liquid adjustment, battery management, troubleshooting, and specifications for the AIKE automatic soap dispenser.
	AIKE AK1205 Automatic Soap Dispenser User Guide This document provides a user guide for the AIKE AK1205 Automatic Soap Dispenser, covering packing list, installation instructions, usage guidelines, and battery replacement reminders in multiple languages.
	AIKE High Speed Hand Dryer AK2822 User Manual User manual for the AIKE High Speed Hand Dryer, model AK2822. Provides instructions on operation, routine maintenance, cleaning the air filter, installation, troubleshooting, and technical specifications.
	AIKE AK2630 Air Hand Dryer User Manual User manual for the AIKE AK2630 Air Hand Dryer, covering installation, testing, daily use, maintenance, specifications, and safety precautions.
	Infanti Aike Stroller: User Manual, Safety Guide, and Warranty Information Comprehensive guide for the Infanti Aike stroller, including safety warnings, assembly and usage instructions, and warranty details. Suitable for children weighing 9 to 15 kg.

[\[pdf\]](#) User Manual Guide

AIKE AK1903 23 06 01 AK1903 Manual BookAIKE Touch Free IPX7 Water Proof Shower
Shampoo Dispenser AIKE Direct StoreAK1903 User Bookcdn shopify s files 1 0606 5930 2585 Book v
1709284563 |||

Packing List Dispenser*1 Self-Adhesive Mounting Plate*1 Automatic Soap Dispenser
AK1223 EN User Gu ... 16 Automatic
Soap Dispenser **AK1903** EN User Guide

lang:it **score:33** filesize: 2.39 M page_count: 10 document date: 2024-03-01

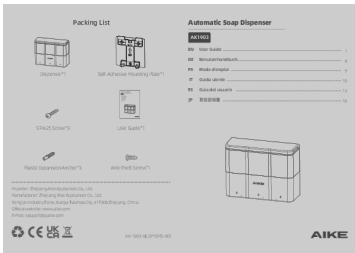

[\[pdf\]](#) User Manual

AIKE AK1903 23 06 01 AK1902 User ManualAIKE 2 Chambers Automatic Soap Dispenser Wall
Mount Shower Gel Dispens AIKE Direct StoreAIKE Manual AK1902cdn shopify s files 1 0606 5930 2585
v 1735800915 |||

...

lang:it **score:18** filesize: 16.46 M page_count: 10 document date: 2023-10-20

