

## FITNATE HS0396G-CA

# FITNATE Smart Biometric Fingerprint Door Knob (Model HS0396G-CA) Instruction Manual

Brand: **FITNATE** | Model: **HS0396G-CA**

## 1. INTRODUCTION

This manual provides detailed instructions for the installation, operation, and maintenance of your FITNATE Smart Biometric Fingerprint Door Knob. This device offers secure and convenient keyless entry through fingerprint recognition, smartphone application control, and traditional key access.

### Key Features

- **Multiple Unlocking Methods:** Fingerprint, App Control, and Emergency Spare Key.
- **Modern Design:** Features one-touch unlocking and a countdown indicator light.
- **Smart Control:** Biometric and App Control for fingerprint management, unlock records, automatic locking, passage modes, and security monitoring. Supports Tuya APP Bluetooth connectivity.
- **Easy Installation:** Designed for quick setup on most standard doors.
- **Safety Features:** Includes a low voltage reminder and emergency key access.

## 2. SETUP AND INSTALLATION

### Before You Begin

Ensure all components are present in the package. You will need a screwdriver for installation.

**Important:** For optimal performance and security, it is strongly recommended to perform a factory reset on the lock before initial setup. This ensures a clean configuration slate.

### Door Preparation and Dimensions

The lock is suitable for wooden doors, fire doors, and security doors with a thickness between 30mm and 55mm.

**Crucial Deadbolt Alignment:** For effortless operation, ensure the strike plate spacing is adjusted to 60-70mm (approximately 2.36-2.76 inches) during installation. Proper alignment at this distance ensures the deadbolt operates smoothly and effortlessly. Refer to the installation cutting template for detailed adjustment steps.



Image: Diagram illustrating the dimensions and compatibility of the FITNATE Fingerprint Door Knob with standard door preparations, showing measurements for backset and bore hole.

## Step-by-Step Installation

1. Refer to the provided installation cutting template for precise drilling if necessary.
2. Install the latch into the door edge.
3. Attach the exterior and interior knob assemblies, ensuring proper alignment of the spindle and wiring.
4. Secure the lock with the provided screws.
5. Test the mechanical operation of the handle before proceeding with electronic setup.

# EASY TO INSTALL

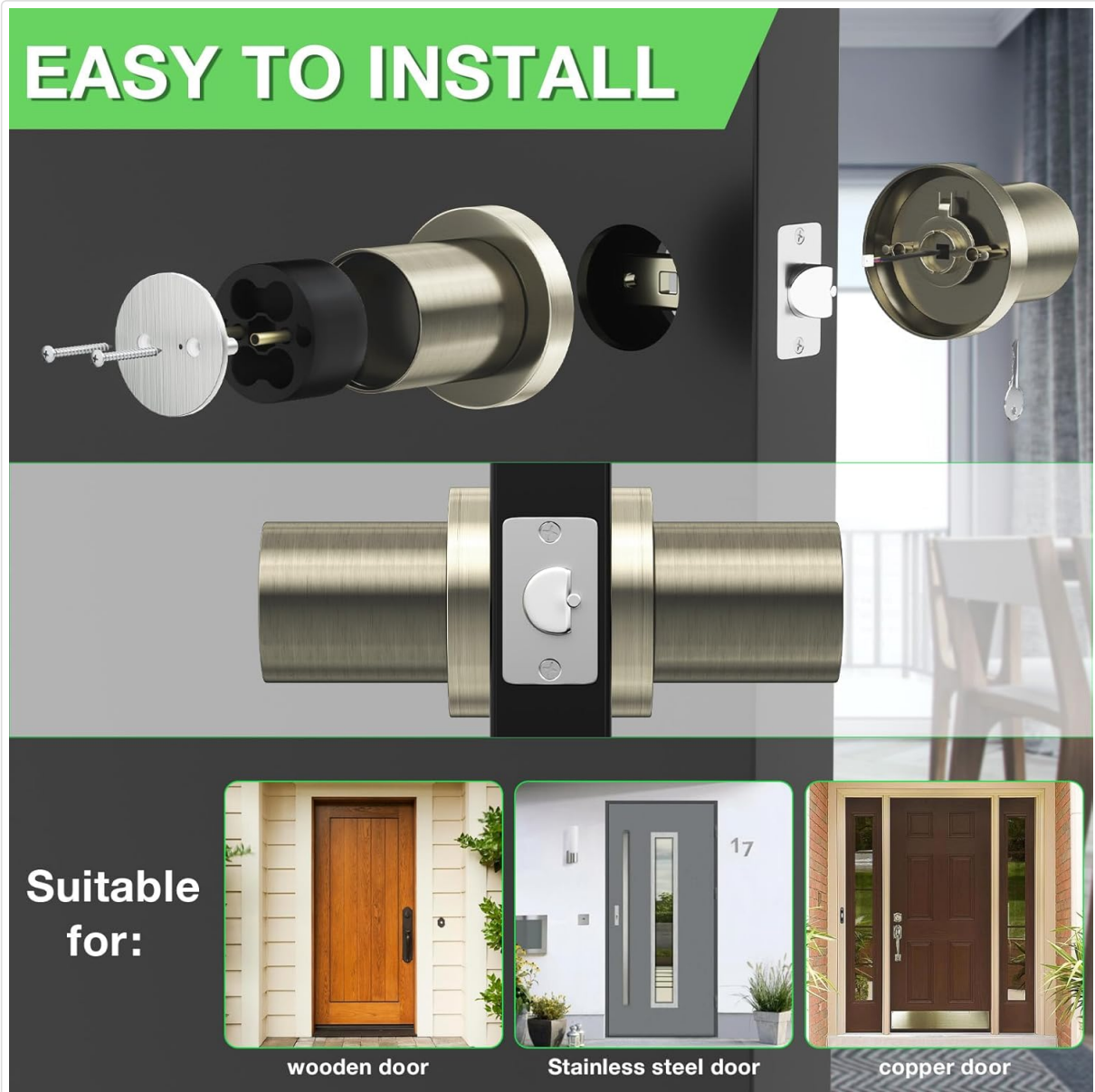

Image: Exploded view of the FITNATE Fingerprint Door Knob components and a visual guide to the installation process, showing how the parts fit together.

## Battery Installation

The smart door lock requires 4 AA batteries (not included).

**Best Practice:** Always use brand-new batteries and ensure correct polarity alignment (+/-) when installing. Proper power source is crucial for consistent operation.

## 3. OPERATING INSTRUCTIONS

### Unlocking Methods

#### Fingerprint Unlocking

To unlock using a registered fingerprint, place your finger on the sensor. The lock will verify your fingerprint and unlock.

# Low Battery Reminder Function&spare key

*the deadbolt lock will alarm when in low battery status or you can use a spare key f or emergency charging*



Image: A hand placing a finger on the biometric sensor of the FITNATE Fingerprint Door Knob for unlocking.

## App Control Unlocking

The lock supports the Tuya APP via Bluetooth. Download the app, pair your device, and follow the in-app instructions to unlock remotely.



# SMART HOME LIFE

Support Tuya APP Bluetooth acceptance,  
can share users



*Fingerprint  
Unlock*



*APP Remote  
Connection*



Image: A smartphone screen displaying the FITNATE app interface for controlling the smart door lock, showing a "Tap and Hold to Unlock" button.

## Emergency Key Unlocking

In case of battery depletion or electronic malfunction, use the provided emergency spare key to unlock the door manually.

# Can store up to 20 fingerprints for users



Image: The FITNATE Fingerprint Door Knob with an emergency key inserted into the keyhole, alongside an icon indicating low battery.

## Fingerprint Management (via App)

The app allows for easy management of fingerprints. You can add, delete, and assign fingerprints to different users. The lock can store up to 20 unique fingerprints.

**Optimize Fingerprint Recognition:** Scan the same finger from 6 distinct orientations during enrollment in the app. This multi-angle capture significantly enhances accuracy and reliability for faster unlocks.

# Fits On Most Standard Doors

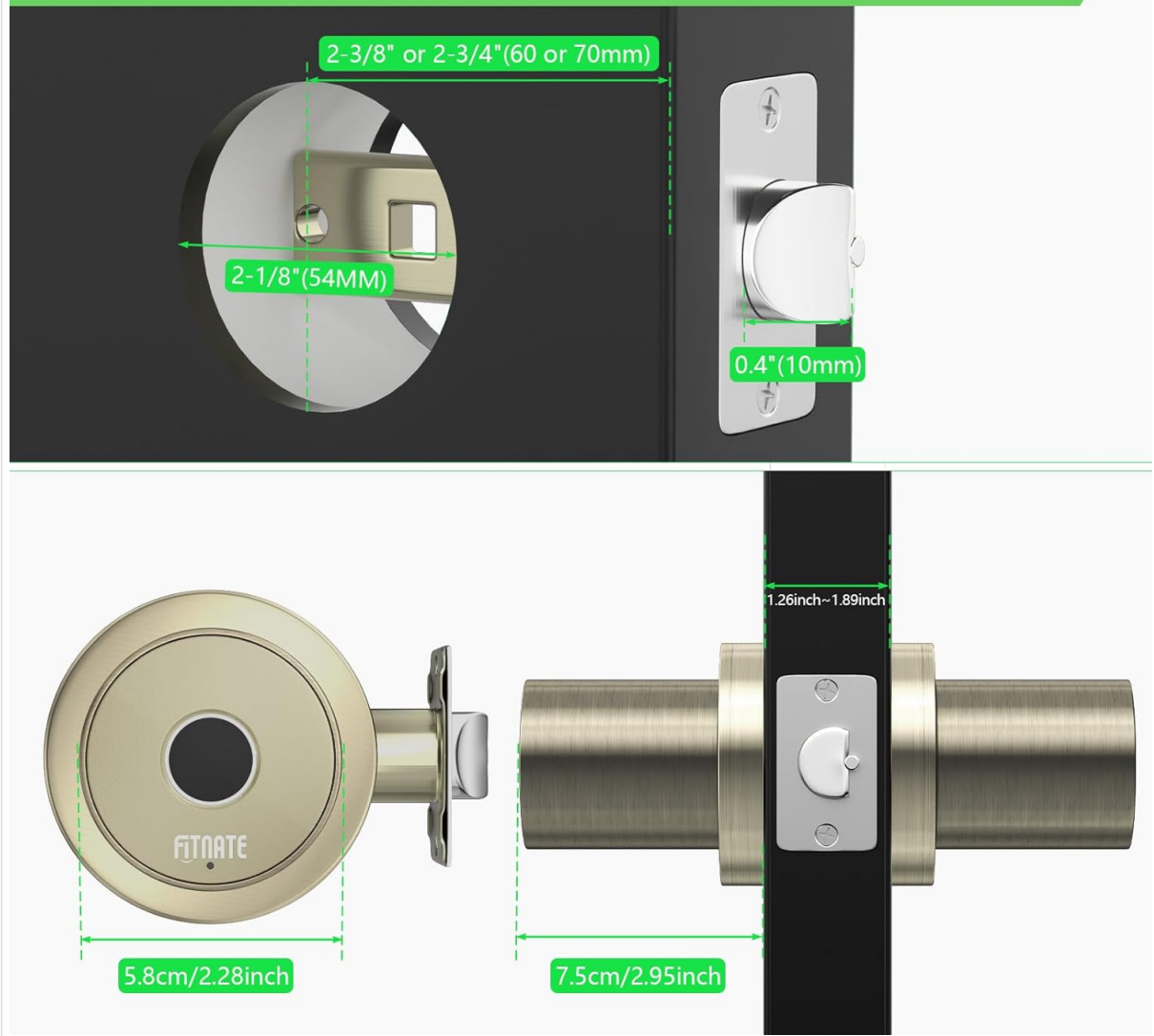

Image: A visual representation showing the FITNATE Fingerprint Door Knob and multiple user profiles, indicating the ability to store up to 20 unique fingerprints.

## App Features

- View unlock records.
- Configure automatic locking.
- Set passage modes (if available).
- Monitor security locks.
- Share user access.

## 4. MAINTENANCE

### Battery Replacement

The lock will provide a low voltage reminder when batteries are running low. Replace all 4 AA batteries promptly to ensure continuous operation.

### Cleaning

Clean the lock's exterior with a soft, dry cloth. Avoid abrasive cleaners or solvents that could damage the finish or electronic components.

## 5. TROUBLESHOOTING

### Common Issues and Solutions

- **Lock not responding:** Check battery levels and replace if necessary. Ensure the power switch is on.
- **Fingerprint not recognized:** Ensure your finger is clean and dry. Re-enroll your fingerprint, scanning from multiple angles as recommended.
- **Lock always in locked mode:** Verify app settings for automatic locking and passage mode. A factory reset may be required to clear incorrect configurations.
- **Difficulty turning handle:** Ensure the strike plate spacing is correctly adjusted (60-70mm). Lubricate the latch mechanism if needed.
- **Emergency power:** If batteries are completely dead, a USB-C cable can be used for temporary power to operate the lock and replace batteries.
- **Factory Reset:** If persistent issues occur, perform a factory reset. Consult the app or detailed manual for specific steps.

## 6. SPECIFICATIONS

### Product Specifications

Feature	Detail
Manufacturer	FITNATE
Model Number	HS0396G-CA
Material	Aluminum
Color	Golden
Lock Type	Biometric
Special Features	Auto-Lock, Fingerprint, Touchscreen
Installation Method	Screw-In
Door Thickness Compatibility	30-55mm
Power Source	4 AA Batteries (not included)
Item Weight	960 g
Product Dimensions	22 x 13.79 x 8.99 cm
Warranty	1 year

## 7. WARRANTY AND SUPPORT







## Warranty Information

This FITNATE product comes with a 1-year warranty from the date of purchase. This warranty covers manufacturing defects and malfunctions under normal use.

## Customer Support

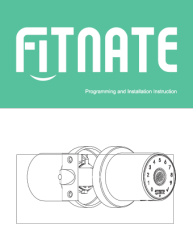
For technical assistance, troubleshooting, or warranty claims, please contact FITNATE customer support. Refer to the product packaging or the official FITNATE website for contact details.

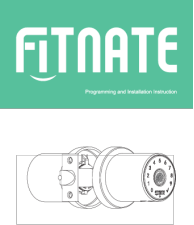
### Related Documents - HS0396G-CA

	<p><a href="#">Fitnate Smart Door Lock HS0434K/HS0434S: Programming and Installation Guide</a></p> <p>This guide provides comprehensive instructions for installing, programming, and operating the Fitnate HS0434K and HS0434S smart door locks. Learn how to set up the lock with the Tuya or Smart Life app, manage users, use various unlocking methods, and understand battery information and important safety precautions.</p>
	<p><a href="#">YL-98A Code Lock User Manual</a></p> <p>Instructions and specifications for the YL-98A Code Lock, a smart lock compatible with the Tuya Smart app, featuring Bluetooth unlocking and multi-user support.</p>
	<p><a href="#">Fitnate Lock Status Indicator Prompts</a></p> <p>A guide to understanding the lock status indicator prompts for various Fitnate smart lock models, detailing unlock, error unlock, and low battery alert signals.</p>
	<p><a href="#">Fitnate Smart Door Lock HS0434K/HS0434S: Programming and Installation Guide</a></p> <p>This guide provides comprehensive instructions for installing, programming, and operating the Fitnate HS0434K and HS0434S smart door locks. Learn how to set up the lock with the Tuya or Smart Life app, manage users, use various unlocking methods, and understand battery information and important safety precautions.</p>
	<p><a href="#">YL-98A Code Lock User Manual</a></p> <p>Instructions and specifications for the YL-98A Code Lock, a smart lock compatible with the Tuya Smart app, featuring Bluetooth unlocking and multi-user support.</p>

**CODEALARM**

**PROFESSIONAL  
SERIES**

**CA 5053  
Owner's Guide**

**Remote Start and Keyless  
Entry System**

©2014 CODE ALARM, Inc. All rights reserved. This document is the property of CODE ALARM, Inc. and is to be used only for the purpose of providing information to the owner of the vehicle. It is not to be reproduced, stored in a retrieval system, or transmitted in any form or by any means, electronic, mechanical, photocopying, recording, or by any information storage and retrieval system. All other rights reserved.

[CODE ALARM CA 5053 Owner's Guide: Remote Start and Keyless Entry System](#)

Comprehensive owner's guide for the CODE ALARM CA 5053 Professional Series remote start and keyless entry system, detailing features, operation, and warranty information.